

In Case of FIRE

Philadelphia Fire Department • Fire Prevention Division

HOME FIRE SAFETY PLAN

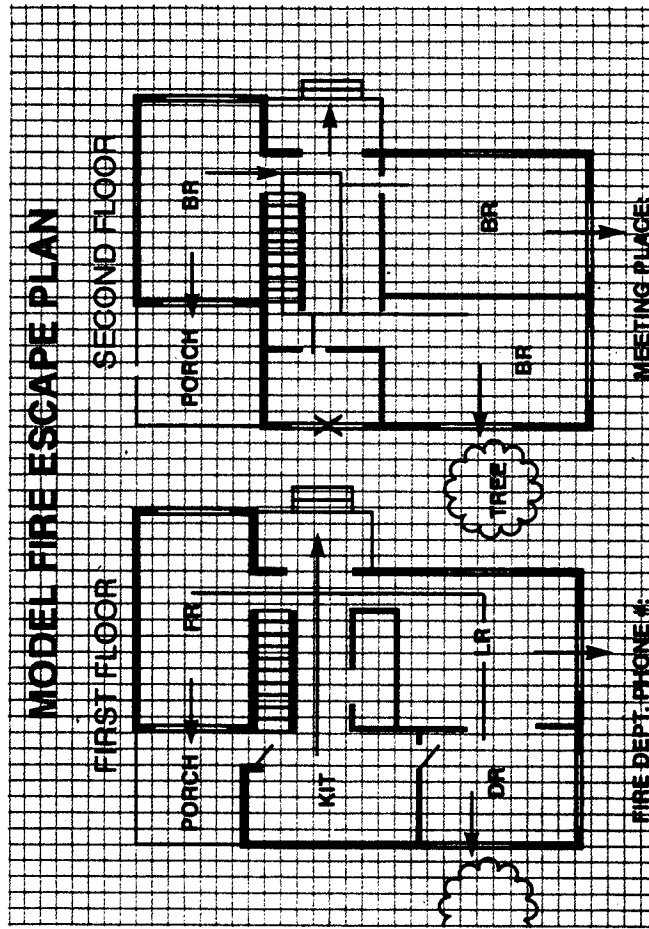

Philadelphia Fire Department
240 Spring Garden Street
Philadelphia, PA 19123

For additional help or information
visit your local firehouse or call
the Fire Prevention Division at
686-1382

HOME ESCAPE PLANNING

- PLACE SMOKE DETECTORS ON EACH LEVEL OF YOUR HOME.
- DRAW YOUR ESCAPE ROUTES FROM EACH LEVEL OF YOUR HOME, PROVIDING AT LEAST TWO MEANS OF ESCAPE FROM EACH ROOM.

Note: When planning escape from the second floor or above you may need home escape ladders to safely get out a window.

- BE SURE TO PROVIDE FOR ASSISTANCE FOR THOSE THAT MAY NEED IT (ELDERLY, CHILDREN).
- HAVE A FAMILY MEETING PLACE.
- NEVER RETURN TO THE BURNING DWELLING.
- CALL 911 FROM A NEIGHBOR'S HOUSE.

PRACTICE YOUR HOME ESCAPE PLAN TWICE A YEAR

THE _____ FAMILY

HOME FIRE ESCAPE FLOOR PLAN

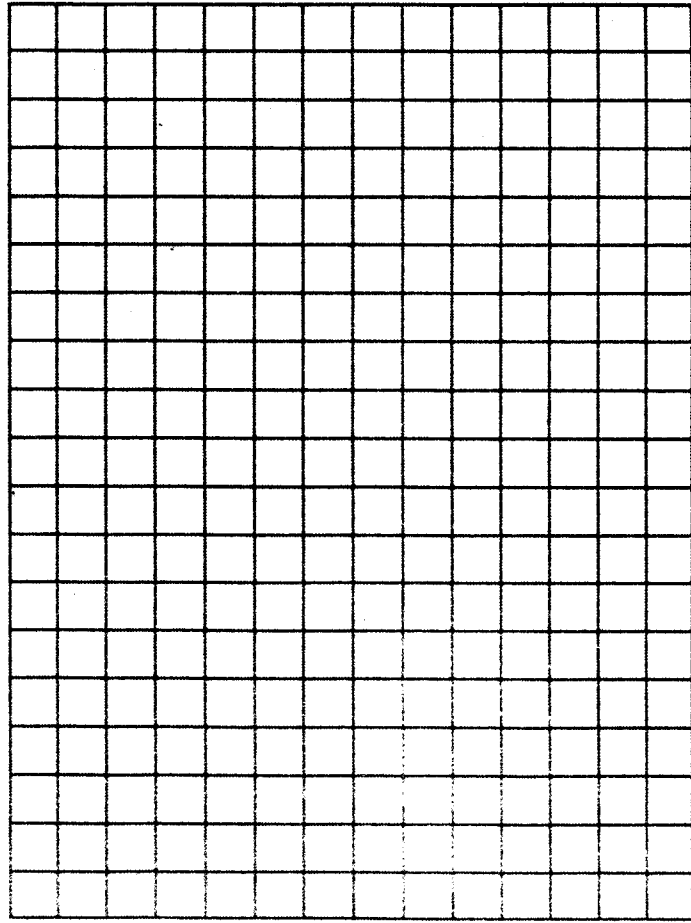

WORKING SMOKE DETECTORS SAVE LIVES!

Change your batteries twice a year.
Test your detector every week.

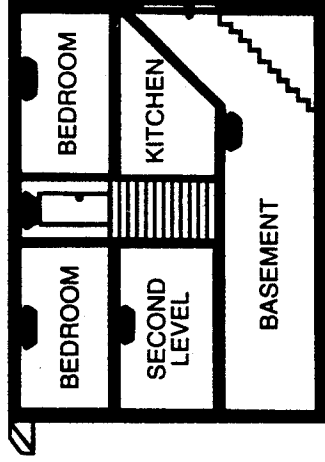

WHERE
SMOKE DETECTORS
SHOULD BE PUT UP

For complete coverage in residential homes, smoke detectors should be installed in all rooms, halls, storage areas, basements and attics. Minimum coverage is one detector on each level.

However, we suggest that you:

- Put a smoke detector in the hallway outside every separate bedroom area.
- Put a smoke detector on every floor of your home.
- Put a smoke detector inside every bedroom.
- Put a smoke detector as close to the center of the ceiling as possible.

