

Art Commission Review – Submittal Form

(Applicant complete below section)

Project Name: Riverview Wellness Village Percent for Art Project

Project Address: 7979 State Road **On Public Property?** Yes No

Total Budget: 525,000 **Utilizing City Funds?** Yes (specify amount): 100% No

Project Type (check all that apply):

- | | |
|--|--|
| <input type="checkbox"/> Building – New Construction or Addition | <input type="checkbox"/> Encroachment in/over ROW |
| <input type="checkbox"/> Building – Renovation or Repair | <input type="checkbox"/> Signage (Reconsideration) |
| <input type="checkbox"/> Plaza/Park/Playground | <input type="checkbox"/> Streetery (Reconsideration) |
| <input checked="" type="checkbox"/> Public Art | <input type="checkbox"/> Other: _____ |

Project Team:

Agency/Org.: Creative Philadelphia Design Lead (firm): Heavy Gate Studio LLC

Other: _____

Primary Contact for Project Communications:

Name: Marguerite Anglin

Affiliation: Creative Philadelphia

Email: [REDACTED]

(Art Commission staff complete below section)

Art Commission Meeting Date of Project Review: 5/13/26

Level of Review:

Concept Review Final Review If Final, specify date of preceding Concept Review: _____

Administrative Review (for projects with minimal visual impact on public realm)

Staff Notes (Optional):

The overall Riverview Wellness Village project, of which this proposal is the Percent for Art piece, was previously approved by Art Commission in March 2025.



April 29, 2026

Katherine Liss
Director
The Philadelphia Art Commission
One Parkway, 1515 Arch Street, 18th Floor
Philadelphia, PA 19102

SUBJECT: Request for Art Commission Concept Review - Percent for Art at Riverview Wellness Village

Dear Katherine:

Creative Philadelphia (Creative PHL) is requesting a concept review for a Percent for Art project at the Riverview Wellness Village during the Philadelphia Art Commission meeting on Wednesday, May 13th, 2026. The project is described below.

The Percent for Art opportunity for the Riverview Wellness Village was initiated in collaboration with our partners at the City's Capital Program Office as part of a transformative effort in this Administration's response to Philadelphia's substance use disorder. Located on a 19-acre site in Northeast Philadelphia, the capital project repurposes a cluster of 20th Century buildings into recovery-based housing. The facility currently offers approximately 300 beds, providing a stable, communal setting for individuals who are transitioning toward independent living, with a new building and campus expansion in progress for up to 600 beds.

The Riverview Wellness Village Percent for Art project will feature a series of contemporary sculptures. The content and themes of the project were shaped by community input, ensuring the final works reflect the voices and identity of the Riverview community and Philadelphians affected by the opioid epidemic. The artworks will be permanent and site-specific.

Creative PHL distributed a Call for Artists which was open from August - September 2025, and 141 applications were submitted. Creative PHL assembled a Percent for Art Committee to guide the artist selection, which included: community members, local artists, Riverview staff and residents, representatives of the Capital Program Office, City Council District 6 office, and Creative Philadelphia.

The Riverview Percent for Art Committee selected three finalists to provide design proposals. The artists received input and inspiration from the Riverview community through in-person and online community engagement meetings and a virtual public survey. Artists Margot

de Messieres and Tsvetomir Naydenov were selected by the Percent for Art Committee as the winning artists. Their designs feature three clusters of custom fabricated aluminum seating and a monumental gateway also with seating, which will provide the Riverview community contemplative spaces to gather outside in nature.

The sculptural seating will invite people to pause along a beautiful tree lined path, drawing on the campus's mid-century style through forged steel, aluminum, and strong, quiet forms. The seating elements will culminate along the pathway with two tall, forged sculptures that suggest opening leaves or expanding wings, marking a gateway with additional L-shaped benches and a lattice with hammered copper shapes. Each seating area sits within rings of granite pavers that resemble ripples on water.

The project will include artist-led community engagement during fabrication and installation, including artmaking sessions with residents at Riverview. During installation, residents and staff will be invited to hammer symbols, initials, or short messages into the benches, creating a textured, tactile record of shared memory over time.

We look forward to presenting this project to the Philadelphia Art Commission and collaborating with the Riverview community and our City partners to bring these artworks to life. Should you require any additional information, please do not hesitate to call me at 215.686.4596.

Sincerely,

A handwritten signature in black ink, appearing to read "Marguerite Anglin". The signature is fluid and cursive, with a long horizontal stroke at the end.

Marguerite Anglin, RA, NOMA
Public Art Director
Creative Philadelphia
City of Philadelphia

Turning New

Riverview Wellness Village
Marguerite de Messières and Tsvetomir Naydenov

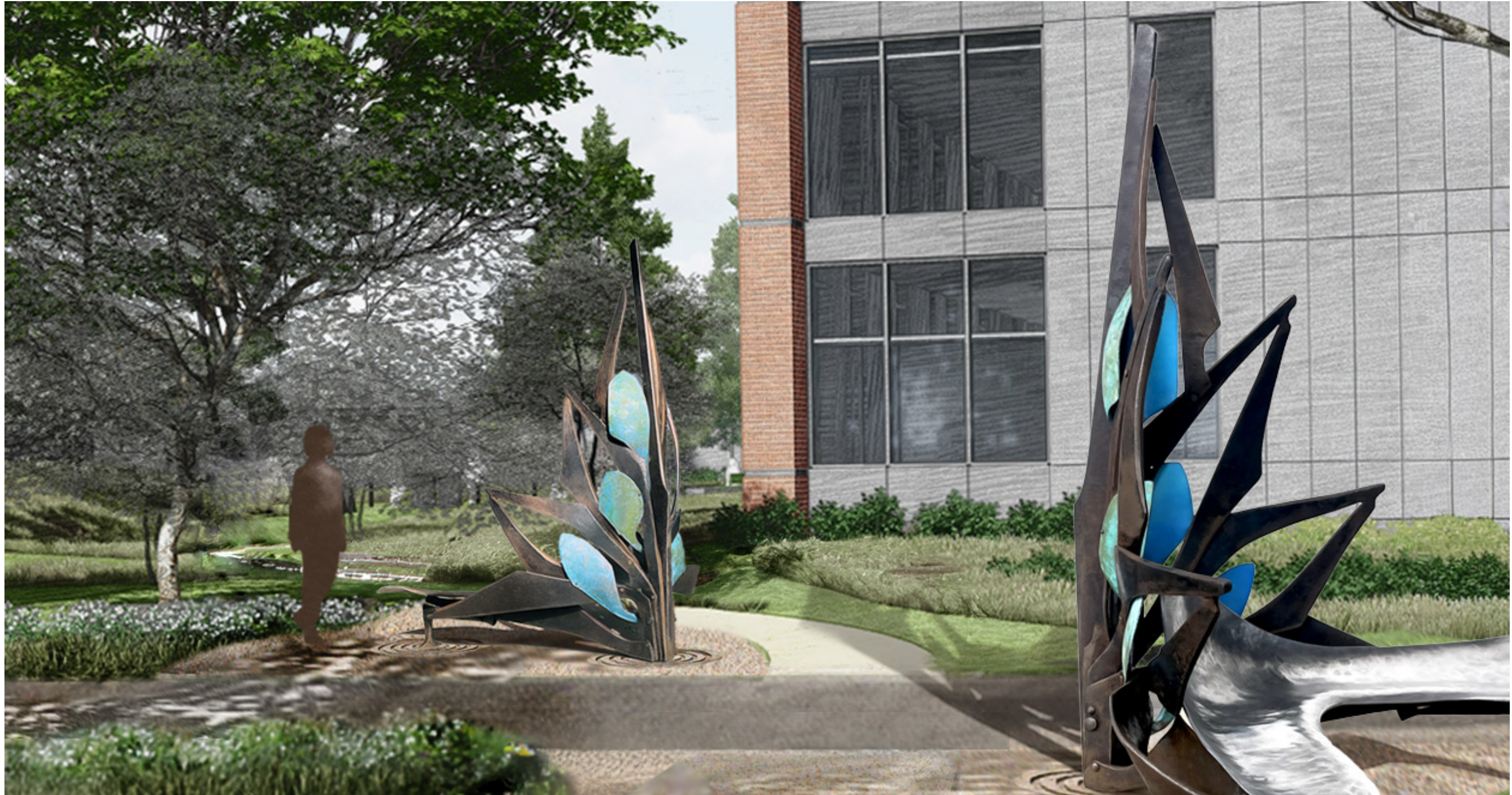

Art Location at Riverview Wellness Village

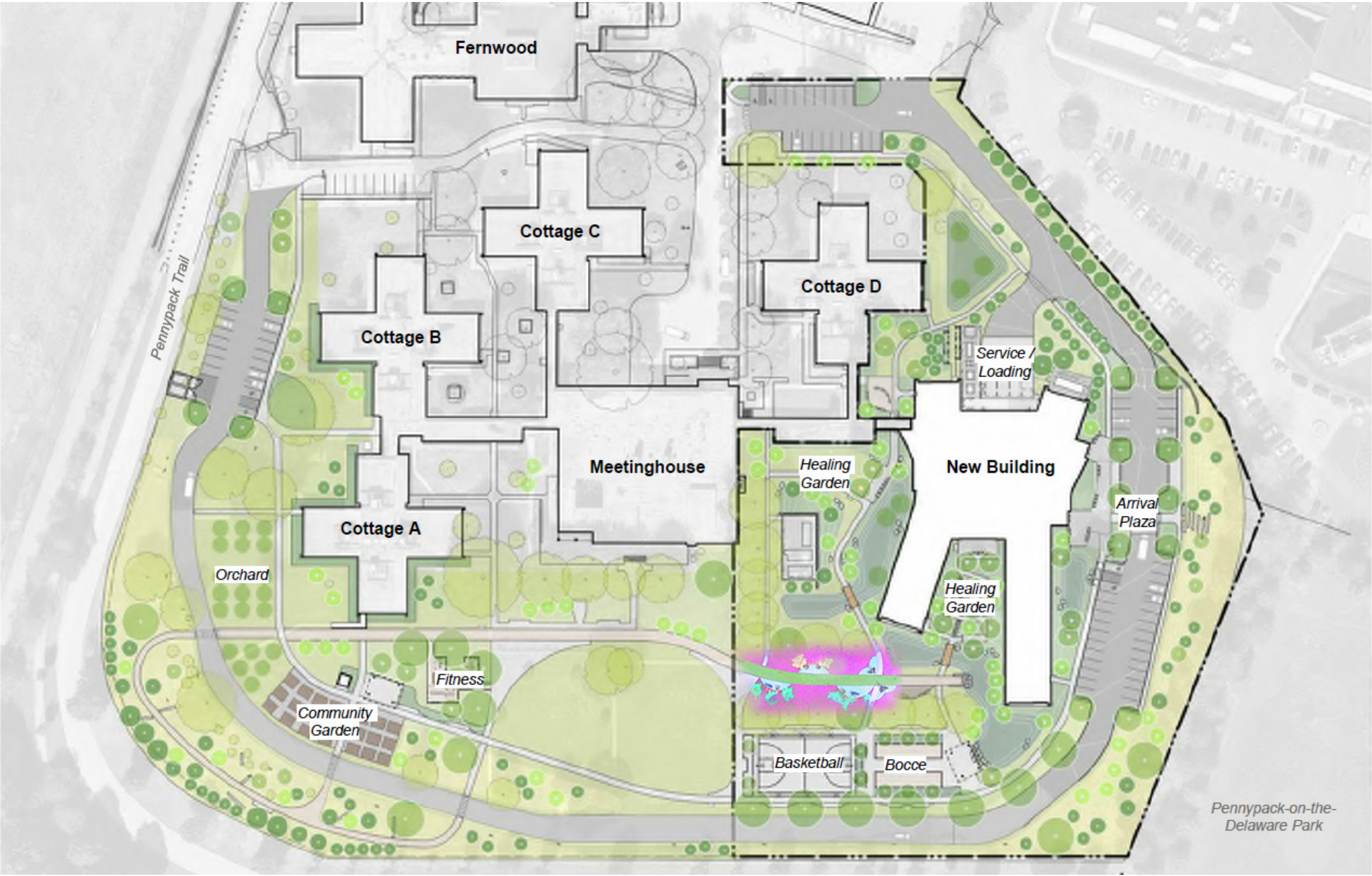

Art Location at Riverview Wellness Village



Current Site: Grand Allée of Trees



Current Site: Grand Allée of Trees



Site Response

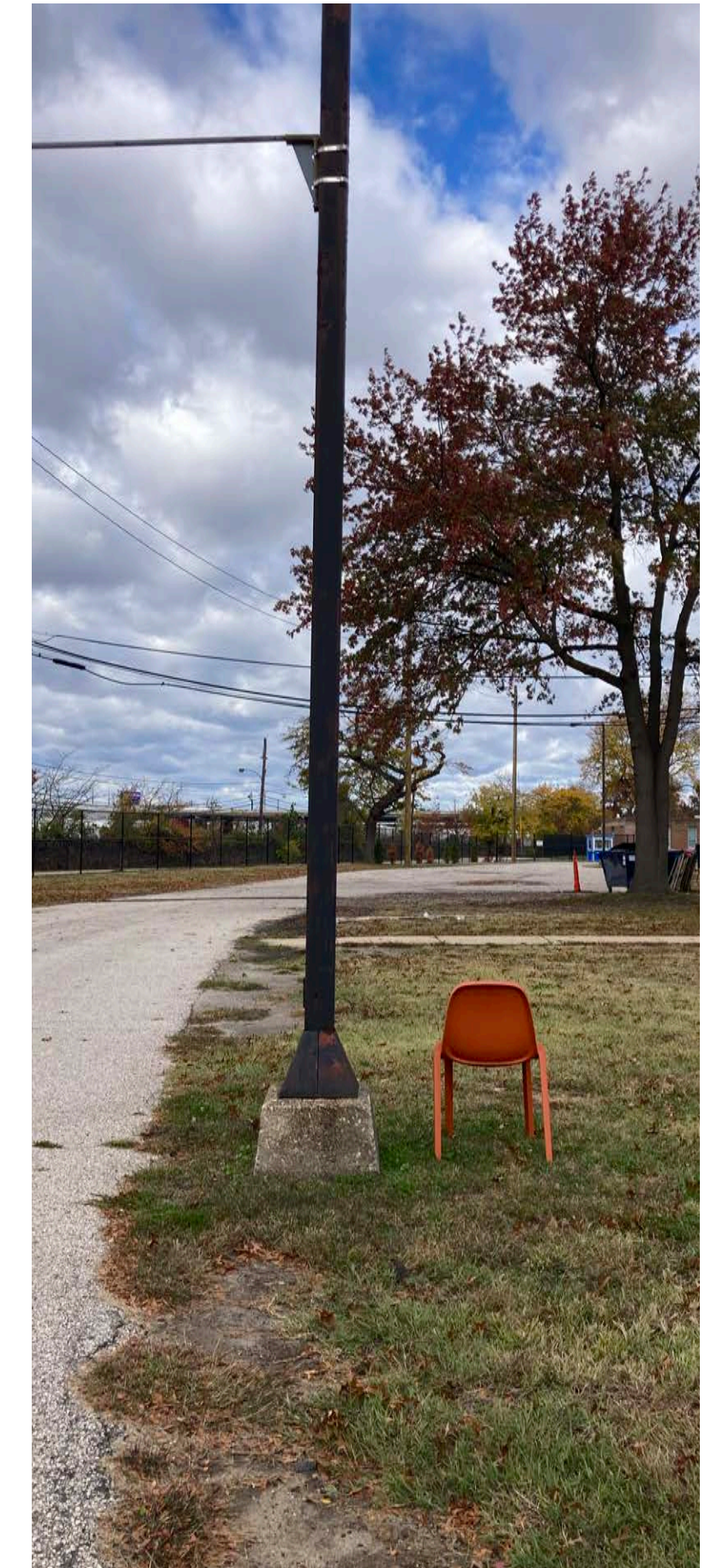
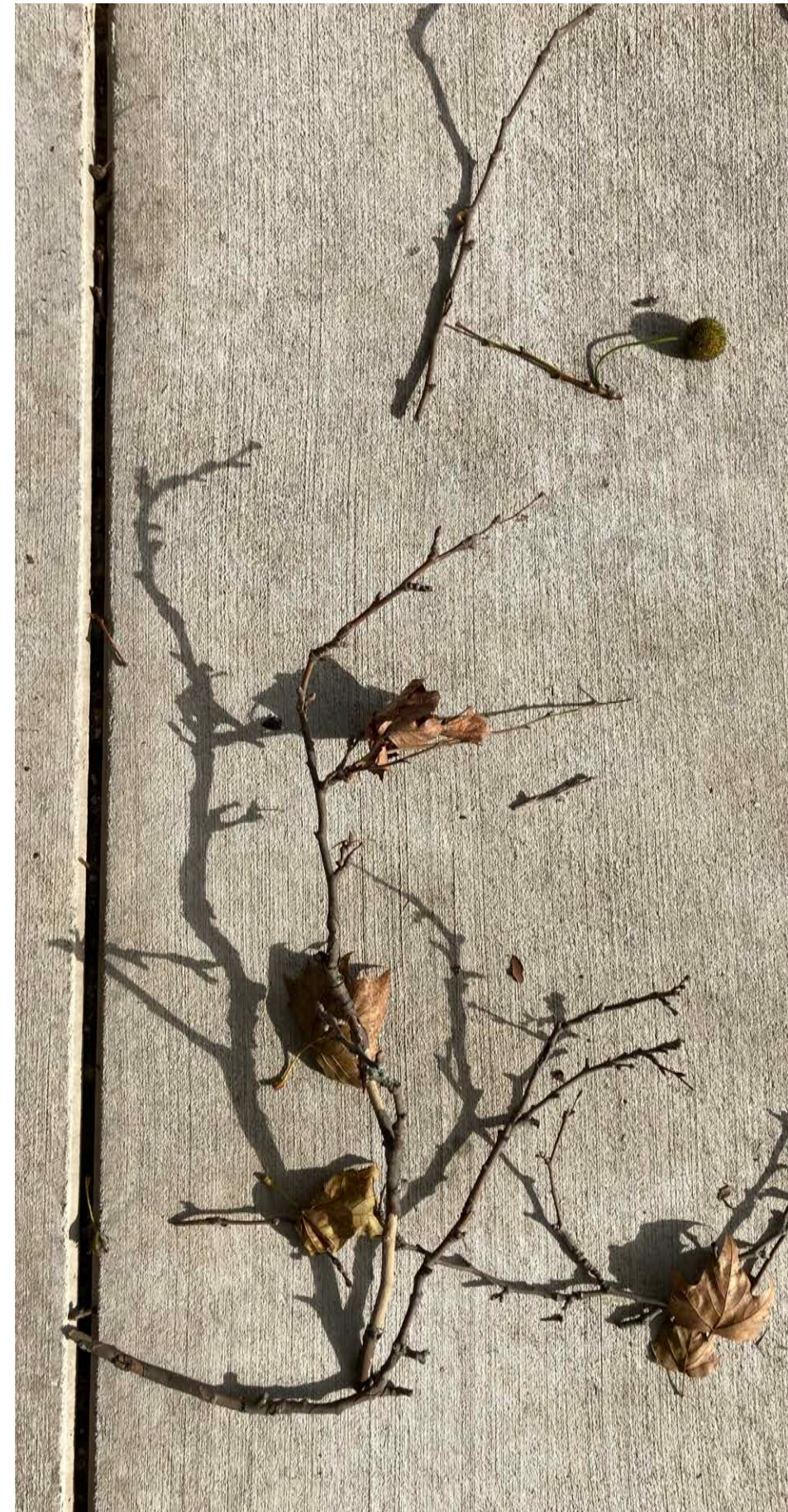
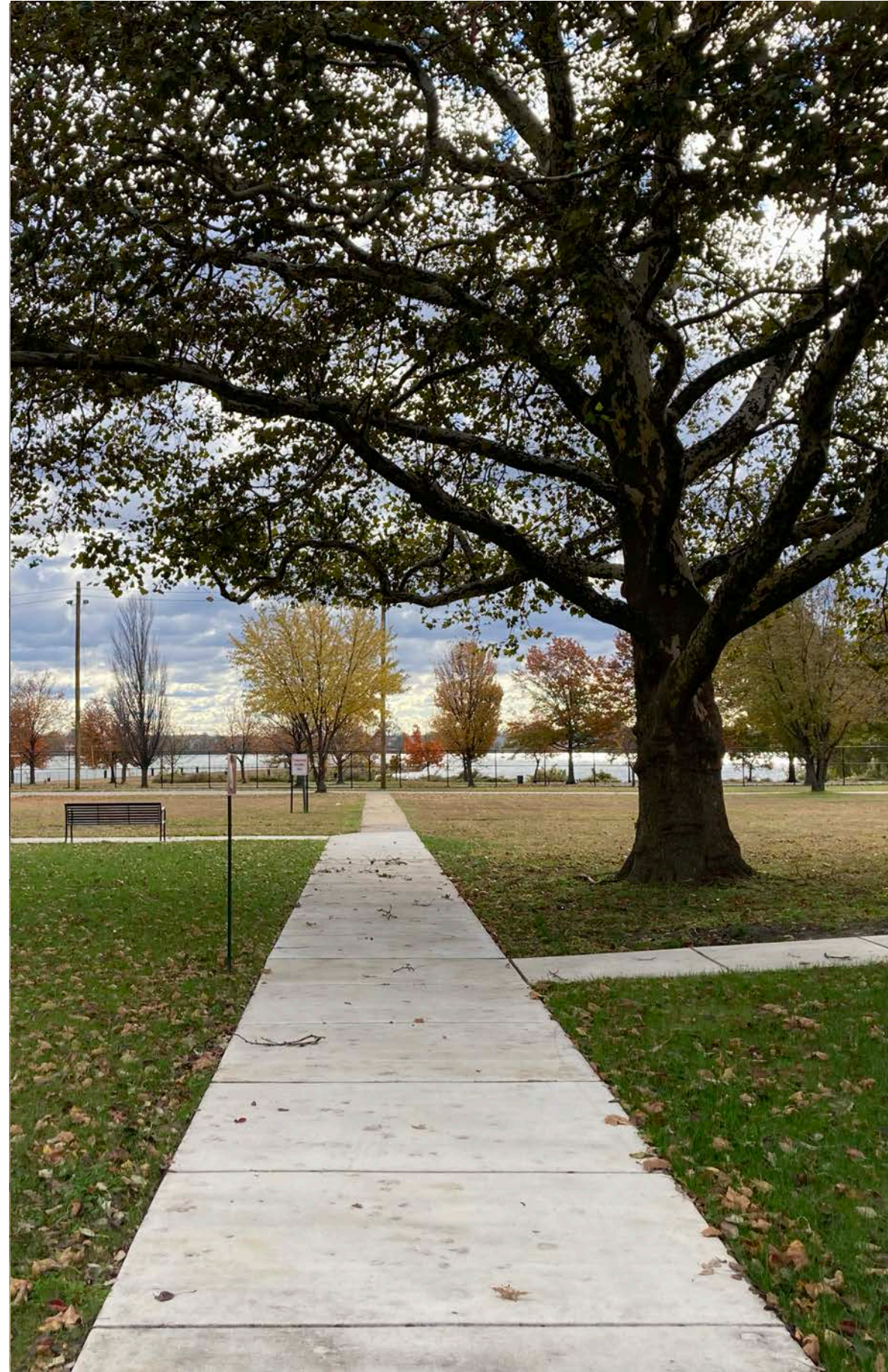

Mid-century architecture: natural forms framed by clear, open lines

Existing metals: aluminum, copper, forged steel

Philadelphia's forged metal tradition

Art Design and Concept

Recovery is marked by key moments, events people remember clearly, when something shifted and their path changed. This installation marks several points of choice and orientation along the walking path at Riverview.

First Site: Gateway

- Forged forms evoke nature, are open, grounded
- A physical turn at the intersection
- L-shaped benches within a sheltered space
- Hammered aluminum reflecting river light
- Community-hammered initials and symbols embedded in the surface
- A moment of emergence
- Space for conversation or solitude



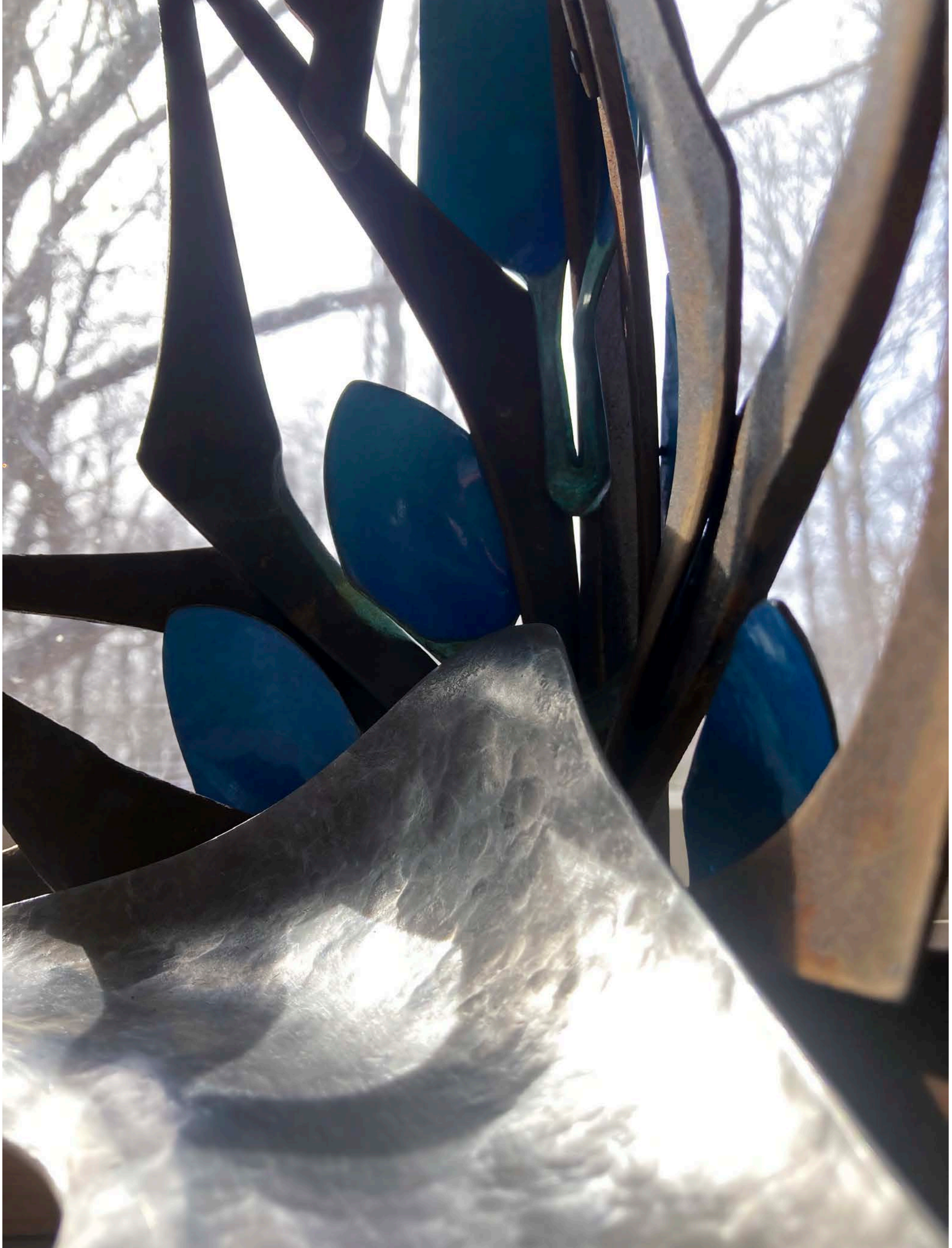

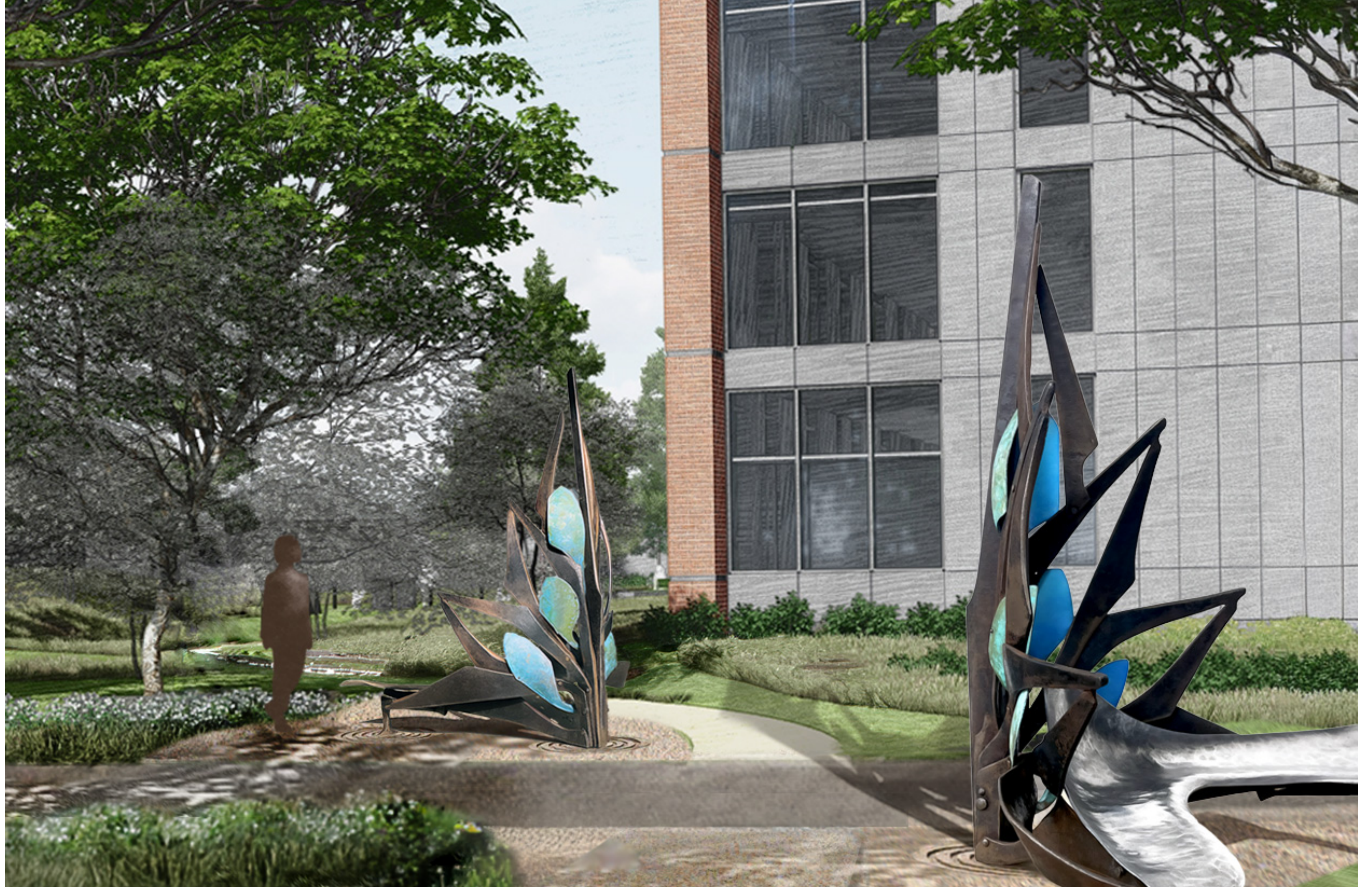

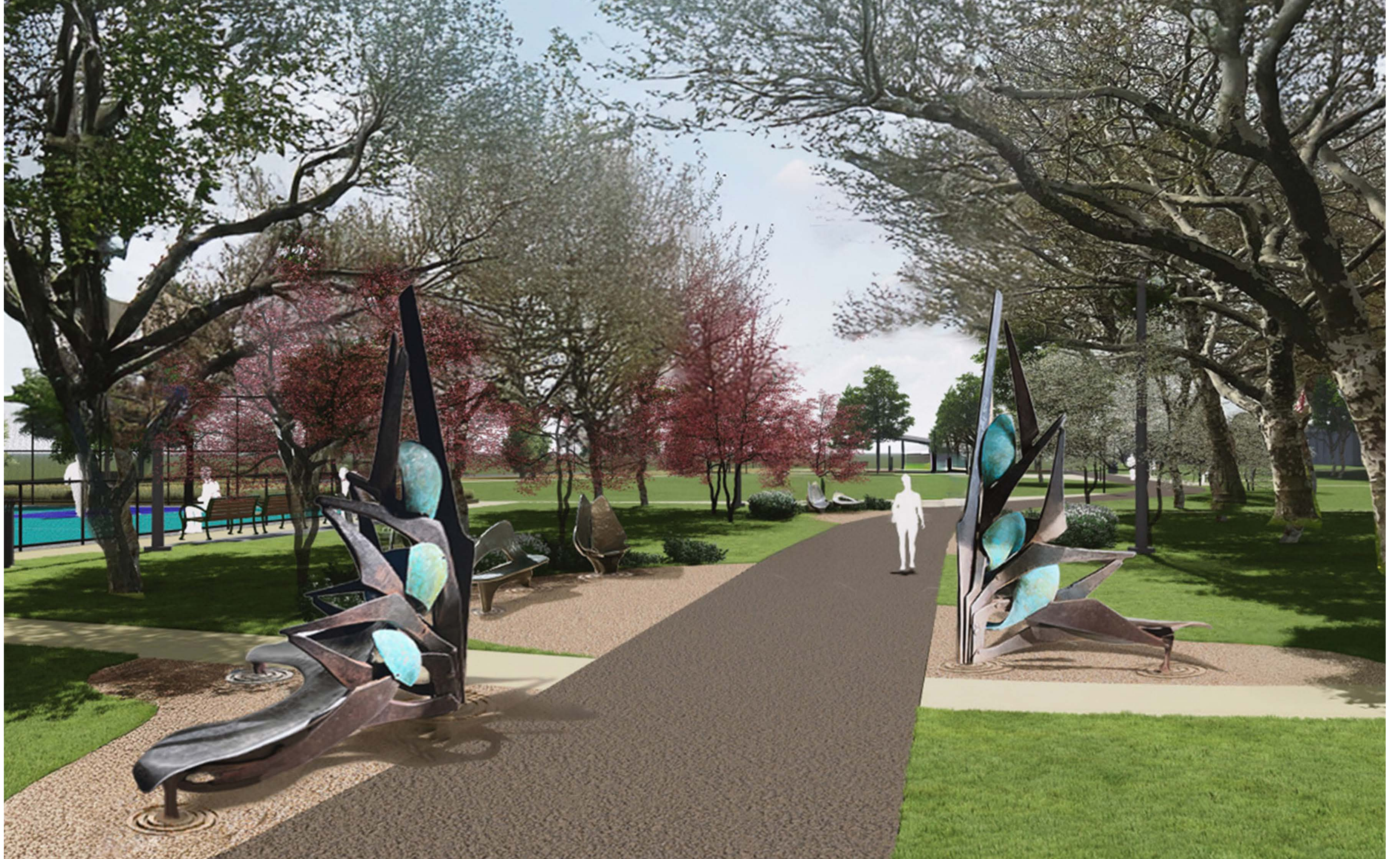

Aerial View

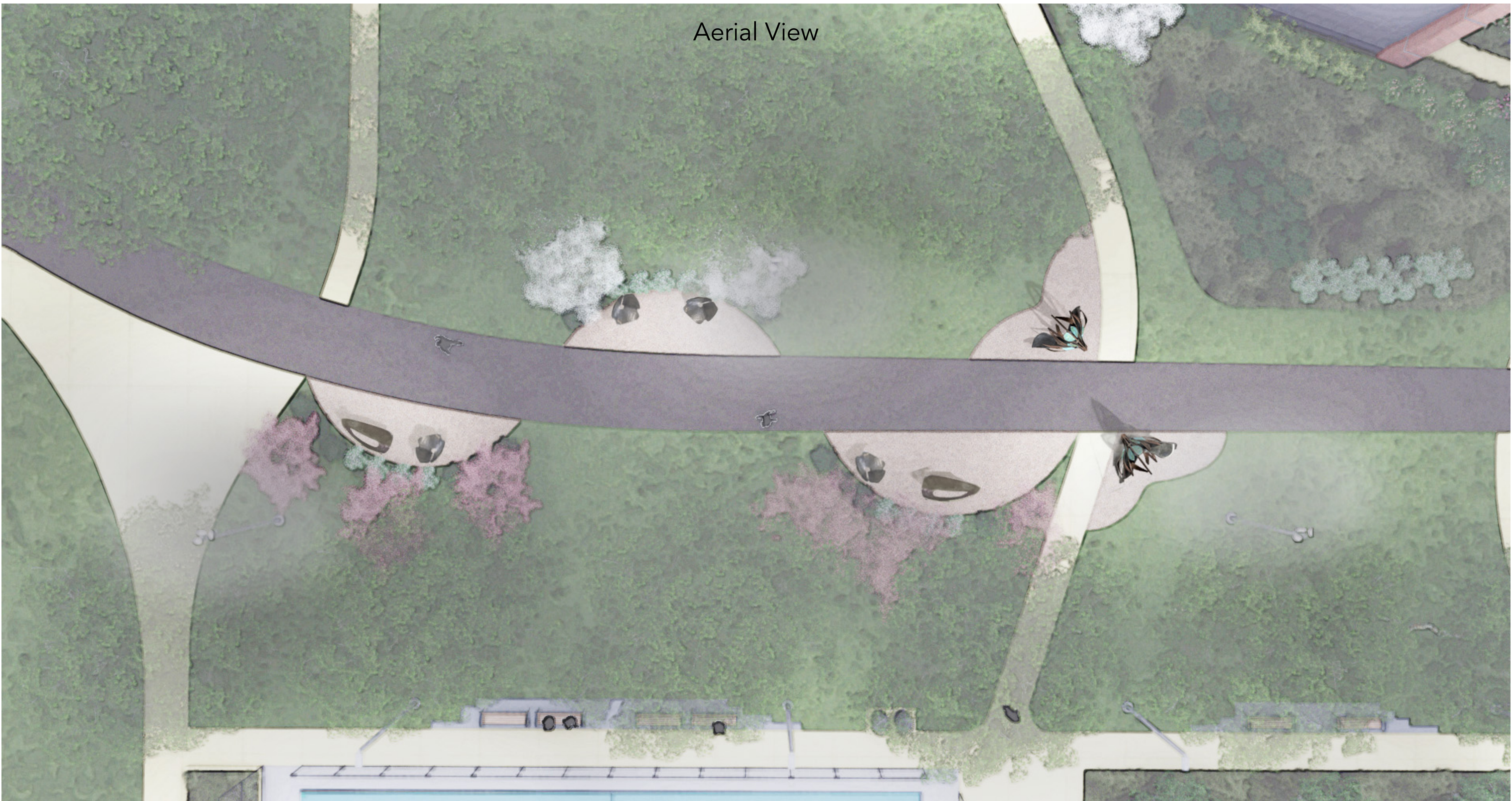



Hammered aluminum seating
Variety of orientation and choice
Generous scale for comfort
Concentric granite rings, ADA accessible spaces





Sculptural chairs and benches shaped like curled, protective leaves.

Heat Mitigation:

- Aluminum does not collect heat like steel, concrete or stone
- Hollow construction reduces transfer of solar heat
- Oversized chairs create a welcoming, interactive space
- Siting choices prioritize shade



Sizes

- Gateways: 10 feet high (max) with benches: 6-8 feet long
- Chairs approx 65" high
- Benches approx 44" x 72"

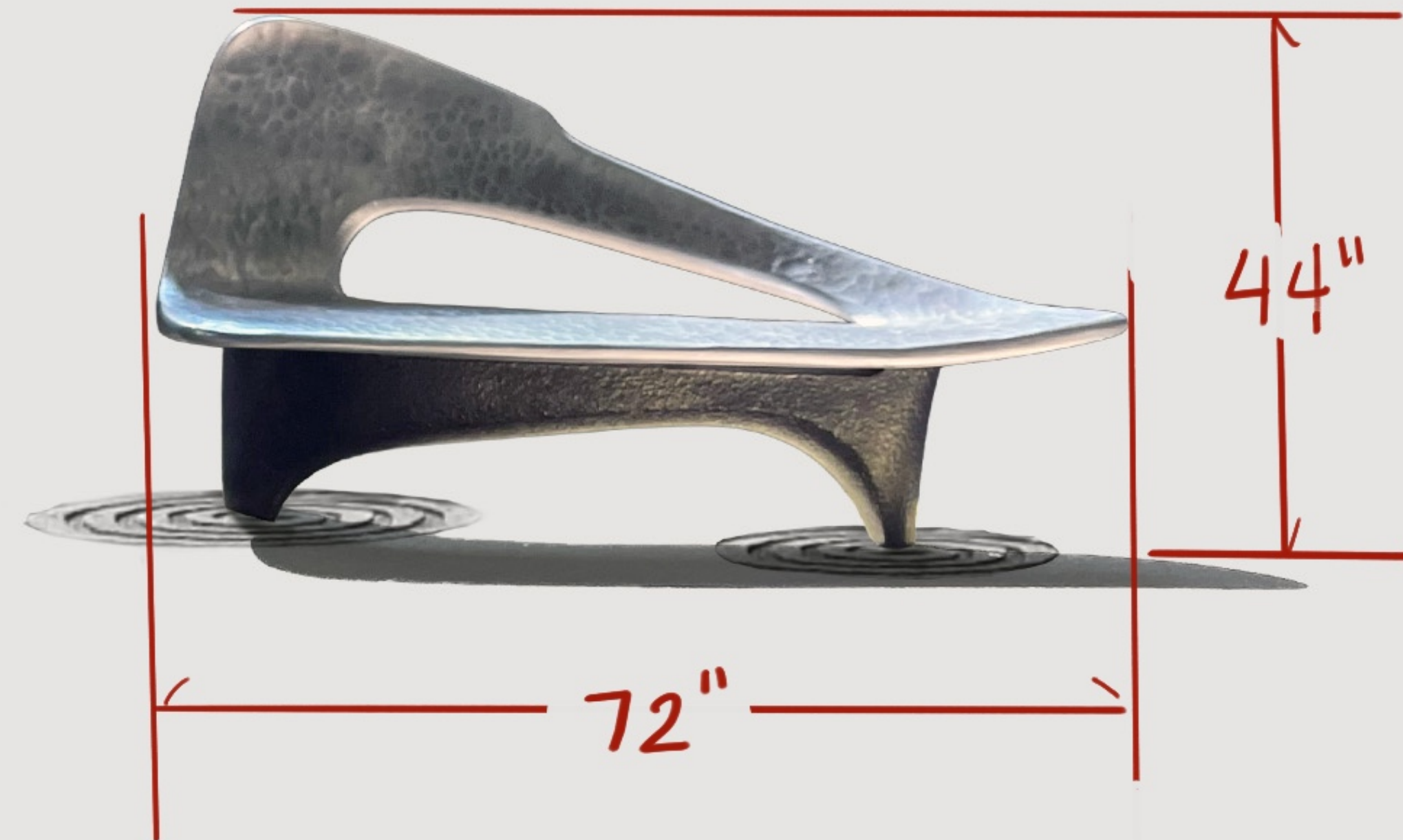
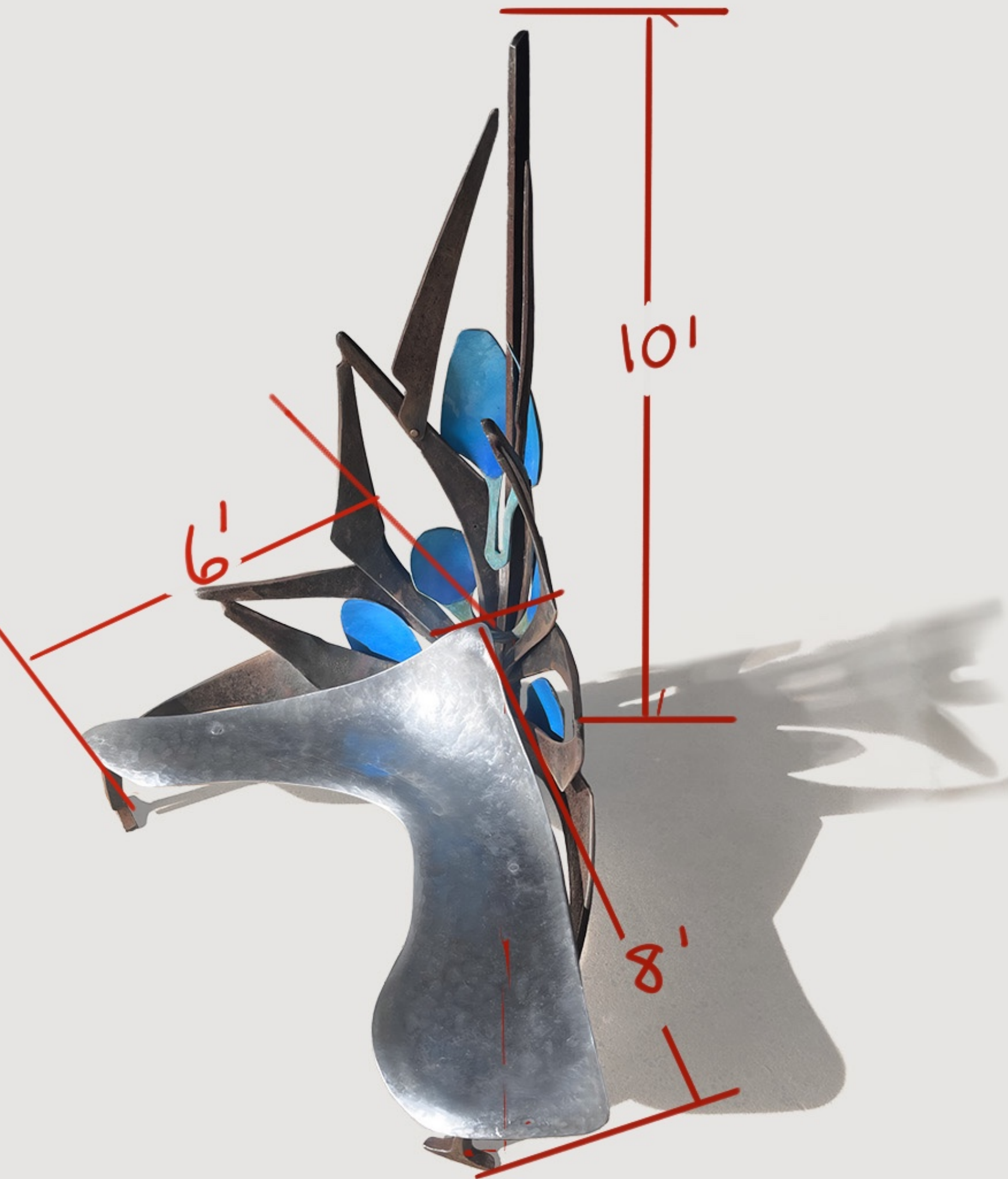

Site Lighting Plan

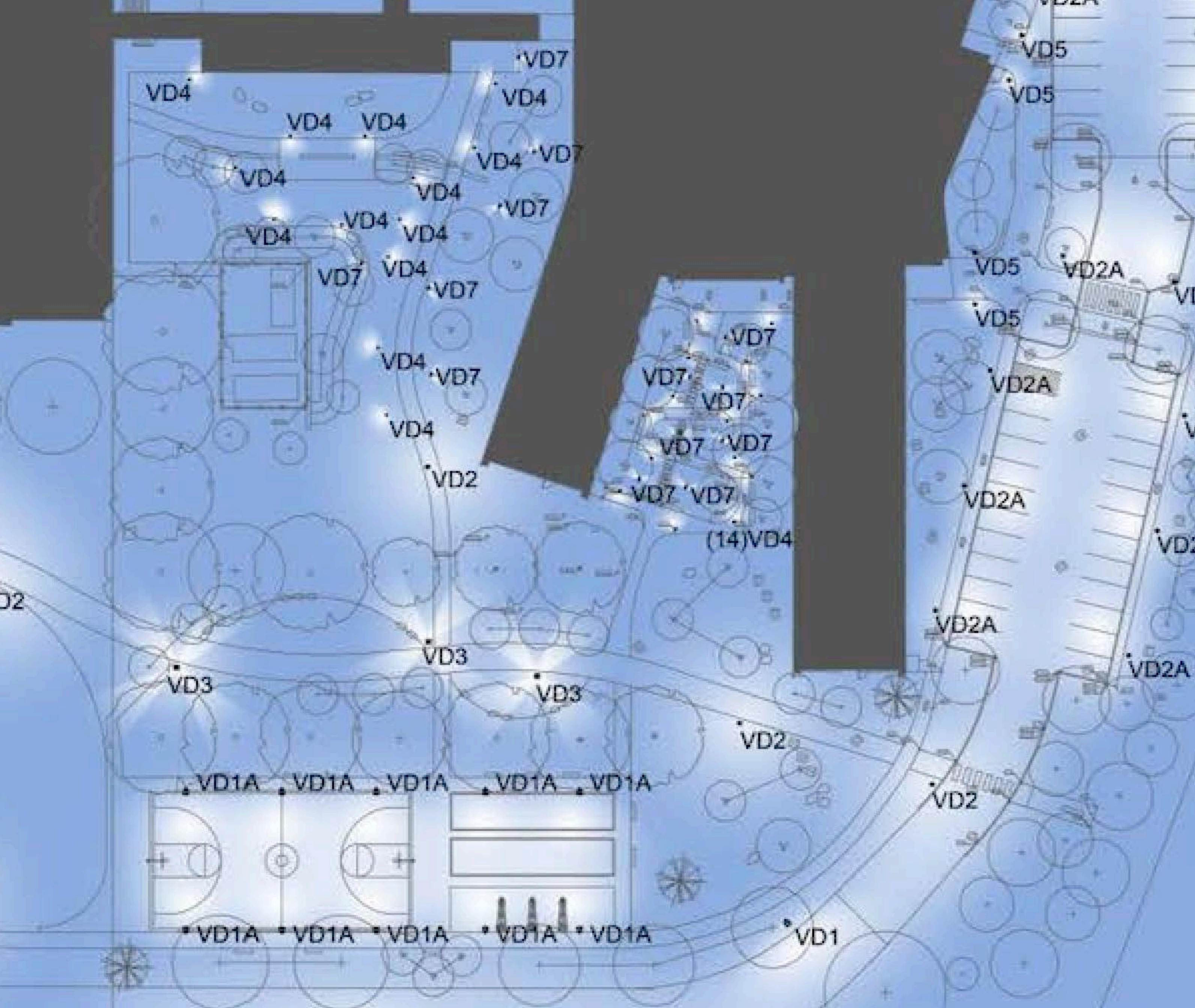

Night Lighting

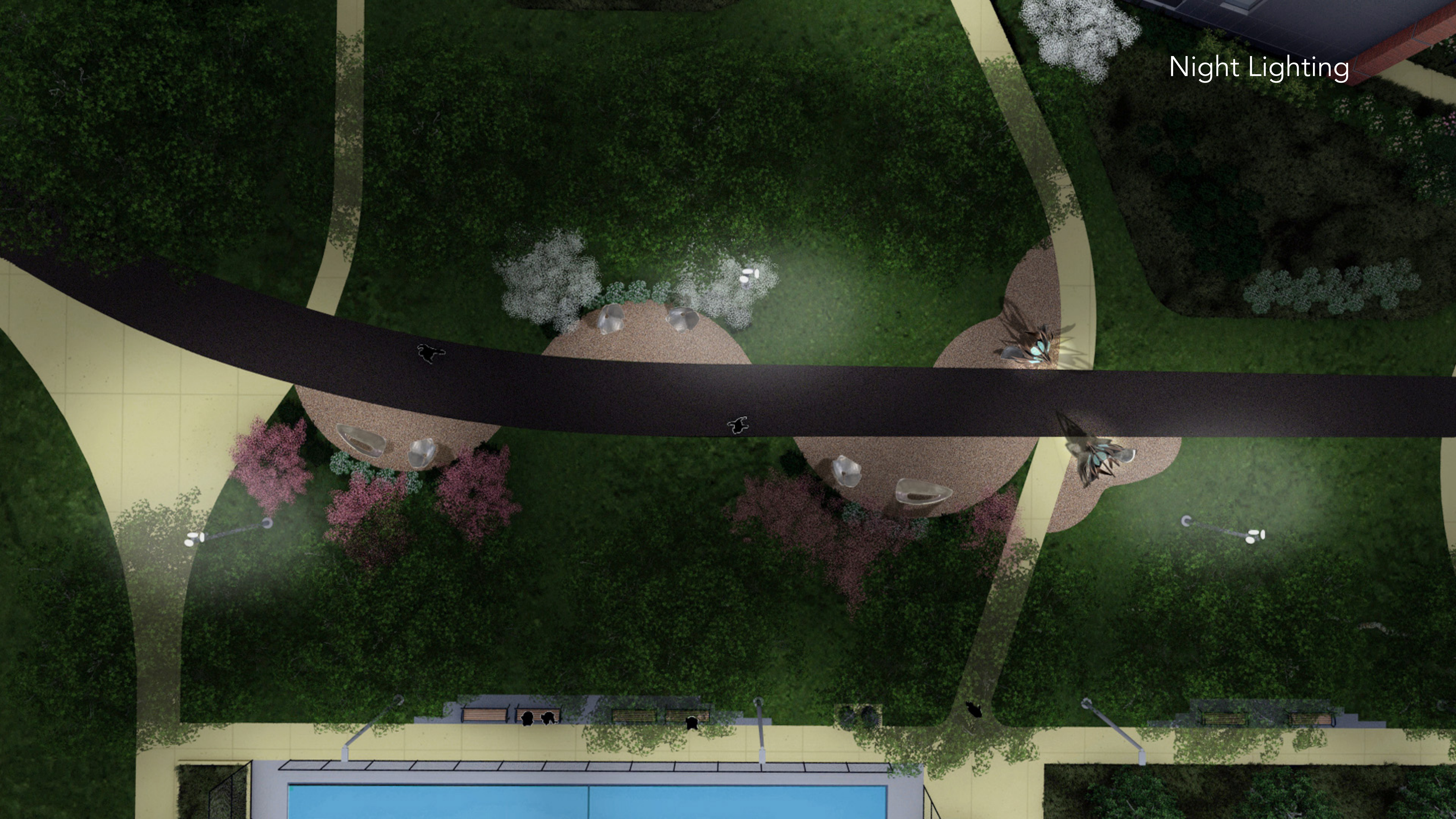

Lattice structure with internal uplight creates distinctive patterns at night

Lantern-like presence enhances safety and atmosphere

Soft, simple, humane illumination without glare





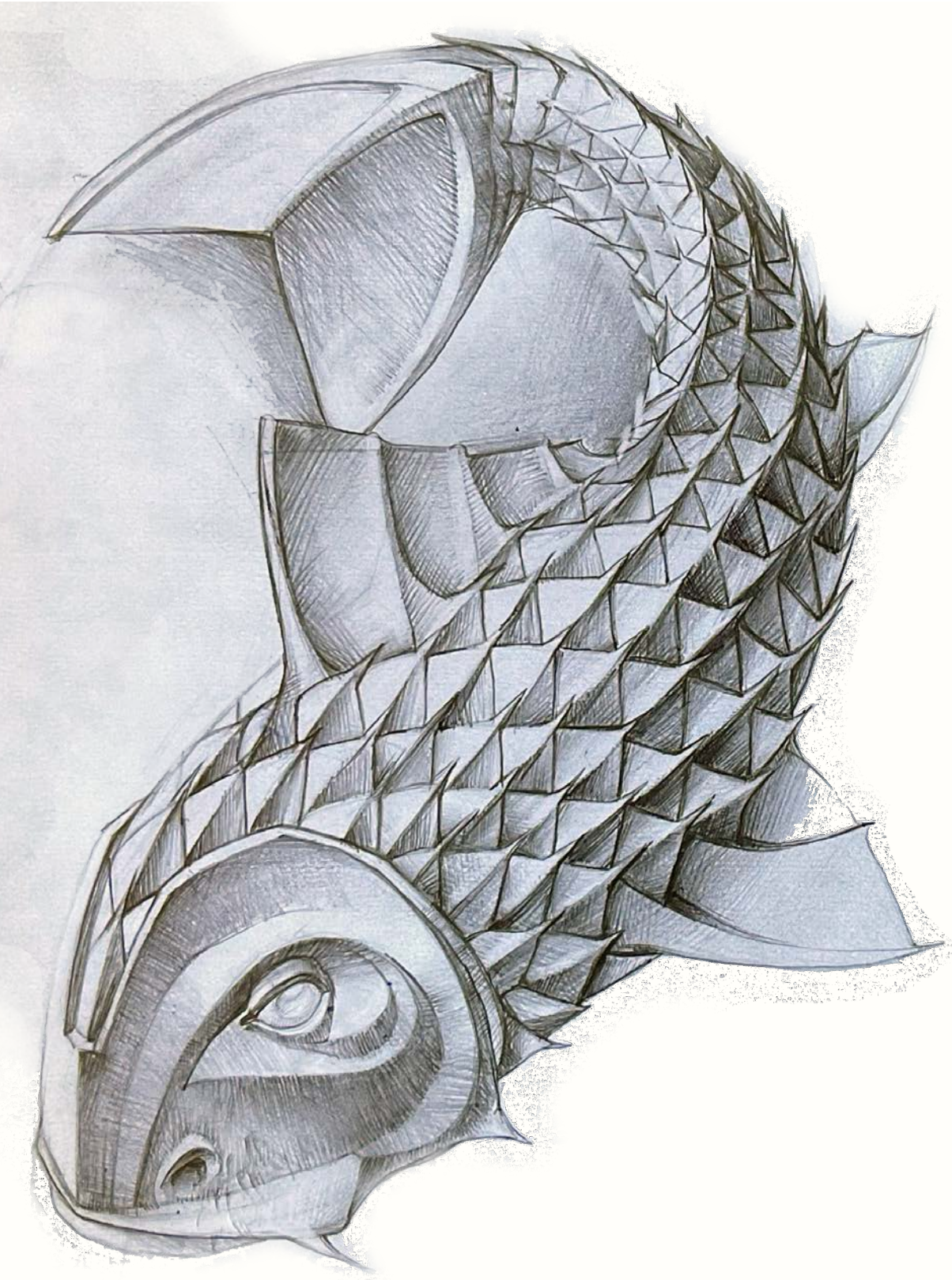

Come join
DRAWING
CLASS

with
Margot and T

Friday 10 am
in the upstairs lounge

All are welcome!

Community Engagement Built Into Every Phase

BEFORE:

- Multiple visits on-site: listening, in-person presentations, and siting
- Month-long online targeted community survey with feedback integrated into design

DURING:

- Drawing Sessions
 - Two one-month sessions
 - All materials provided; all skill levels welcome
 - Keep connection across time, build toward hammering event
- Hammering Events During Fabrication
 - Residents and staff add initials or small symbols
 - Assisted participation so everyone can take part
 - Marks become part of the finished surface
- An additional site visit to share updates and posters and an integrated creative project to connect Riverview with local artists

AFTER:

- Ongoing Life of the Work
 - New marks welcomed over time
 - A tactile, shared record: ownership that continues to grow



Materials, Fabrication & Installation

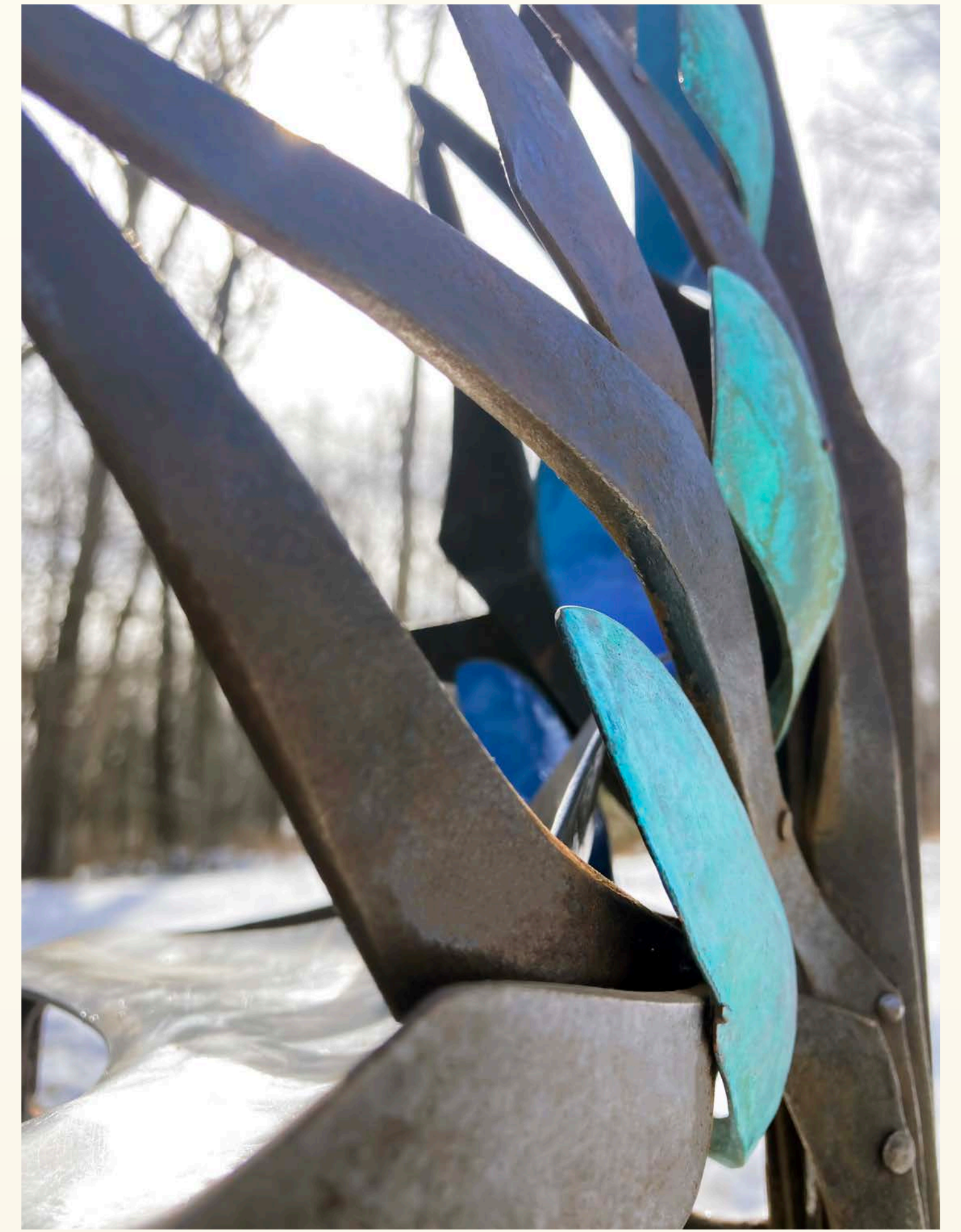

Materials

Hammered hollow-form aluminum seating elements (lightweight, durable, tactile, and low thermal mass)

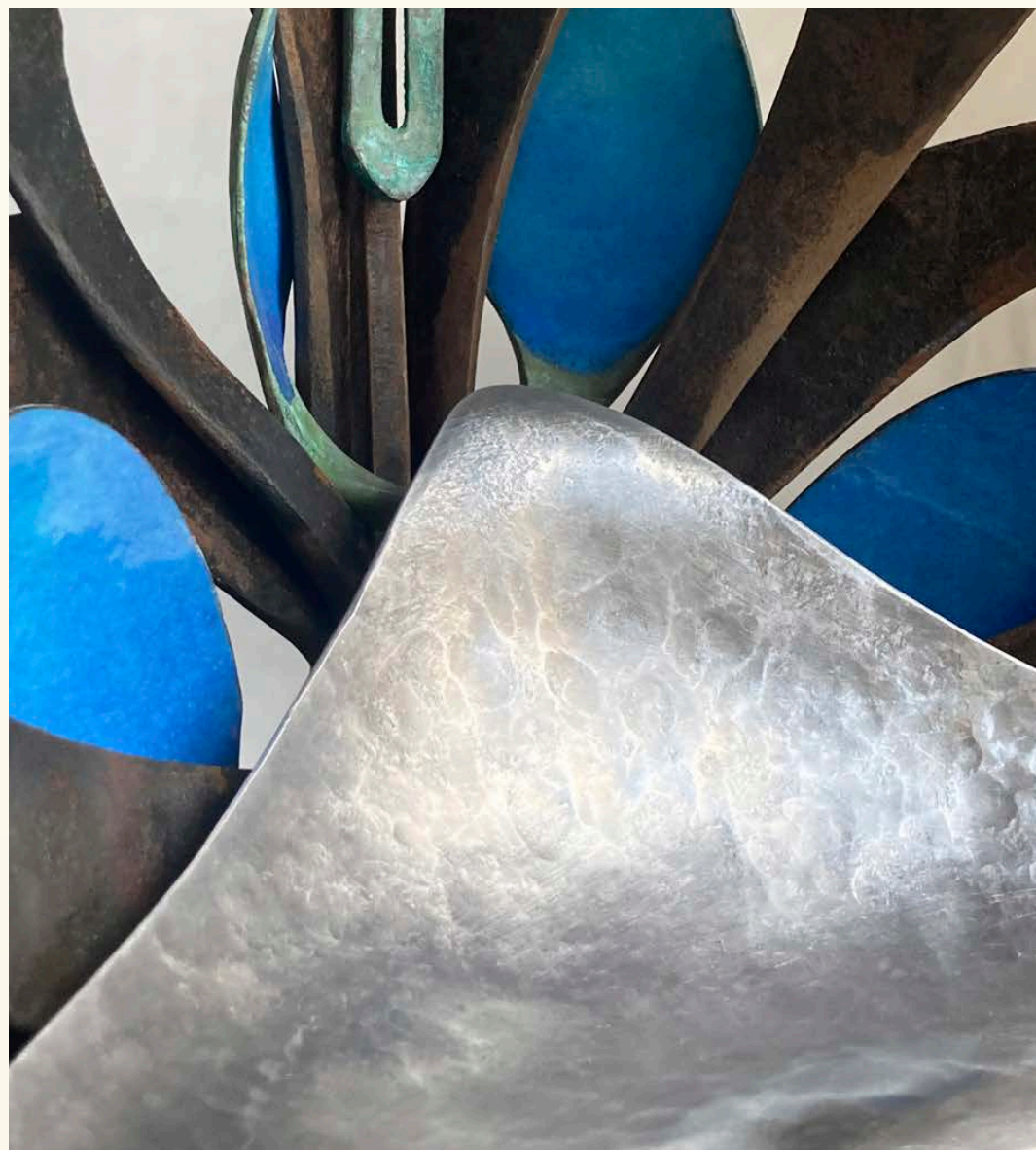

Forged and fabricated Cor-ten steel self-healing corrosion-resistant surface develops over time

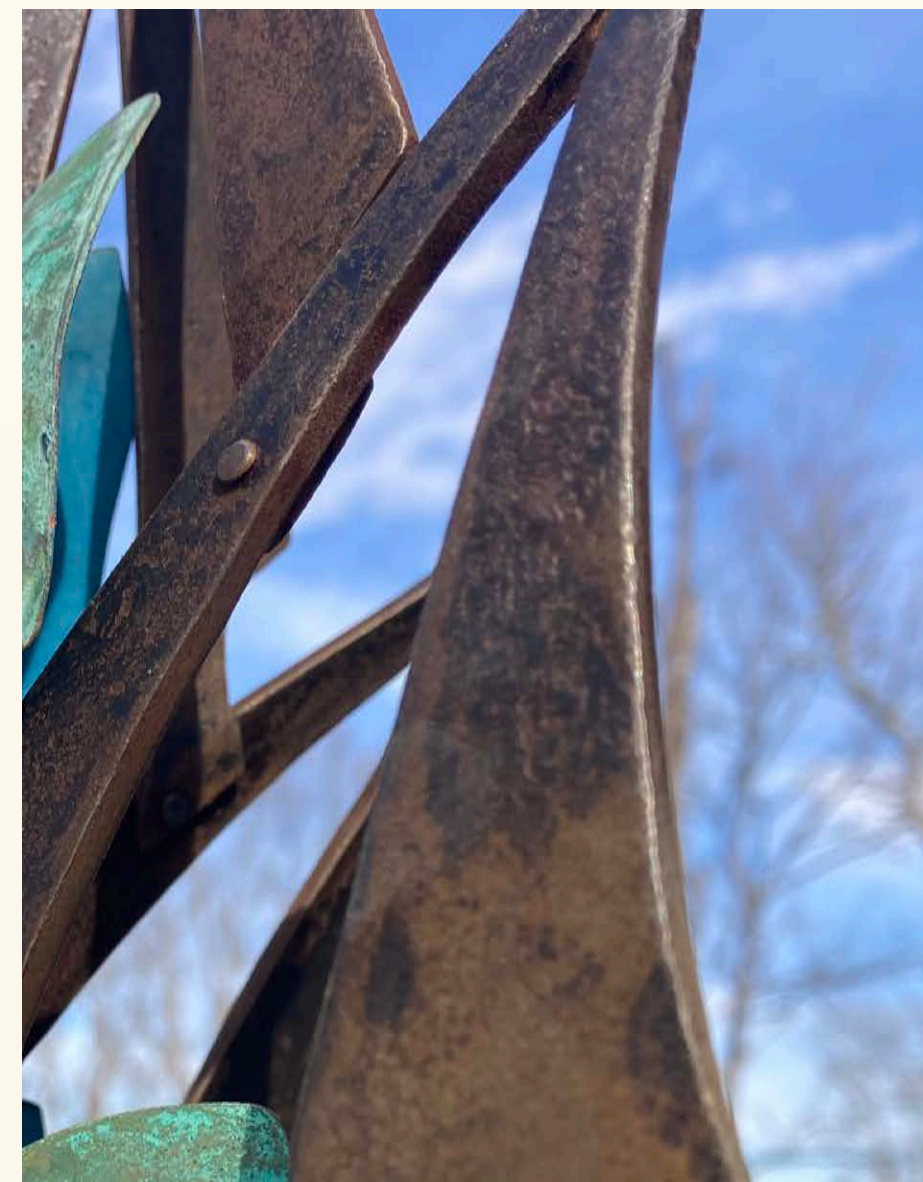

Forged copper accents Natural green patina, sealed for stability - these will continue to evolve and age over time



Enamel color details in shifting blue to blue-green tones (ceramic-like coating heat-fused to the metal: inert, corrosion resistant and UV stable)

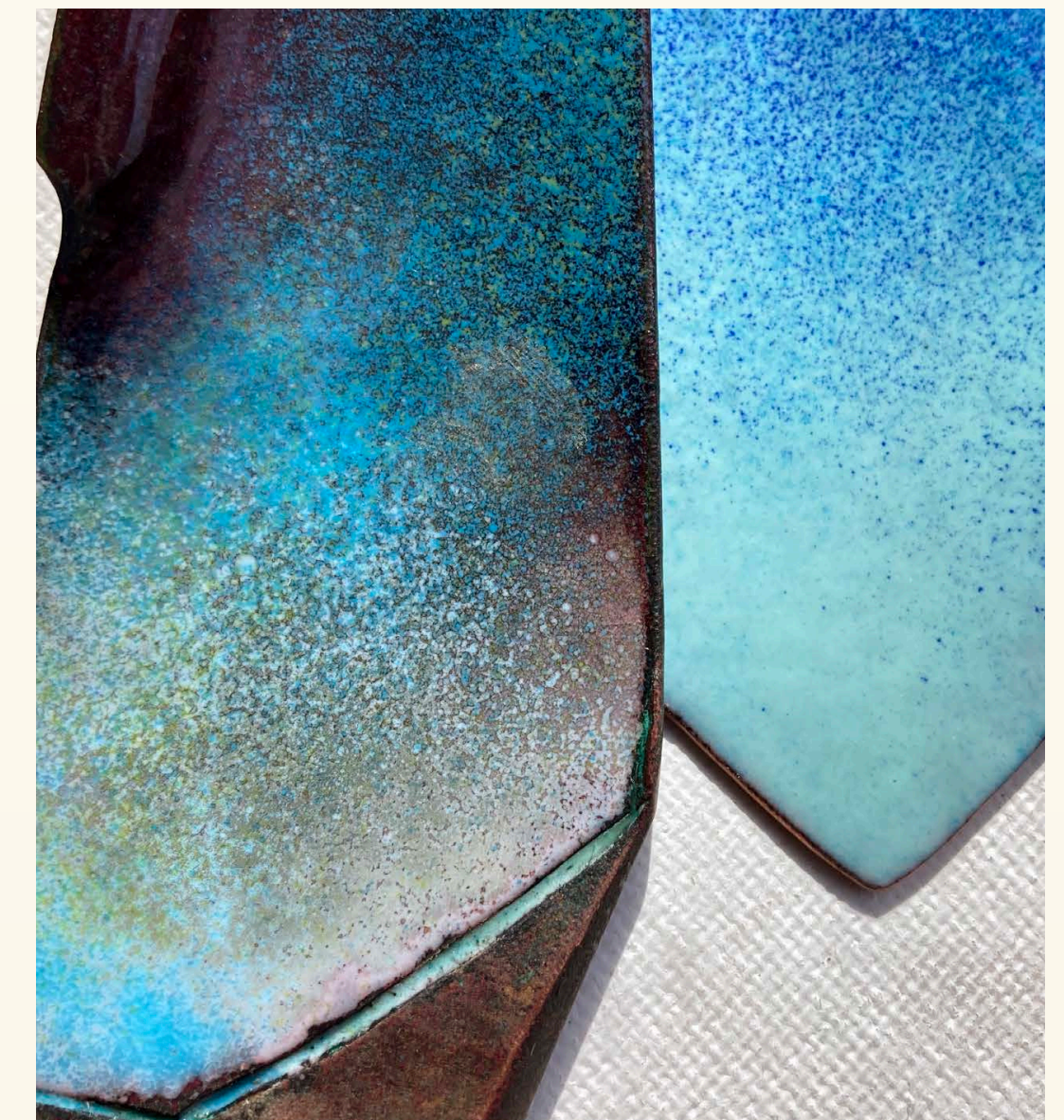

Durability & Conservation

Materials are selected for long-term outdoor performance and minimal maintenance in a non-marine urban environment.

Durability and Corrosion Resistance

- Cor-ten steel is corrosion resistant
- Sealed copper with UV-stable vitreous enamel color
- Corrosion-resistant aluminum seats
- Permeable gravel ring reduces standing water
- Drainage holes will prevent pooling on or within structures
- Granite base material is highly durable against moisture, scuffing and salt
- Galvanic relationships between metals are addressed through surface area hierarchy, selective isolation at contact points

Vandalism, Surface Wear, & Maintenance

- Washable, durable surfaces
- Natural oxidation and surface aging are desirable
- Hand-forged textures visually absorb minor marks and wear
- Most likely vandalism: minor surface marking on aluminum seating; this is part of the “life” of the piece and will not compromise the aesthetic experience
(offensive vandalism can be washed or sanded/hammered out)
- Expected lifespan with minimal maintenance: 50+ years
- Annual inspection recommended
- Cleaning with mild detergent and water as desired

Fabrication & Installation Summary

Fabrication will be done by the artists in their studio, with specialized subcontracting for site preparation, granite stonework, concrete footers/landscaping, and electrical/lighting.

Installation will occur in phases:

Foundations installed first

- Round concrete footers variable sizes for each sculpture

- Granite rings level to ground over footers and gravel base

Delivery and assembly on site

- Sculptures anchored into footers through pre-drilled holes in central granite stone bases

Site finishing

- Gateway sculptures lighting installation

- Resin-bound aggregate pour

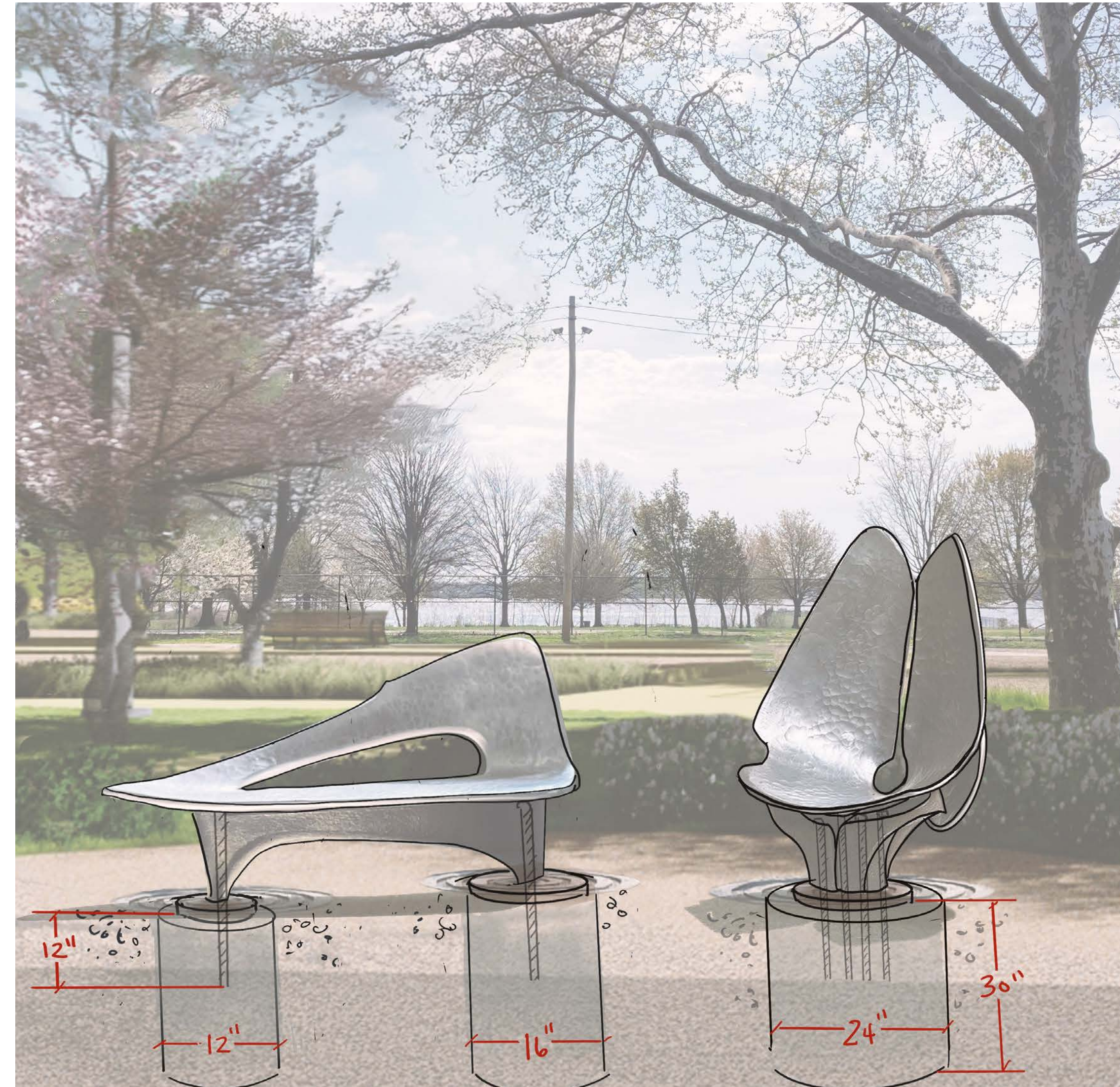

BENCH DETAILS:

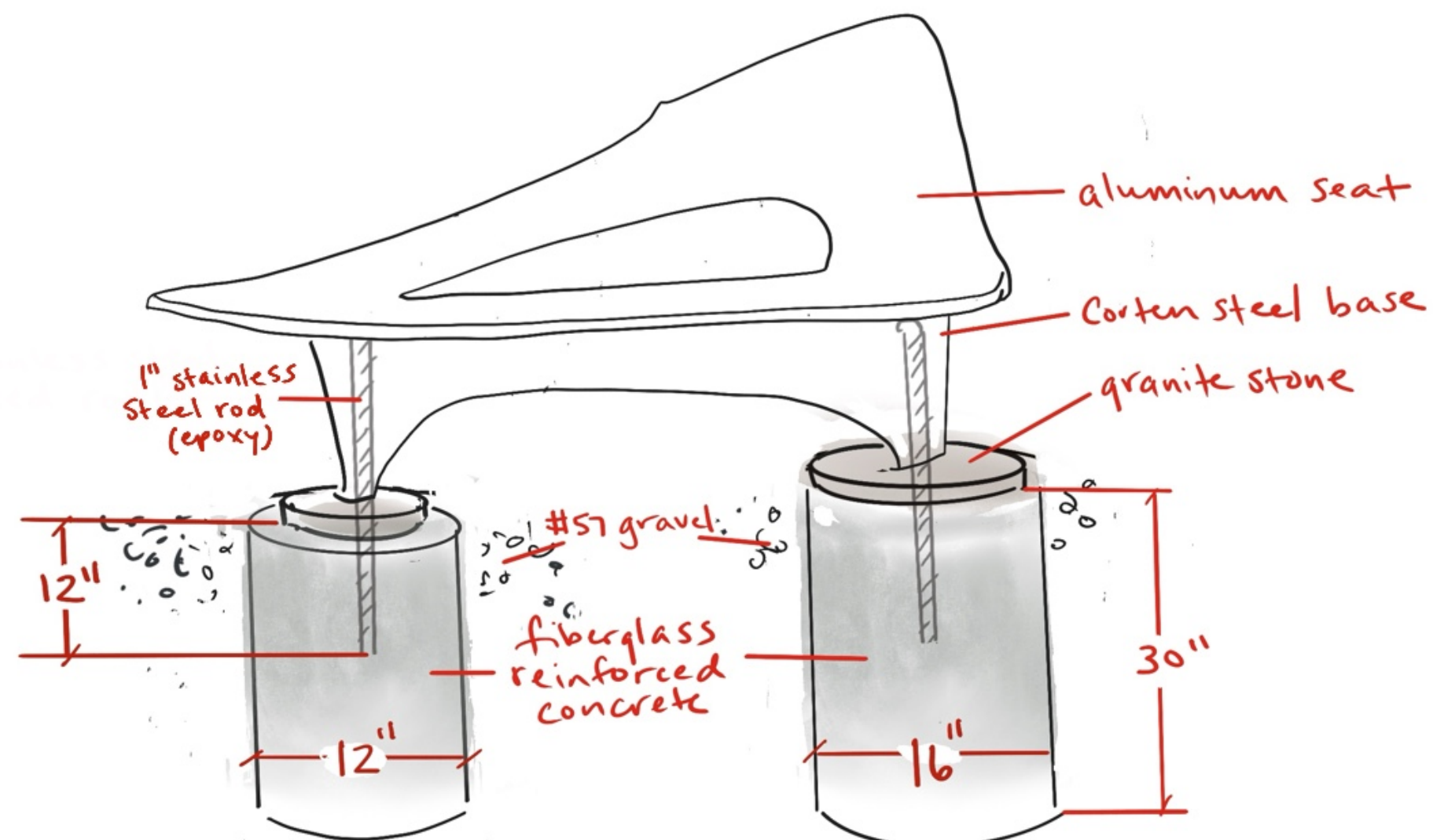
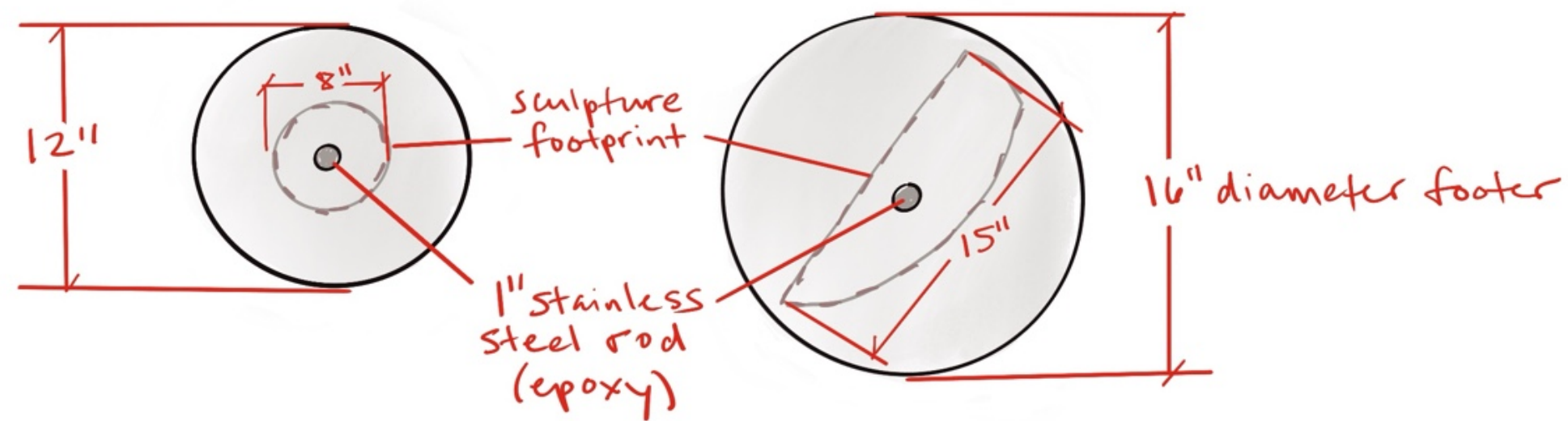

EACH BENCH \approx 250 lbs
 \approx 44" high x 72" long

CHAIR DETAILS: EACH CHAIR \approx 250 lbs \approx 65" high

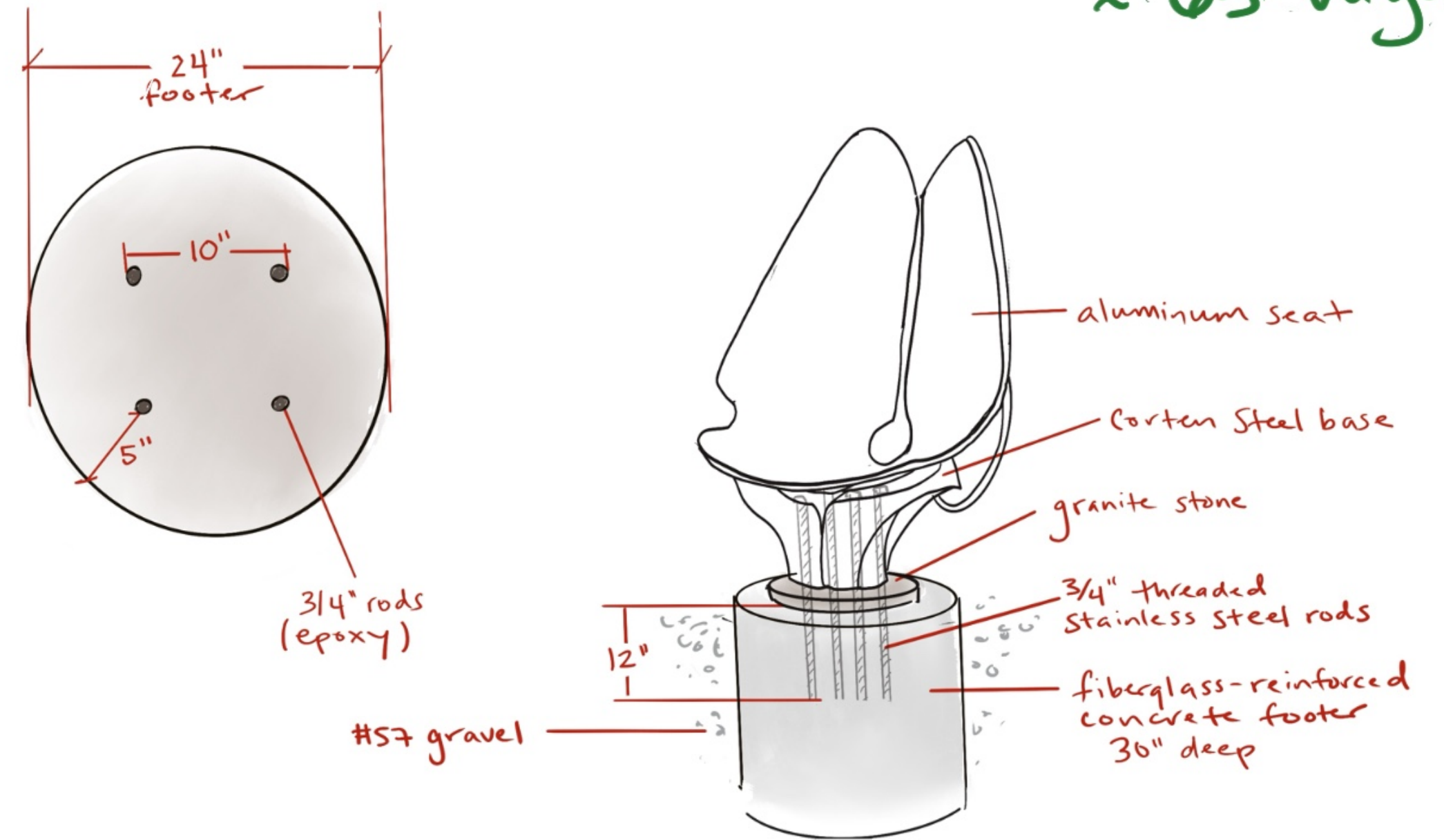

GRANITE DETAILS: HOLES FOR THREADED RODS

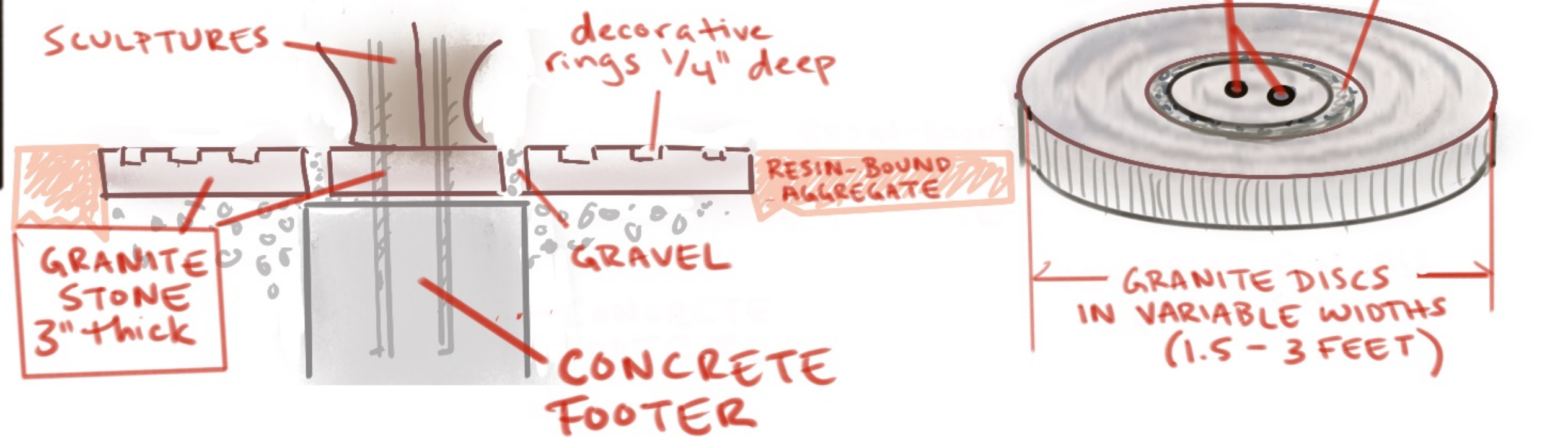

GRANITE VARIABLE WEIGHTS 30-250 lbs.

2 "GATEWAY" SCULPTURES

10' HIGH

HIDDEN BOLT:

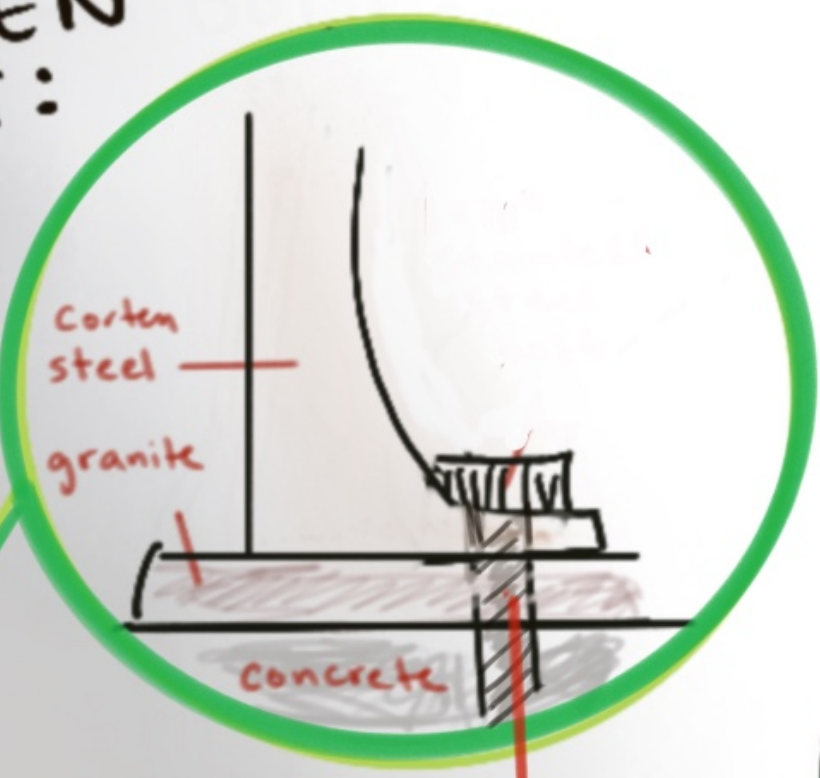

EACH GATEWAY HAS 3 FOOTERS: one 24" and two 12" diameter (30" deep)

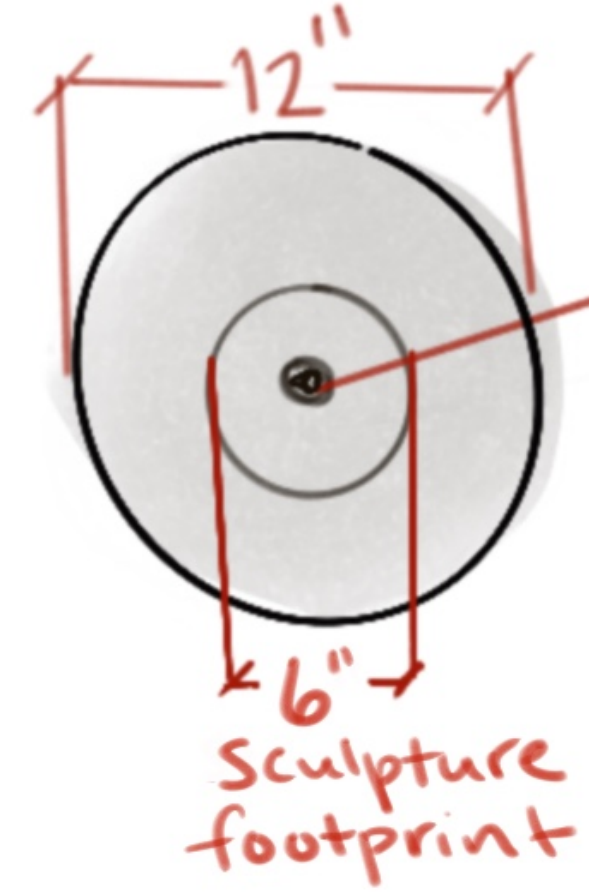
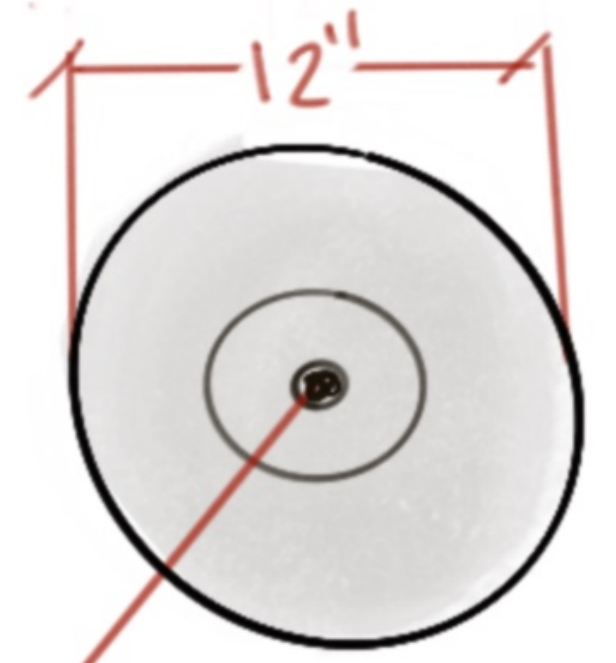
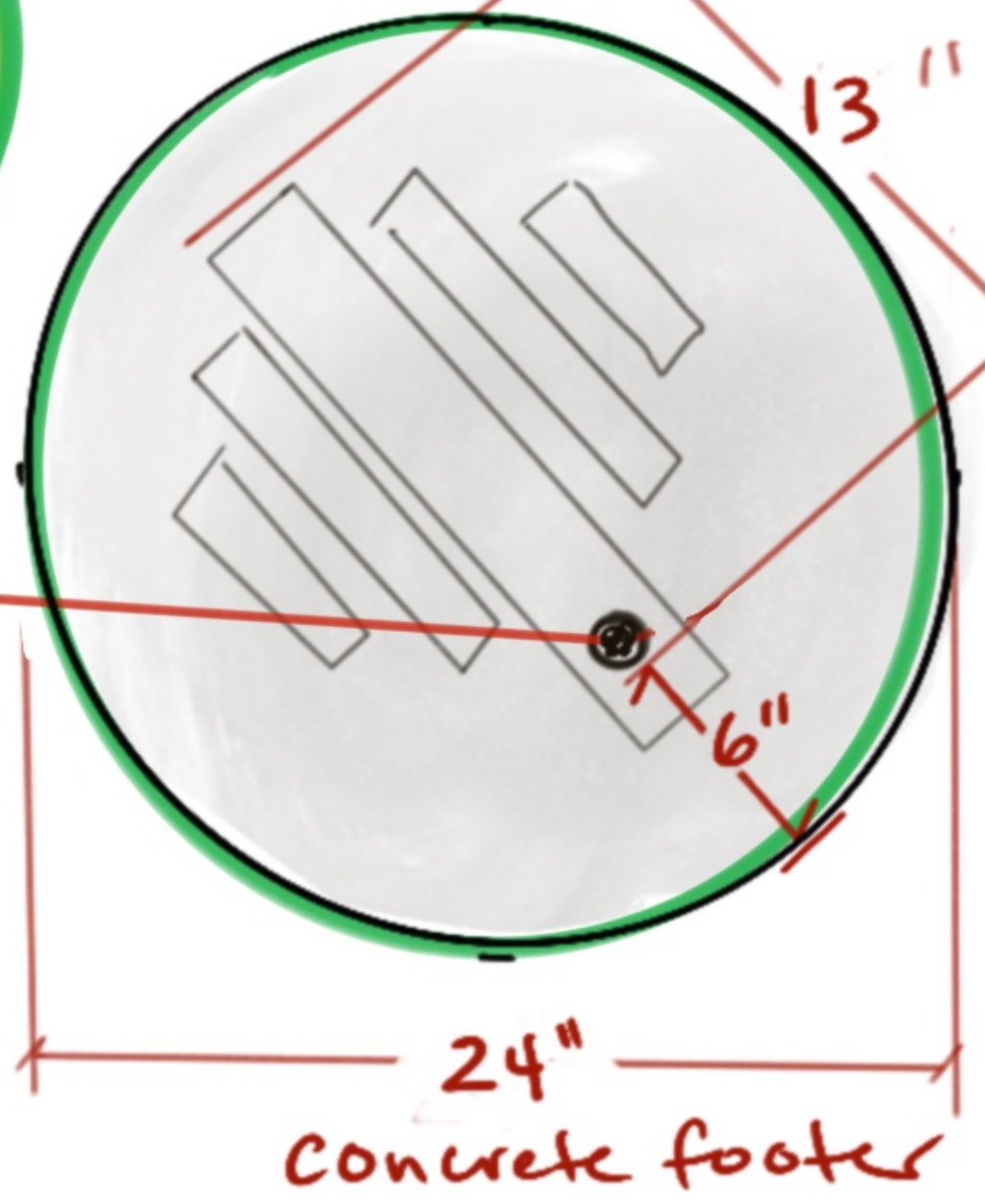

ENAMELED COPPER

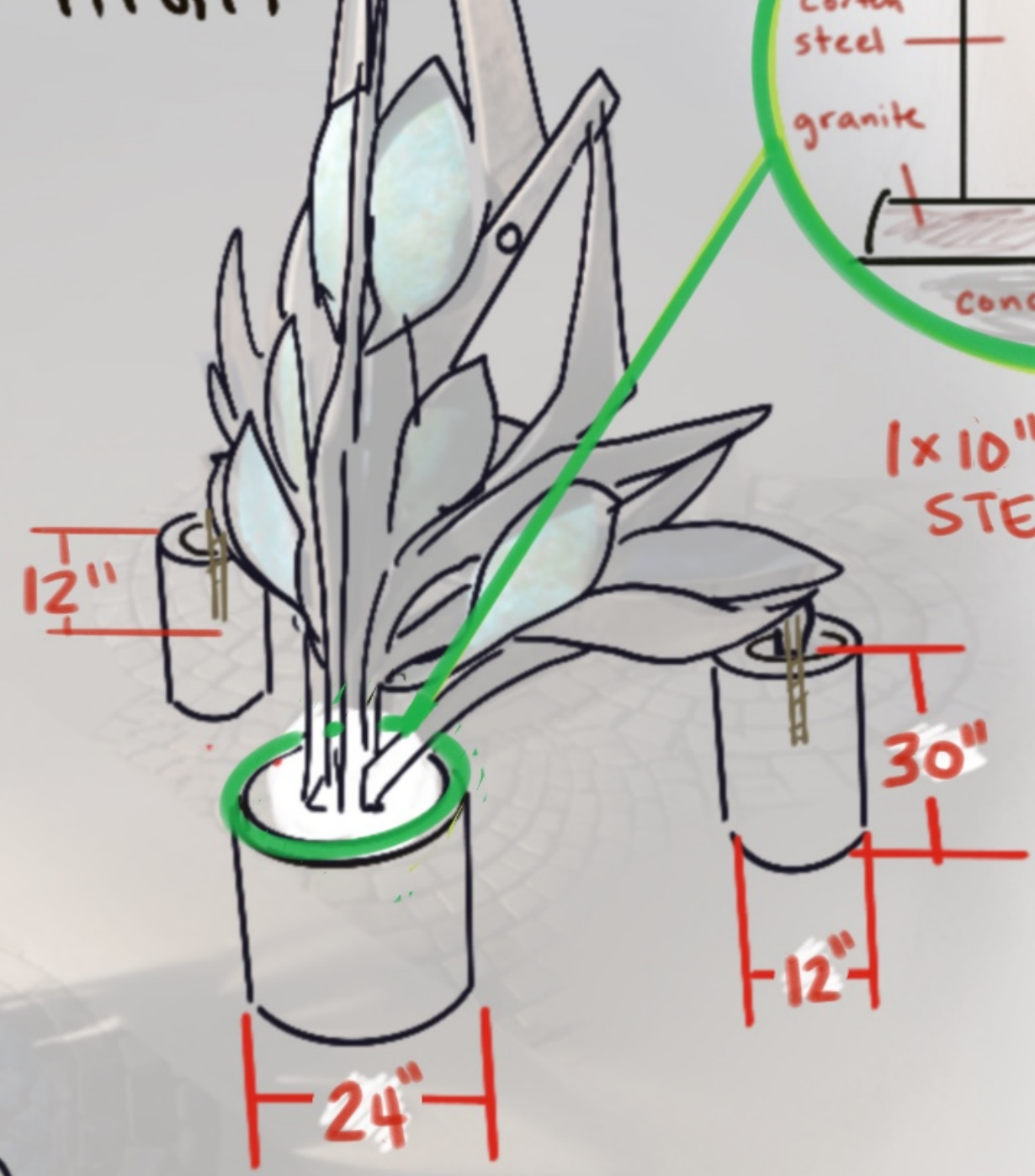
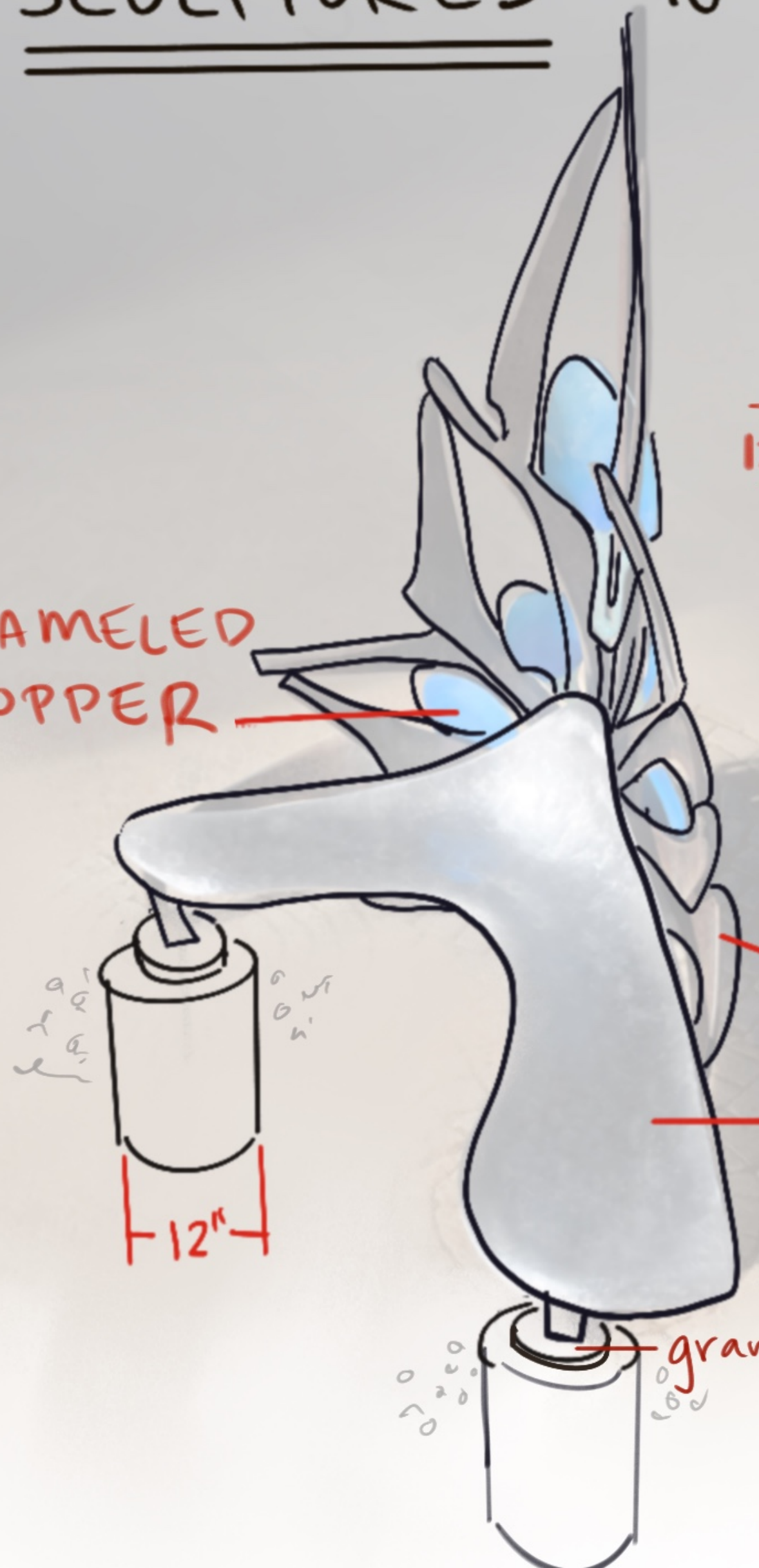

1x10" STAINLESS STEEL BOLT (EPOXY)

CORTEN STEEL BASE

ALUMINUM SEAT (1/4" hollow-form)

granite stone

EACH GATEWAY ≈ 1800 lbs

Projected Schedule

Phase 1: Design & Approvals

(March – October 2026)

- Design Development & Research:
2 months
- Technical Drawings & Engineering:
2 months (overlapping)
- Philadelphia Art Commission Review:
May 2026
- Contract Execution: June – Oct 2026

Phase 2: Fabrication

(November 2026 – Summer 2028)

- Fabrication begins November 2026
- Total fabrication duration: approximately
14–18 months
- Sculptural elements delivered and
installed in phases
- **Community Engagement** integrated
throughout fabrication:
 - Drawing Classes (8 sessions spaced
across fabrication)
 - Two Community Hammering events
(each lasts 1 day) incorporated into
aluminum bench fabrication
 - Integrated creative community
project and additional site visit /
update meeting before installation

Phase 3: Site Work & Installation*

(April 2027 – Fall 2028)

- Initial site prep and concrete
foundations poured: Summer 2027
- First installation: Fall 2027
- Second installation: Summer 2028
- Final landscaping and lighting: Fall 2028

* each installation takes about one day on site

Budget Total: \$525,000

<u>Fees and contracts:</u>	<u>\$180,000</u>	<u>Sculpture fabrication and install:</u>	<u>\$345,000</u>
• Artist Design and Project Fee (18%)	94,500	• Research costs	2,000
• Community engagement	20,750	(details of colors, finishes, landscape consultations)	
Drawing Classes (2 monthly sets + 1TBD) 10,900		• Materials	26,000
Art supplies (2,000 x 3) 6,000		Copper, 500 lbs - 8,000	
Artist Travel (250x12) 3,000		Cor-Ten Steel, 1/4" plate, 300 sq. Ft. - 5,000	
Snacks and drinks (150 x 12) 1,800		Aluminum, 1/4" plate, 350 sq. Ft - 9,000	
Class Invitation/ Posters Printing 100		Vitreous Enamels - 700	
Community hammering events (2) 9,500		Bearings/hardware/misc - 3,300	
Custom metal punches/stamps 5,000		• Fabrication/ Shop Costs	300,250
Aluminum transportation (1,500 x 2) 3,000		Hammering/fabricating aluminum benches 120,000	
Artist Travel (2 x 250) 500		Granite discs fabrication and delivery 38,000	
Event food and drink (500 x 2) 1,000		Forging/fabricating steel shapes 117,000	
Community art updates and descriptions 350		Forging copper shapes 18,500	
Posters/ printing 100		Enameling 6,000	
Artist Travel 250		Patinas and finishing 750	
• Engineering Costs	4,000	• Installation	16,750
• Insurance (1%)	5,250	Shipping /Sculpture Transportation (1,500 x 3) 4,500	
• Plaque fabrication and installation	3,000	Lift / Equipment Rental (750 x 3) 2,250	
• Contingency/Miscellaneous (10%)	52,500	Granite installation 10,000	

Note: Creative Philadelphia has a separate \$200,000 fund to cover costs of site prep, footers, and lighting installation

Artist Experience

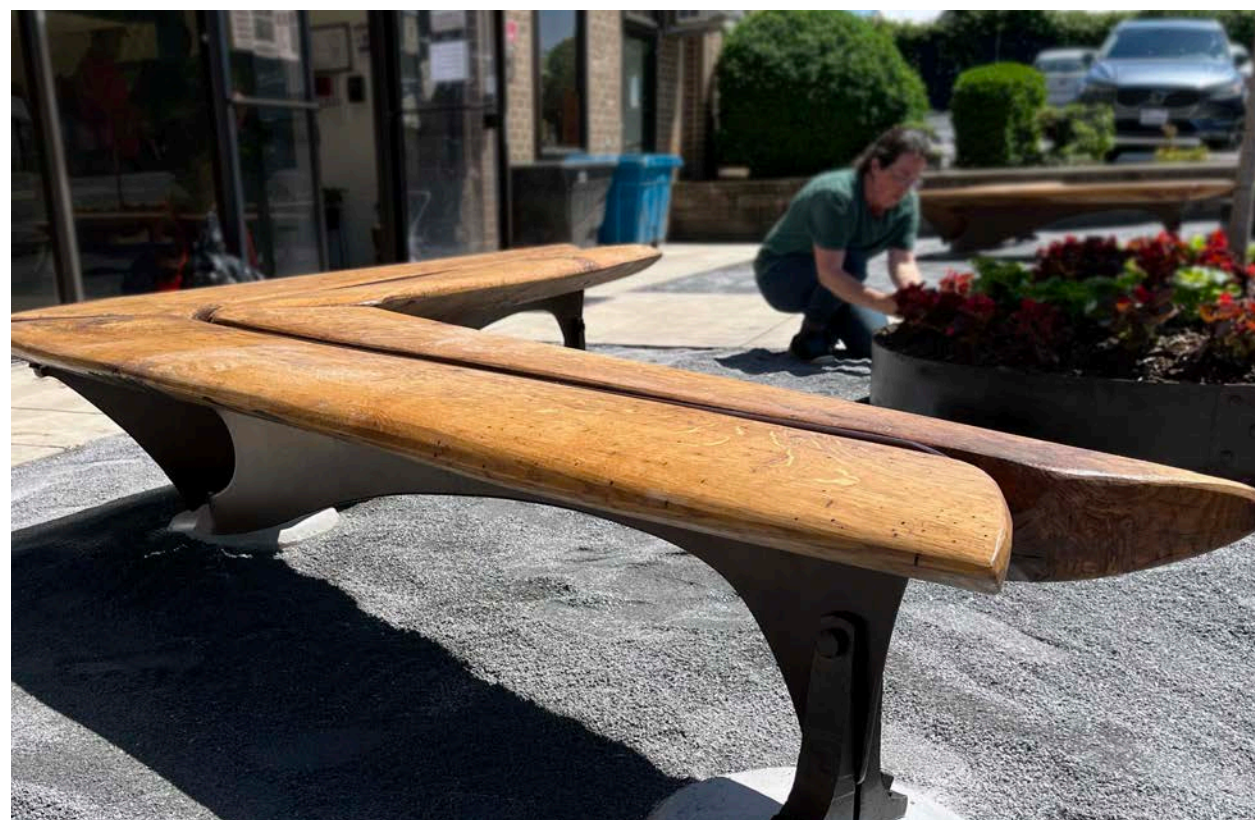
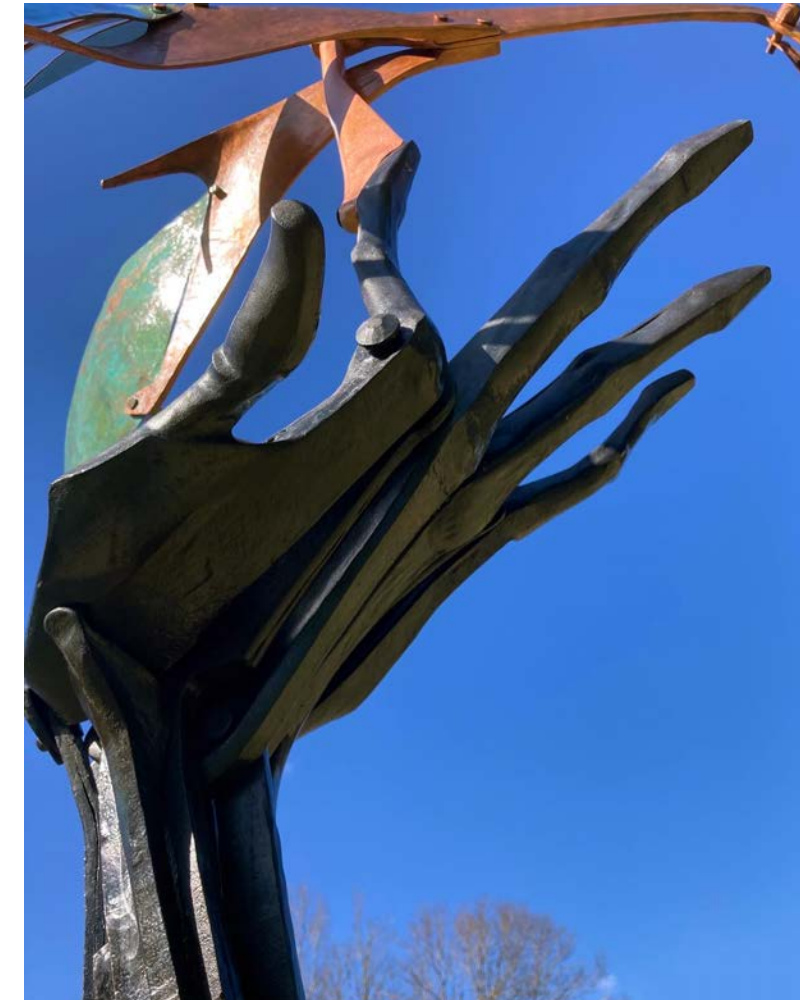
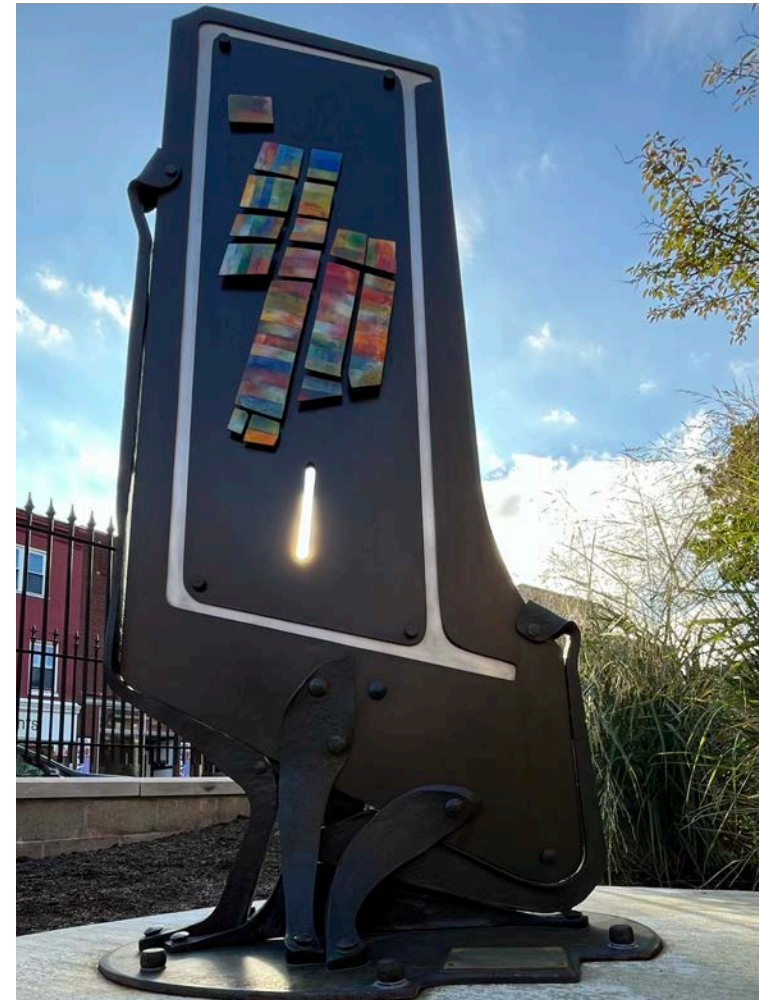

Tsvetomir Naydenov and Marguerite de Messières have extensive experience working with a variety of communities to create public art installations. More examples of their work: www.heavygatestudio.com

Turning New

Riverview Wellness Village
Marguerite de Messières and Tsvetomir Naydenov

