

Art Commission Review – Submittal Form

(Applicant complete below section)

Project Name: Bus Shelter Program

Project Address: Multiple **On Public Property?** Yes No

Total Budget: N/A **Utilizing City Funds?** Yes (specify amount): _____ No

Project Type (check all that apply):

- | | |
|--|--|
| <input type="checkbox"/> Building – New Construction or Addition | <input checked="" type="checkbox"/> Encroachment in/over ROW |
| <input type="checkbox"/> Building – Renovation or Repair | <input type="checkbox"/> Signage (Reconsideration) |
| <input type="checkbox"/> Plaza/Park/Playground | <input type="checkbox"/> Streetery (Reconsideration) |
| <input type="checkbox"/> Public Art | <input type="checkbox"/> Other: _____ |

Project Team:

Agency/Org.: City of Philadelphia--OTIS Design Lead (firm): Intersection

Other: _____

Primary Contact for Project Communications:

Name: Neil Garry

Affiliation: City of Philadelphia--OTIS

Email: [REDACTED]

(Art Commission staff complete below section)

Art Commission Meeting Date of Project Review: 4/8/26

Level of Review:

- Concept Review Final Review If Final, specify date of preceding Concept Review: _____
- Administrative Review (for projects with minimal visual impact on public realm)

Staff Notes (Optional):

Overall bus shelter design previously approved. Proposal is for siting at four (4) locations. Continued submission from March 11th meeting.



Michael A. Carroll, P.E.

1401 John F. Kennedy Blvd Suite 1430

Philadelphia, PA. 19102

Phone: (215) 686-9003

Email: otis@phila.gov

February 24, 2026

Katherine Liss
Philadelphia Art Commission
1515 Arch Street, 13th Floor
Philadelphia, PA 19102

Re: Administrative Review of Bus Shelter Locations

Dear Ms. Liss,

Through this letter, OTIS is requesting administrative review of 4 bus shelter locations as part of the March 11, 2026, Art Commission meeting. Our list of locations and supporting materials are enclosed.

Please contact me at neil.garry@phila.gov for all matters regarding bus shelters. Do not hesitate to reach out with questions or clarifications.

Sincerely,

A handwritten signature in blue ink, appearing to read "Neil Garry".

Neil Garry
Transit Program Manager
Office of Transportation and Infrastructure Systems

Bus Shelter Deployment Batch 7 – March



1. Cottman Av & Glendale Av NE

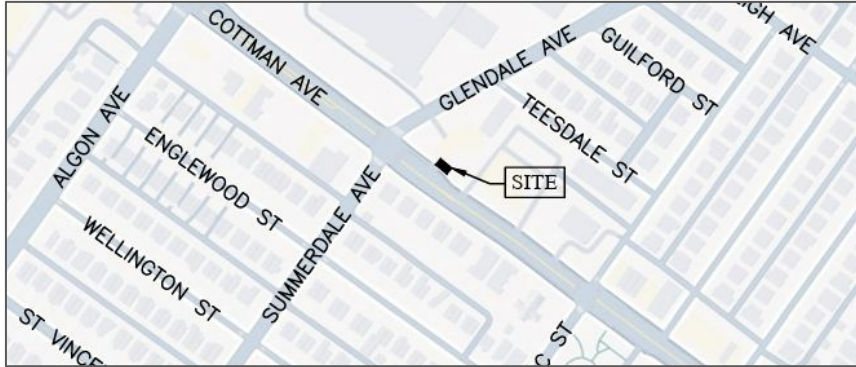

- Bike Rack
- Fire Hydrant
- Gate
- Electric Box
- Tree
- Power Pole
- Street Light
- ROW
- Manhole
- Traffic Light
- Sign
- Proposed electric
- Existing shelter for replacement
- City Inlet

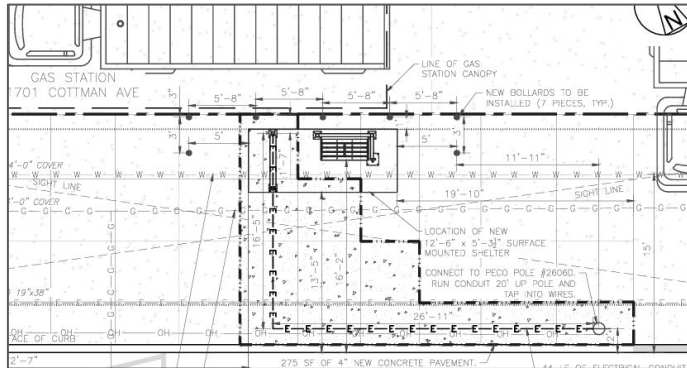

Note: Final shelter position pending PA - 1 Call & Streets Department ROW Approval

2. 49th St & Chester Av FS NE



- Bike Rack
- Fire Hydrant
- Gate
- Electric Box
- Tree
- Power Pole
- Street Light
- ROW
- Manhole
- Traffic Light
- Sign
- Proposed electric
- Existing shelter for replacement
- City Inlet

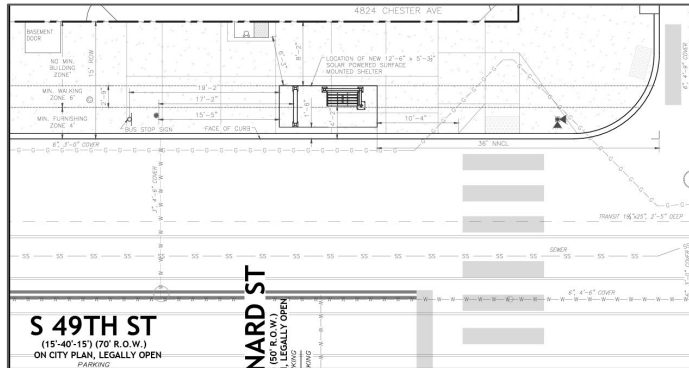

Note: Final shelter position pending PA - 1 Call & Streets Department ROW Approval

3. Rising Sun Av and Cottman Av NW

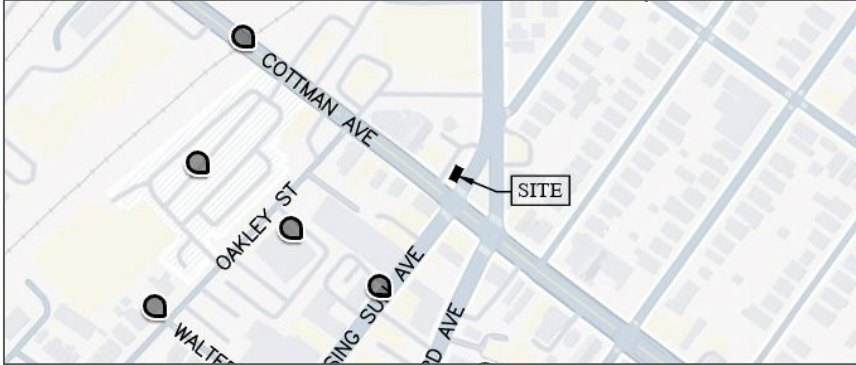

- Bike Rack
- Fire Hydrant
- Gate
- Electric Box
- Tree
- Power Pole
- Street Light
- ROW
- Manhole
- Traffic Light
- Sign
- Proposed electric
- Existing shelter for replacement
- City Inlet

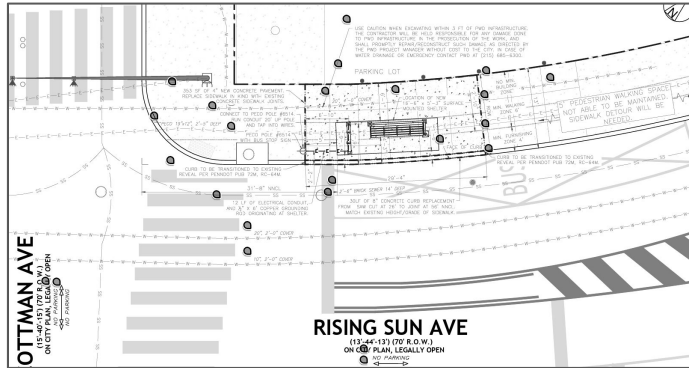

Note: Final shelter position pending PA - 1 Call & Streets Department ROW Approval

4. Lehigh Av & American St SW



- Bike Rack
- Fire Hydrant
- Grate
- Electric Box
- Tree
- Power Pole
- Street Light
- ROW
- Manhole
- Traffic Light
- Sign
- Proposed electric
- Existing shelter for replacement
- City Inlet

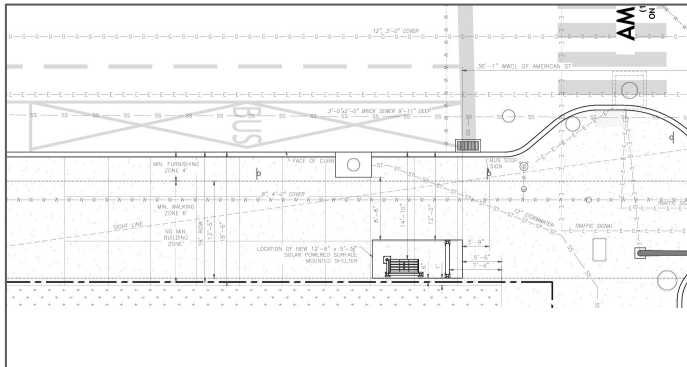

Note: Final shelter position pending PA - 1 Call & Streets Department ROW Approval