

Art Commission Review – Submittal Form

(Applicant complete below section)

Project Name: Bus Shelter Program

Project Address: Multiple **On Public Property?** ☒ Yes ☐ No

Total Budget: N/A **Utilizing City Funds?** ☐ Yes (specify amount): _____ ☒ No

Project Type (check all that apply):

- | | |
|--|--|
| <input type="checkbox"/> Building – New Construction or Addition | <input checked="" type="checkbox"/> Encroachment in/over ROW |
| <input type="checkbox"/> Building – Renovation or Repair | <input type="checkbox"/> Signage (Reconsideration) |
| <input type="checkbox"/> Plaza/Park/Playground | <input type="checkbox"/> Streetery (Reconsideration) |
| <input type="checkbox"/> Public Art | <input type="checkbox"/> Other: _____ |

Project Team:

Agency/Org.: City of Philadelphia--OTIS Design Lead (firm): Intersection

Other: _____

Primary Contact for Project Communications:

Name: Neil Garry

Affiliation: City of Philadelphia--OTIS

Email: [REDACTED]

(Art Commission staff complete below section)

Art Commission Meeting Date of Project Review: 2/11/26

Level of Review:

☐ Concept Review ☐ Final Review If Final, specify date of preceding Concept Review: _____

☒ Administrative Review (for projects with minimal visual impact on public realm)

Staff Notes (Optional):

Overall design previously approved. Review is for eight (8) new locations.

January 20, 2026

Katherine Liss
Philadelphia Art Commission
1515 Arch Street, 13th Floor
Philadelphia, PA 19102

Re: Administrative Review of Bus Shelter Locations

Dear Ms. Liss,

Through this letter, OTIS is requesting administrative review of 8 bus shelter locations as part of the February 11, 2026, Art Commission meeting. Our list of locations and supporting materials are enclosed.

Please contact me at neil.garry@phila.gov for all matters regarding bus shelters. Do not hesitate to reach out with questions or clarifications.

Sincerely,



Neil Garry
Transit Program Manager
Office of Transportation and Infrastructure Systems

Bus Shelter Deployment Batch 6 February 2026



#1 – Castor Av & Benner St SE

Proposed Bus Shelter Site – New – Solar

Note: Final shelter position pending PA – 1 Call & Streets Department ROW Approval

MAP



EXISTING CONDITIONS



SITE PLAN

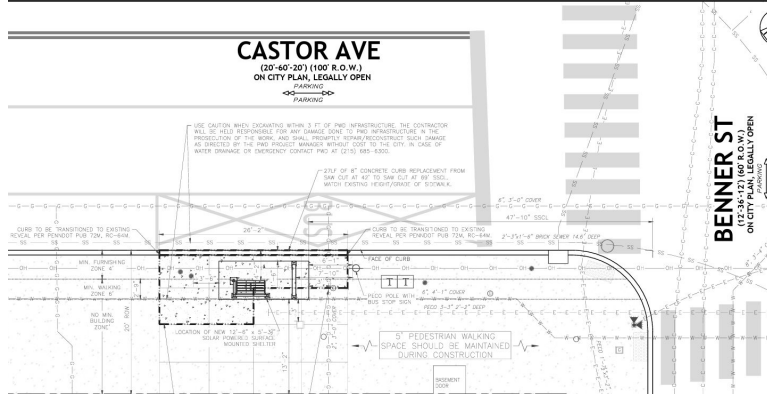
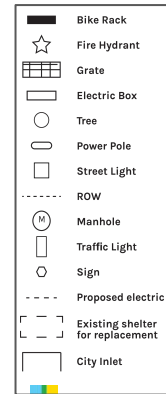

RENDERING



#2 – Overbrook Av & Haverford Av SE

Proposed Bus Shelter Site - New - Mount

Note: Final shelter position pending PA - 1 Call & Streets Department ROW Approval

MAP



EXISTING CONDITIONS



SITE PLAN

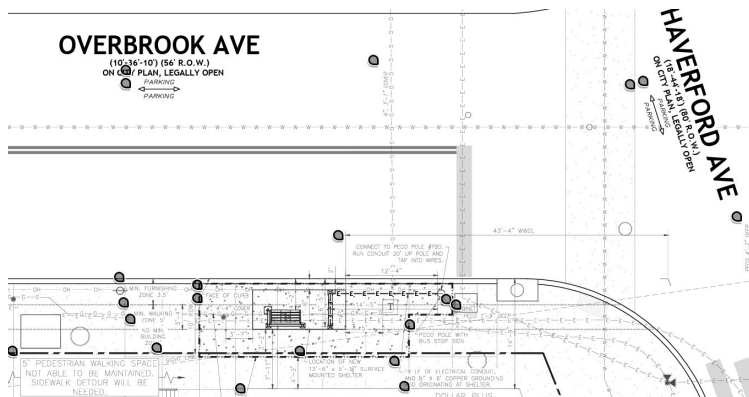
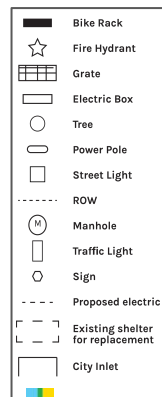

RENDERING



#3 – Castor Av & Rhawn St NW

Proposed Bus Shelter Site – New – Solar

Note: Final shelter position pending PA – 1 Call & Streets Department ROW Approval

MAP



EXISTING CONDITIONS



SITE PLAN

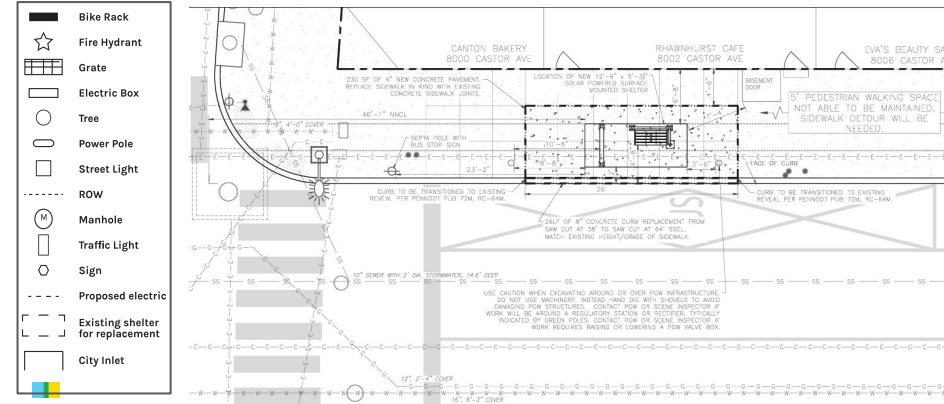

RENDERING



MAP



EXISTING CONDITIONS



SITE PLAN

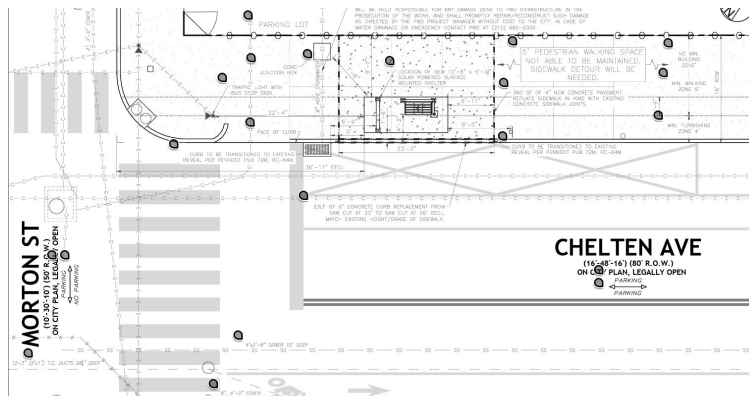
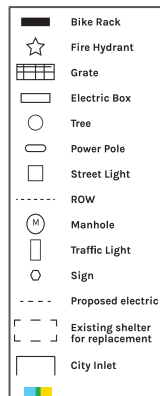

RENDERING



Proposed Bus Shelter Site - New - Solar

Note: Final shelter position pending PA – 1 Call & Streets Department ROW Approval

#5 – Lindbergh Blvd & Mario Lanza Blvd

Proposed Bus Shelter Site – New – Solar

Note: Final shelter position pending PA – 1 Call & Streets Department ROW Approval

MAP



EXISTING CONDITIONS



SITE PLAN

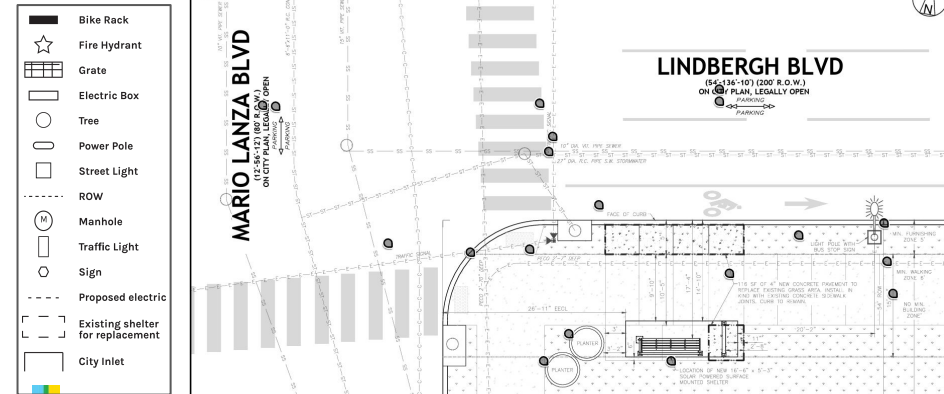

RENDERING



#6 – Lehigh Av & 7th St NE

Proposed Bus Shelter Site – New –Mount

Note: Final shelter position pending PA – 1 Call & Streets Department ROW Approval

MAP



EXISTING CONDITIONS

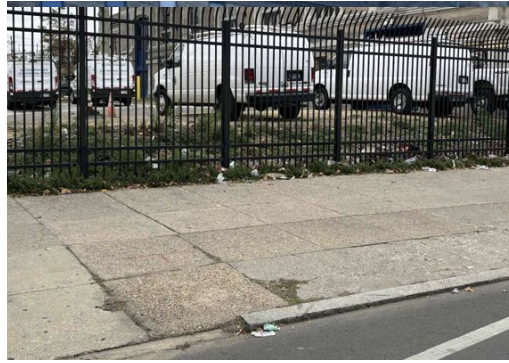

SITE PLAN

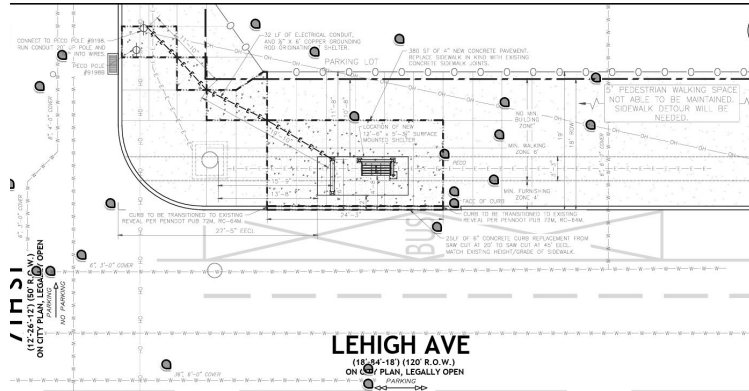
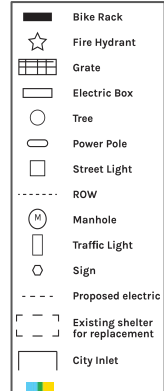

RENDERING



#7 – Ridge Av & Melon St NE

Proposed Bus Shelter Site – New – Solar

Note: Final shelter position pending PA – 1 Call & Streets Department ROW Approval

MAP



EXISTING CONDITIONS



SITE PLAN

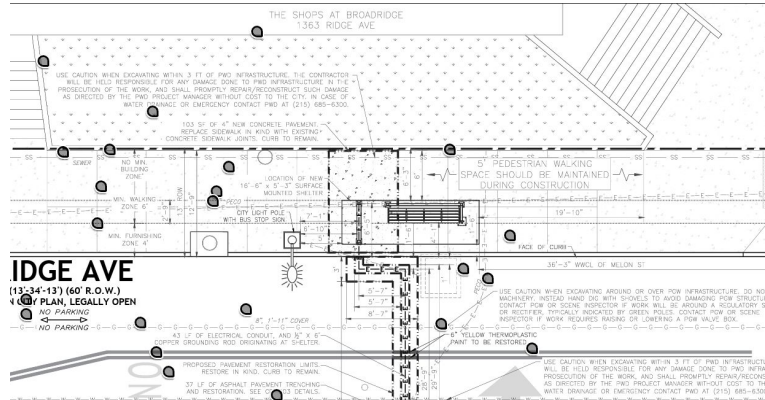
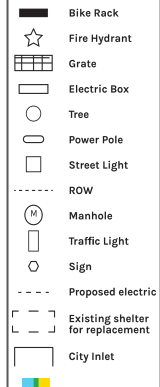

RENDERING



#8 – Castor Av & Hellerman St NW

Proposed Bus Shelter Site – New – Solar

Note: Final shelter position pending PA – 1 Call & Streets Department ROW Approval

MAP



EXISTING CONDITIONS

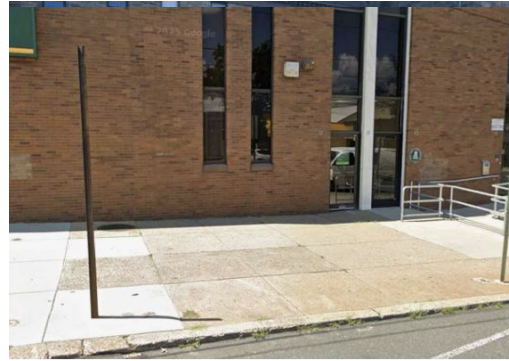

SITE PLAN

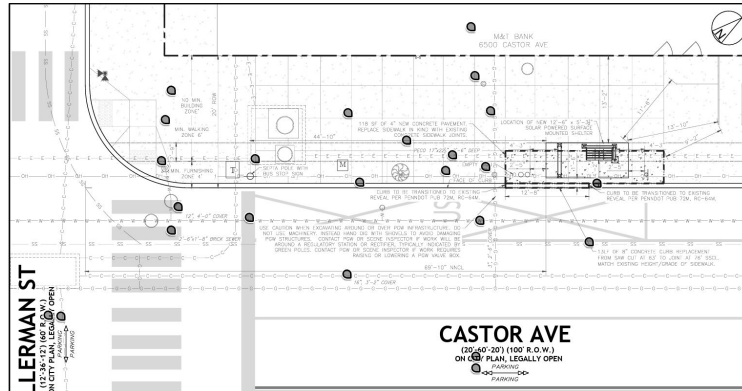
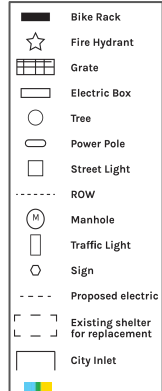

RENDERING

