

# Memorandum



**To:** Kacie Liss, Art Commission  
**From:** Sydney DeRoma, Capital Project Manager, CPO  
**Date:** September 24<sup>th</sup>, 2025  
**Re:** Request for Administrative Approval

---

We respectfully request administrative approval for site improvements at Bridesburg Recreation Center: 4601 Richmond St, Philadelphia, PA 19137.

A brief description of the project is stated below, and the enclosed drawings show the intended extent of work.

The project includes installing new safety surface, new pieces of play equipment, and necessary site amenities as requested by the community and Council. The project budget is \$380,000.

Thank you for your attention. Please inform me if you need more information at this time.

cc: Aparna Palantino, Deputy Managing Director, CPO  
Francesco Cerrai, Project Director, CPO  
Sydney DeRoma, Project Manager, CPO  
File: Project # 16-22-7099-01, Section 2.12



The background image shows a playground area with a blue and yellow rubber safety mat. There are several orange slides, a blue and green play structure, and a small blue and green play structure. A brick building is visible in the background, and there are trees with some autumn-colored leaves. A chain-link fence is on the right side. The text "BRIDESBURG RECREATION CENTER PLAYGROUND | 4601 RICHMOND ST" is overlaid in the center.

# **BRIDESBURG RECREATION CENTER PLAYGROUND | 4601 RICHMOND ST**



# SITE CONTEXT



BRIDESBURG RECREATION CENTER

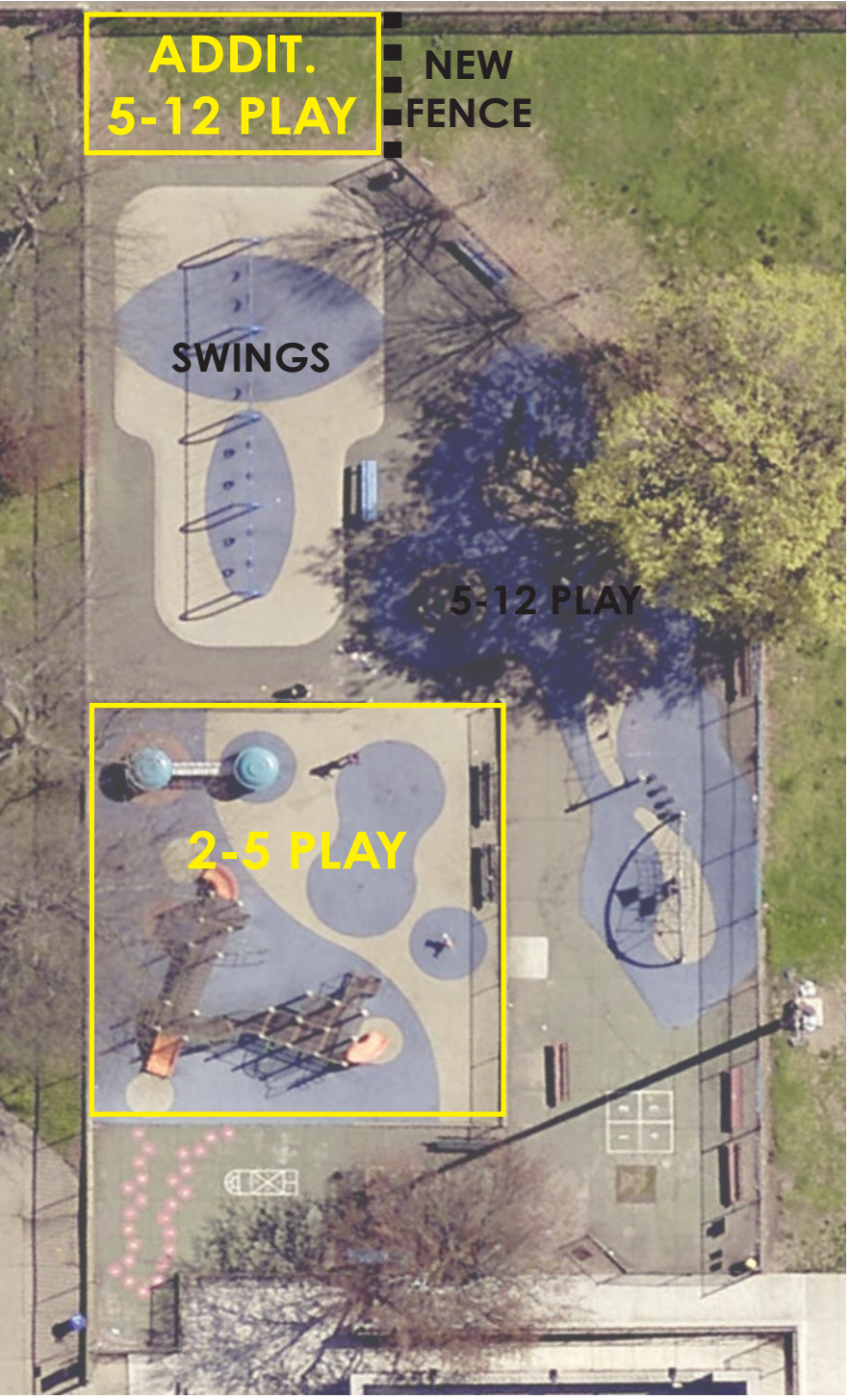

PLAYGROUND

 = extent of work





# EXISTING CONDITIONS PLAN

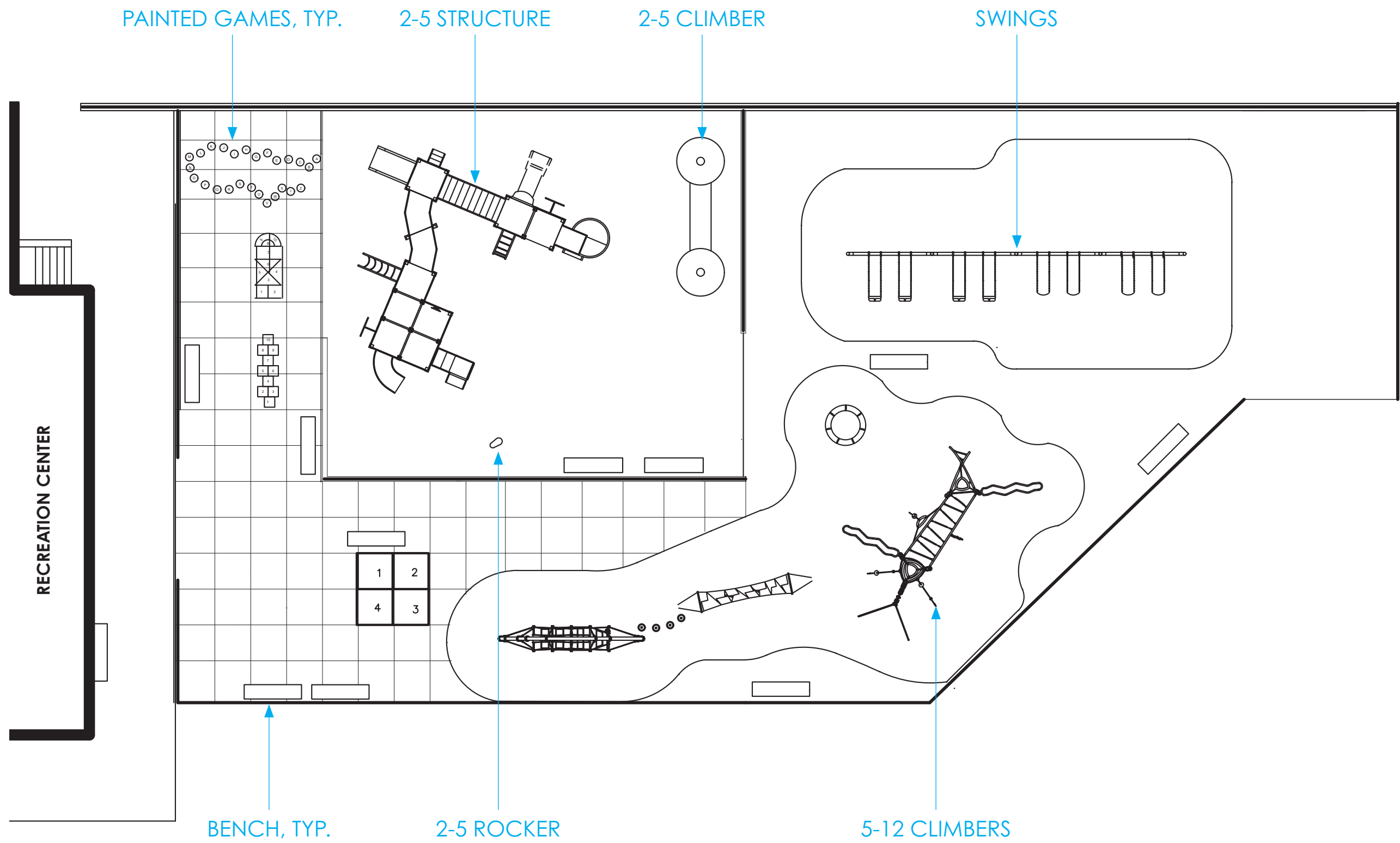

# DEMOLITION PLAN

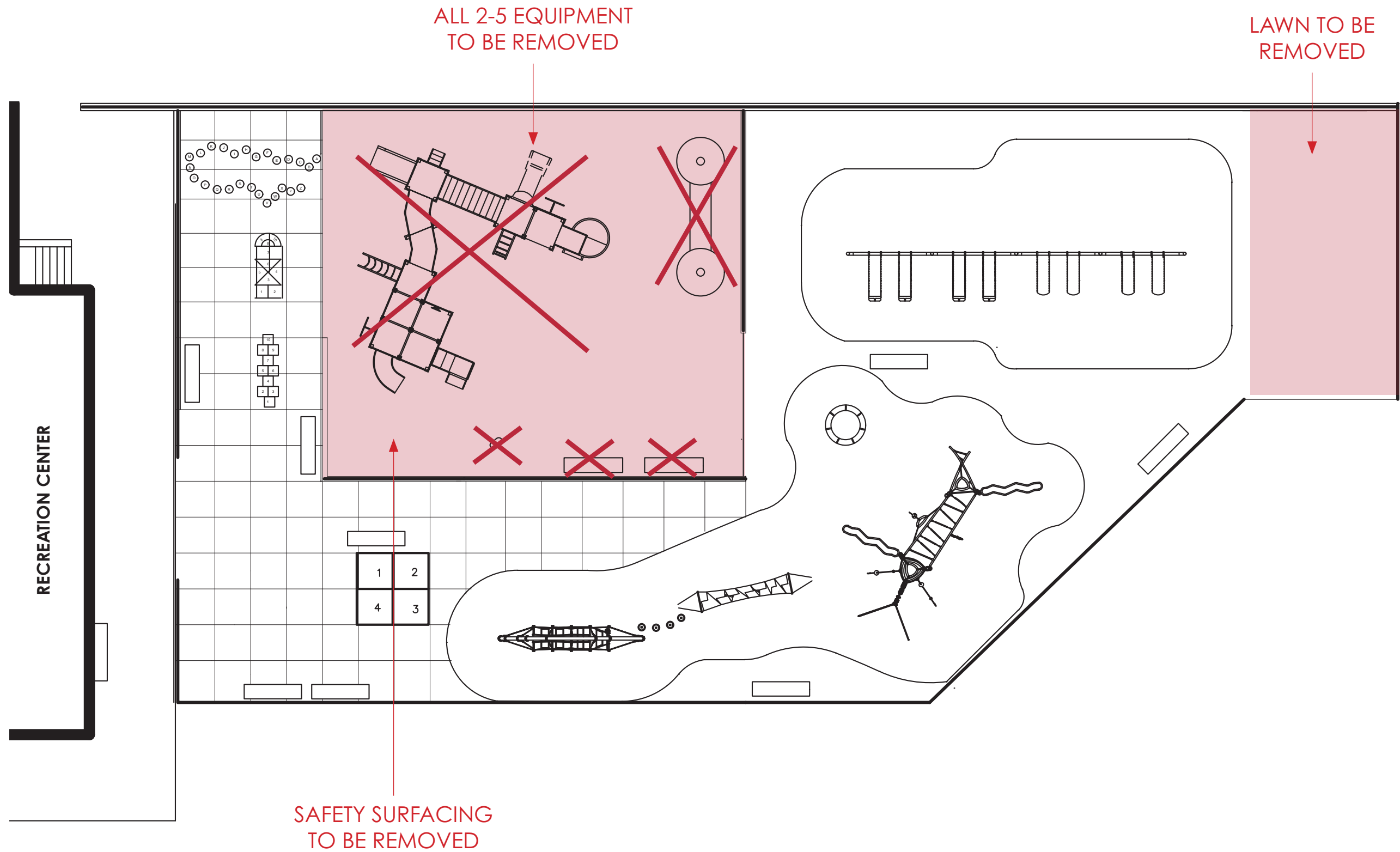



# EXISTING CONDITIONS



LIFTED/WORN SAFETY SURFACE

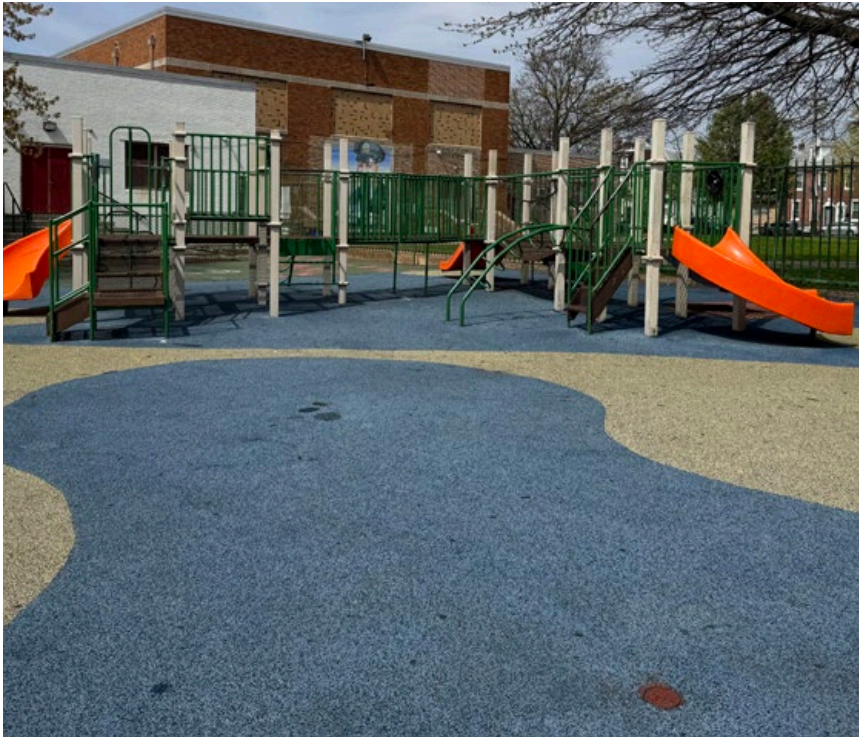

OLD FOOTINGS FROM MISSING EQUIPMENT

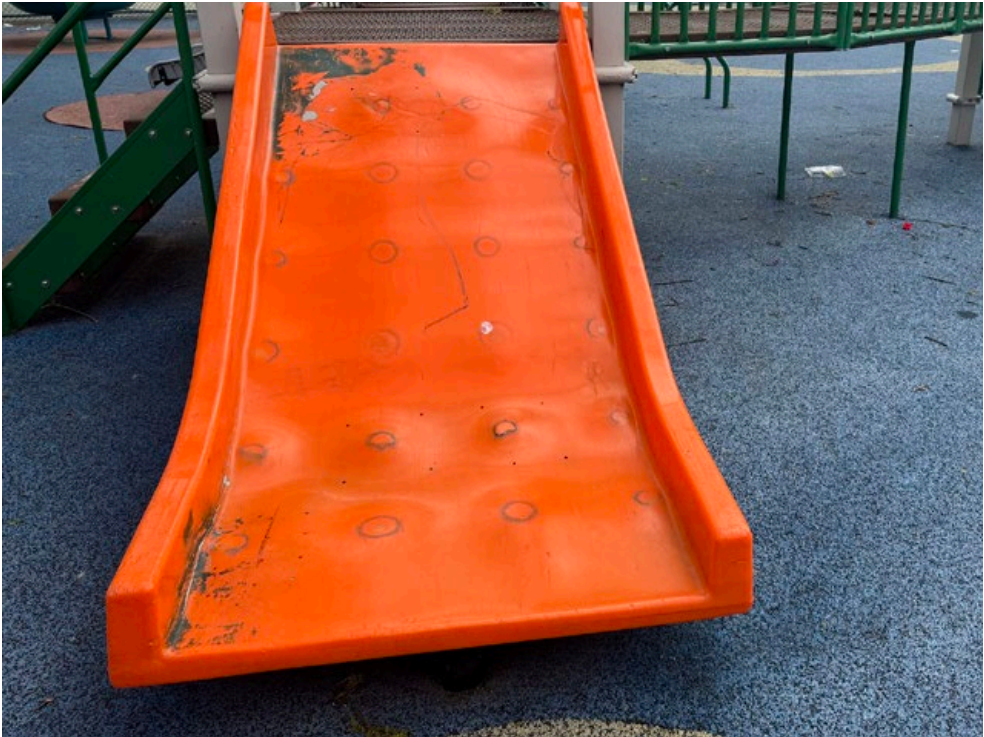

WARPED SLIDE



CLIMBER

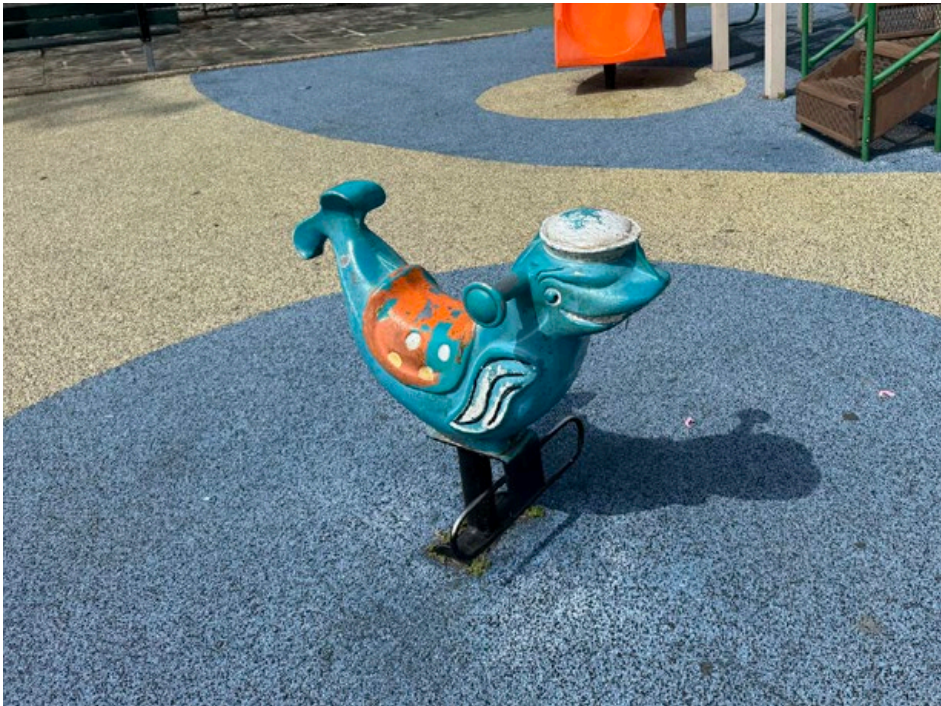

ROCKER



DENTED SLIDE



# PROPOSED PLAN

TOP-VOTED DESIGN BY COMMUNITY

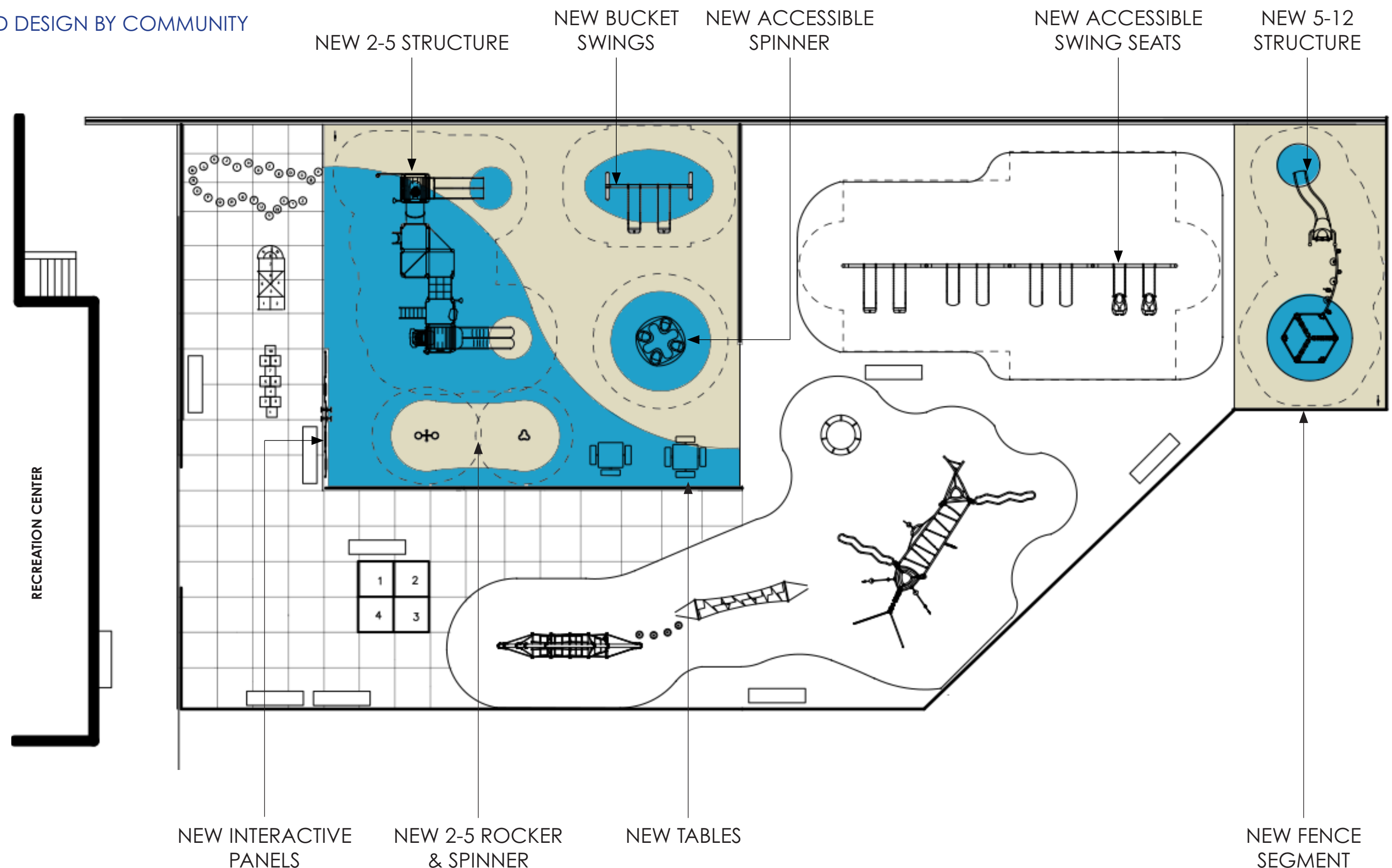



# PROPOSED PLAYGROUND EQUIPMENT

COLOR PALETTE CHOSEN BY COMMUNITY



2-5 PLAY STRUCTURE (FRONT)



2-5 PLAY STRUCTURE (BACK)



ADDITIONAL 5-12 STRUCTURE



2-5 AREA FACING REC CENTER



2-5 AREA FACING RICHMOND ST



