



September 26, 2025

Katherine Liss
The Philadelphia Art Commission
One Parkway, 1515 Arch Street, 13th Floor
Philadelphia, PA 19102

Dear Katherine:

Creative Philadelphia (Creative PHL) is requesting a conceptual review of the Percent for Art project for the Barrett Playground during the Philadelphia Art Commission meeting on Wednesday, October 8th, 2025. The project is described below.

SUBJECT: Percent for Art – Barrett Playground

PROJECT DESCRIPTION:

This Percent for Art opportunity for the Barrett Playground was initiated in collaboration with our partners at Rebuild and Nicetown CDC, as part of a major construction project that will include a new community building and significant outdoor site improvements.

The project is located in the Logan section of North Philadelphia at 641 Lindley Avenue. Barrett Playground has long been a cornerstone of community life, boasting a rich history dating back to the late 19th century. Serving as a vital communal space, it has been instrumental in fostering a sense of belonging among residents and hosting a myriad of recreational and cultural activities.

The Barrett Playground Percent for Art project will provide two (2) complimentary works of art to be located in the main Commons area of the new community building. One will be a Sculptural Ceiling-Hung Art Installation, and the other will be an Indoor Art Wall Installation. The artworks will be permanent, site-specific, and will reflect the culture, values, and diversity of the Logan community. Telling the story of this neighborhood's past as well as envisioning the future was of particular importance to community members.

Creative PHL distributed a Call for Artists which was open from April 2nd – June 24th, 2024, and 90 artist teams applied. Creative PHL assembled a Percent for Art Committee to guide the selection of the artist, which included: community members, residents, local arts and culture professionals, and representatives of Creative Philadelphia, Rebuild, Nicetown CDC, and the City of Philadelphia.

The Barrett Playground Percent for Art Committee selected four (4) finalist teams to provide design proposals. The artist teams received input and inspiration from the community, prior to and after creating their proposals, through in-person and online community engagement meetings and an online survey that collected public feedback about each design. Artists Eric Okdeh, Jamond Bullock, and Kathleen Studebaker were selected by the Barrett Playground Percent for Art Committee as the winning artist team. Their collaborative design, titled "Logan Times", features two (2) complimentary artworks that celebrate the neighborhood's heritage, resilience, and vibrant community spirit.

The first artwork is a large-scale mural located in the inset part of the Commons area. Threaded throughout the mural are symbols of joy, fellowship, and multigenerational families. The composition showcases Logan's architectural beauty and its rich history of immigration, with imagery that includes archival photographs, neighborhood landmarks, and scenes of everyday life. A central globe motif anchors the mural, surrounded by a mosaic flower and bee, symbols of diverse people coming together in harmony.

The second artwork is a sculptural ceiling installation inside the recreation center. Its central form is an expansive construction of concentric aluminum rings, evoking growth, aspiration, and collective momentum. Surrounding the rings are aluminum gears that represent purpose and potential, recalling Logan's industrial past while speaking to its productive future. A constellation of dichroic glass stars, laid out to match the night sky over Logan on a meaningful date, scatters light across the room in colorful reflections.

The project will include a series of inclusive artmaking workshops, where community members will contribute personal artwork and ideas that inform the final design. These sessions ensure that the project evolves through collaboration and reflects the lived experiences of Logan residents. Through these works, the artists aim to honor Logan's legacy while fostering connection, creativity, and pride for generations to come.

Should you require any additional information, please do not hesitate to call me at 215.686.4596.

Sincerely,

A handwritten signature in black ink, appearing to read "Marguerite Anglin". The signature is fluid and cursive, with a long, sweeping tail on the final letter.

Marguerite Anglin, RA, NOMA
Public Art Director
Creative Philadelphia

Eric Okdeh, Jamond Bullock and Kathleen Studebaker

Barrett Playground Percent for Art Project

Logan Times

PROPOSED SITE PLAN

Okdeh/Bullock/Studebaker - Barrett Playground;
Site Plan & Artwork Location

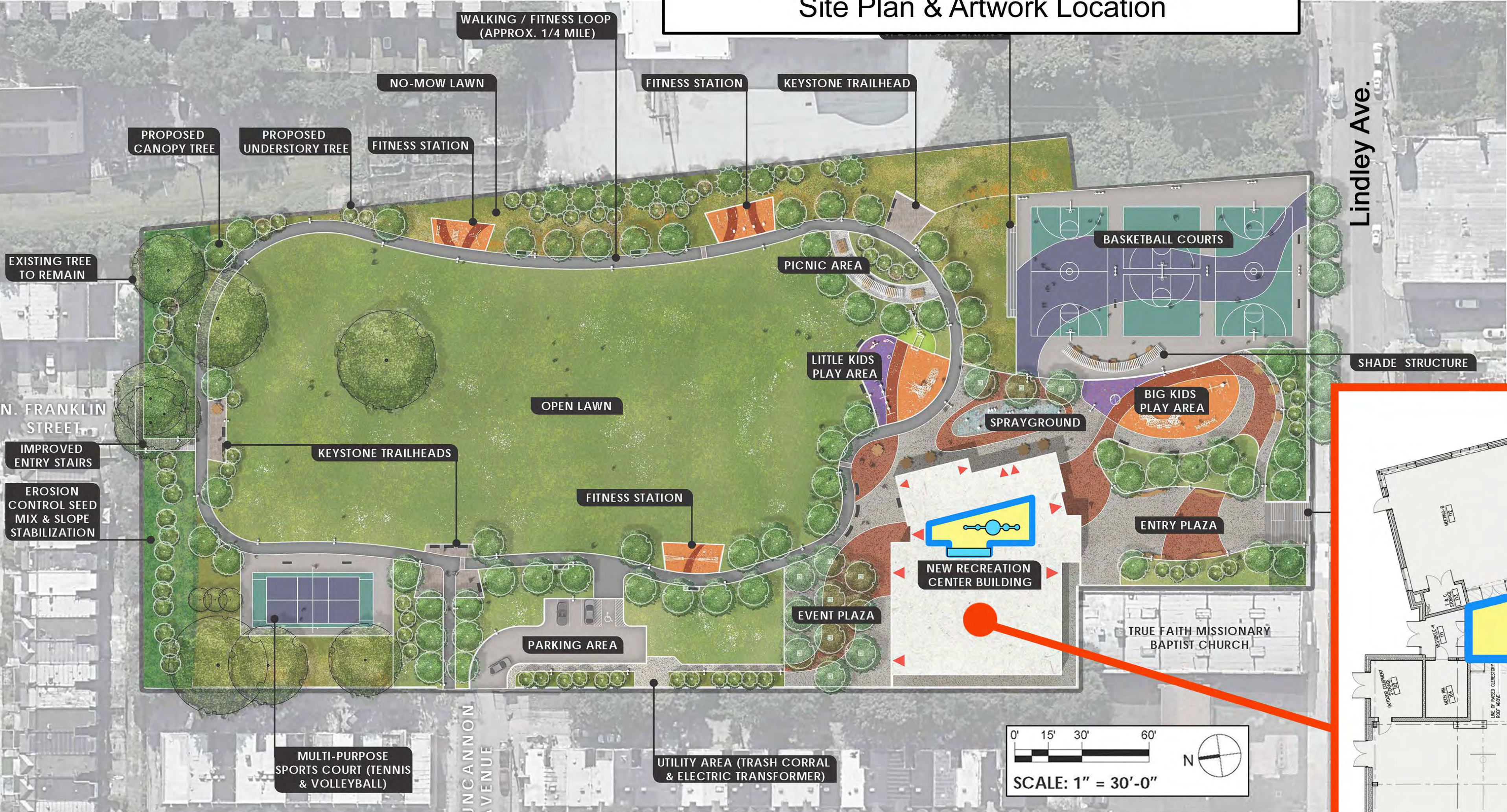

KEY:

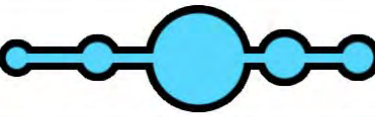
 Sculpture

 Mural

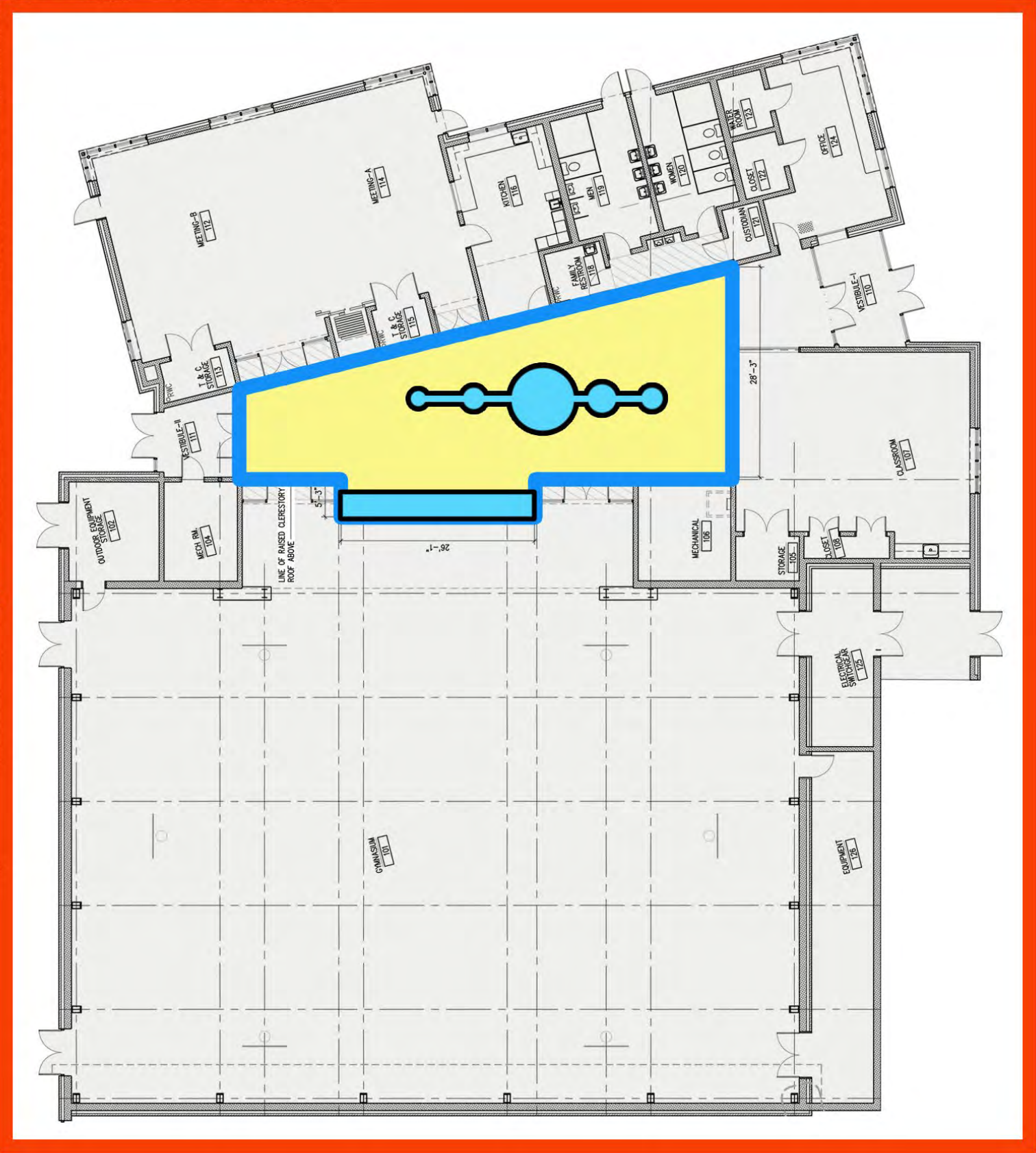

BARRETT PLAYGROUND

PHILADELPHIA ART COMMISSION REVIEW 7.13.2022

Okdeh/Bullock/Studebaker - Barrett Playground; Concept & Inspiration - Overall

This design incorporates elements of nature, community, and social justice, reflecting Logan's rich heritage. The design has evolved through feedback and collaboration with the citizens of Logan. We plan to run a series of inclusive artmaking workshops throughout fabrication that will give neighborhood residents a chance to participate in the creation of both mural and sculpture.

Threaded throughout the mural are symbols of joy, fellowship, and multigenerational families. We showcase the beautiful architecture of the neighborhood, and highlight its history of immigration. The central circle doubles as a globe, and the mosaic flower and bee symbolize diverse people coming together. Youth appear in tandem with older photos. The young boy on the right admires an image of a Logan playground in 1961. The PAM girls drill team is shown performing in the 1970s, as a young family strolls down the street nearby.

The ceiling sculpture's central form is an expansive construction of concentric aluminum rings. It spreads through the room and evokes a sense of growth and aspiration. A grouping of iconic Logan buildings surround the central circle, echoing the mural. The aluminum gears represent purpose and potential, recalling the past industry of the area, and speaking to its productive future. The rest of the ceiling is occupied by a constellation of dichroic glass stars; laid out to match the night sky over Logan on a specific, meaningful date. These "stars" will catch light, scattering it across the room in colorful reflections.



Okdeh/Bullock/Studebaker - Barrett Playground;
Concept & Inspiration - Sculpture Drawing

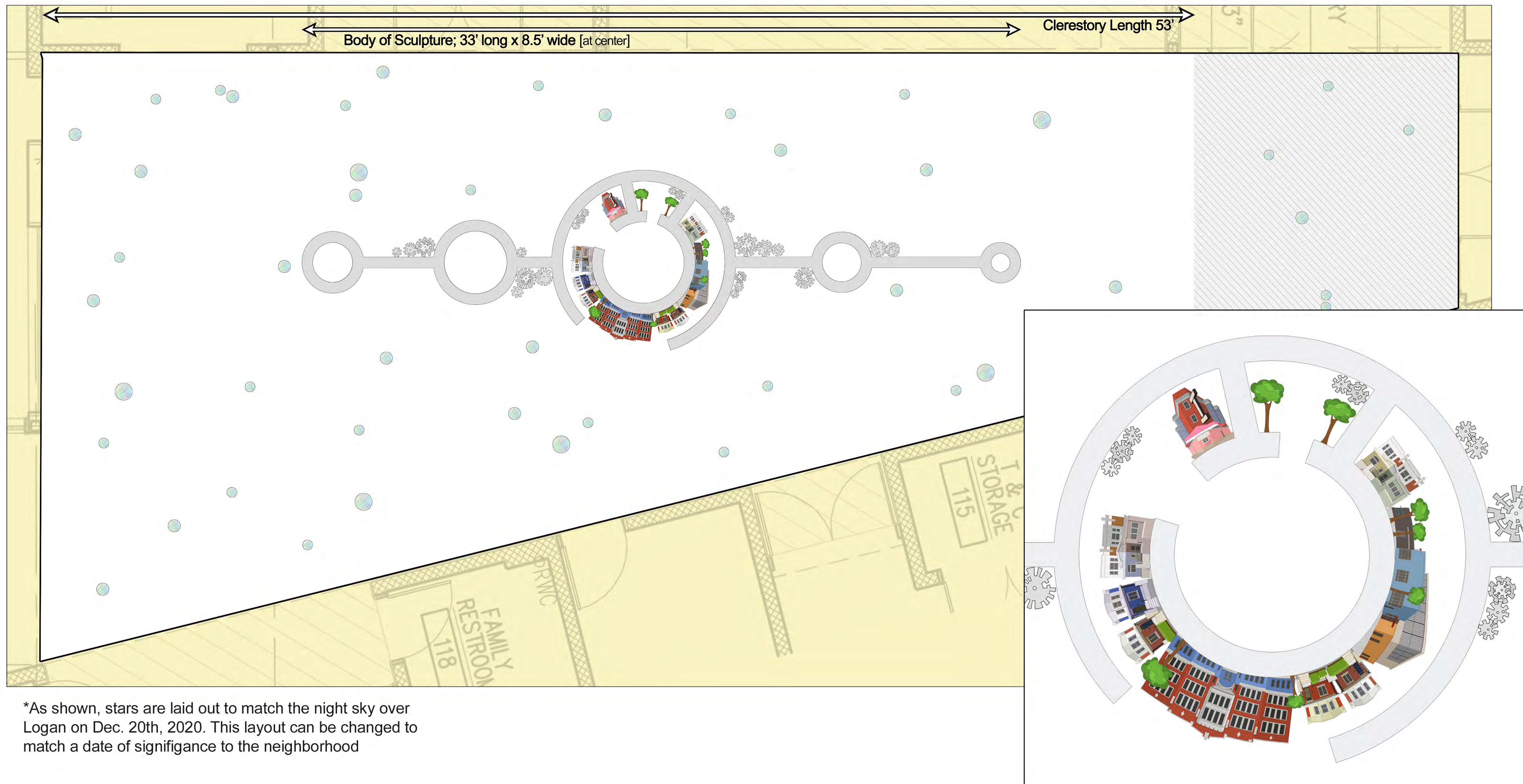

Okdeh/Bullock/Studebaker - Barrett Playground;
Renderings - Sculpture

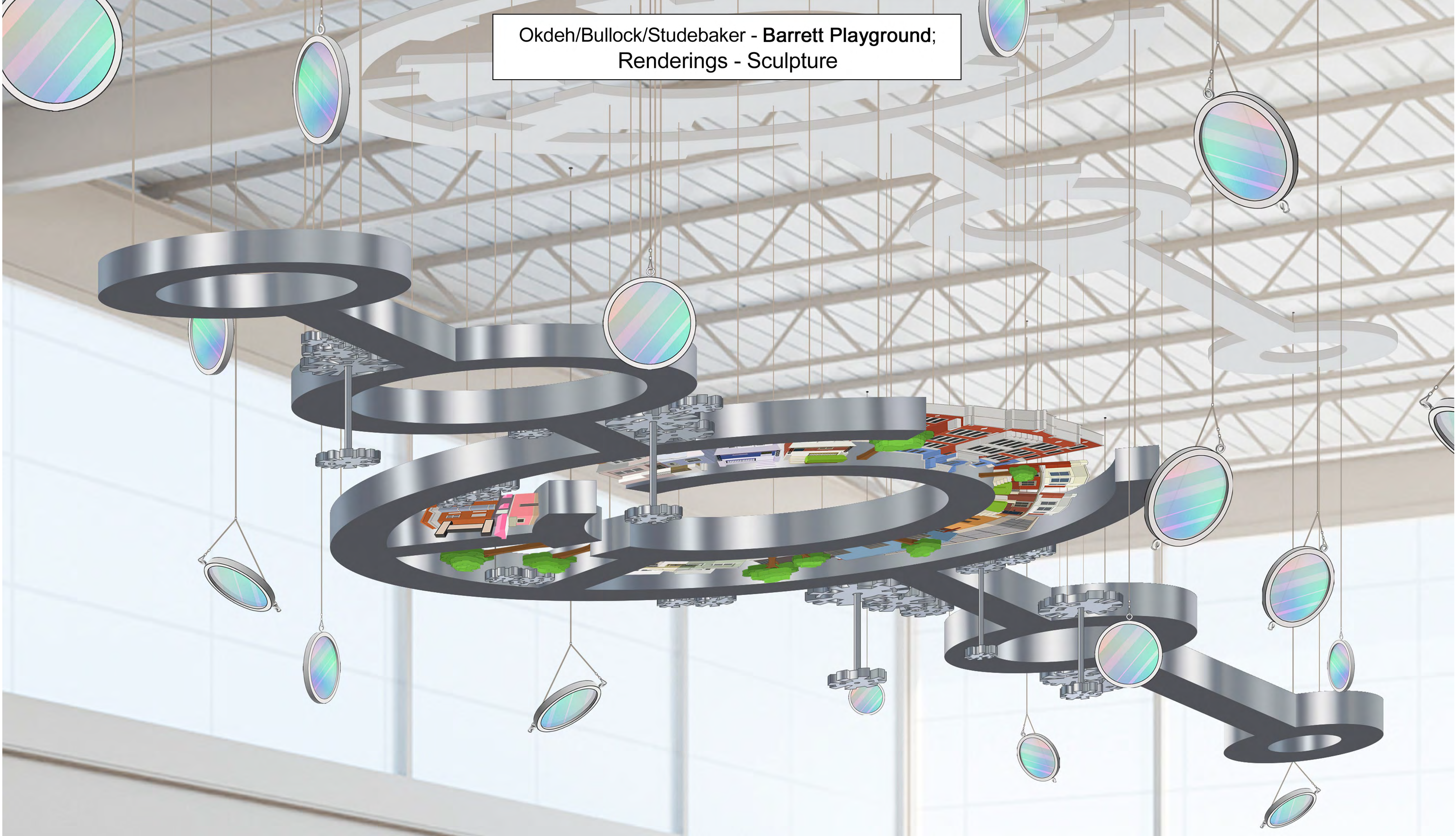

Okdeh/Bullock/Studebaker - Barrett Playground;
Renderings - Sculpture Details

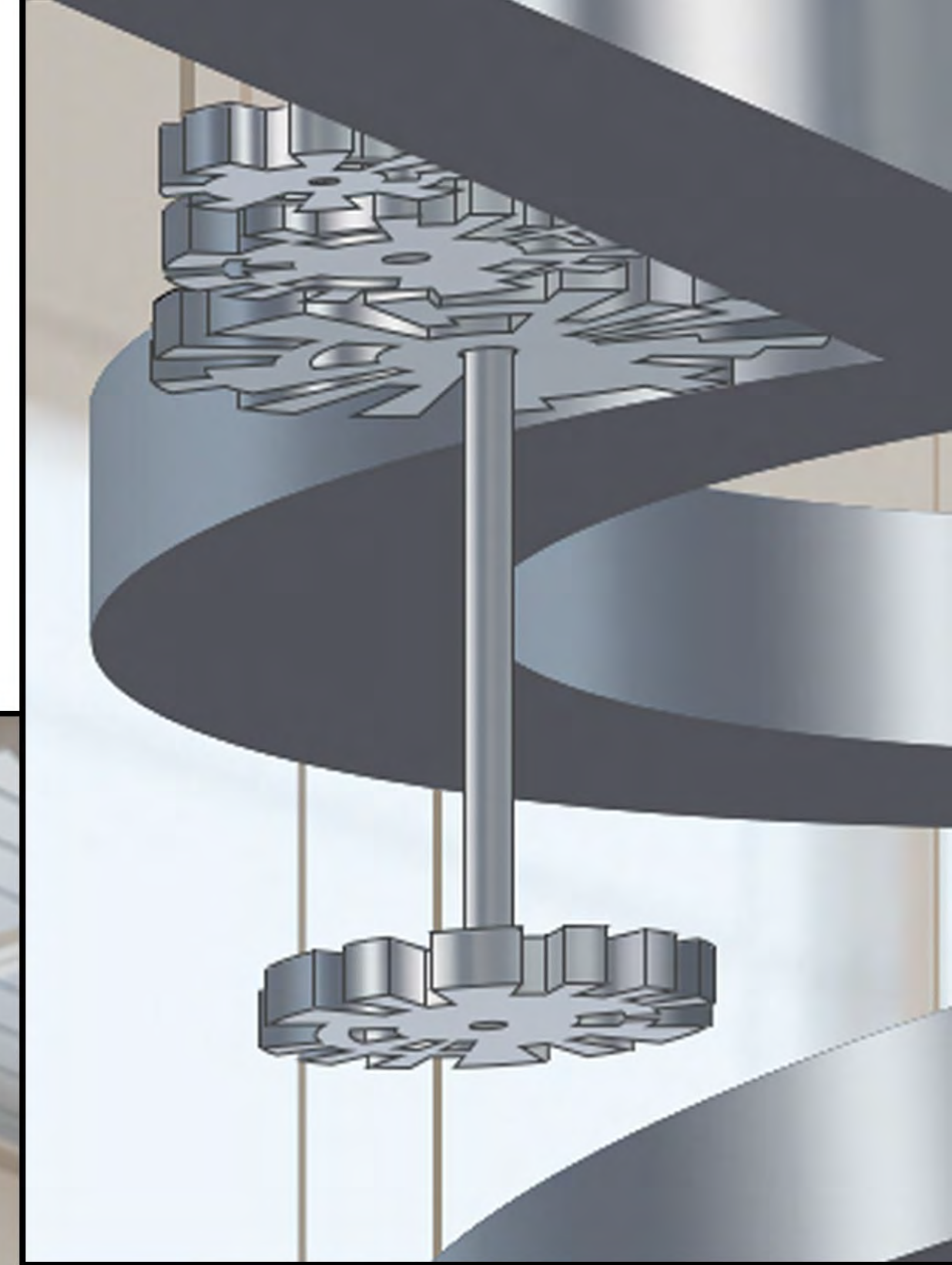
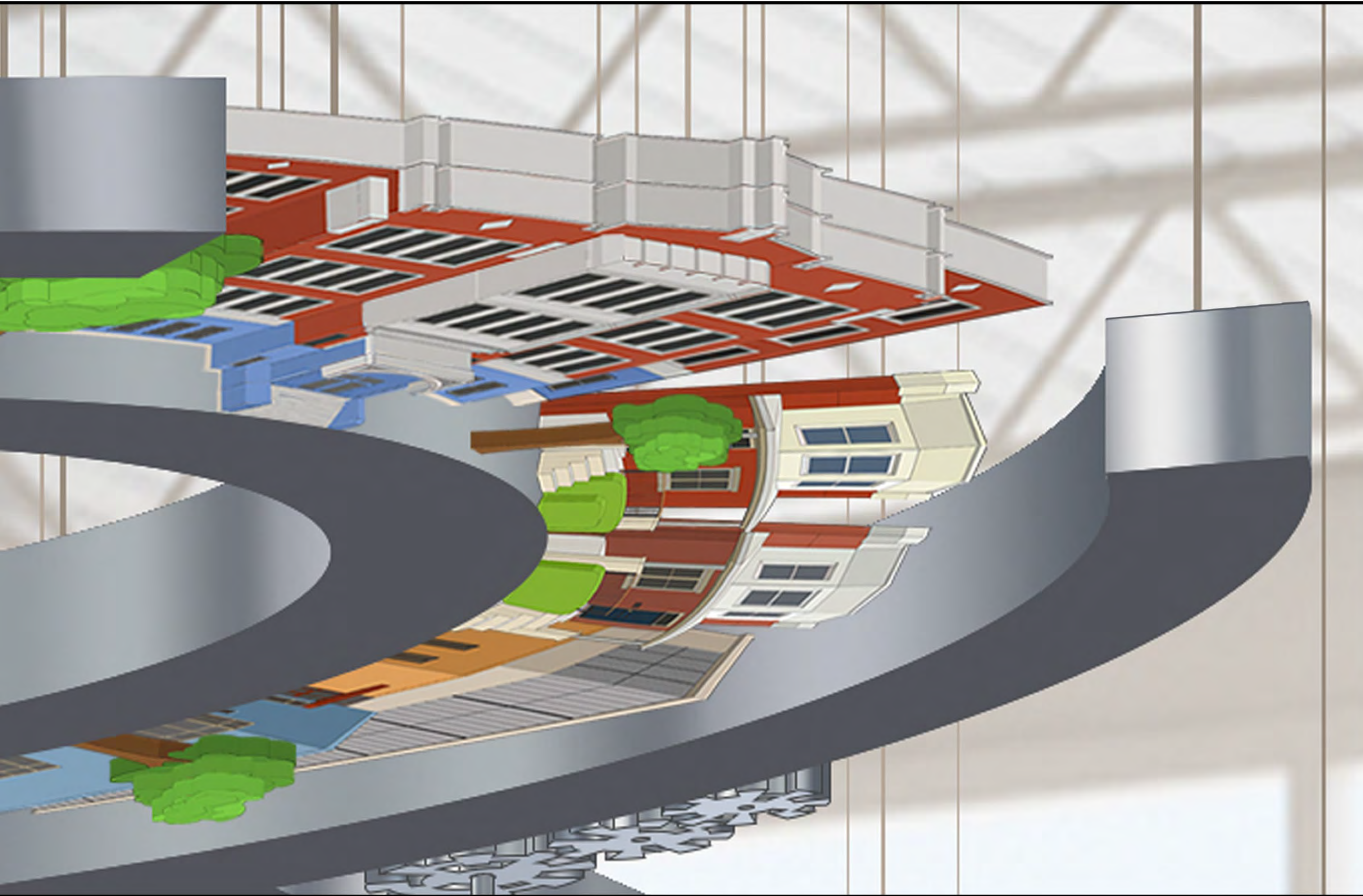

Okdeh/Bullock/Studebaker - Barrett Playground;
Concept & Inspiration - Mural; Exploded View



- Many design images are sourced from the main branch of the library, microfilm of the Logan Times paper, and Temple University's archives.
- Imagery focuses on elements of Logan's past that are relevant to the community.
- Images of today's Logan residents are paired with archived photos of the past, providing viewers a sense of thier place in history.
- Design contains small nods to Logan, including a sonics Jersey on a boy with the number 22, referencing Logan local Flip Murray.
- The radio tower represents Roger Pin's Cambodian-American radio network, which was founded in Logan.
- Children on bikes are in front of an arial view of Huntingdon Park.

Okdeh/Bullock/Studebaker - Barrett Playground;
Renderings - Mural Details



Okdeh/Bullock/Studebaker - Barrett Playground;
Fabrication - Sculpture; Aluminum Form

Cross-section view:

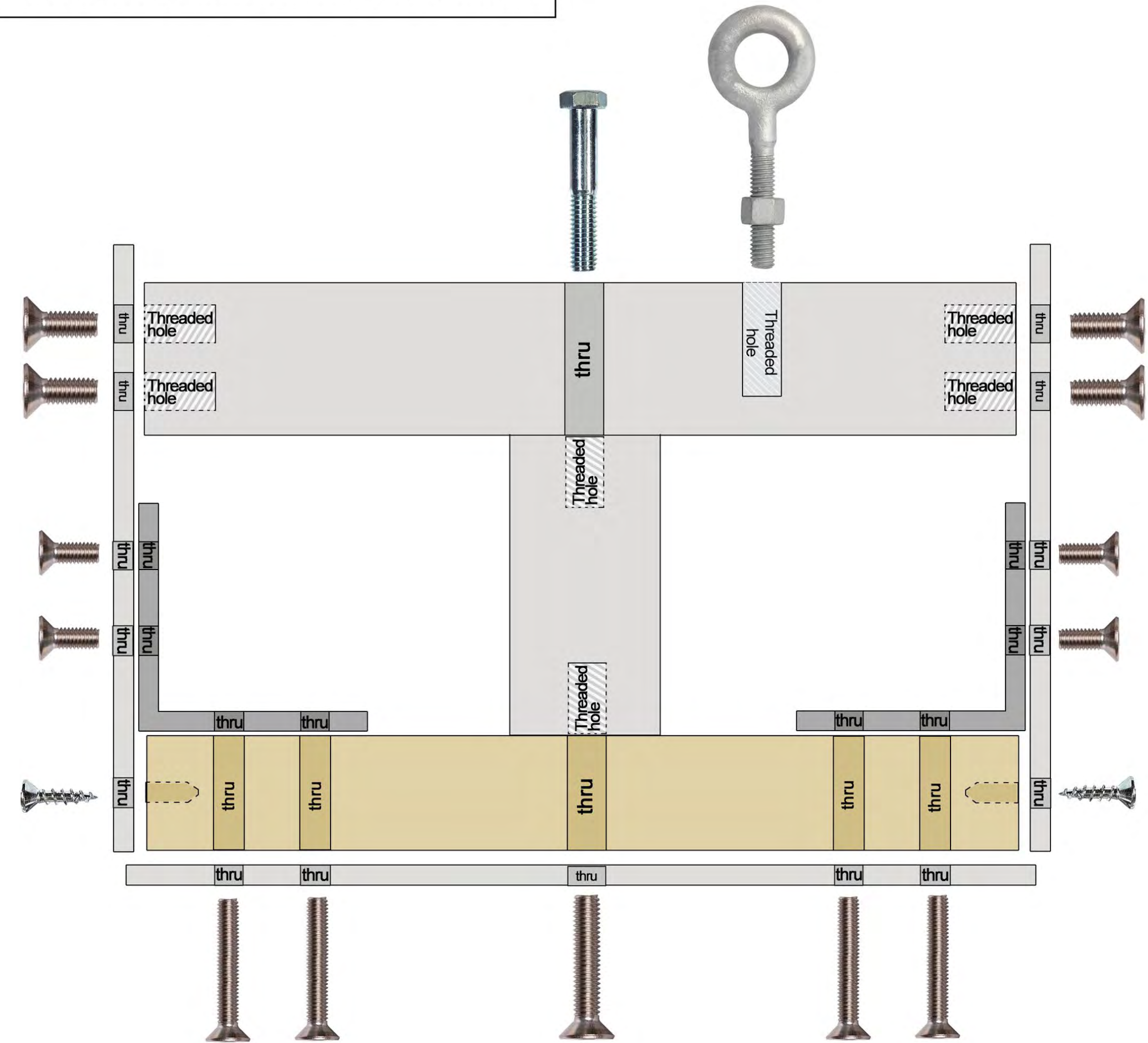

Okdeh/Bullock/Studebaker - Barrett Playground;
Fabrication - Sculpture Sample

Sample
[cross-section]

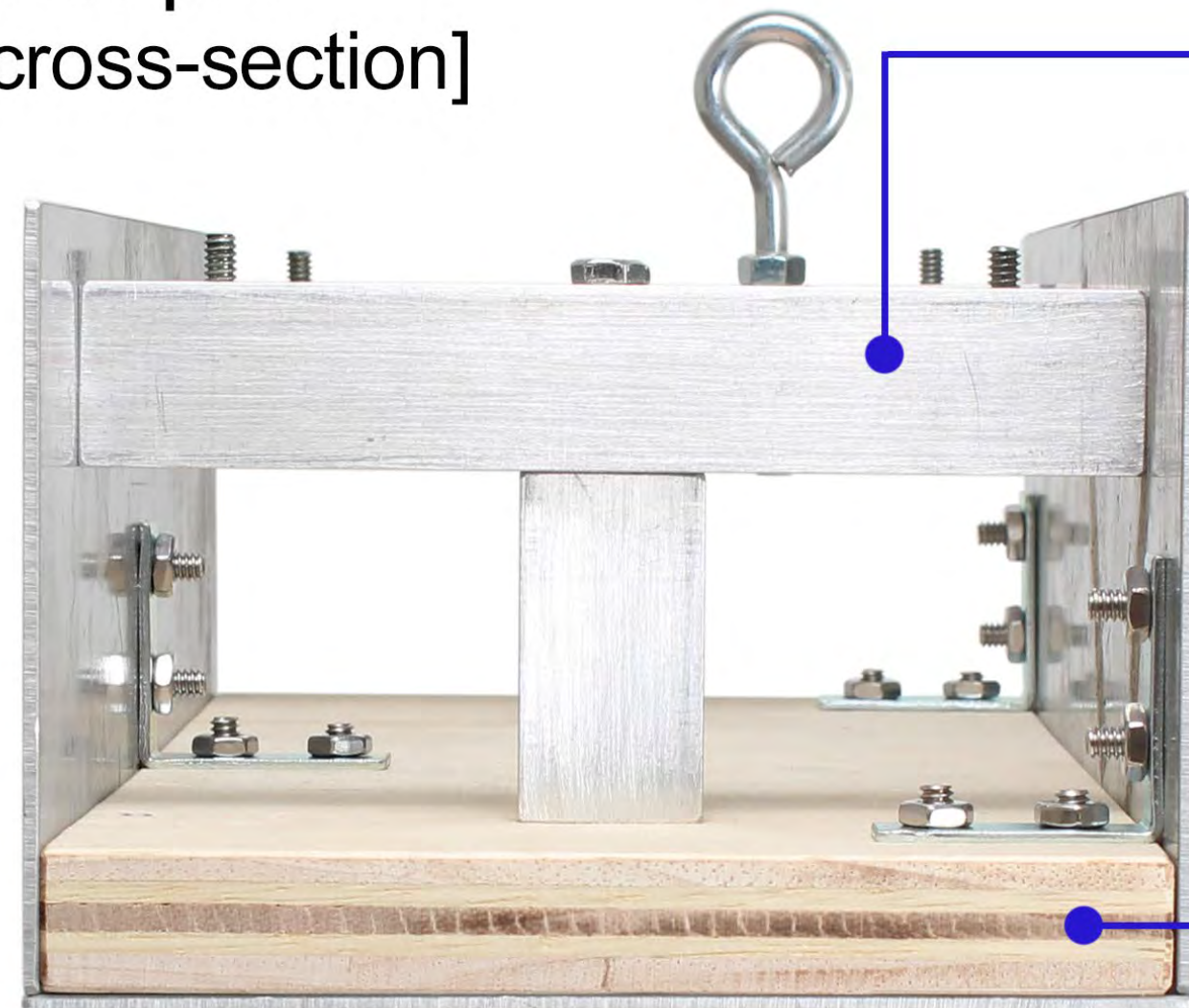

1/2" x 1" Aluminum Bar

1/8" Aluminum Plate

3/4" Plywood

Sample
[Exterior]

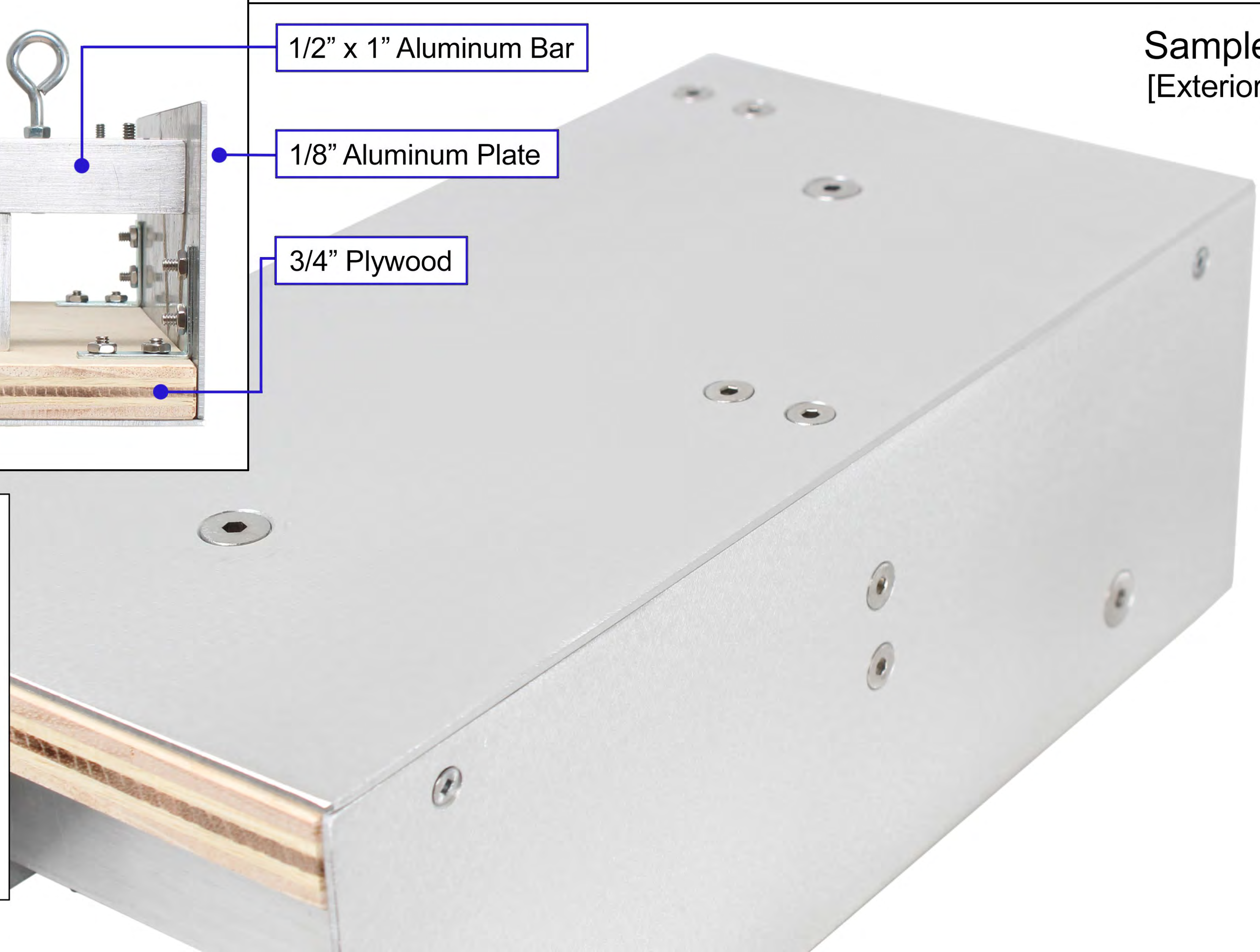

Drawing

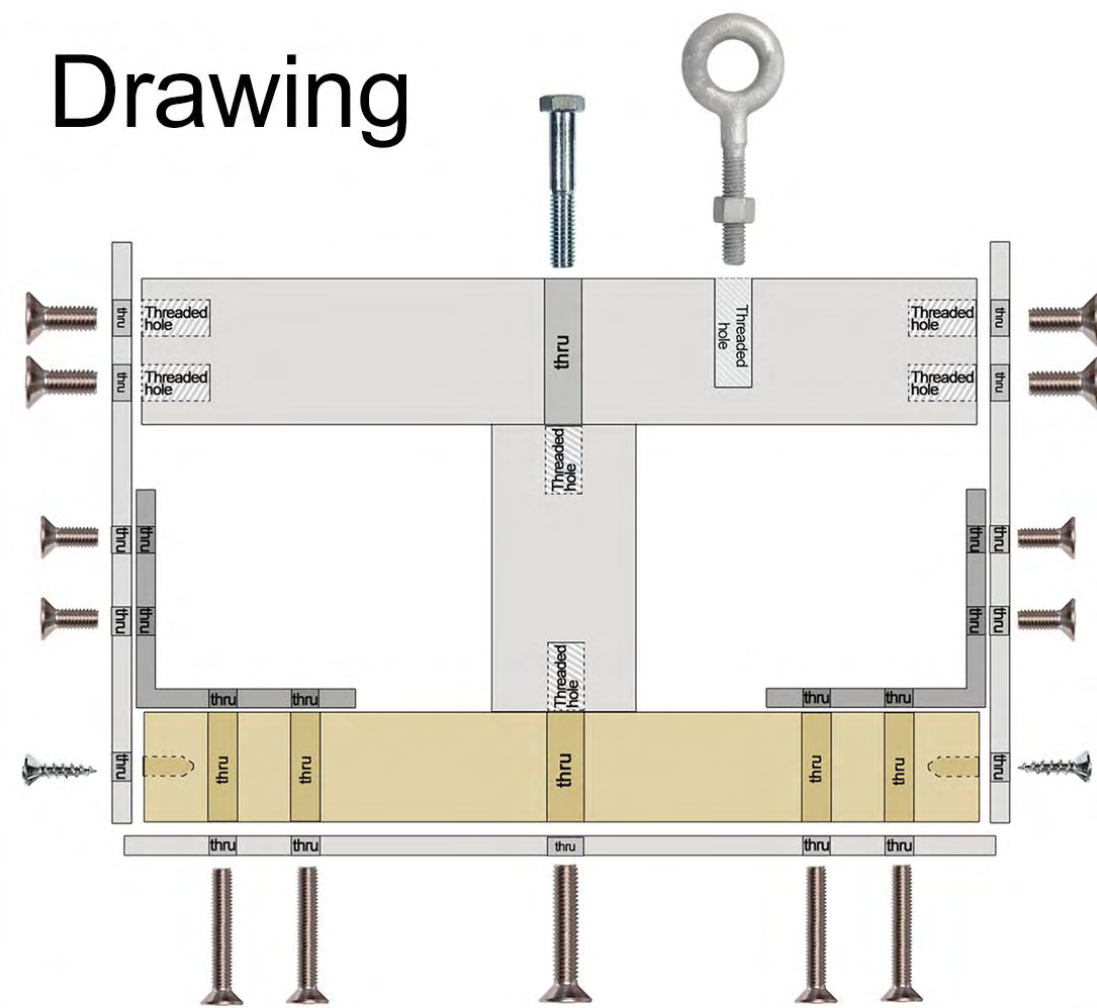

Okdeh/Bullock/Studebaker - Barrett Playground;
Fabrication - Sculpture; Buildings



MATERIALS:

- Plywood;
various thicknesses
- Acrylic paint
- Steel hardware
- Wood glue



GEARS

Okdeh/Bullock/Studebaker - Barrett Playground;
Fabrication - Sculpture; Gears & Stars

STARS

3/4"
Plywood



1/8"
Aluminum

Aluminum
Flashing

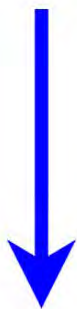

+

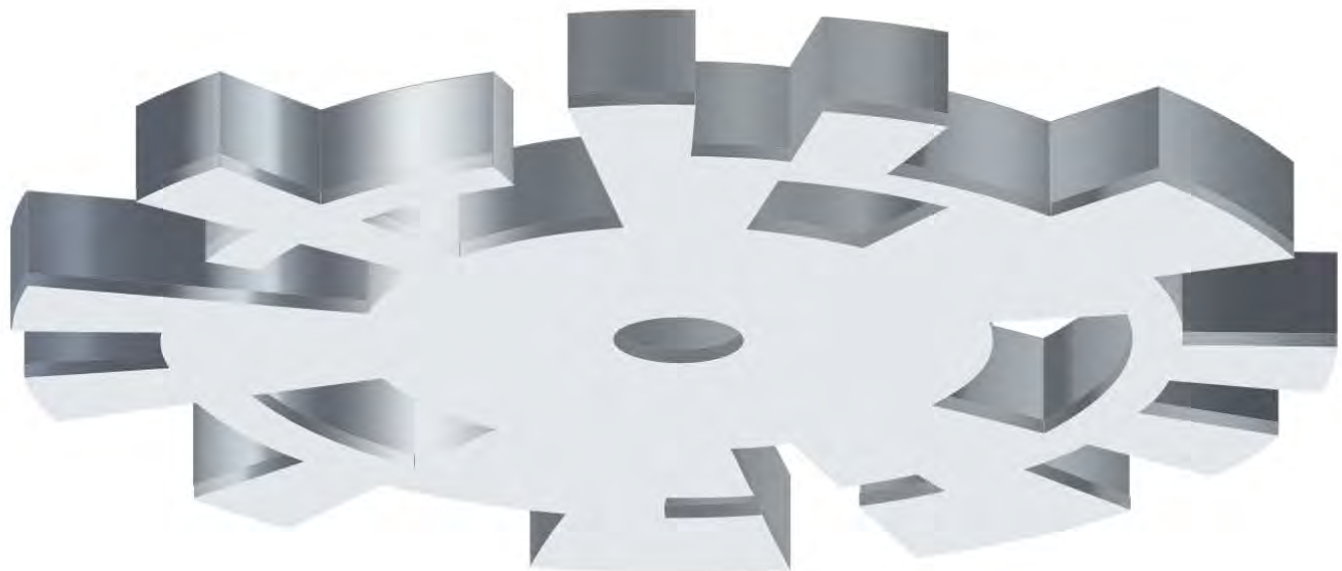
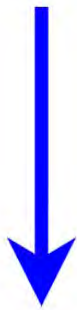
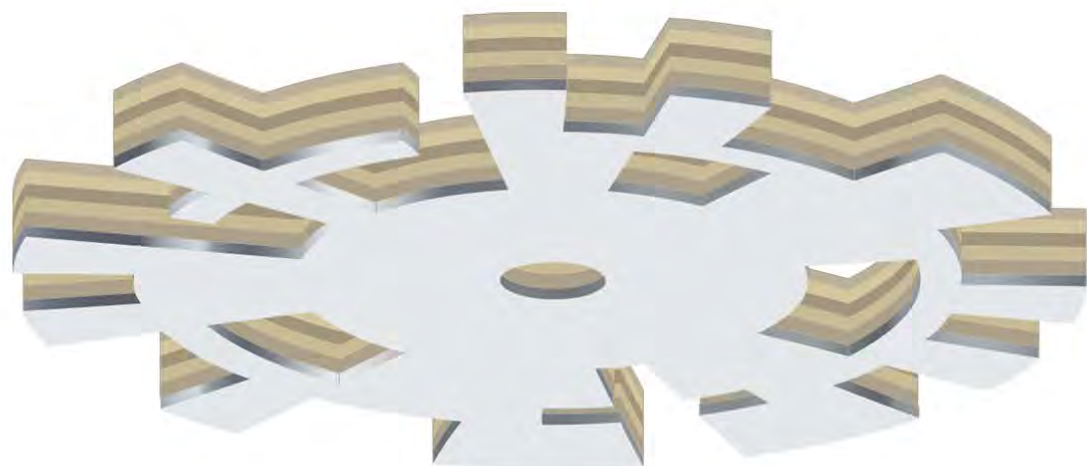

Zinc
Channel

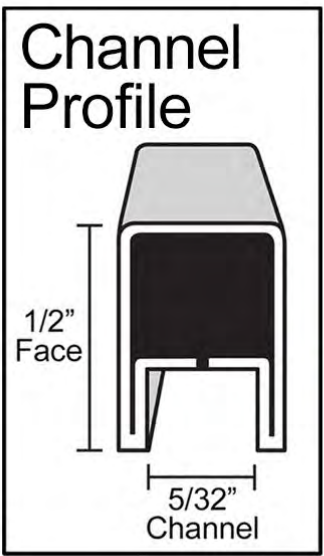

Channel
Profile

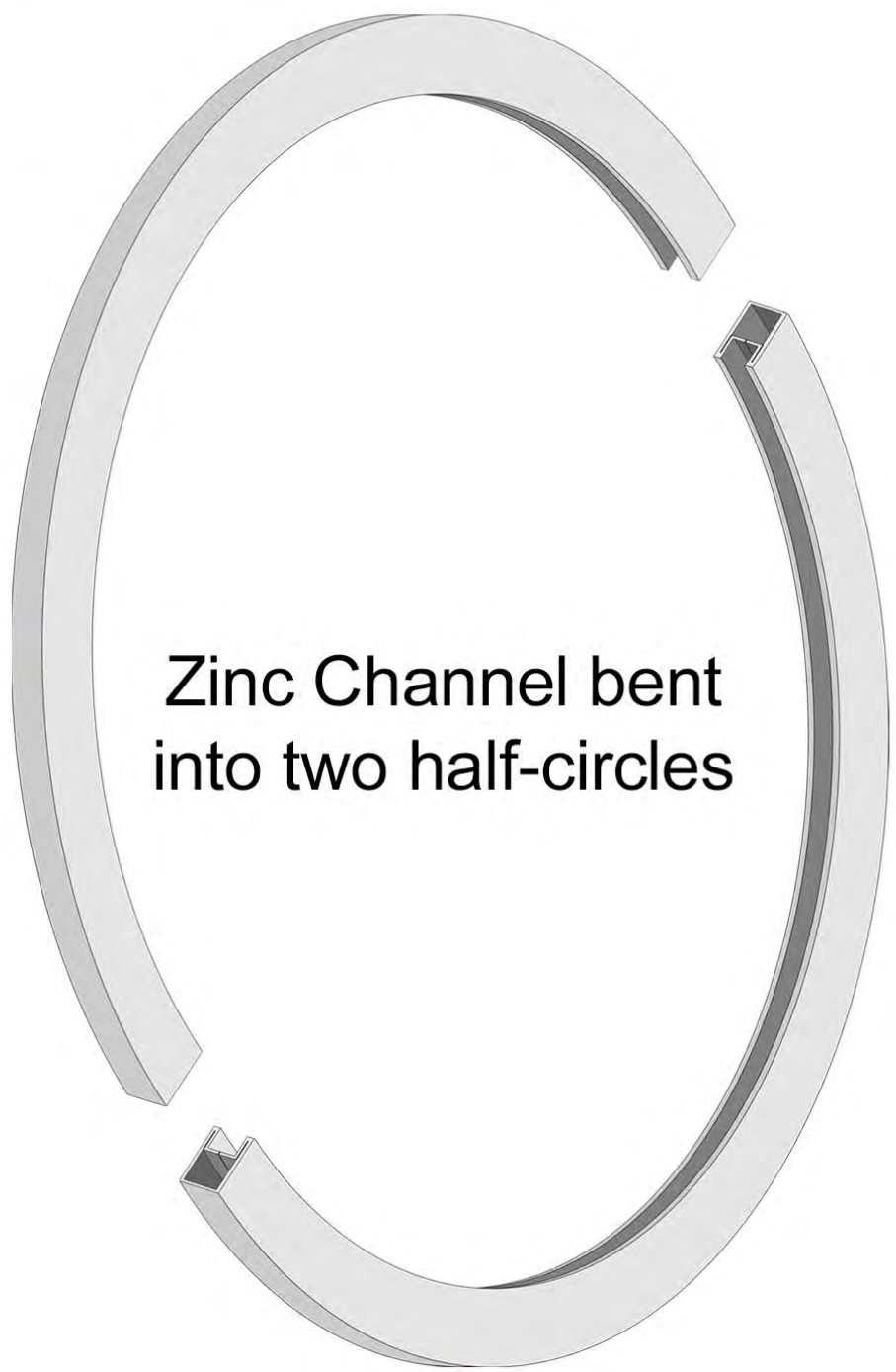

Zinc Channel bent
into two half-circles

+



Dichroic Glass



Two half-circles
soldered together
with eyebolt
installed and
glass inside

Okdeh/Bullock/Studebaker - Barrett Playground;
Fabrication - Mural



Mural drawing numbered for painting



Mural in-progress



Polytab panels awaiting installation

Okdeh/Bullock/Studebaker - Barrett Playground;
Fabrication - Barrett Mosaic Plan



Barrett mural design shown with proposed mosaic areas highlighted

Okdeh/Bullock/Studebaker - Barrett Playground;
Fabrication - Glass Mosaic



Example mosaic
in progress



Okdeh/Bullock/Studebaker - **Barrett Playground;**
Installation - Sculpture; “Ceiling Shadow”

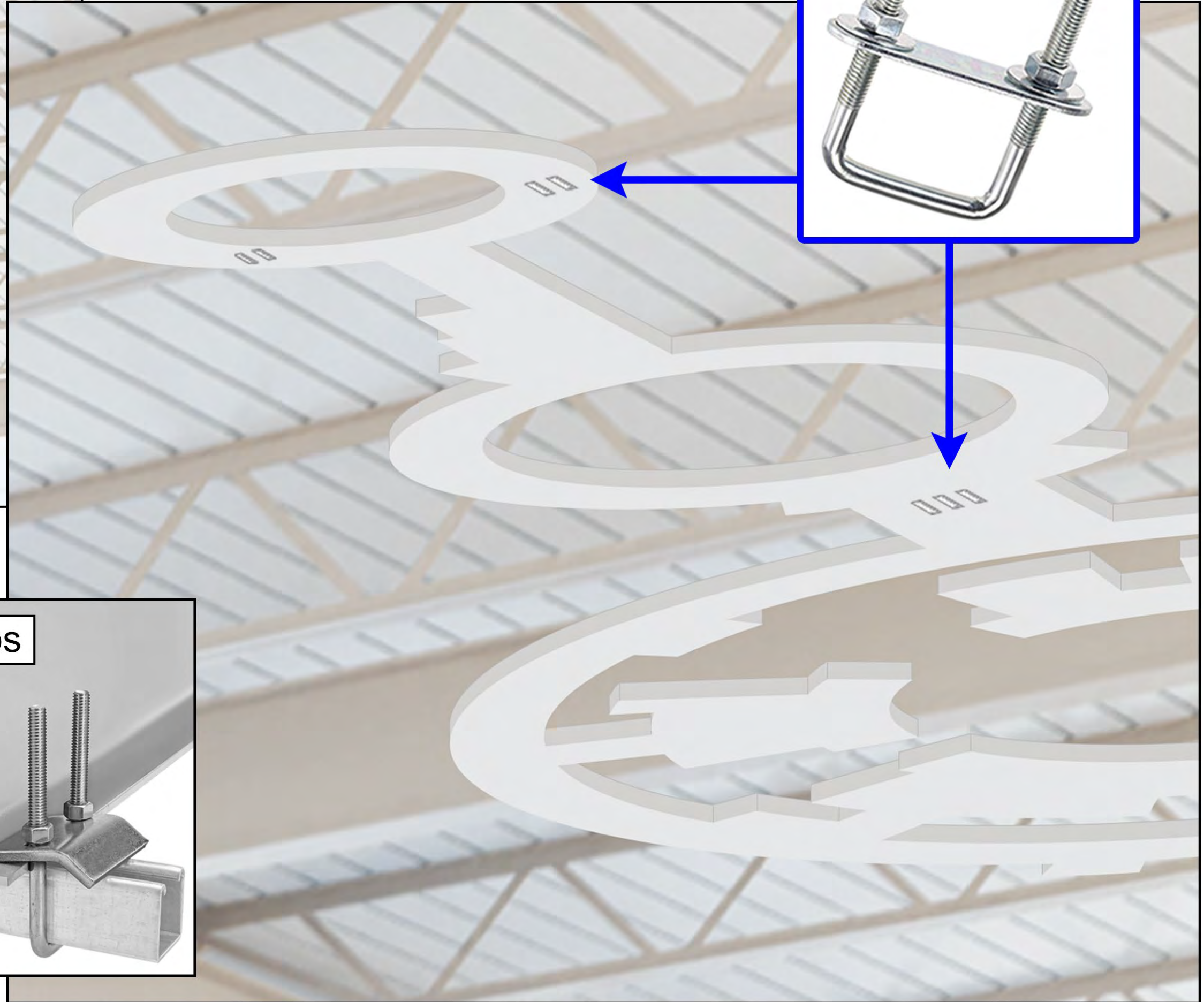
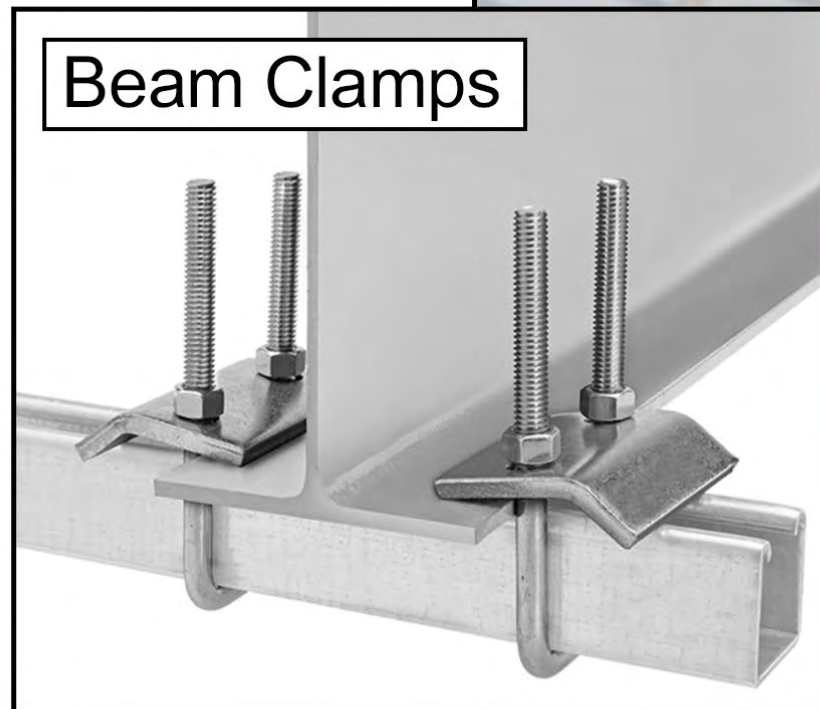
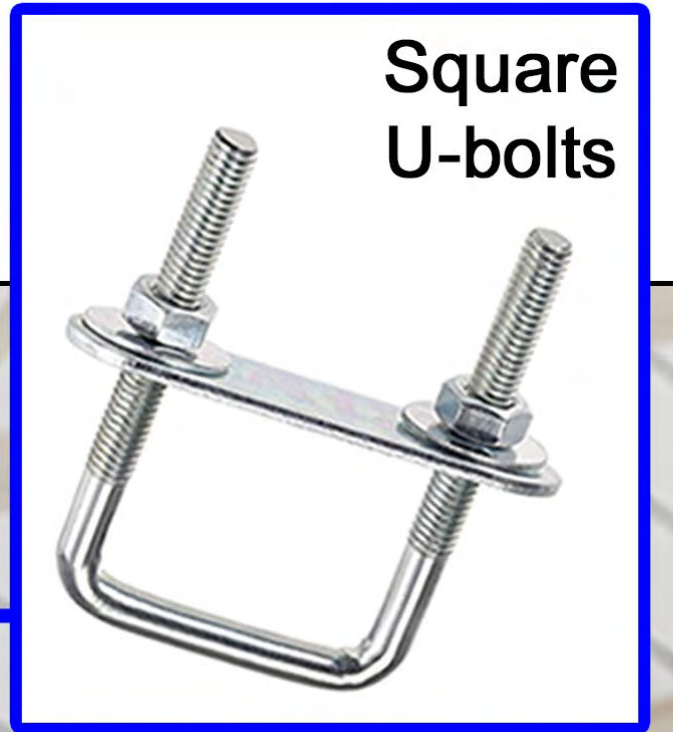

Okdeh/Bullock/Studebaker - Barrett Playground;
Installation - Sculpture; Hanging Hardware

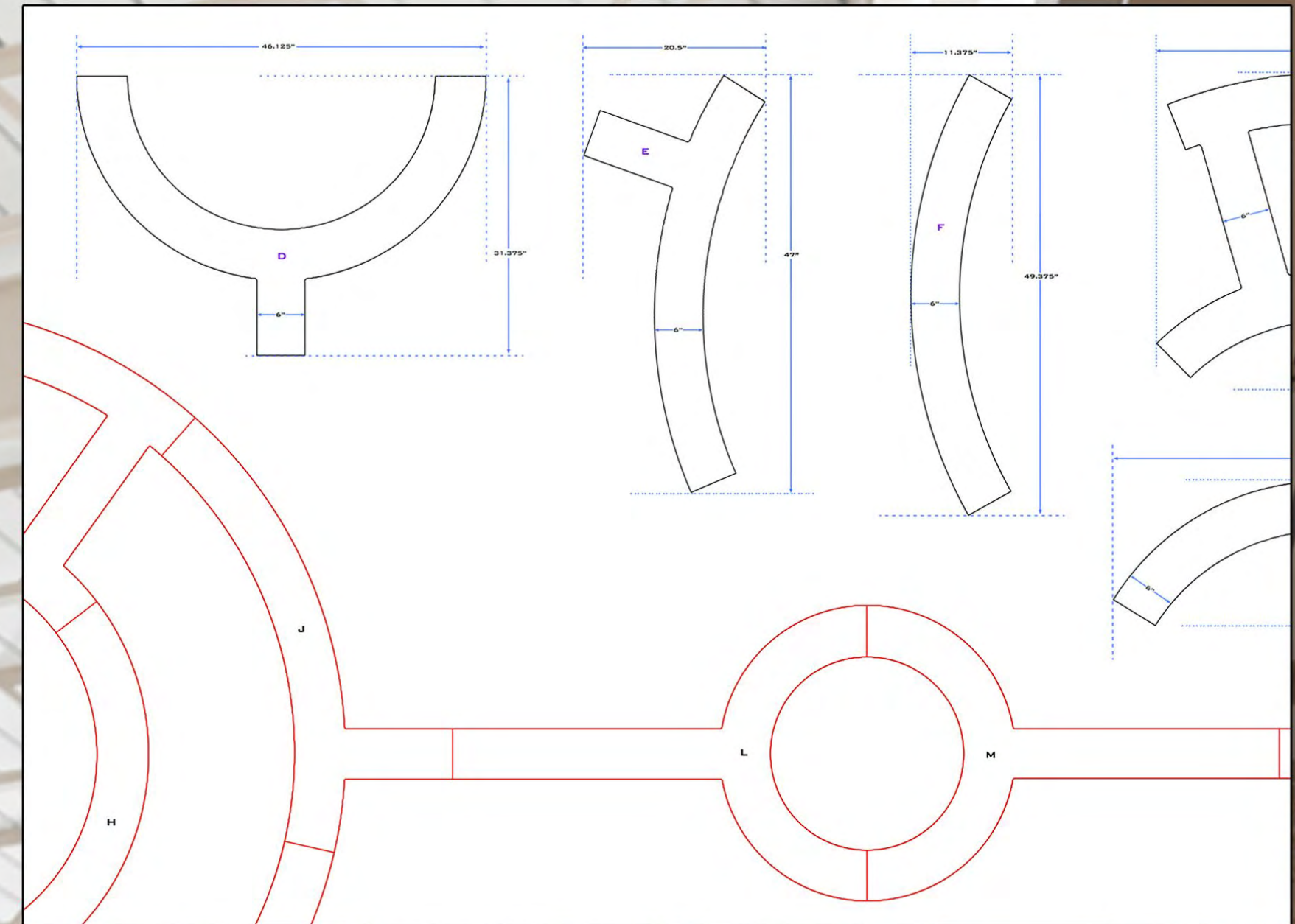

Sculpture will be hung in 8-10
pieces & from 15-20 points

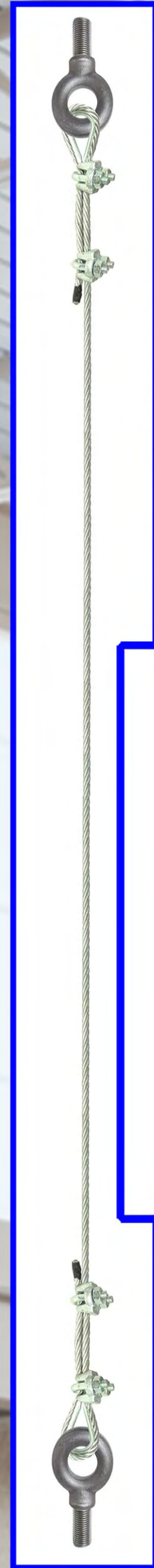

Okdeh/Bullock/Studebaker - **Barrett Playground;**
Installation - Sculpture; Overall View



Okdeh/Bullock/Studebaker - Barrett Playground;
Installation - Mosaic

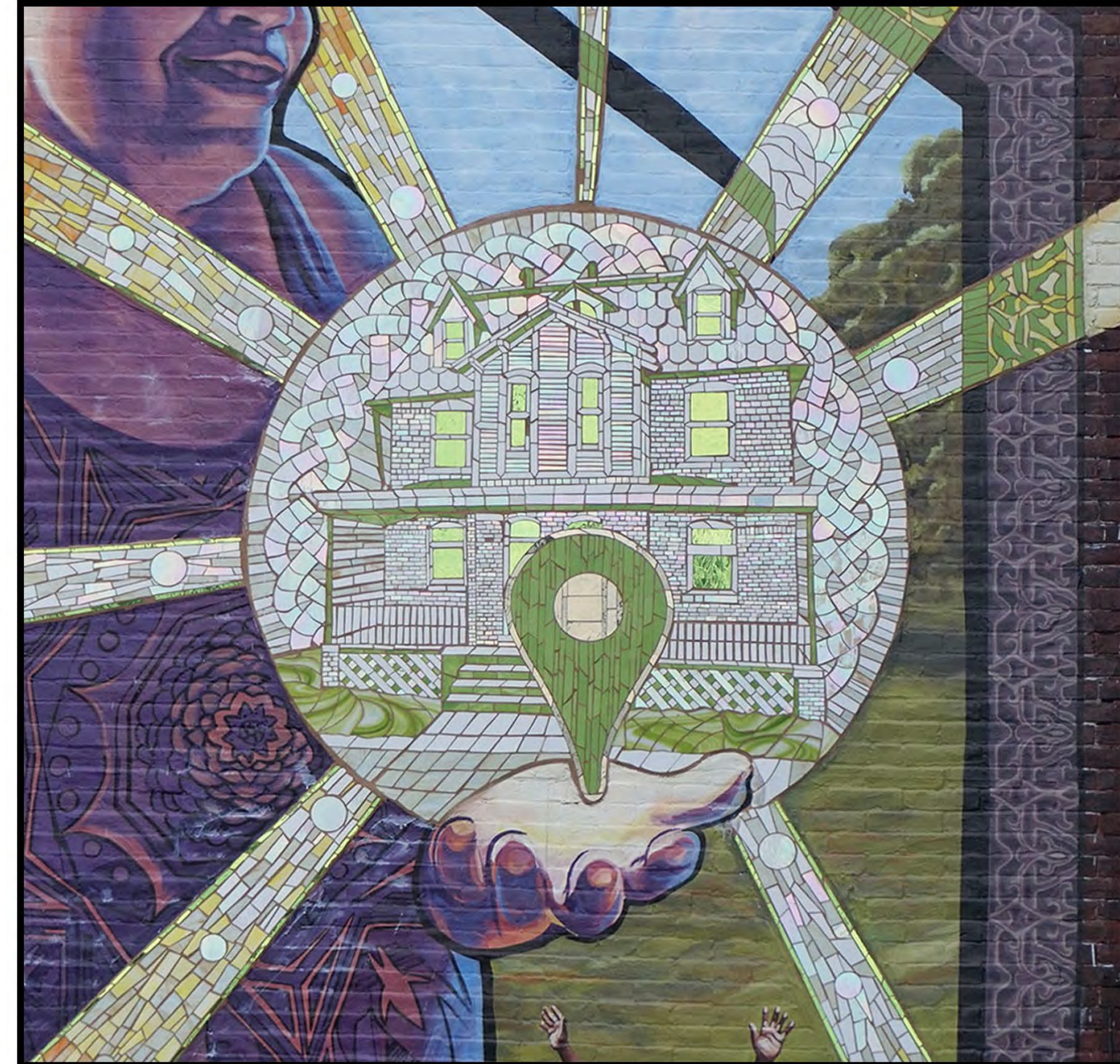
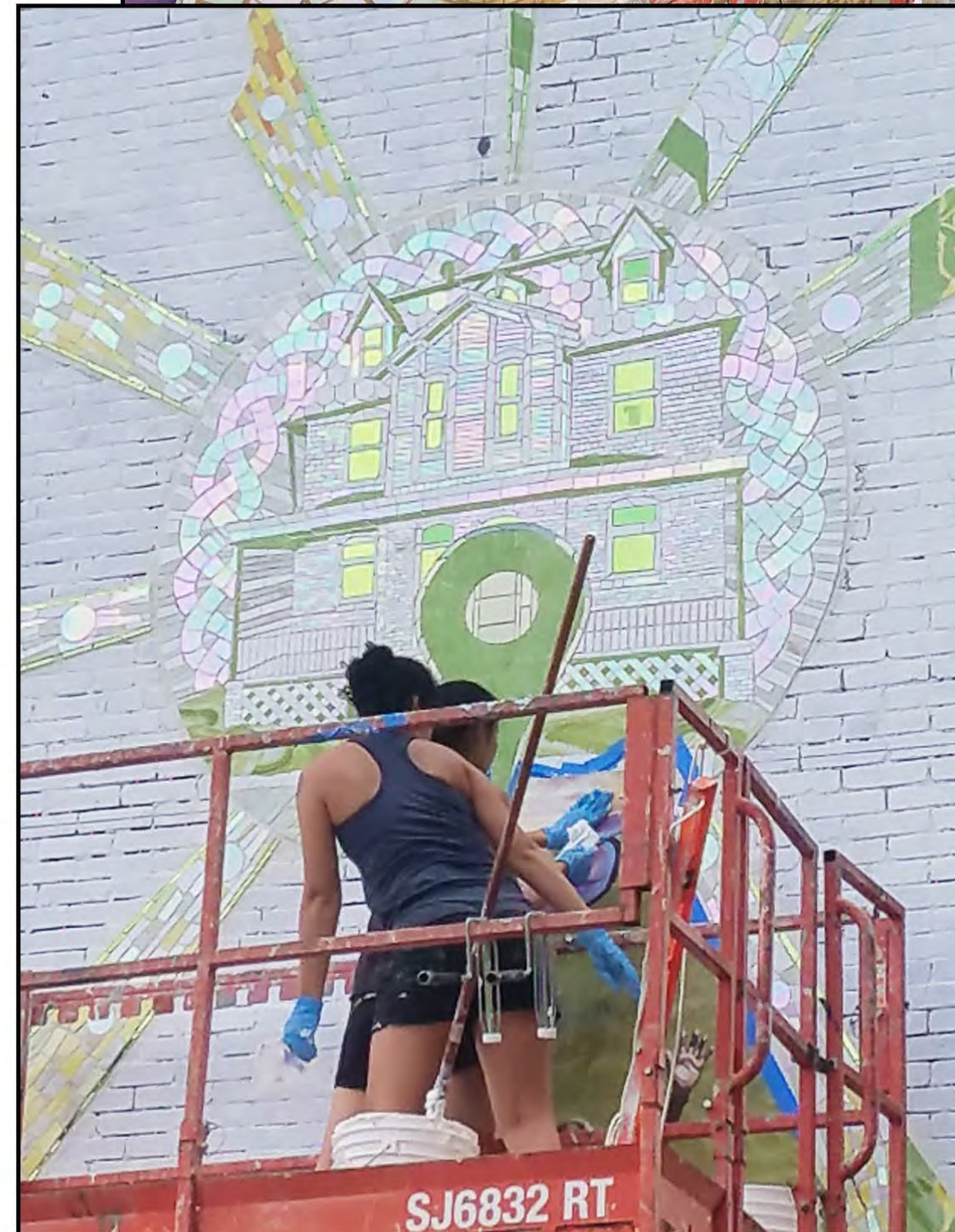
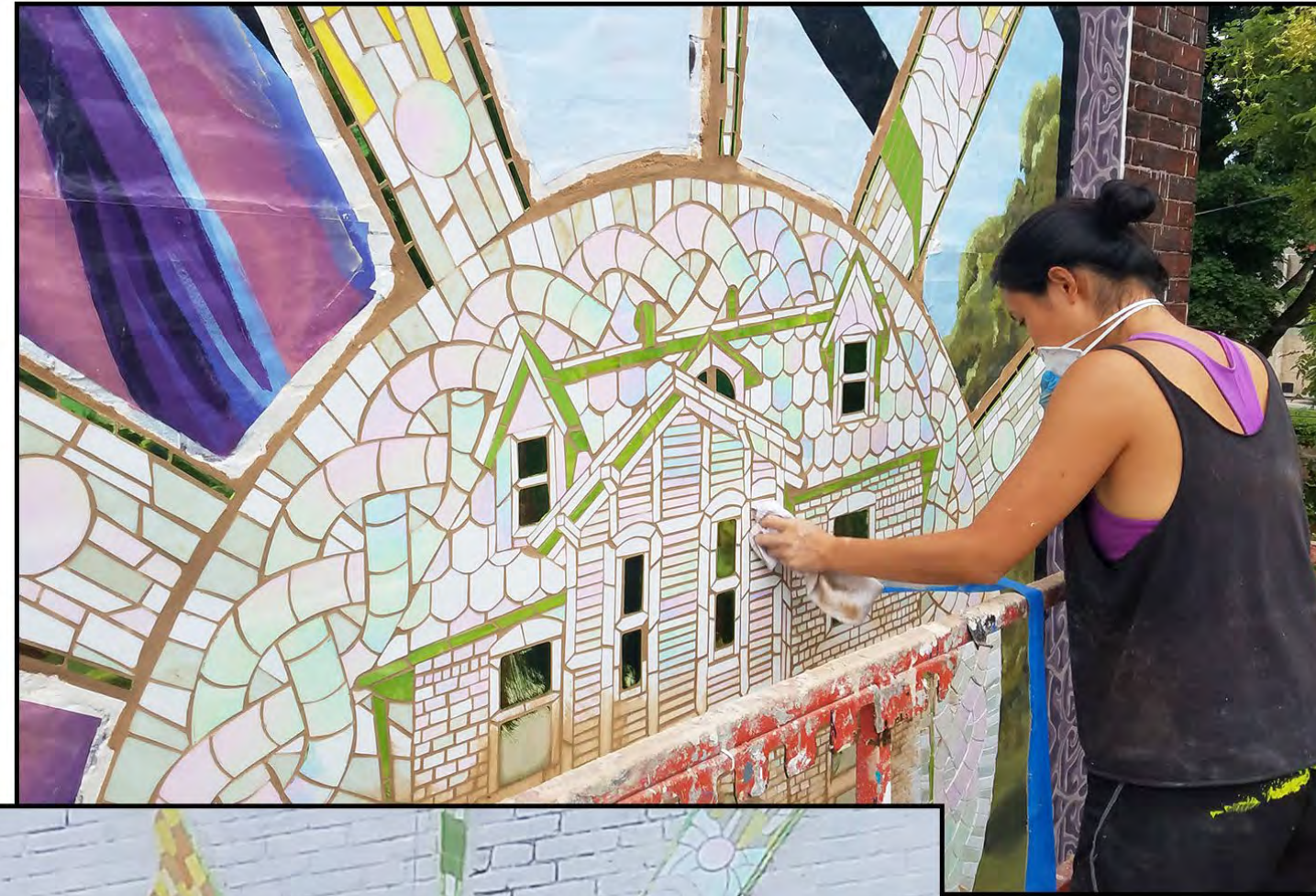



Okdeh/Bullock/Studebaker - Barrett Playground;
Installation - Mural



Mural being painted in-studio,
and installed on-site



Mural installation
in-progress



WORKSHOP 1: Making Gears

To be run near the start of the fabrication phase

Number of participants: 15

Location: TBA

Duration: Three hours

Description:

All materials will be provided.

Participants will design multiple gears using small paper templates, and then transfer their favorite two or three designs to pre-cut foam core circles. The patterns will be cut out by Kathleen or Eric (participants may be able to help cut out their own gears, depending on their age/maturity/experience).

Once the gears are complete, participants can paint them with a variety of metallic paints, and then choose a method of display (construct a little wood stand, free-hanging with a string, or hang on the wall).

Materials Needed:

Paper gear patterns
Foam core (pre-cut into circles)
Pens/pencils
Foam cutter[s]
Metallic paint / brushes
Drop cloths
String
Super glue & Elmer's glue
Pre-cut pieces of wood for stands

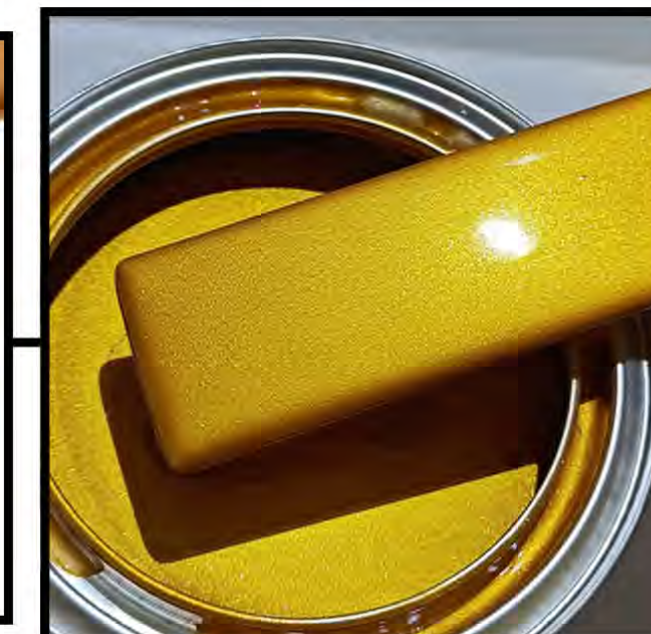
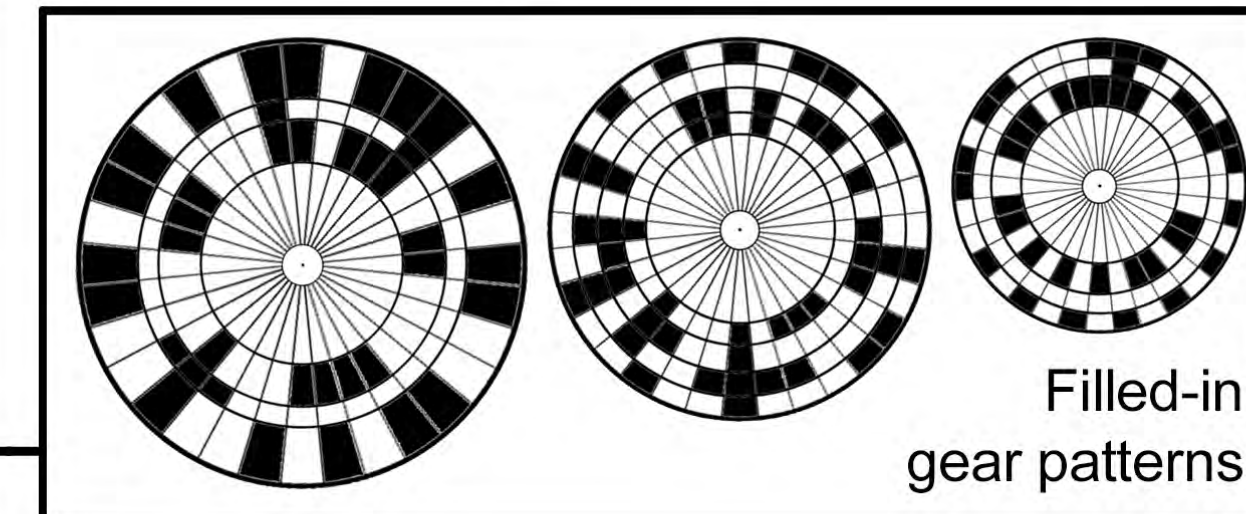
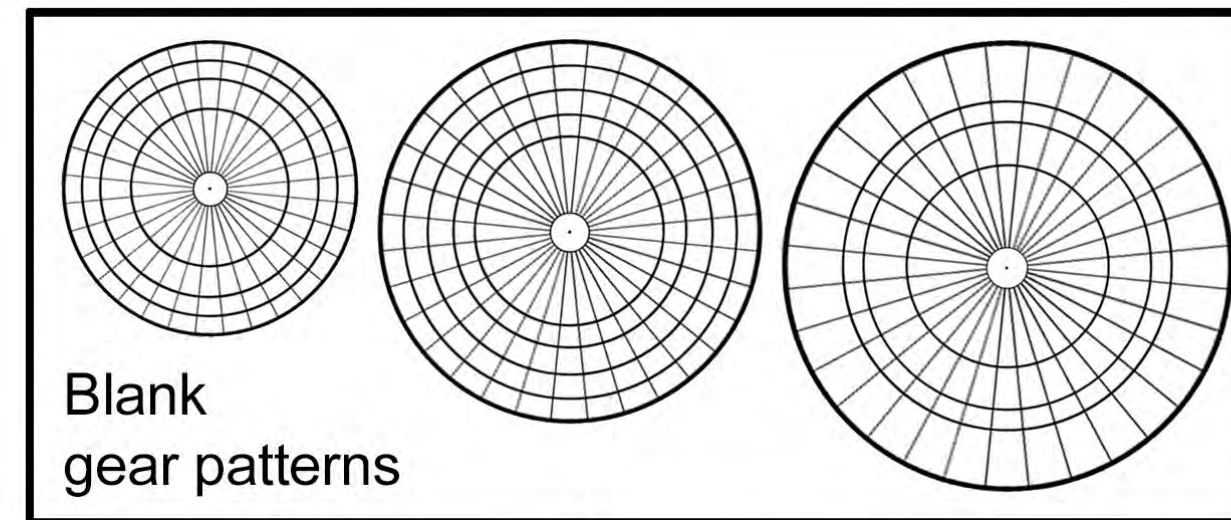

WORKSHOP 2: Sculpture/Building Painting

To be run two-three months into the fabrication phase

Number of participants: Part 1: Variable [open]
Part 2: 10

Location: TBA

Duration: Four hours

Description:

There will be two components to this workshop:

- 1] An open invitation for people from the community to drop in and help paint the buildings that will be in the sculpture. All materials will be provided, and the painting will be done in a paint-by-numbers fashion.
- 2] Small plywood versions of the various building parts-and-pieces will be available for participants to paint and construct their own building, to be taken with them when they are complete.

*These supplies will be limited to approx 10 participants



Materials Needed:

Many colors of paint
Paint brushes
Drop cloths
Plywood building pieces
[sculpture]
Plywood building pieces
[small; take-home]
Wood glue



Materials Needed:

Spray Cans
Variety of Nozzles
Acetone for Cleaning
Primed Masonite Panels

WORKSHOP 3: Working with Spraypaint

To be run at any point during the mural's fabrication

Number of participants: 15

Location: TBA

Duration: Three hours

Description:

Participants will be given a spray paint tutorial on plywood which will cover:
How to blend tones, difference in spray nozzles,
wrist movements, can proximity, linework, fading, blending, and spray can safety.

Once the tutorial is complete, Participants will create thier own individual 2'x2' panels with the spraypaint and nozzles available.



WORKSHOP 4: Creating a Mural

To be run at any point during the mural's fabrication

Number of participants: 15

Location: TBA

Duration: Three hours

Description:

- Learn how to brainstorm and design elements of a mural.
- Definition of a Mural: Understanding what constitutes a mural.
- Finding a Mural Location: Strategies for identifying ideal locations for murals.
- Crafting a Strong Mural Recipe: Key elements that make a mural effective.
- Symbolism in Storytelling: Using symbols to convey messages and tell stories.
- Reflection and Community Building: How murals can reflect and build community.

After completing the workshop tasks, create a drawing using your mural recipe to tell a story about hope for your community.

Materials Needed:

Sketchbooks
Pencils
Pens
Markers/ Watercolors/ Pastels



WORKSHOP 5: Mosaic Making

To be run before the murals Fabrication

Number of participants: 10 (15 years and Up)

Location: TBA

Duration: Three hours

Description:

Participants will learn the basics of glass cutting and mosaic making. They will be introduced to the tools and materials needed and how to safely use them. The class starts with a lesson teaching basic cuts on scrap glass, and the day ends with all participants walking away with their own 8"x8" mosaic piece mounted on hardibacker board. Participants will also learn how to cut circular Dichroic stars for the Barrett Playground Mosaic.

The lessons in this workshop go beyond artmaking, as they effectively teach one how to cut and lay tile as well. The skills learned here easily translate to backsplashes and tile walls in the home.

Materials Needed:

Glass
Glass Pliers
Scoring Tools
Grinder
Safety Goggles/Gloves
Markers
Transparency Paper
Thinset
Tile Trowel



WORKSHOP 6: Stained Glass Windows (Copper Foil)

To be run before the mural's fabrication

Number of participants: 10 (15 Years and Up)

Location: TBA

Duration: Three hours

Description:

Taking inspiration from the colorful dichroic glass reflections in our Barrett mural, community participants will learn how to cut and assemble hangable 8" stained glass windows. Participants will learn how to wrap cut glass in copper foil, and how to use flux to help solder their artworks together, creating a colorful stained glass window.

Participants walk away with thier very own
hangable reflective 8" stained glass window

Materials Needed:

Glass
Glass Tools
Foil Tape
Flux
Solder
Soldering Iron
Safety Equipment



WORKSHOP 7: Barrett Mural Paint Days

To be run before the mural's fabrication

Number of participants: 30

Location: TBA

Duration: Three hours

Description:

These two 3 hour sessions will be the opportunity for the Logan community to participate in the painting of the Barrett Playground mural. The design will be drawn and numbered by color on polytab cloth, enabling anyone ● regardless of age and skill level to have a hand in painting the actual mural. Our team members will be on hand to facilitate these events, after which the panels will be taken ● to our studios for final touches.

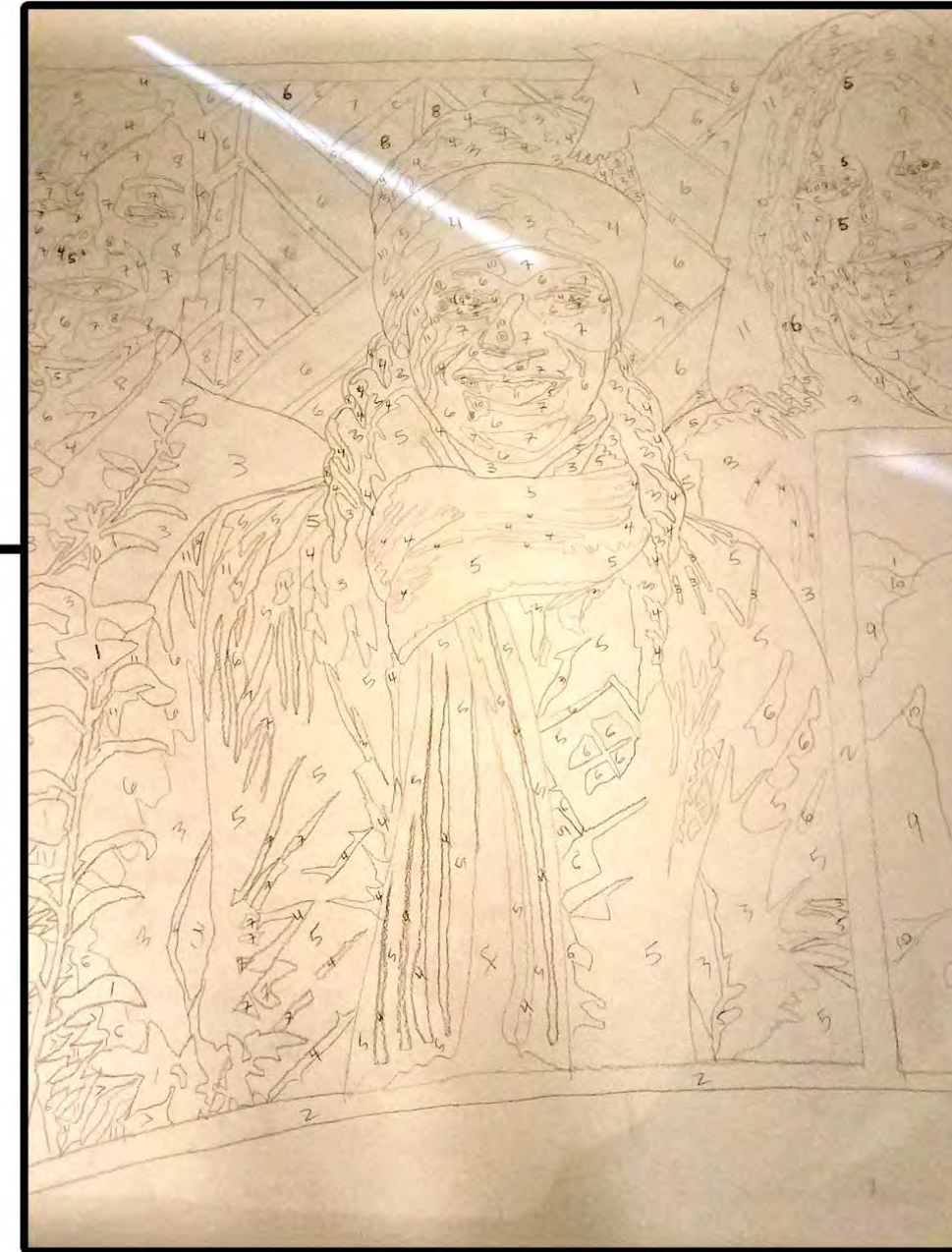

Materials Needed:
Mural Drawn Polytab
Mixed Paint
Brushes

Sculpture Maintenance:

*Aluminum & painted surfaces will be sealed (unlikely to require any regular maintenance)

- 1] Visual inspection of the hanging hardware - 1x /year
(if obvious problems are noted, the artist can be contacted to make repairs)
- 2] Dusting of stars & upward-facing surfaces (tops of the gears etc.) - 1x /3-5 years
- 3] Dusting of hollow interior of aluminum sculpture - 1x /10 years
(interior will be blocked off by screen material, easily removed)

Materials & Qualities:			
*All materials are highly durable, not subject to rust, warping, or deterioration over time			
*Weights are approximate and include hanging hardware			
<u>Main Body of Sculpture:</u> Weight: 475lbs Made of: 1] Aluminum 2] Plywood 3] Water-based polyurethane 4] Stainless steel & zinc-plated hardware	<u>Buildings:</u> Weight: 90lbs Made of: 1] Plywood 2] Acrylic paint 3] Water-based polyurethane 4] Stainless steel & zinc-plated hardware	<u>Gears:</u> Weight: 35lbs Made of: 1] Aluminum 2] Plywood 3] Water-based polyurethane 4] Stainless steel & zinc-plated hardware	<u>Stars:</u> Weight: 30lbs Made of: 1] Dichroic glass 2] Zinc 3] Stainless steel & zinc-plated hardware

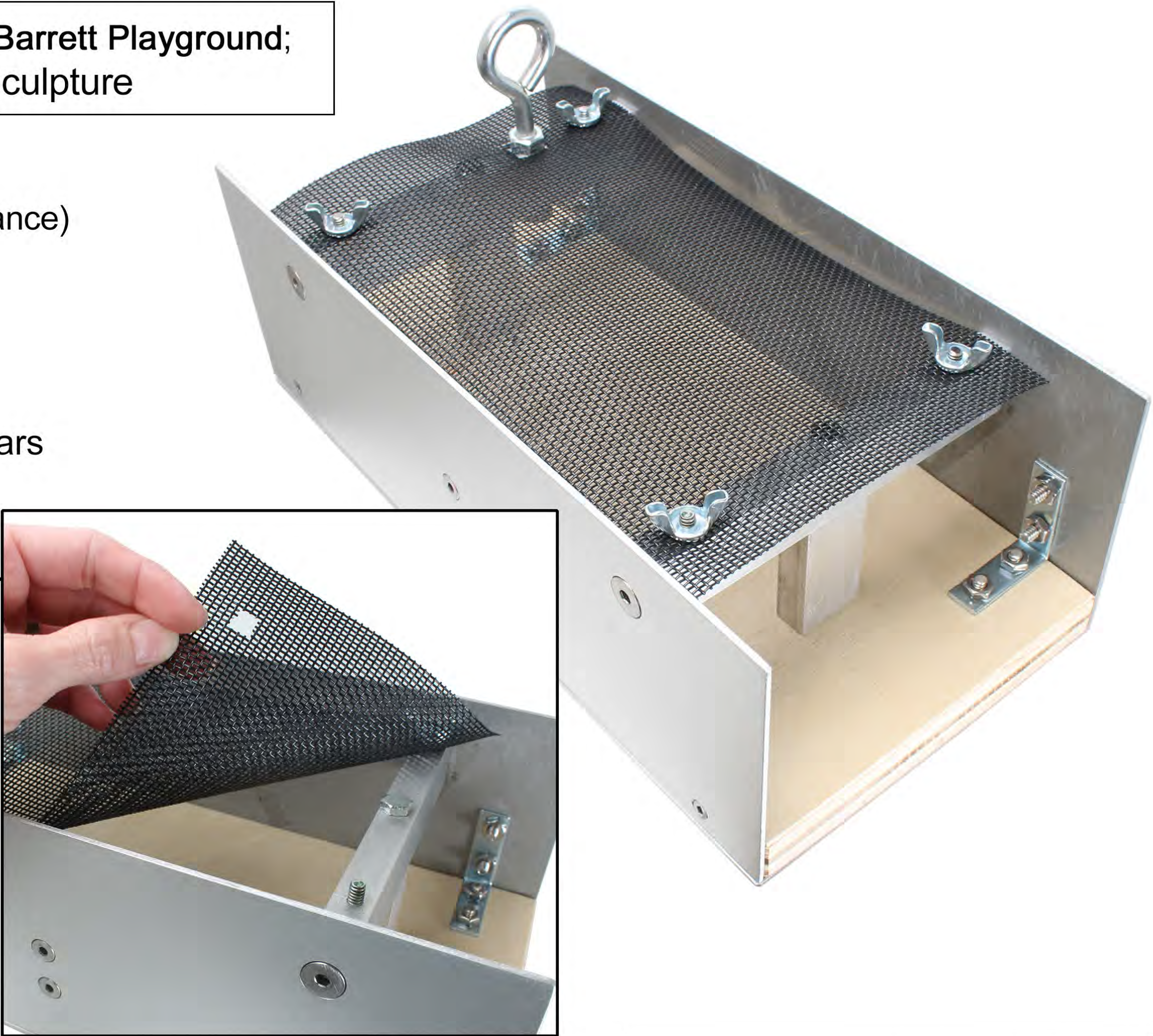

Vandalism:

- If necessary: visible surfaces can be wiped down with wet cloth or mild cleaner
- In the event of significant damage, the artist can make needed repairs

Mural and Mosaic Maintenance

The mural and mosaic will be well sealed (3 times), and conservation requires no more than wiping down the surface with a damp cloth annually or as needed. If there are instances of Graffiti or vandalism, the artists can make the necessary repairs to the work.

All design imagery and color swatches are kept on file indefinitely for such instances.



Project Budget

\$135,000 total project budget, to be allocated:

Artist fee (18%)	24,300
Assistant Labor Fees	16,000
Artist Lead Community Workshops	7,000
Mural Materials (Spray/Acrylic)	9,000
Mosaic Materials/ Dichroic Glass	6,000
Sculpture Materials	24,200
Fabrication	7,550
Site Preparation	300
Lighting costs	7,280
Installation	7,700
Shipping	1,620
Travel	4,700
Engineering Costs	1,500
Insurance (1%)	1,350
Contingency (10%)	13,500
Plaque Fabrication and Installation	3,000



PROJECTED TIME SCHEDULE:

*NOTE: This schedule refers to the sculpture only

Schedule start date is concurrent with execution of the contract

Research:

FOUR WEEKS

Construction/Technical Drawings:

SIX WEEKS

- Kathleen to produce final DMX files for 3rd party fabrication shops ●
- Kathleen to finalize plans for construction of buildings ●
- Engineers to sign off

Fabrication:

FIVE MONTHS:

- Two month lead time for laser/CNC shops ●
- Five months in-studio fabrication (runs concurrently with shop lead time)

Installation:

TWO WEEKS (14 days)

- Day 1: Transport & unload all parts & pieces (including lift)
- Day 2-3: Instal “shadow” sculpture on ceiling
- Day 4-8: Instal & assemble main sculpture in 8-10 parts
- Day 9-10: Instal & attach buildings
- Day 11-12: Instal & attach gears
- Day 13-14: Hang stars

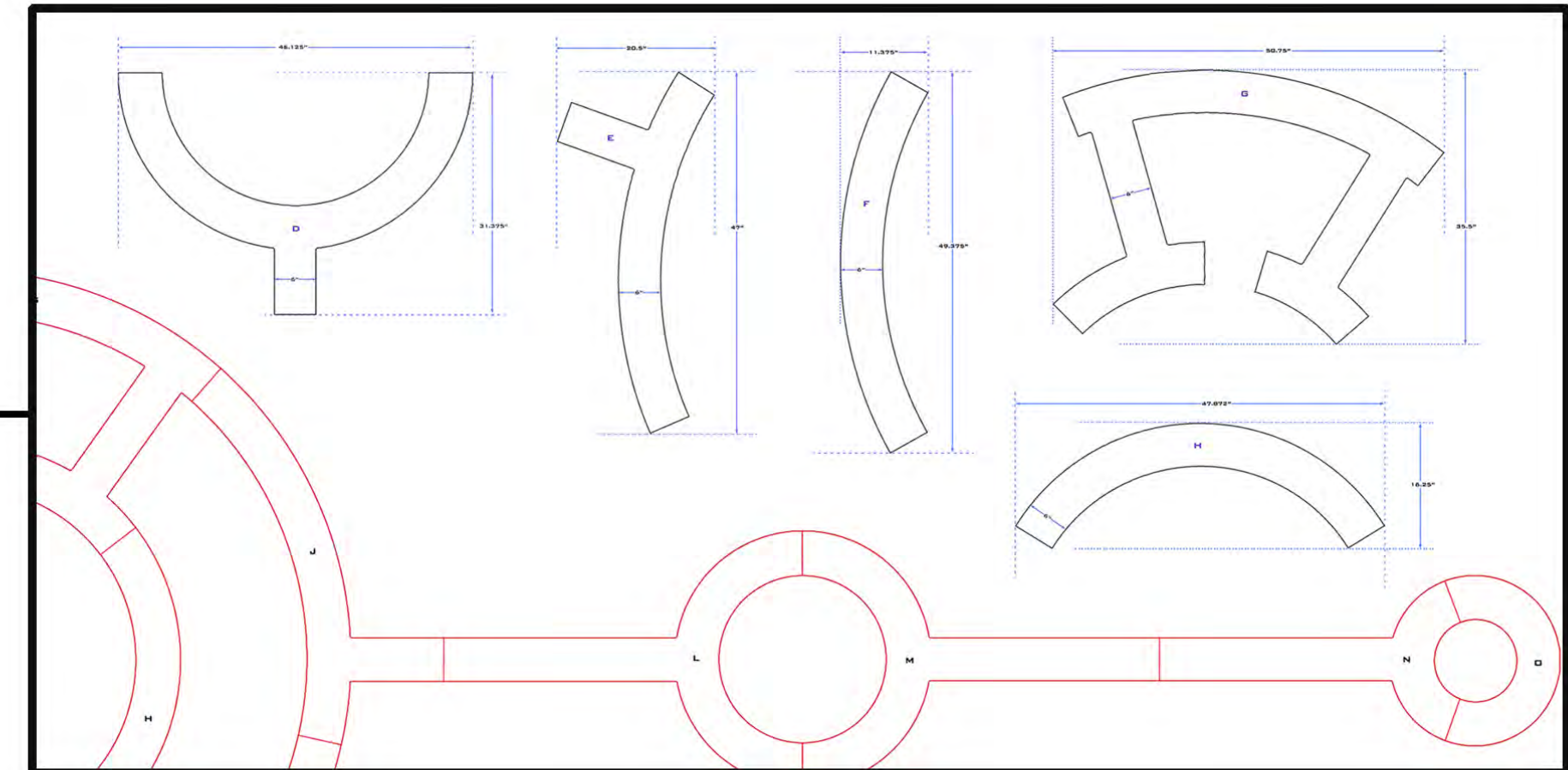

PROJECTED TIME SCHEDULE

*NOTE: This schedule refers to the mural/mosaic only

Research:
FOUR WEEKS

Workshops:
SIX WEEKS
-Portions of the mural sculpture/painting/mosaic to be worked on
by community participants

Fabrication:
TWO MONTHS:
-Mural on polytab to be touched up and finalized in studios
-Mosaic Glass to be cut and readied for install

Installation:
TWO WEEKS:
-Mosaic elements to be installed first
-Remaining wall primed/ prepped/ gridded
-Polytab mural install
-Touch ups
-Mural/Mosaic Sealing



R-LINE® SPOT 2.0



TYPE T1F, T1S



CERTIFICATIONS & COMPLIANCE



FEATURES

5 YEAR
limited
led warranty

CONFIGURATIONS

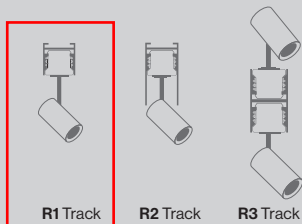

SPOT 2.0

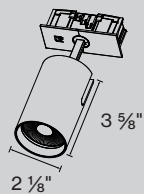

BEAM ANGLE

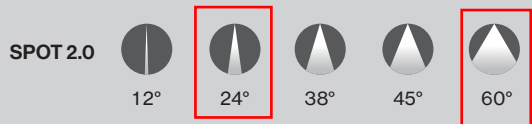

COLORS



Catalog Number Example

RLINS-SPOT2.0-BLBL-30K-C90-48V-010V-45D-500LM-8W

A B C D E F H I

A SYSTEM

R-LINE R L I N S

B PRODUCT

Spot 2.0 S P O T 2 . 0

C COLOR HEAD

Black RAL9005 B L
White RAL9016 WH
Bronze Anodized B Z
Custom RAL X X
custom RAL, please contact BASO

ADAPTER COLOR sub option

Black B L
White WH
recommendation: adapter & track color should match

D CCT/CRI

2700K /CRI>90 2 7 K - C 9 0
3000K /CRI>90 3 0 K - C 9 0
3500K /CRI>90 3 5 K - C 9 0
4000K /CRI>90 4 0 K - C 9 0

E VOLTAGE

48V low constant voltage 4 8 V
remote driver required (see driver cutsheet)

F DIMMING

0-10V 1% dimming 0 1 0 V

G CIRCUIT

1 or 2 Circuit *
compatible with 1 or 2 track (see driver cutsheet)
*leave blank

H BEAM ANGLE Spot 2.0

12° spot 1 2 D
24° medium 2 4 D
38° flood 3 8 D
45° wide flood 4 5 D
60° ultra wide flood 6 0 D

I OUTPUT SPOT 2.0

1000 lm 10W 1 0 0 0 LM - 10W
1500 lm 20W 1 5 0 0 LM - 20W
2000 lm 24W 2 0 0 0 LM - 24W

Accessories

ships pre-assembled

J FILTER

No Filter *
Hex Louver H L
Solite Filter S F
*leave blank

K SNOOT

Standard Short Snoot *
Anti Glare Snoot 1" S N
*leave blank

Optional Accessories

ships separately

L ADAPTER COVER

ship standard with straight cover (field changeable)

Curved R18" R 1 8
Curved R24" R 2 4
Curved R36" R 3 6
Straight S T R

M LENS

Set Extra Lenses all beam spreads E X

Other Options

+ LINEAR OPAL

see R-Line Linear cutsheet

+ CURVE OPAL

see R-Line Curve Opal cutsheet

+ LOUVER

see R-Line Louver cutsheet

BASO
basolighting.com

CS-V01

01/2025

DIMENSIONS

SPOT 2.0

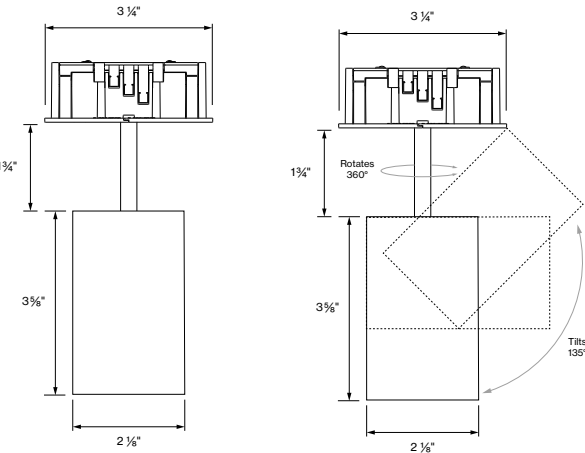

OPTIONS

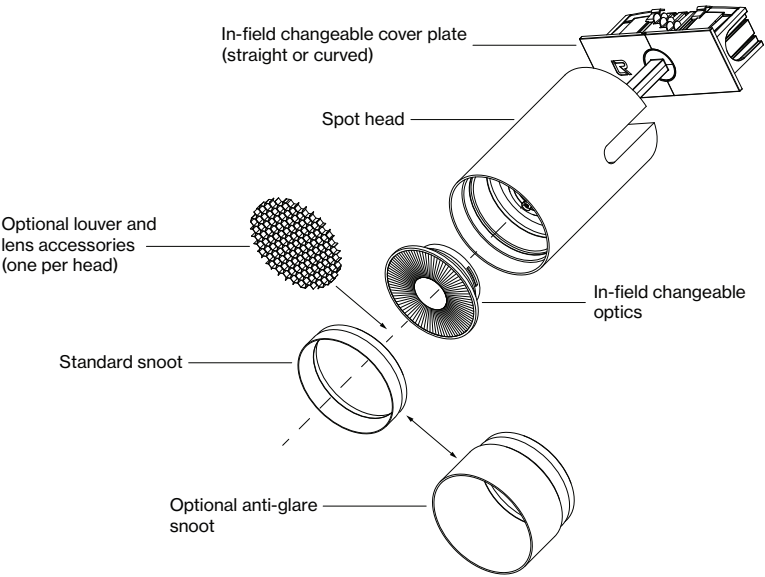

Declare.

R-LINE SPOT
BASO Inc.

Final Assembly: Oxford, Connecticut, USA
Life Expectancy: 7 Year(s)
End of Life Options: Recyclable (80%), Landfill (20%)

Ingredients:

Aluminum; Small electrical components; Zinc; Steel
manufacture, chemicals; Copper

¹LBC Temp Exception RL-002 - Small Electrical Components

Living Building Challenge Criteria: Compliant

I-13 Red List:

☐ LBC Red List Free % Disclosed: 100% at 100ppm
☒ LBC Red List Approved VOC Content: Not Applicable
☐ Declared

I-10 Interior Performance: Not Applicable
I-14 Responsible Sourcing: Not Applicable

BAS-0004
EXP. 01 AUG 2025
Original Issue Date: 2024

FOR MORE INFORMATION, VISIT www.livingfuture.org/declare
INTERNATIONAL LIVING FUTURE INSTITUTE™ [livingfuture.org/declare](https://www.livingfuture.org/declare)

R-LINE[®] TRACK



TYPE T24

Catalog Number Example

RLTR-R1-PDT-BLBL-48V-010V-1C-ST-02'

A B C D E F G I

A PRODUCT

R1 Track 1" track	R L T R-R 1
R2 Track 2" track	R L T R-R 2
R3 Track H track	R L T R-R 3
R3 track is only available as a pendant	

B MOUNTING

Recessed Trimless	R T L
Surface Mount	S U R
Pendant Cable	P D T
Pendant Stem coming soon	S T M
Custom Mount	X X X
custom mount, please contact BASO	

C HOUSING COLOR

Black RAL9005	B L
White RAL9016	W H
Custom RAL	X X
custom RAL, please contact BASO	

PENDANT HARDWARE COLOR

sub option: pendant cable or stem only

Black	B L
White	W H
None recessed or surface mount	
power feed, stem & canopy cover only; AC cable & barrel mount come in silver	

D VOLTAGE

48V low constant voltage	4 8 V
remote driver required (see driver cutsheet)	

E DIMMING

0-10V 1% dimming	0 1 0 V
------------------	---------

F CIRCUIT

1 Circuit 2x48V 1xPWM	1 C
2 Circuit 4x48V 2xPWM	2 C
4 Circuit 8x48V 4xPWM	4 C
4 circuit R3 track only; for EMC contact BASO	

G SHAPE/PATTERN

Linear	S T
L-Shape (90°)	L S
□-Shape rectangular shape (90°)	R S
U-Shape (90°)	U S
Z-Shape (90°)	Z S
Wall to Ceiling (90°)	W C
Custom Pattern	C P
custom angles and patterns, please contact BASO	

H CORNERS

No Corners	*
Mitered 90°	M 9 0
Curved Radius 18"/90°	R 1 8
Curved Radius 24"/90°	R 2 4
Curved Radius 36"/90°	R 3 6
Custom	X X
custom radius and angles, please contact BASO	
*leave empty	

I DIMENSIONS

2' 0" min. length	0 2'
4' 0"	0 4'
6' 0"	0 6'
8' 0"	0 8'
Shape / Pattern	x x x x
Custom	
custom patterns, please contact BASO	

J FIELD CUT

Field Cuttable Track	F
please see next page for limitations	

K CCEA (optional)

CCEA Rated (Chicago Plenum)	C P
recessed and surface mount only	

Optional Accessories

ships separately

L BLIND COVERS

Blind Cover 1" flush with R1 track	B 1
includes field cuttable blind cover (end to end)	

+ TRACK WITH UPLIGHT

see R-Line Uplight cutsheet

CERTIFICATIONS & COMPLIANCE



FEATURES

5 YEAR
limited
led warranty

CHANNEL

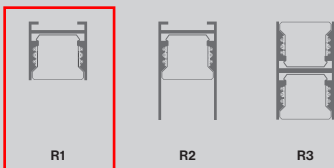

PERFORMANCE

- Modular 48V track system
- Combine linear, curve, and track
- Patented technology
- Field cuttable track

CONFIGURATIONS

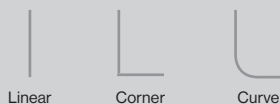

MOUNTING

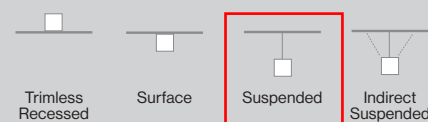

INSET OPTIONS

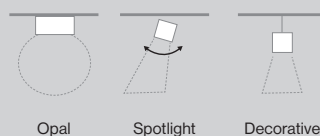

BASO
basolighting.com

CS-V01

01/2025

DIMENSIONS

R1

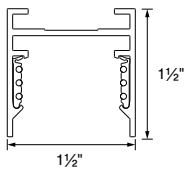

R1 (Recessed Trimless)

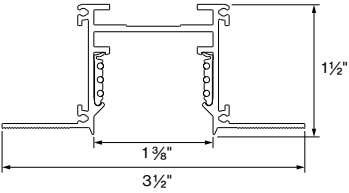

R2

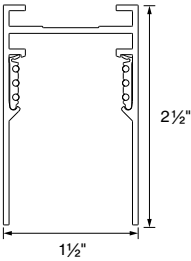

R3

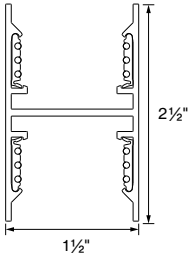

R2 (Recessed Trimless)

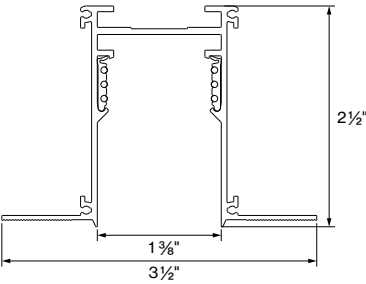

POWER FEED

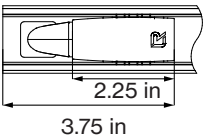

Insets cannot be placed on top of power feeds and electrical connectors.

ELECTRICAL CONNECTOR

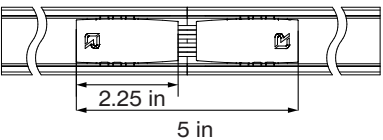

ELECTRICAL CONNECTOR

L-Configuration

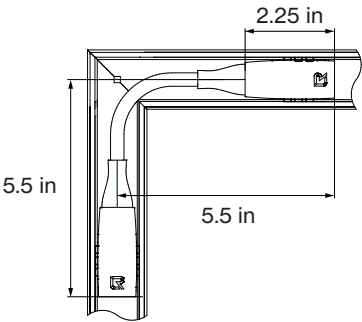

ELECTRICAL CONNECTOR

X-Configuration

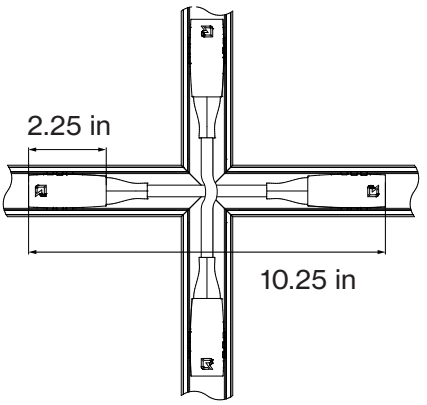
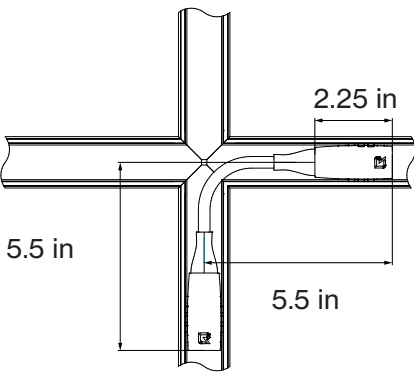
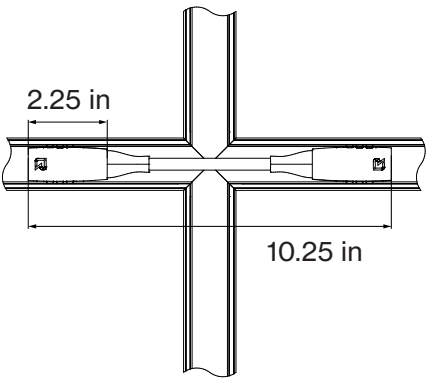



The Day-Brite / CFI HCY sealed high bay is an ideal choice where functional high bay lighting is needed with an aesthetic appeal. The round form factor lends itself to retail and institutional applications.



Project: _____
Location: _____
Cat.No: _____
Type: _____
Qty: _____
Notes: _____

Ordering guide

Example: HCY0823L8CST-UN3-DIM

Series	Lumens ¹ (nominal)	Color (CRI/CCT)	Voltage	Voltage	Finish
HCY		8CST	UN3	DIM	
HCY Round High Bay LED dual select	0823L 8,000/14,000/23,000lm 2437L 24,000/32,000/37,000lm	8CST 80 CRI, Color Select (3500/4000/5000K)	UN3 Universal voltage 120-347V	DIM 0-10v dimming	BK Black WH White

1. Nominal delivered lumens at 25°C ambient.

Note: Many luminaire components, such as reflectors, lenses, sockets, lampholders, and LEDs are made from various types of plastics which can be adversely affected by airborne contaminants. If sulfur based chemicals, petroleum based products, cleaning solutions, or other contaminants are expected in the intended area of use, consult factory for compatibility.

Accessories (order separately)

Cat Code	Description
HCY-SURFACE BKT SM	Surface mount bracket for HCY0823L
HCY-SURFACE BKT LG	Surface mount bracket for HCY2437L
HCY3-PRSM	Clear polycarbonate reflector for HCY0823L
HCY3-PRLG	Clear polycarbonate reflector for HCY2437L
HCY3-WGSM	Wire guard for HCY0823L
HCY3-WGLG	Wire guard for HCY2437L
HCY3-LCSMLG	Clear polycarbonate lens cover for HCY3
HCY-SENSOR	Field installed microwave sensor
HCY-REMOTE	Remote hand-held programmer for HCY-SENSOR



Features

- Die cast frame and driver containment housing.
- Corrosion resistant black and white finish.
- Clear polycarbonate lens protects LEDs.
- Heavy duty hook provided for connection to customer-supplied suspension.
- Driver surge protection is 4kV L-N and 6kV LN-GND.
- Lumen maintenance up to 70% (L70) at 50,000 hrs.
- Default HCY-SENSOR settings are 1 minute timeout to 20% dim level, then 1 minute timeout to off. HCY-REMOTE must be used to change default sensor settings.
- HCY-SENSOR may be used up to 50ft mounting height.
- Note that using the sensor together with the reflector will affect sensor performance.
- Exposed leads for wiring connection with sleeving for environmental protection.
- 6' cord provided for power connection and dimming connection.
- Field CCT and Lumen selectable.
 - Default CCT setting is 4000K.
 - Default lumen setting for small is 23000lm.
 - Default lumen setting for large is 37000lm.
- cULus listed for use in wet locations for -30°C to 50°C ambient.
- IP65 and NEMA4X rated. IK08 impact rated.
- Components are RoHS compliant.
- DesignLights Consortium qualified. Please see the DLC QPL list for exact catalog numbers (www.designlights.org/QPL)
- Five year limited luminaire warranty. Visit www.signify.com/warranties for complete warranty information.

HCY Round High Bay

Dual Select (8,000 to 37,000lm)

Dimensions

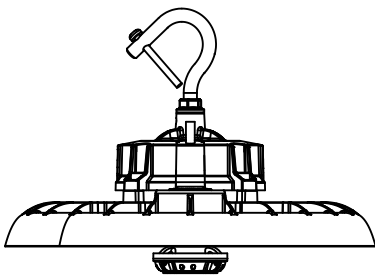

HCY0823

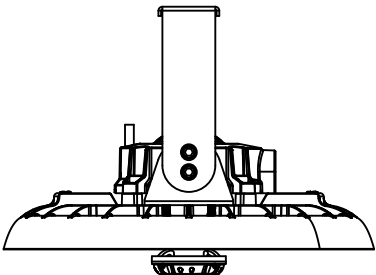

3/4"
(20mm)

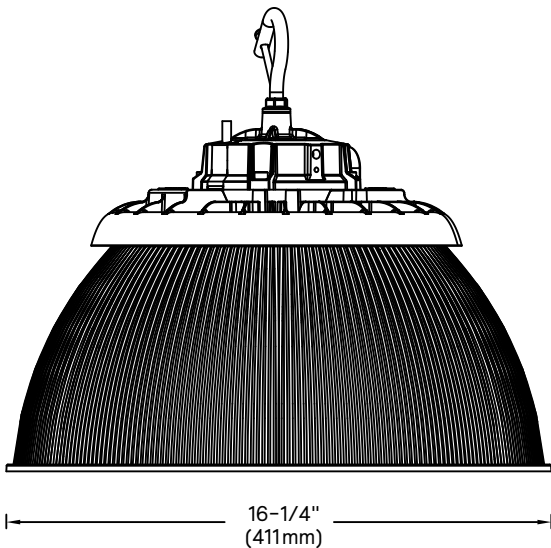

7-1/8"
(182mm)
4"
(104mm)
6-1/4"
(160mm)
13-3/8"
(342mm)

7-1/4"
(184mm)

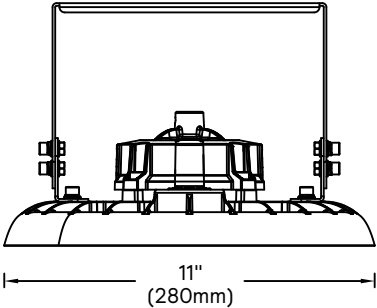

1-7/8"
(46mm)

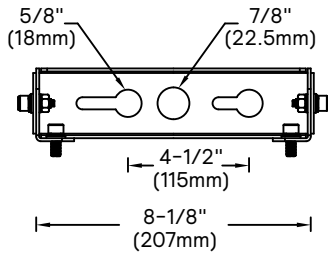

HCY Round High Bay

Dual Select (8,000 to 37,000lm)

Photometry

HCY21L8CST-UN3-DIM-4000K

Luminaire Lumens	23000
Luminaire Efficacy Rating (LER)	153
Total Luminaire Watts	150
Spacing Criterion (0-180)	1.24

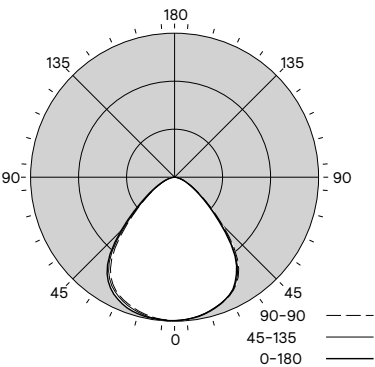

Candela Distribution						Flux
	0	45	90	135	180	Lumens
0	11255	11255	11255	11255	11255	
5	11202	11181	11202	11231	11249	1069
15	10868	10828	10873	10975	11102	3098
25	10196	10180	10239	10349	10559	4760
35	8488	8626	8769	9022	9233	5482
45	4989	5140	5355	5653	5935	4230
55	2378	2470	2581	2634	2832	2381
65	1126	1170	1206	1232	1316	1243
75	461	482	493	508	524	537
85	67	72	76	81	80	99
90	2	2	1	3	2	
95	3	3	1	3	2	2
105	6	6	1	1	2	4
115	12	12	2	2	3	7
125	19	20	7	6	6	12
135	29	28	15	15	15	17
145	41	40	28	27	27	21
155	49	49	34	33	33	19
165	57	57	47	46	46	14
175	59	59	57	55	56	5
180	54	54	54	54	54	

Zonal Lumen Summary			
Zone	Lumens	%Fixture	%Lamp
0-30	8927	38.8%	38.8%
0-40	14409	62.6%	62.6%
0-60	21019	91.4%	91.4%
0-90	22899	99.6%	99.6%
90-180	101	0.4%	0.4%
0-180	23000	100.0%	100.0%

Avg. Luminance (cd/m²)			
	0	45	90
45	152236	156825	163387
55	89456	92926	97087
65	57476	59719	61574
75	38422	40167	41106
85	16682	17821	18732

Coefficients of Utilization % (Based on a floor reflectance of 0.2)												
Pc---		80				70			50			0
Pw---		70	50	30	10	70	50	30	50	30	10	0
RCR	0	119	119	119	119	116	116	116	111	111	111	100
	1	111	107	104	101	108	105	102	101	98	96	88
	2	103	96	91	86	100	94	89	91	87	83	77
	3	95	87	80	74	93	85	79	82	77	72	68
	4	88	78	71	65	86	77	70	75	69	64	60
	5	82	71	63	58	80	70	63	68	62	57	54
	6	77	65	57	51	75	64	56	62	56	51	48
	7	71	59	52	46	70	59	51	57	50	46	43
	8	67	55	47	42	65	54	47	53	46	41	39
	9	63	50	43	38	61	50	43	49	42	38	36
10	59	47	40	35	58	46	39	45	39	34	33	

* Based on a floor reflectance of 0.2

Photometric Test List

Catalog No.	Delivered Lumens	Input Watts	Efficacy
HCY0823L8CST-UN3-DIM	8000	50	160
HCY0823L8CST-UN3-DIM	14000	90	156
HCY0823L8CST-UN3-DIM	23000	150	153
HCY2437L8CST-UN3-DIM	24000	150	160
HCY2437L8CST-UN3-DIM	33000	210	157
HCY2437L8CST-UN3-DIM	37000	240	154

LTD5140 : LINEAR LED WALL WASH

- TYPE T3
- High-Output LED Delivers 2,600+ Lumens
 - Produces Even, Scallop-free Wall Wash
 - For use with standard H-Style 1 circuit and 2 circuit track
 - Incandescent Dimming
 - Precision design ensures firm positioning
 - Highly adjustable, 355° Rotation/0°-90° Gimbal
 - Lockable tilt

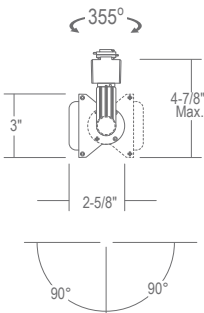
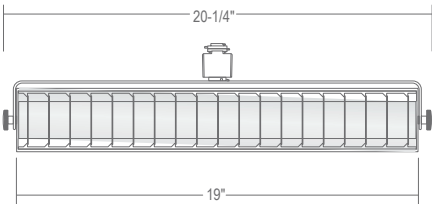

ORDERING : LTD5140B-T35

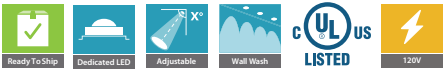

Fixture	Finish	Track Option	ColorTemperature	Accessories
2600lm (40W) LTD5140	Black B ¹ White W	1 & 2-Circuit/1-Neutral Blank 2-Circuit/2-Neutral -2C2N 3-Circuit/1-Neutral -3C1N	3500K (90CRI) -T35 4000K (90CRI) -T40 ColorSelect 3000K/3500K/4000K (90CRI) -TS354	No Louver Blank Louver -LVR

¹LTD5140B only available with -LVR
Note: Wattage limitations on compatible items must be met.

COMPATIBILITY

LP913F

Line voltage ground canopy

LP971

Line voltage square canopy

PT57

Plug-in clamp adapter

LP

1 CCT track channel

LP20

Recessed track

LPC

2 CCT Track channel

SPECIFICATION

Application

High-output EcoTrack LED trackhead features a sleek, rectangular, low-profile design that combines soft yet powerful illumination with maximum energy efficiency. Perfect for applications in retail stores, boutiques and other areas where adjustable illumination is required and ceilings may be high or distances may be long. Functions both as a flood and as an even, scallop-free wall wash to illuminate signage, displays and merchandise. Provides up to 5 times the lumen output of traditional halogen lamp sources.

Aiming

Precision machined aiming mechanism allows 90° vertical adjustment.

Connector

Comes standard with 3-Wire H-Type thermoplastic track connections. Optional 2-Circuit/2-Neutral (-2C2N), and 3-Circuit/1-Neutral (-3C1N) are also available.

Driver

Electronic Direct Current U.L. recognized driver mounted away from LED Array for cool operation and end-of-life modularity. Comes standard with 120VAC input.

Dimming

Works with standard electronic low voltage (ELV) dimmers. Factory qualified for use with Lutron brand dimmers: SELV300P, DVELV-300P, MAELV-600 and NELV-450.

Lumen Maintenance

Minimum 50,000 hours L70 life based on ANSI TM-21 calculations from LM80 standardized test results.

Thermal Management

Effective thermal dissipation facilitated by integral cast-aluminum, heat sink design for maximum heat rejection to provide long LED life.

Color Temperature:

Available in 3500K (90 CRI), 4000K (90 CRI), and TS354 ColorSelect 3000K/3500K/4000K (90 CRI)

Safety Labels

cETLus/UL listed. Suitable for dry locations only.

Warranty

Covered by a 3 Year Warranty to be free of defects in materials craftsmanship.

Finish

Available in Black and White.

Barrett Percent for Art
Lighting Plan
(supplemental info
provided by Building
Lighting Designer)
10/1/25

MURAL WALL
LOCATION

MURAL WALL
LOCATION

TRACK LIGHTS

LOCATION OF CEILING
HUNG SCULPTURE

