



July 29th, 2025

Robert Roesch, Chair
City of Philadelphia Art Commission
1515 Arch St., 13th Floor
Philadelphia, PA 19102

Re: Request for Art Commission Review

To the Philadelphia Art Commission,

We respectfully request to be included on the Art Commission agenda for August 13th to present the Conceptual Design for the Chinatown Stitch. A brief description of the project is included in this cover letter. The Project Team will submit photographs, plan and section views, renderings, and other required supporting materials by August 6th.

Currently, Chinatown is bisected by the Vine Street Expressway (I-676) and its frontage roads (local Vine Streets), which together encompass thirteen lanes of traffic. The Chinatown Stitch, led by the City of Philadelphia, aims to reconnect Chinatown and make it easier and safer for people to get to work, schools, doctors, stores, and parks. The project includes two main components:

- Construction of a 1.3 acre, 730-foot-long cap over the Vine Street Expressway between 10th and 12th Streets. The cap will host a park and community space.
- Implementation of a road diet, streetscaping, and pedestrian and bicycle improvements on the local Vine Street lanes.

Constructing the cap over the Vine Street Expressway will require the removal of the existing 10th Street Plaza, which includes public seating, trees and plantings, statues (two statues of foo dogs, one statue of General Lin Zexu), and a ground mural. The City is following relevant regulations and procedures to relocate the statues within the new park and decommission the ground mural.

The Chinatown Stitch Conceptual Design has been informed by extensive outreach. The City of Philadelphia, in partnership with the Philadelphia Chinatown Development Corporation, conducted three phases of engagement in 2023 as part of the *Chinatown Stitch Vision Report*. The Project Team then used the feedback received during the *Chinatown Stitch Vision Report* to develop three preliminary conceptual designs which were presented to the public and stakeholders during engagement conducted in spring 2025. The Project Team used the input received during this most recent round of engagement to develop a single Conceptual Design to present to the Art Commission.



Thank you for your consideration. Please contact Casey Ross (cc'd) and me if you have any questions about the application.

Sincerely,

Christopher Puchalsky

Christopher Puchalsky

Director of Policy and Strategic Initiatives

City of Philadelphia Office of Transportation and Infrastructure Systems

Christopher.Puchalsky@phila.gov | (215) 686-9001

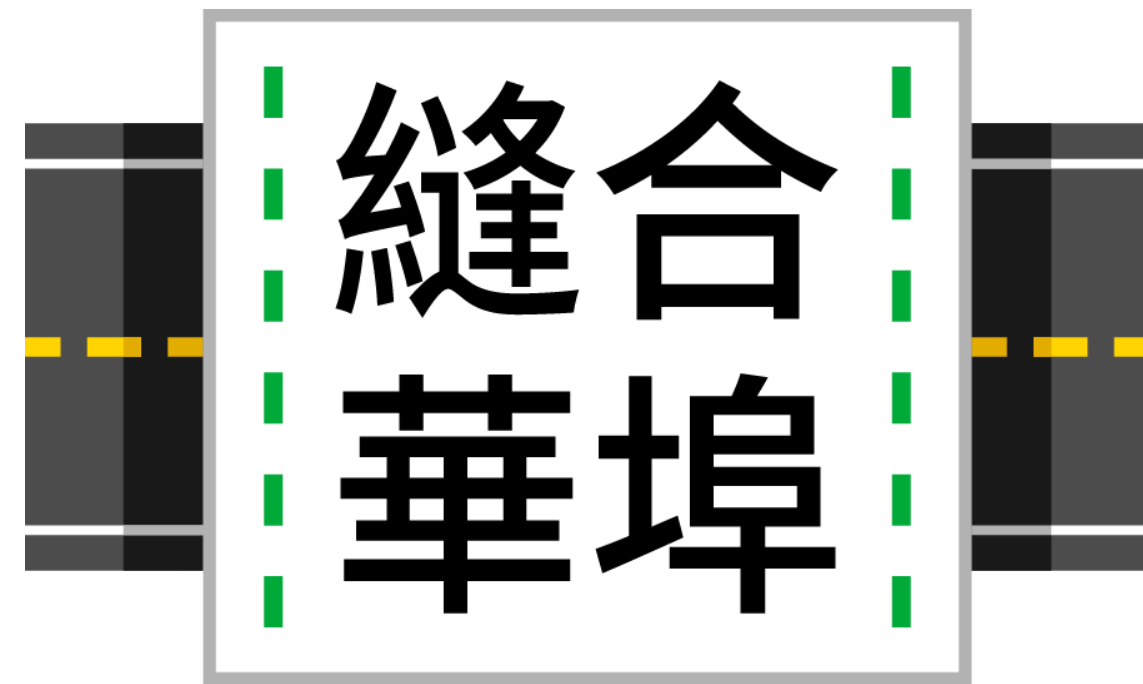

The Chinatown Stitch

Art Commission Review

August 13th, 2025



OJB

Ground Reconsidered

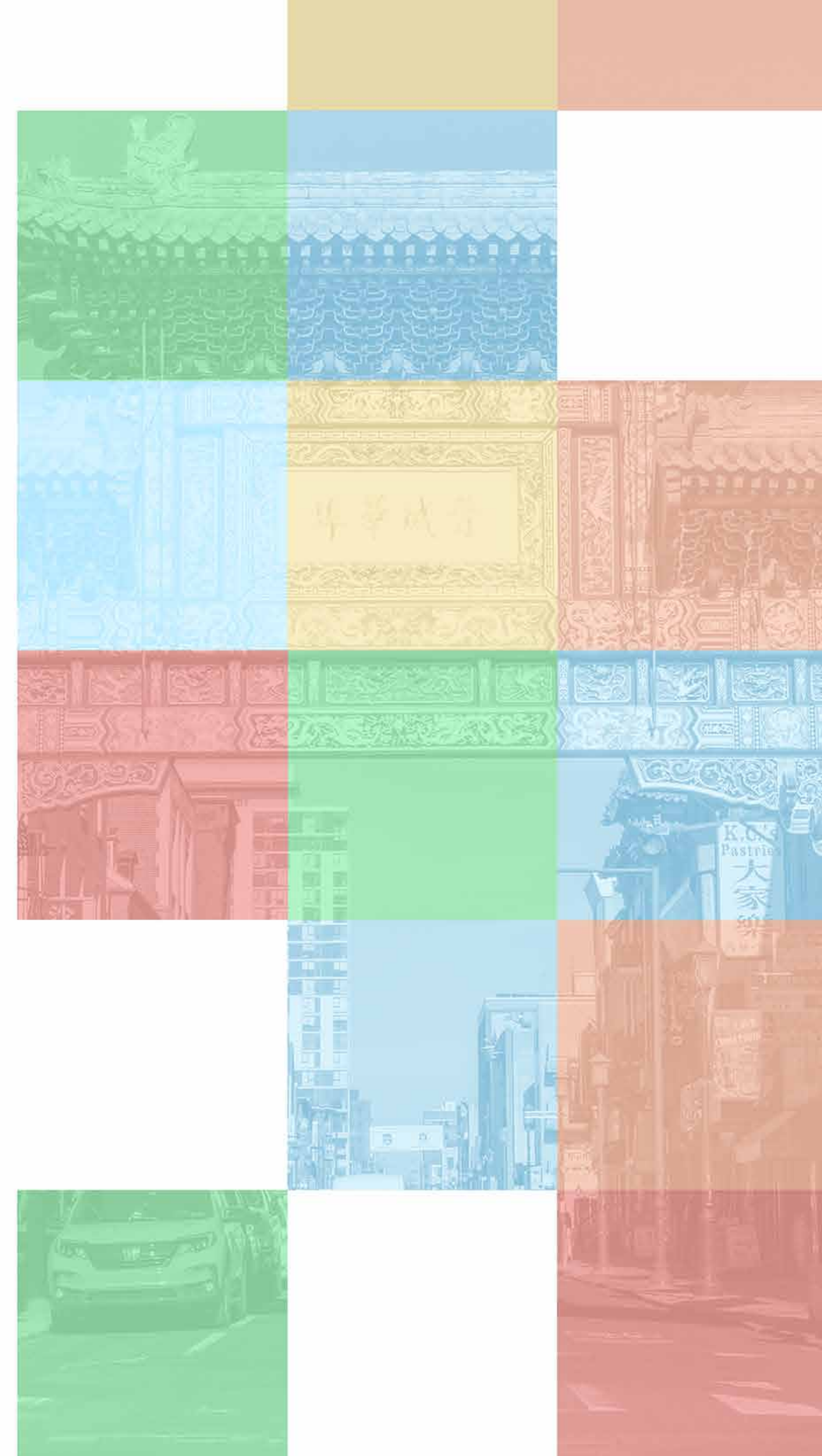

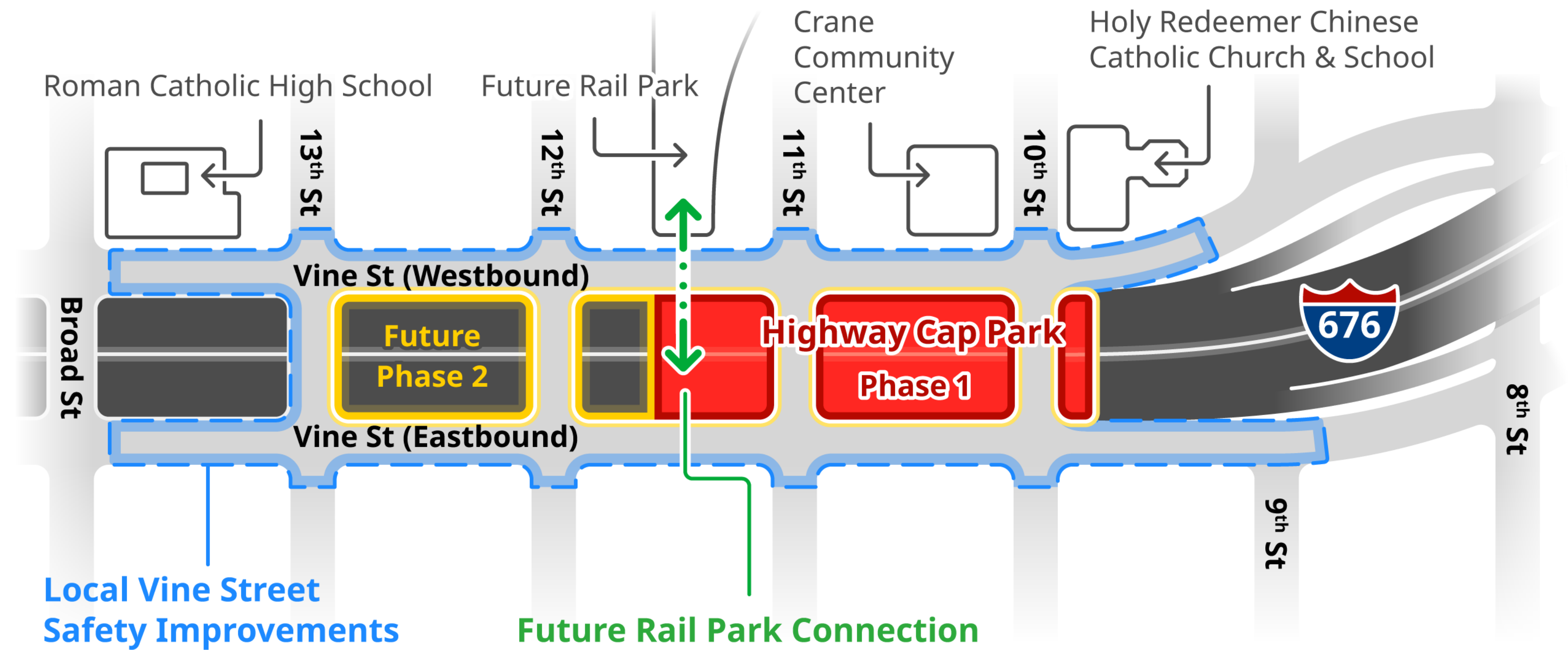

Project Area Overview

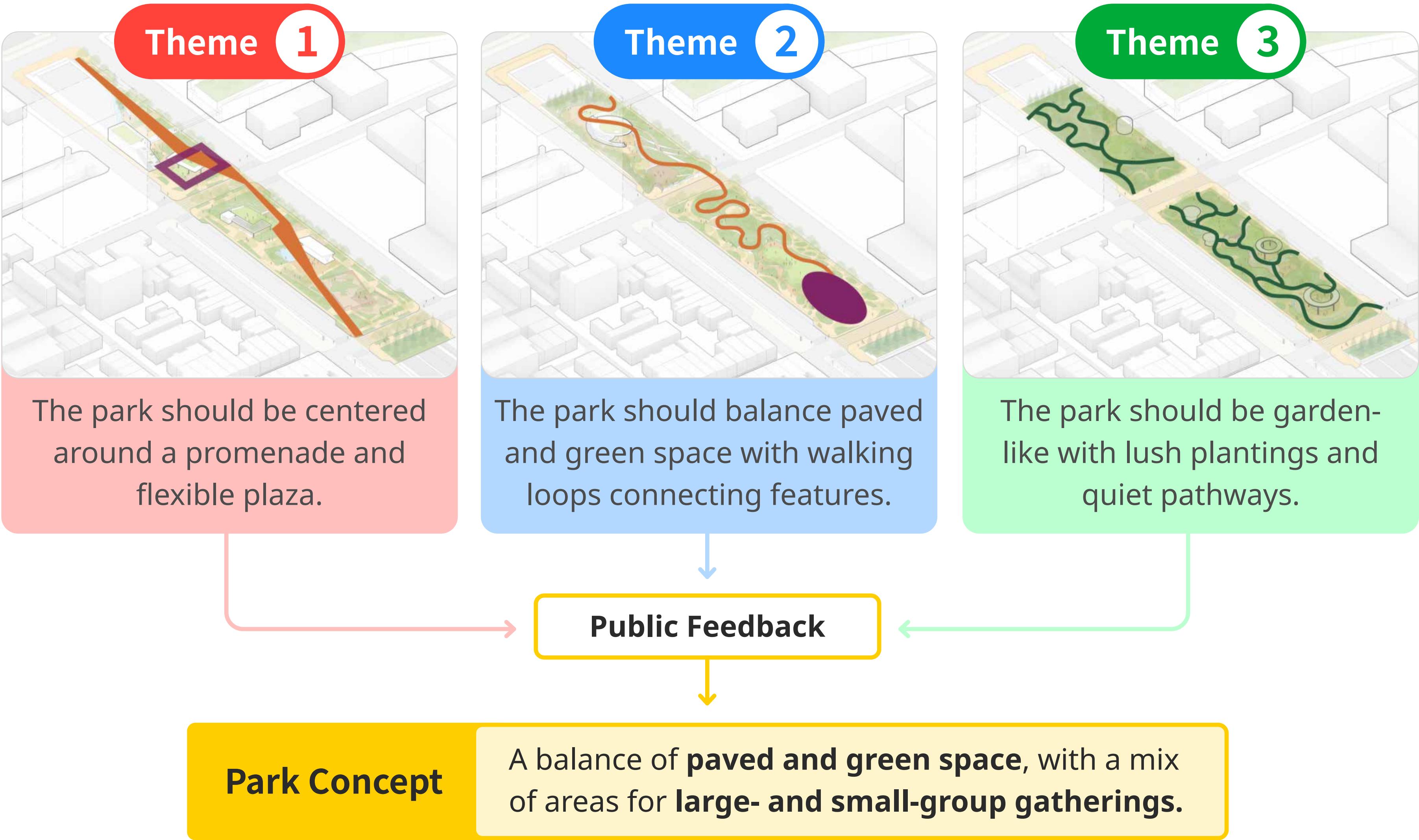

In Spring 2025, we engaged:

1,900 people

300 Chinatown residents

65 Chinatown businesses & organizations

Community Engagement





Locally Rooted

The character of the Chinatown Stitch draws from Chinatown’s position as a dynamic neighborhood firmly connected to its cultural traditions.

The park space will be diverse in design character, building on a traditional framework with a contemporary design that makes use of local materials.



Focus on Neighborhood

The park will be vibrant with amenities that welcome the everyday user—residents, students, and business commuters.

Seasonally, the space will be able to “flex-up” to host community events, including cultural events that celebrate the neighborhood’s heritage.



A Green Refuge

A contrast to the urban environment surrounding the park, the Chinatown Stitch will be an immersive green space balanced with shaded paving areas.

Rich in plantings, the space is inspired by a legacy of Chinese gardens and Philadelphia’s reputation as “the City of Gardens.” The planted environment will encourage visitors to enjoy a slower pace of life.



A Place of Resilience

The park will be flexible and serve as a community asset. It will strengthen Chinatown’s vitality and economy, with a primary focus being improving people’s health and wellness.

A self-sustaining operations and management approach will enable the park to thrive for generations to come.

Design Considerations



Project Area Existing Conditions

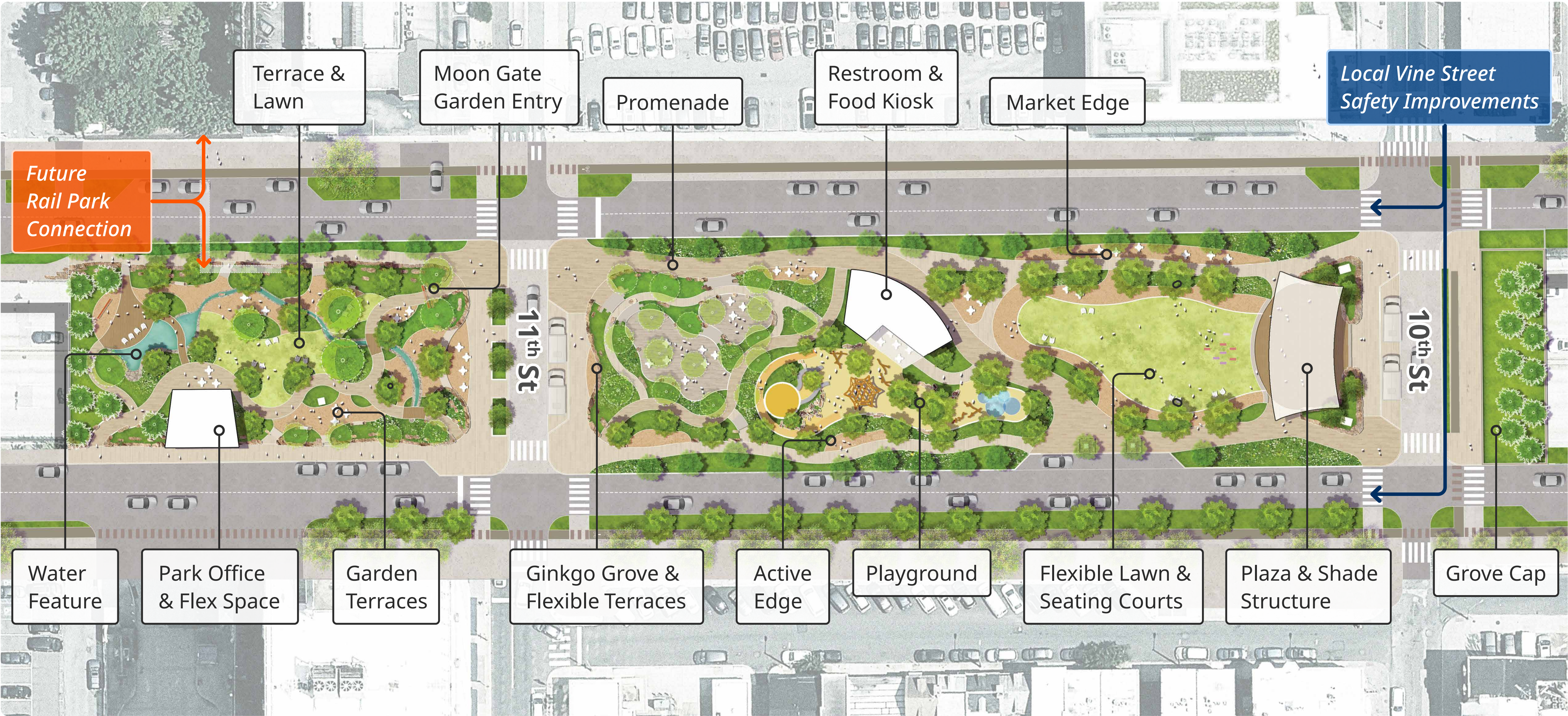

Proposed Site Plan: Park & Streetscape



DESIGN CONSIDERATIONS

Highlight Cultural Traditions

- Incorporate practices of traditional and modern Chinese gardens.
- Focus on seasonality.
- Pair and site plants based on traditional practices and community input.

Connect Philadelphia to East Asia

- Leverage best practices from a model eco-region.
- Utilize plants native to Philadelphia while considering culturally relevant adaptive analogs.
- Highlight successful adaptive species.
- Optimize plant performance and sustainability.

TECHNICAL CONSIDERATIONS

The Philadelphia City Planning Commission will be consulted for review and approvals.

Philadelphia Parks and Recreation will be consulted on street trees and plantings.

Future operations and maintenance entity will be consulted on the selection and maintenance of plantings.



DESIGN CONSIDERATIONS

Highlight Chinatown’s New Green Space

- Use non-distinctive lighting for features across the site.
- Accent trees and planting through lighting.
- Consider experiential accent lighting where appropriate.

Prioritize Safety and Usability

- Promote use of all park spaces through functional lighting.
- Utilize light poles to house security, data, and other operational devices.
- Consider dimmable LED fixtures that are adaptable for a variety of future uses.
- Consider dark skies compliance.

TECHNICAL CONSIDERATIONS

Future operations and maintenance entity will be coordinated with in regard to lighting and security.

The City of Philadelphia Department of Streets will be consulted on lighting within the local Vine Street right-of-way.



Grading Plan



Public Art Relocation



Renderings: Streetscape



Entrance at 10th St (Southwest Corner)



Central Lawn and Shade Structure



Entrance at 11th St (Northwest Corner)



11th St Garden

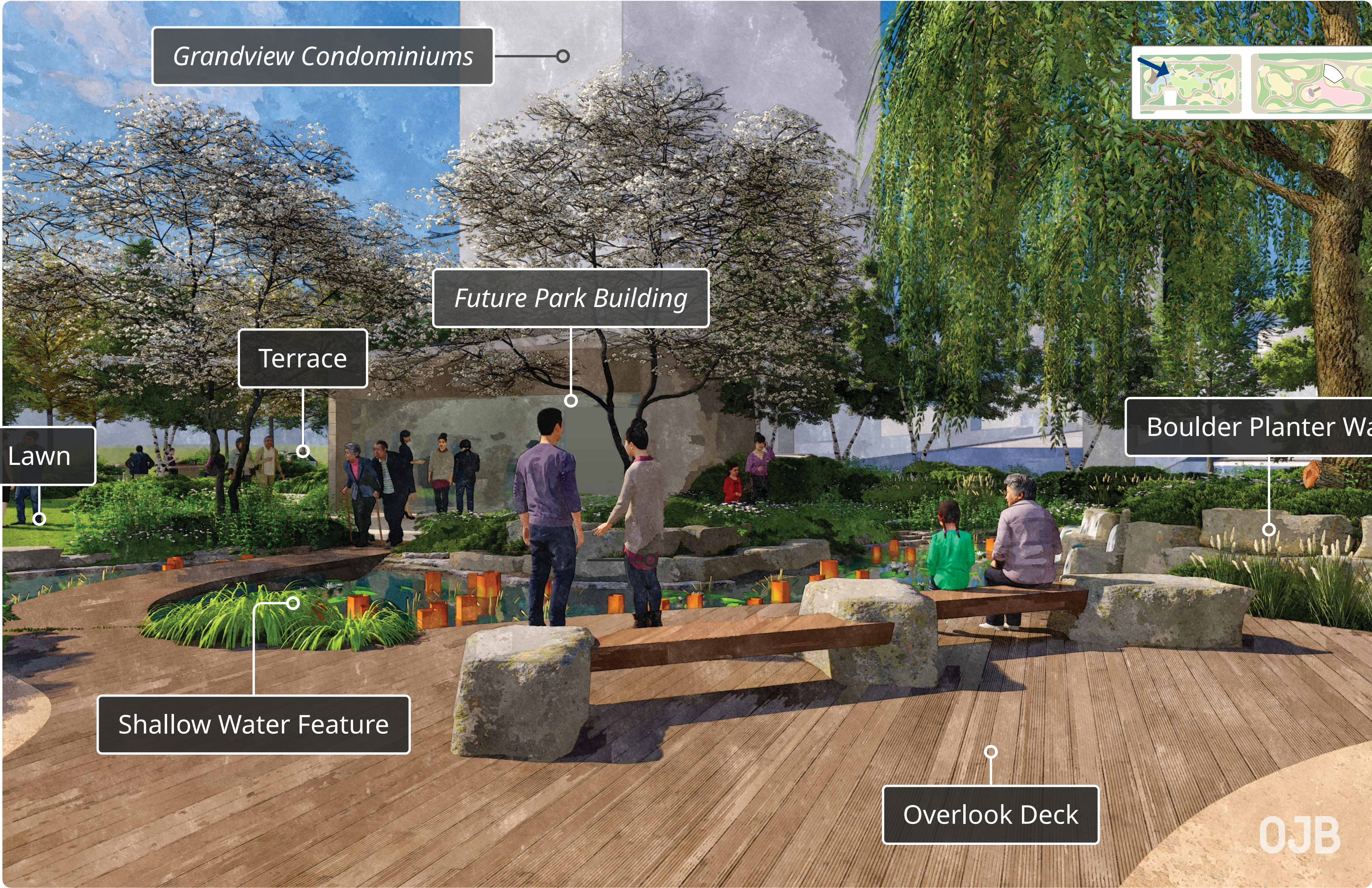

11th St Garden



11th St Garden

BUDGET

\$207 million

Total Project Construction, Design, and CM/CI Costs

SCHEDULE

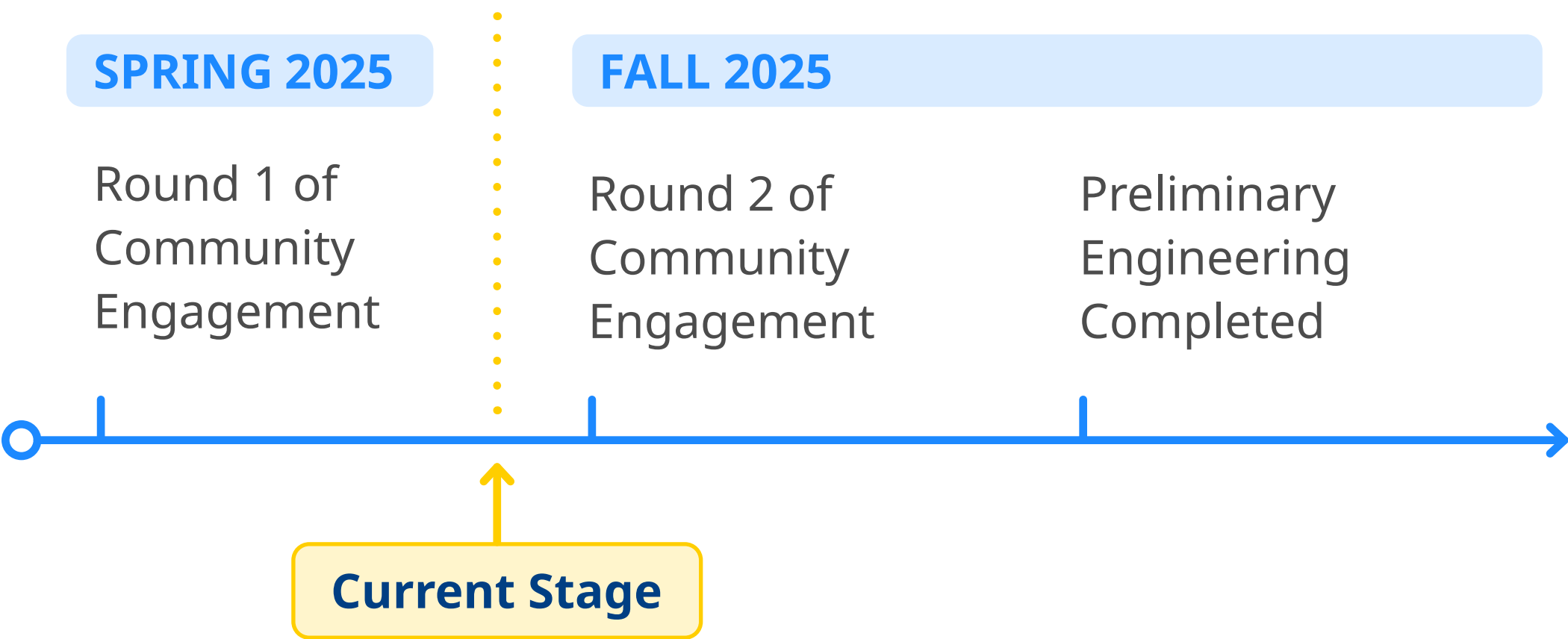

Budget & Schedule