

Memorandum



To: Alex Smith, Director, Art Commission
From: John Keiser, Project Coordinator, Capital Program Office
Date: April 29, 2025
Re: Request for Administrative Approval / Art Commission Review
James Allen Shuler Playground, 2901 N. 29th St., Philadelphia PA 19132

We respectfully request administrative approval for Playground improvements at James Allen Shuler Playground, 2901 N 29th St., Philadelphia, PA 19132.

The brief description of the project as stated below and the enclosed drawings show the intended extent of work.

This project includes the removal of hazardous and outdated existing playground equipment and, installation of new playground and safety surface. Through a community driven design process a selection was made that reflected the community's preference for a localized play area and bright colors designed by the playground manufacturer by BCI Burke. Project budget is \$350,000 which is funded by the Councilman Curtis Jones Jr.

Thank you for your attention. Please inform me directly if you need more information.

cc: Aparna Palantino, Deputy Commissioner, CPO
Francesco Cerrai, Project Director
John Keiser, Project Coordinator, John.Keiser@phila.gov or (215) 683-4473

SHULER PLAYGROUND | N. 27th ST

JUNE 2025



SITE CONTEXT

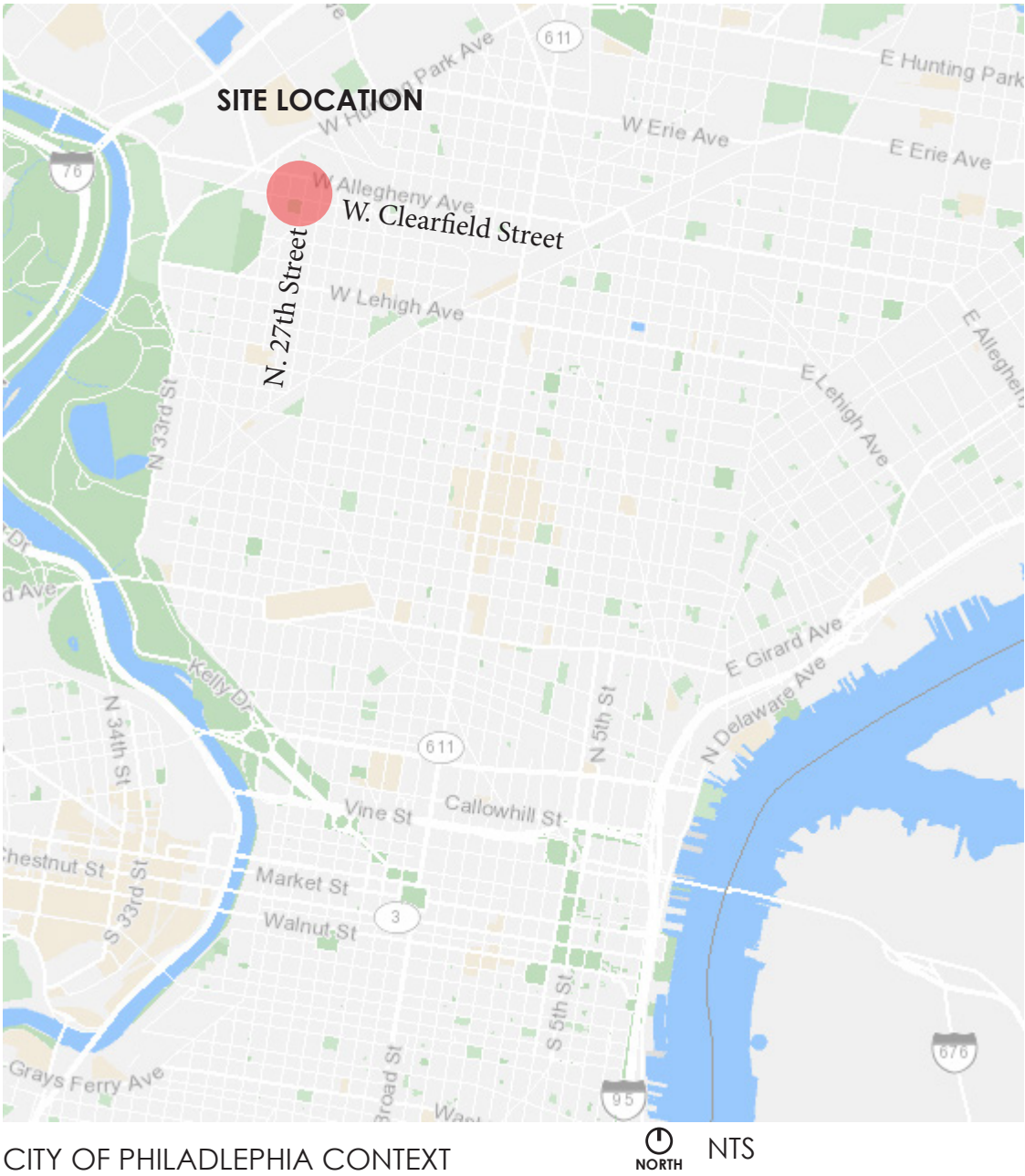

CITY OF PHILADELPHIA CONTEXT



SITE DIAGRAM

COMMUNITY INPUT

APRIL 2023

This community meeting was the first step in getting improvements at the Shuler Recreation Center. PPR listened to, and noted the community needs.

NOVEMBER 2024

Three different designs were presented to the community inside the Shuler Playground Recreation Center.

DESIGN INTENT

The final design was selected because of the consolidation of play areas to the rear of the recreation center.



SCOPE REFINEMENT

DECEMBER 2024

Playground scope has been funded by Councilman Curtis Jones Jr's office for playground improvements

FINAL DESIGN INTENT

- Removal of hazardous existing play equipment and safety surface
- Brand new 2-12 playground and safety surface with playground signage
- All existing site furnishings are to remain
- No vegetation to be removed
- Existing lighting to remain
- Utilize existing perimeter fencing for playground

FUTURE PHASING:

- Building improvements; restrooms, indoor lighting



EXISTING CONDITIONS

EXISTING 2-5 PLAY AREA

- Play structures are past their useful lifespan. Some hazardous conditions exist on deck platforms.
- Play surface does not meet ASTM standards for impact attenuation.
- Separate play areas are not conducive to observing play.

EXISTING 5-12 PLAY AREA

- Play structures are past their useful lifespan.
- Play surface does not meet ASTM standards for impact attenuation.
- Separate play areas are not conducive to watching children play.

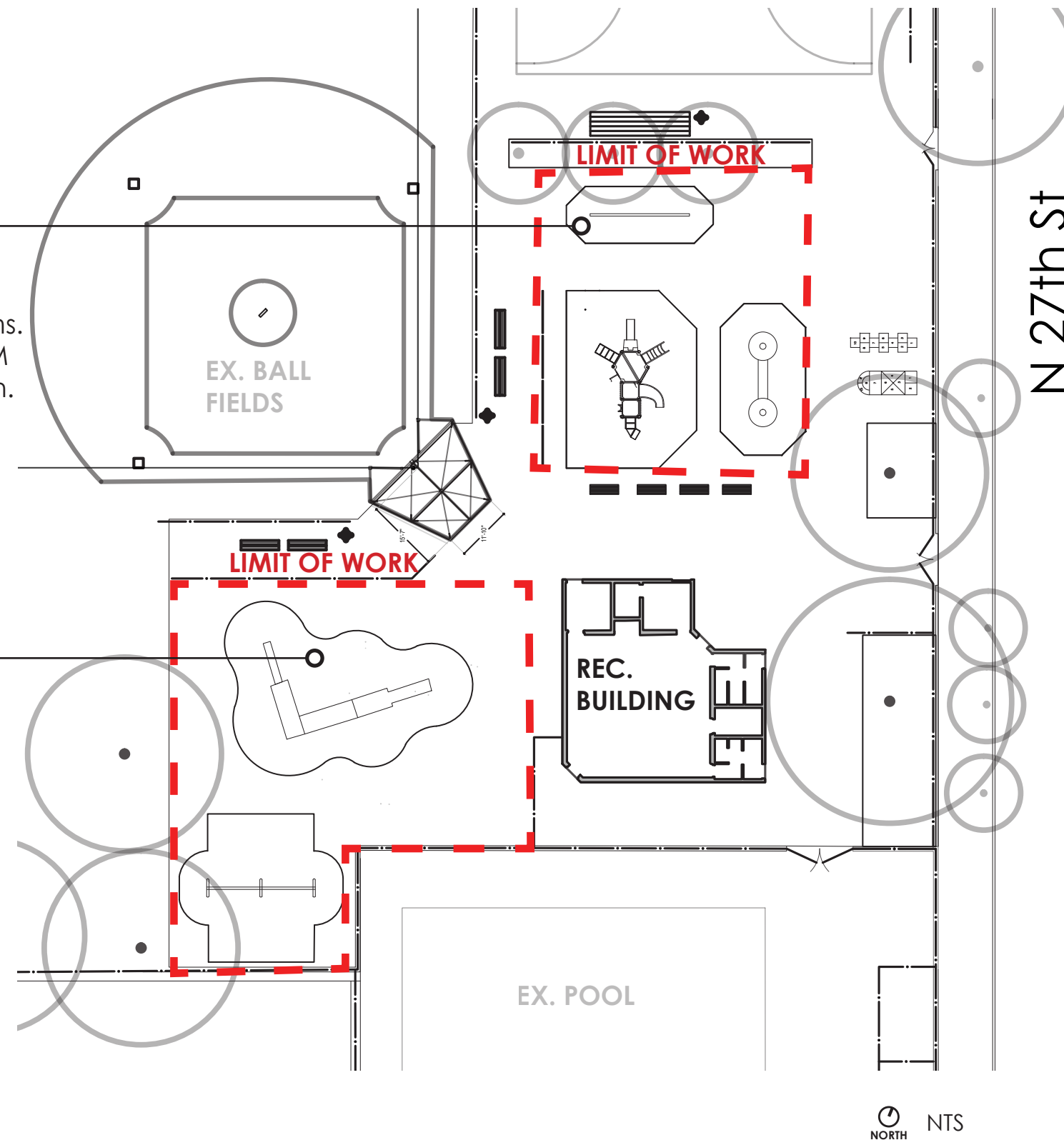

EXISTING CONDITIONS

5-12 PLAY AREA



2-5 PLAY AREA



DEMOLITION PLAN

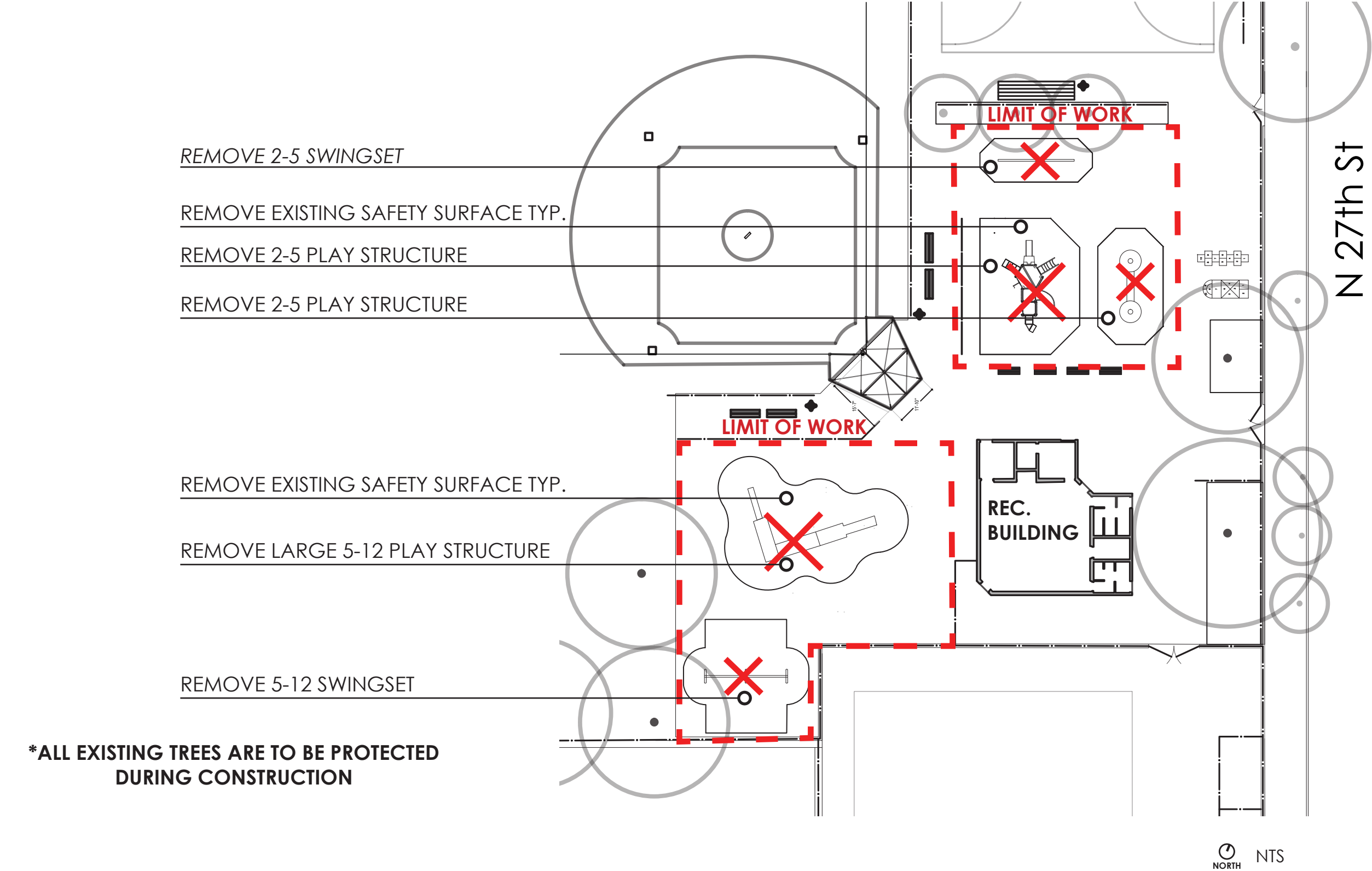

SITE PLAN

ASPHALT OPEN SPACE

Area to be repaved with asphalt until future phase.

PROPOSED 2-12 PLAY STRUCTURES

All new poured in place safety surface and play equipment to be installed to meet current ASTM standards for inclusive PG design.

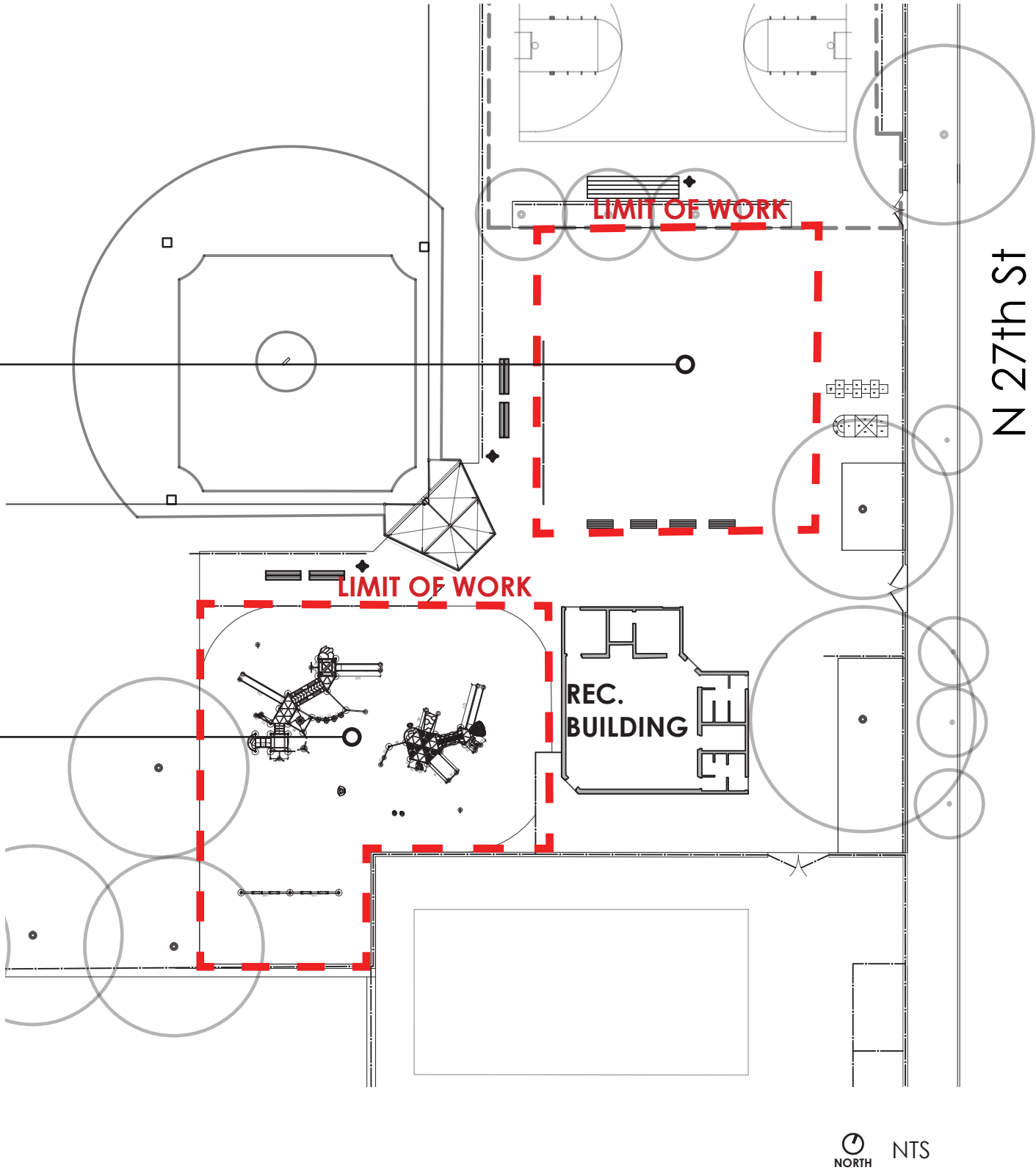

EQUIPMENT SELECTED



SHULER PLAYGROUND | N. 27th ST

JUNE 2025



EQUIPMENT SELECTED



SHULER PLAYGROUND | N. 27th ST

JUNE 2025



EQUIPMENT SELECTED





THANK YOU