

DESIGNS PREPARED FOR:

*Wonder*

PHILADELPHIA, PA

**SITE ADDRESS:**

1600 Chestnut St  
Philadelphia, PA 19103

**JOB NUMBER:**

000000

**SALES REPRESENTATIVE:**

R. Walker

**PROJECT MANAGER:**

X. XXXXXXXX

# JONES SIGN

SITEPLAN

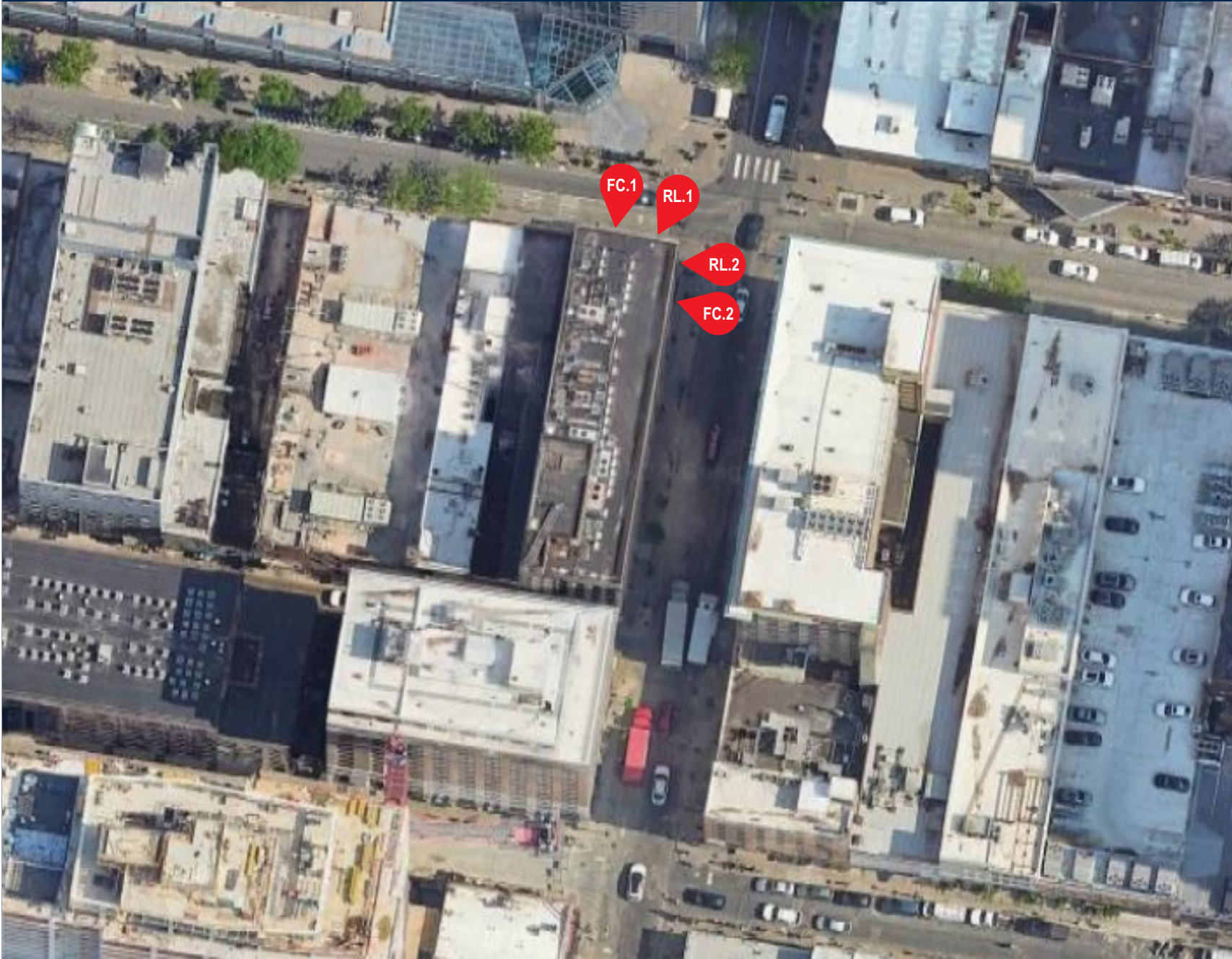

N

SCOPE OF WORK		
SIGNS		QTY
RL.1	FACE LIT CHANNEL LETTERS ON A BACKER PAN	1
RL.2	FACE LIT CHANNEL LETTERS ON A BACKER PAN	1
FC.1	FACADE COVER	1
FC.2	FACADE COVER	1

SCALE: X = 1'-0"

<div><div>JONES SIGN</div><div>Your Vision. Accomplished.</div><div>A MORTENSEN COMPANY</div></div>	<div>JOB #:</div> <div>DATE: 03.27.25</div> <div>DESIGNER:</div> <div>SALES REP: R. Walker</div> <div>PROJ MGR:</div>	REQUIRED:	LANDLORD APPROVAL	DATE	<div>Wonder</div>	<div>Wonder</div> <div>1600 Chestnut St</div> <div>Philadelphia, PA 19103</div>	<div>SHEET NUMBER</div> <div>1.0</div>
		<div><div><div><input type="checkbox"/> FIELD SURVEY</div><div><input type="checkbox"/> VECTOR ARTWORK</div></div><div><div><input type="checkbox"/> PAINT COLOR</div><div><input type="checkbox"/> CLIENT PMS COLOR</div></div><div><div><input type="checkbox"/> FONTS</div><div><input type="checkbox"/> ENGINEERING</div></div></div> <div>OTHER:</div>	CLIENT APPROVAL	DATE			

This is an original, unpublished drawing by Jones Sign Co., Inc. It is for your personal use in conjunction with a project being planned for you by JONES SIGN. It is not to be shown to anyone outside of your organization, nor is it to be used, reproduced, copied or exhibited in any fashion. Use of this design or the salient elements of this design in any sign done by any other company, without the express written permission of JONES SIGN, is forbidden by law and carries a civil forfeiture of up to 25% of the purchase price of the sign. JONES SIGN will endeavor to closely match colors, including PMS, where specified. We cannot guarantee exact matches due to varying compatibility of surface materials and paints used. All sizes and dimensions are illustrated for client's conception of project and are not to be understood as being exact size or exact scale.



RL.1 OPTION B - ILLUMINATED CHANNEL LETTERS ON BACKER PAN (Qty 1)

SQUARE FOOTAGE: 98.83 SQ FT



NIGHT VIEW



SPECIFICATIONS:

- 1. .040" X 3" PRE-FINISHED ALUMINUM COIL (WHITE INSIDE) (SEAMS IN CORNERS OR TOP) PAINTED TO MATCH TRIMCAP COLOR **P-1**
- 2. 040 ALUMINUM BACKS
- 3. PRINCIPAL LED QUICK MOD 2 LEDs
- 4. 0.150" WHITE POLYCARBONATE FACES
- 5. 1" PRE-FINISHED JEWELITE CHEMICALLY BONDED TO FACES (SEAMS AT THE TOP) **HUNTER GREEN**
- 6. 1/4 - 20 THREADED STUDS, MINIMUM 5 PER LETTER
- 7. #8 - 1/2" PAN HEAD SCREWS (NO MORE THAN 24" APART)
- 8. 1/4" DIA. WEEP HOLES W/ .063" DRAIN HOLE COVER (EXTERIOR APPLICATIONS ONLY)
- 9. 7/8" ELECTRICAL HOLE / 3/4" COUPLER WITH FLEXIBLE CONDUIT TO POWER SUPPLY BOX (IN MIDDLE OF LETTER UNLESS NOTED OTHERWISE)
- 10. PRINCIPAL LED QUICK MOD 2 LEDs, 60 W 120V/12V PRINCIPAL LED POWER SUPPLY - REMOTE IN UL APPROVED BOX
- 11. TOGGLE SWITCH MOUNTED TO POWER SUPPLY BOX
- 12. 15 FT. MIN. WHIP LENGTH
- 13. RIGID CONDUIT THROUGH WALL WITH 1/2" - 1" STUB BEYOND INSIDE WALL. INSTALLER TO FOLLOW LOCAL CODE
- 14. .080 ALUMINUM FACED BACKER PAN WITH 2" ALUMINUM ANGLE FRAME - PAINTED **P-1**
- 15. 1 1/2" ALUMINUM ANGLE H FRAME - MOUNTED TO FACADE MOUNTING HARDWARE TO SUIT LOCATION

NOTES:

- 1. **PHOTO CELL**
- 2. **UL STICKER VISABLE TO GROUN & JONES STICKER**
- 3.
- 4.

COLORS / FINISHES:

**P-1** MP TO MATCH PMS 3537C - SATIN FINISH

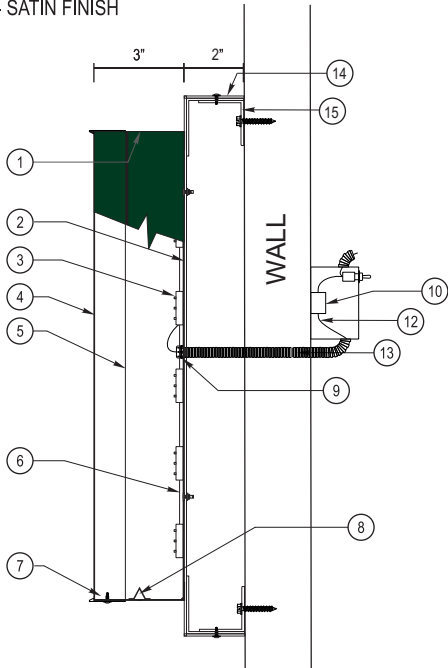

CROSS SECTION VIEW  
SCALE: N.T.S

EXTERIOR VIEW



<div>JONES SIGN</div> <div>Your Vision. Accomplished.</div> <div>A MORTENSEN COMPANY</div>	<div>JOB #:</div> <div>DATE: 03.27.25</div> <div>DESIGNER:</div> <div>SALES REP: R. Walker</div> <div>PROJ MGR:</div>	<div>REQUIRED:</div> <div><div><input type="checkbox"/> FIELD SURVEY</div><div><input type="checkbox"/> VECTOR ARTWORK</div></div> <div><div><input type="checkbox"/> PAINT COLOR</div><div><input type="checkbox"/> CLIENT PMS COLOR</div></div> <div><div><input type="checkbox"/> FONTS</div><div><input type="checkbox"/> ENGINEERING</div></div>
--	---	---

OTHER:



RL.2 OPTION B - ILLUMINATED CHANNEL LETTERS ON BACKER PAN (Qty 1)

SQUARE FOOTAGE: 98.83 SQ FT

ALL MEASUREMENTS ARE APPROXIMATE, SURVEY REQUIRED BEFORE PRODUCTION

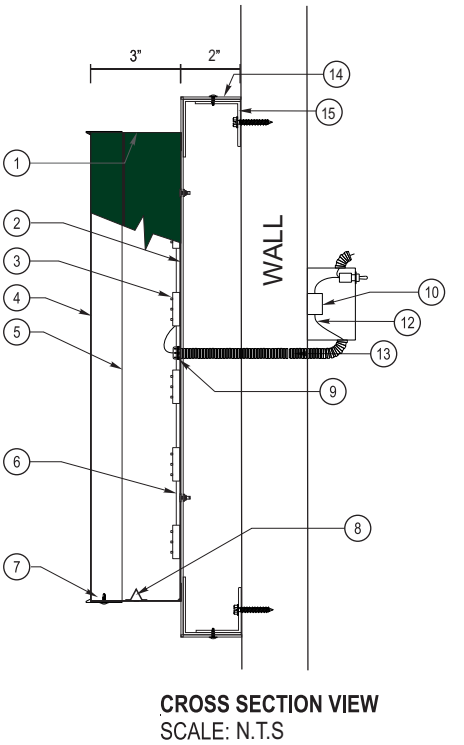

SPECIFICATIONS:

- .040" X 3" PRE-FINISHED ALUMINUM COIL (WHITE INSIDE) (SEAMS IN CORNERS OR TOP) PAINTED TO MATCH TRIMCAP COLOR **P-1**
- 040 ALUMINUM BACKS
- PRINCIPAL LED QUICK MOD 2 LEDs
- 0.150" WHITE POLYCARBONATE FACES
- 1" PRE-FINISHED JEWELITE CHEMICALLY BONDED TO FACES (SEAMS AT THE TOP) **HUNTER GREEN**
- 1/4 - 20 THREADED STUDS, MINIMUM 5 PER LETTER
- #8 - 1/2" PAN HEAD SCREWS (NO MORE THAN 24" APART)
- 1/4" DIA. WEEP HOLES W/ .063" DRAIN HOLE COVER (EXTERIOR APPLICATIONS ONLY)
- 7/8" ELECTRICAL HOLE / 3/4" COUPLER WITH FLEXIBLE CONDUIT TO POWER SUPPLY BOX (IN MIDDLE OF LETTER UNLESS NOTED OTHERWISE)
- PRINCIPAL LED QUICK MOD 2 LEDs, 60 W 120V/12V PRINCIPAL LED POWER SUPPLY - REMOTE IN UL APPROVED BOX
- TOGGLE SWITCH MOUNTED TO POWER SUPPLY BOX
- 15 FT. MIN. WHIP LENGTH
- RIGID CONDUIT THROUGH WALL WITH 1/2" - 1" STUB BEYOND INSIDE WALL. INSTALLER TO FOLLOW LOCAL CODE
- .080 ALUMINUM FACED BACKER PAN WITH 2" ALUMINUM ANGLE FRAME - PAINTED **P-1**
- 1 1/2" ALUMINUM ANGLE H FRAME - MOUNTED TO FACADE MOUNTING HARDWARE TO SUIT LOCATION

NOTES:

- PHOTO CELL**
- UL STICKER VISABLE TO GROUN & JONES STICKER**
- 
- 

COLORS / FINISHES:

**P-1** MP TO MATCH PMS 3537C - SATIN FINISH

EXTERIOR VIEW



<div>JONES SIGN</div> <div>Your Vision. Accomplished.</div> <div>A MORTENSEN COMPANY</div>	<div>JOB #:</div> <div>DATE: 03.27.25</div> <div>DESIGNER:</div> <div>SALES REP: R. Walker</div> <div>PROJ MGR:</div>	<div>REQUIRED:</div> <div><div><input type="checkbox"/> FIELD SURVEY</div><div><input type="checkbox"/> VECTOR ARTWORK</div></div> <div><div><input type="checkbox"/> PAINT COLOR</div><div><input type="checkbox"/> CLIENT PMS COLOR</div></div> <div><div><input type="checkbox"/> FONTS</div><div><input type="checkbox"/> ENGINEERING</div></div>
--	---	---

OTHER:



FC.1 FRONT / FC.2 SIDE

FACADE COVERS (Qty 2)

ALL MEASUREMENTS ARE APPROXIMATE, SURVEY REQUIRED BEFORE PRODUCTION

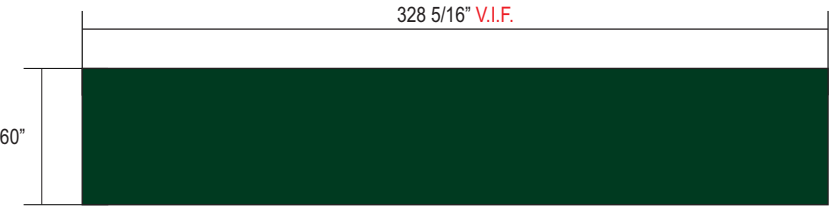

FC.1 FRONT  
SCALE: N.T.S



FC.2 SIDE  
SCALE: N.T.S

SPECIFICATIONS:	COLORS / FINISHES:
1. 60" H x 2" D ANGLE FRAME ALUMINUM PAN PAINTED P-1	<div></div> P-1 MP TO MATCH PMS 3537C - SATIN FINISH



<div><div>JONES SIGN</div><div>Your Vision. Accomplished.</div><div>A MORTENSEN COMPANY</div></div>	JOB #:  DATE: 03.27.25  DESIGNER:  SALES REP: R. Walker  PROJ MGR:	REQUIRED: <div><div><input type="checkbox"/> FIELD SURVEY<input type="checkbox"/> PAINT COLOR<input type="checkbox"/> FONTS</div><div><input type="checkbox"/> VECTOR ARTWORK<input type="checkbox"/> CLIENT PMS COLOR<input type="checkbox"/> ENGINEERING</div></div> OTHER: <div></div>	LANDLORD APPROVAL  <div>DATE</div>	<div>Wonder</div>	Wonder 1600 Chestnut St Philadelphia, PA 19103	SHEET NUMBER  4.0
			CLIENT APPROVAL  <div>DATE</div>			

This is an original, unpublished drawing by Jones Sign Co., Inc. It is for your personal use in conjunction with a project being planned for you by JONES SIGN. It is not to be shown to anyone outside of your organization, nor is it to be used, reproduced, copied or exhibited in any fashion. Use of this design or the salient elements of this design in any sign done by any other company, without the express written permission of JONES SIGN, is forbidden by law and carries a civil forfeiture of up to 25% of the purchase price of the sign. JONES SIGN will endeavor to closely match colors, including PMS, where specified. We cannot guarantee exact matches due to varying compatibility of surface materials and paints used. All sizes and dimensions are illustrated for client's conception of project and are not to be understood as being exact size or exact scale.