

William H. Gray 30th Street Station Redevelopment Project

April 24, 2024

Members of the Philadelphia Art Commission:

On behalf of Amtrak and PIP, we are pleased to present The Market Street Plaza at William H. Gray III 30th Street Station to the Art Commission.

Amtrak has partnered with the Plenary Infrastructure Philadelphia (PIP) as the master developer whose responsibility it is to design, build, finance, operate and maintain the station improvements for 50 years as part of a public-private partnership (P3) agreement. Key contractors currently performing various portions of its work include Gilbane Building Company as design-build lead, Johnson Controls Inc. for facility operations and maintenance, and Vantage Airport Group for concessions development and management. The project has an estimated capital construction value of \$550 million with major elements of the station restoration and renovation to include:

- Modernizing and expanding station food & beverage and retail offerings
- Improving station operations and enhancing the customer experience
- Upgrading The Porch landscaping and community amenities
- Modernizing Amtrak corporate offices
- Enhancing building infrastructure to achieve and maintain a state of good repair'

Amtrak and PIP share a vision to transform the southern face of the William H. Gray III 30th Street Station long Market Street into a compelling and vital urban plaza, henceforth “the Plaza”. This investment will create a lasting impression of the multimodal hub, expand West Philadelphia’s open space network, and serve as an anchor and gateway in University City. Beyond functioning as a welcoming front door to the Station, the transformed plaza will seamlessly integrate everyday passenger access, convenience and comfort with a variety of new opportunities for social interaction and recreation. Our design for the plaza builds on the “pop-up” success of The Porch and grows from the conceptual design developed last year under Amtrak’s leadership. We envision the look and feel of the new the Plaza to redefine comfort and activation through balancing the need for a design that complements the dignity of the historic facility while exuding a new freshness and energy that is compatible with the transformative Station revitalization.

The Plaza is designed with the purpose of creating a real sense of place – a distinctive quality to entice people to pass time and enjoy activities and amenities. As an anchoring historic landmark in Philadelphia, the plaza at 30th Street Station will act as a gateway into West Philadelphia and will stand on its own as a world class public amenity for local, regional and international users. The plaza design will serve as a destination supporting the flow of people through an expansive range of programming options that encourage activation. From quiet, intimate spaces in which we can honor Philadelphia’s great leaders like William H Gray II, to vibrant social spaces with outdoor markets and small community events, the plaza will support both passive and active programs from civic scale to personal interests.

The elimination of Little Market Street as a vehicular thoroughfare across the site allows for the plaza design to reclaim the open space frontage along Market Street. Utilizing the full breadth of area adjacent to 30th St Station, our team proposes an intimate network of

social pockets that support an intensive planting strategy, stormwater management, and retail activation while maintaining flexibility for a range of uses. Planter walls will bound the plaza on the southern edge to provide protection to pedestrians from the high traffic along Market Street, and vehicle pick-up and drop-off will be limited to the east, west building entrances.

Building on the design principles from the original concept design, we prioritize and further enhance the pedestrian circulation and amenities, evolving the plaza space into more flexible and diverse scale to support the programmatic goals of this world class transit plaza. The plaza is organized into four distinct typologies of spaces: the Central Plaza, East and West Gateway Groves, Garden Passage and the Promenade. Each space offers a unique experience and programmatic contribution for both Civic and intimate scales.

On behalf of Amtrak and PIP, we look to reviewing the design intent of The Market Street Plaza at William H. Gray III 30th Street Station at the presentation on May 8th, 2024

Sincerely,

Ryan Johnson



Senior Project Manager & Developer Representative
Plenary Infrastructure Philadelphia



AMTRAK 30TH STREET STATION MARKET STREET PLAZA
Art Commission Presentation | May 9, 2024

PROJECT INTRODUCTION



William H. Gray III 30th Street Station is strategically located on the Northeast Corridor, a gateway to the Philadelphia region and a landmark in the neighborhood.

The Station is the region's most important intermodal hub with approximately 4 million Amtrak riders and 12 million SEPTA and NJ Transit riders annually.

The current renovation will align with the new age of rail and readies the station for Amtrak ridership to double by 2040 nationwide.

Recognizing that the involvement from neighborhood stakeholders would lead to the production of a master plan capable of being implemented; Amtrak, Brandywine Realty Trust, Drexel, Pennsylvania Department of Transportation, and SEPTA joined forces to develop a joint commercial and residential plan for the area, known as the Philadelphia 30th Street Station District Plan.

- This project is part of that implementation. Amtrak is renovating the Philadelphia - William H. Gray III 30th Street Station to:
- Enhance customer experience for current customers and anticipated future growth in ridership.
 - Revive historic station as a customer-oriented gateway and civic destination.
 - Improve operations and retail opportunities.
 - Modernize the corporate office space.
 - Restore historic fabric of Station.
 - Address the backlog of deferred maintenance.

EXISTING CONDITIONS



Amtrak owns a portion the New proposed Market Street Plaza
The Property Line delineates that Amtrak's ownership is the building and a portion of the exterior space beyond
The remaining portion is owned jointly by the City (surface and road improvements) and PennDOT (underlying structure)
The New Market Street Plaza is planned to be operated and maintained by Amtrak and Plenary Infrastructure Philadelphia

PROJECT PUBLIC OUTREACH

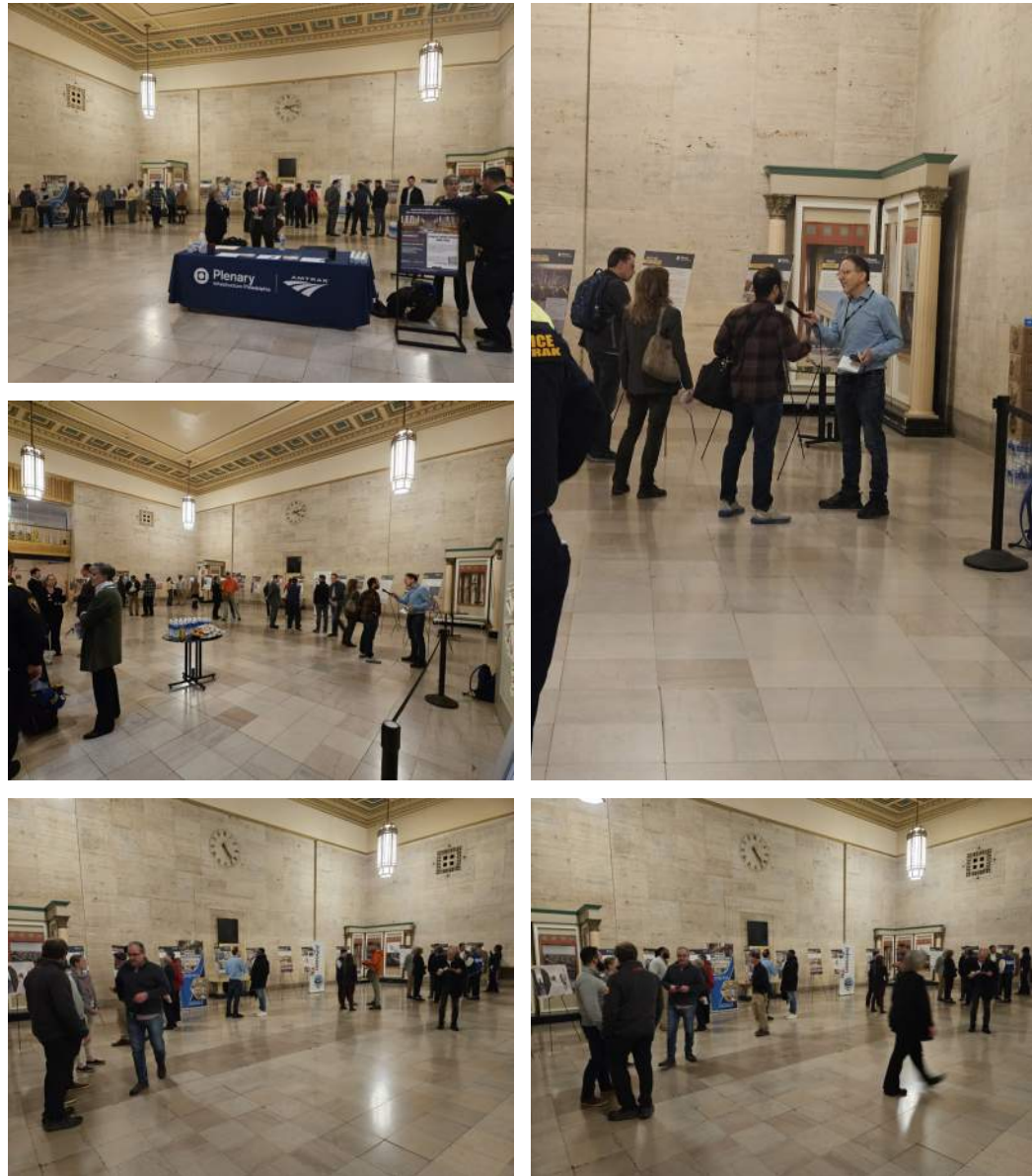

2016-2018
30th Street District Plan with

2018-2021
RFQ / RFP process to solicit master Developer for Amtrak's Phase 1 of the 30th Street District Plan

2021
Plenary Infrastructure Philadelphia selected as Master Developer

2021
PIP / Amtrak led Public Meeting to gather design input public feedback
(held virtually due to Pandemic)

2021
S106 Process - 1st Consulting parties meeting

2022
Street's Department Developer Services Meeting

2022
S106 Process 2nd Consulting parties meeting

2023 - PIP / Amtrak led Public Meetings to preview upcoming construction impacts and imagery of the project designs

2024 Art Commission Review

EXISTING CONDITIONS



EXISTING CONDITIONS | LITTLE MARKET STREET

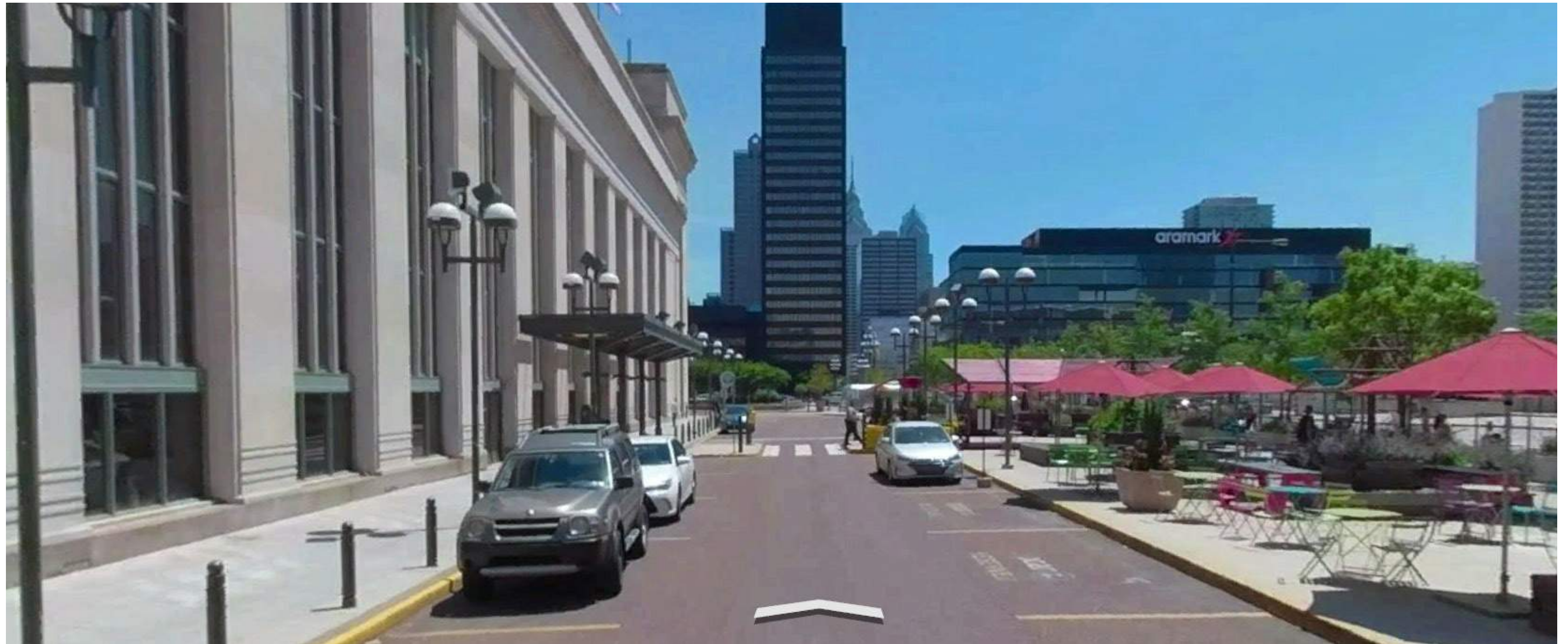

EXISTING CONDITIONS | MARKET STREET



CONCEPTUAL DESIGN SITE PLAN

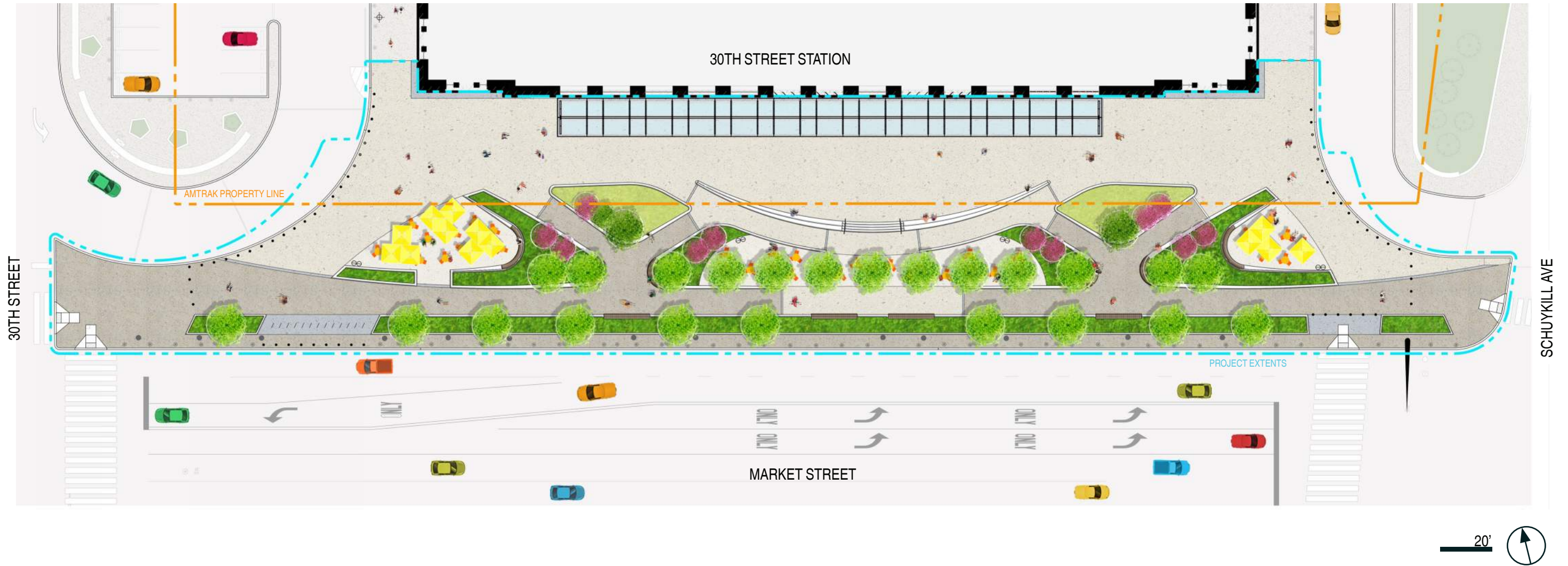

OPEN SPACE CHARACTER

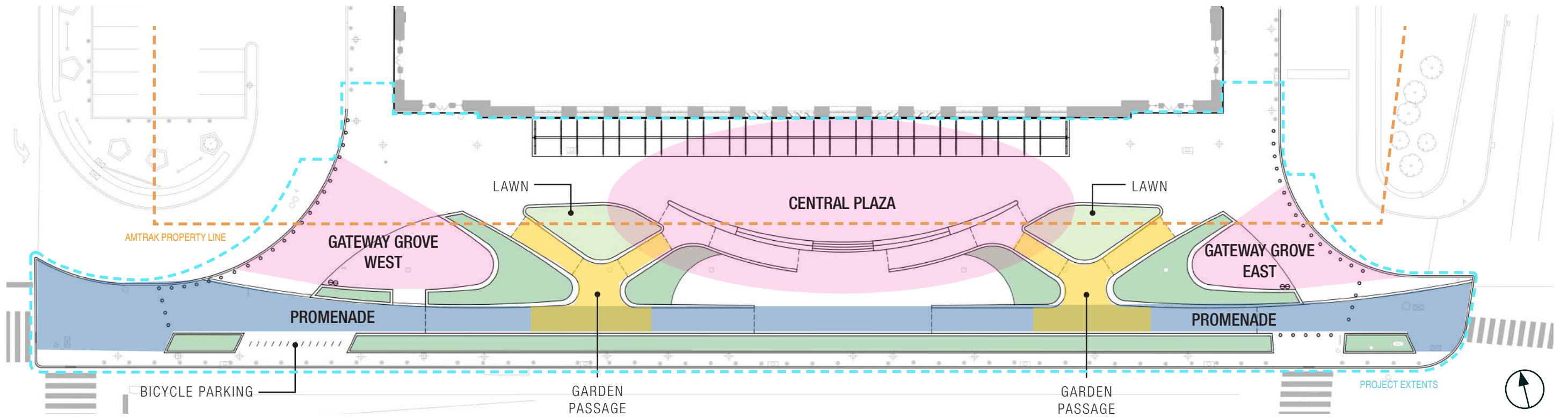

GATEWAY GROVE - WEST



PROMENADE



CENTRAL PLAZA



GARDEN PASSAGE



GATEWAY GROVE - EAST

PEDESTRIAN CIRCULATION

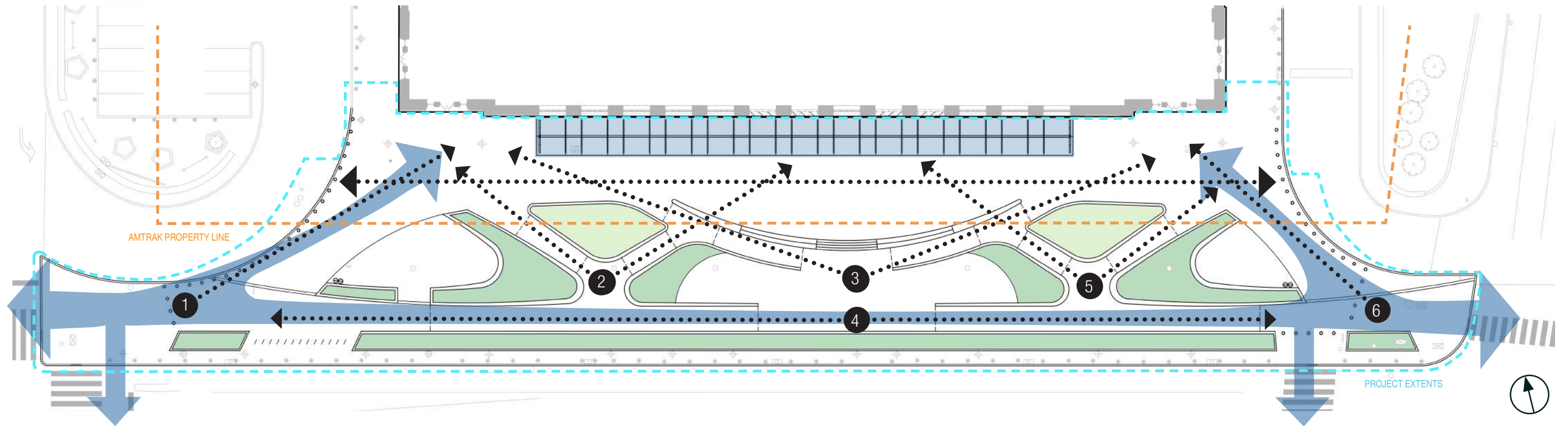

SECTIONS





AMTRAK 30TH STREET STATION MARKET STREET PLAZA
Art Commission Presentation | May 9, 2024



AMTRAK 30TH STREET STATION MARKET STREET PLAZA
Art Commission Presentation | May 9, 2024



AMTRAK 30TH STREET STATION MARKET STREET PLAZA
Art Commission Presentation | May 9, 2024

PAVING – PRECAST PAVERS

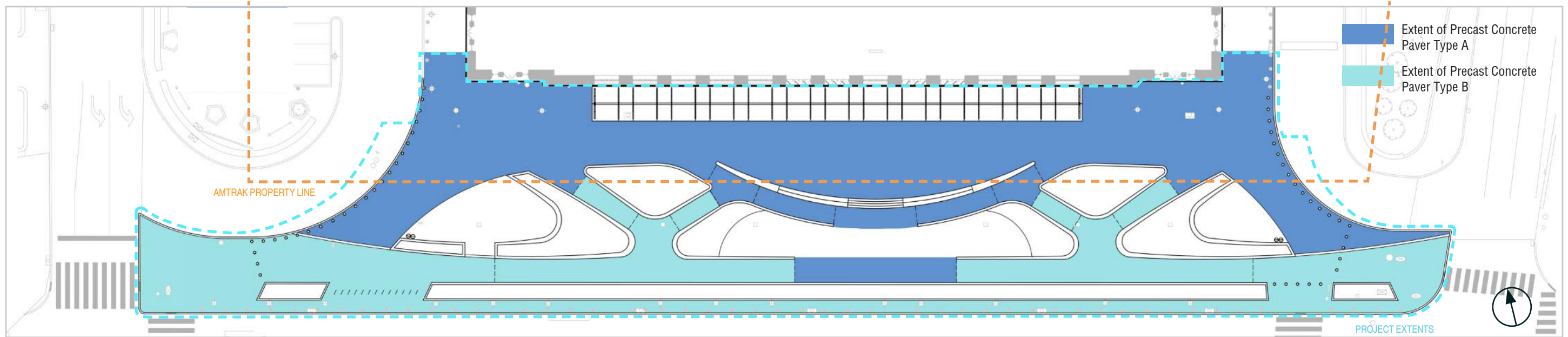

Precast Concrete Paver Type A

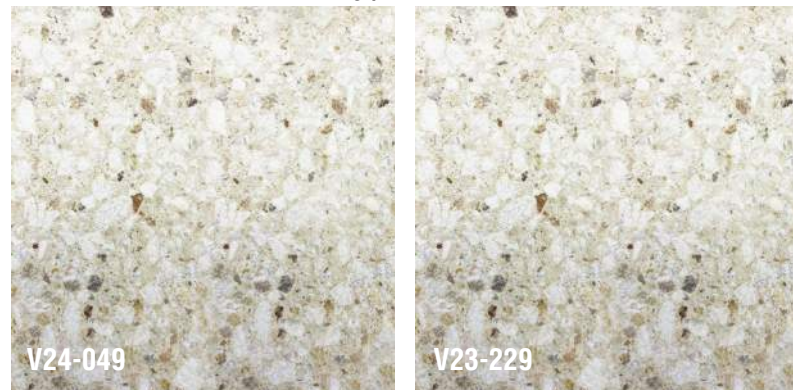

Basis of Design: Type 'A'

V24 – 049 (6" x 12" x 3")

V23 – 229 (6" x 24" x 3")

Manufacturer: Wausau Tile

Precast Concrete Paver Type A



Basis of Design: Type 'A'

V24 – 049 (6" x 12" x 3")

V23 – 229 (6" x 24" x 3")

Manufacturer: Wausau Tile

PAVING – GRANITE

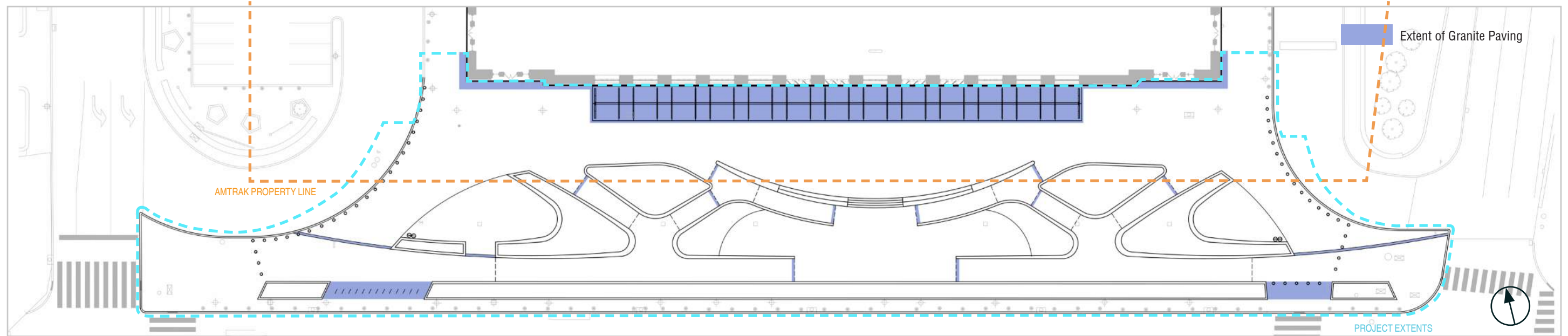

Granite Unit Paving



Basis of Design: Lake Placid Blue
Manufacturer: Coldspring Granite

PAVING – POROUS RESIN-BOUND AGGREGATE

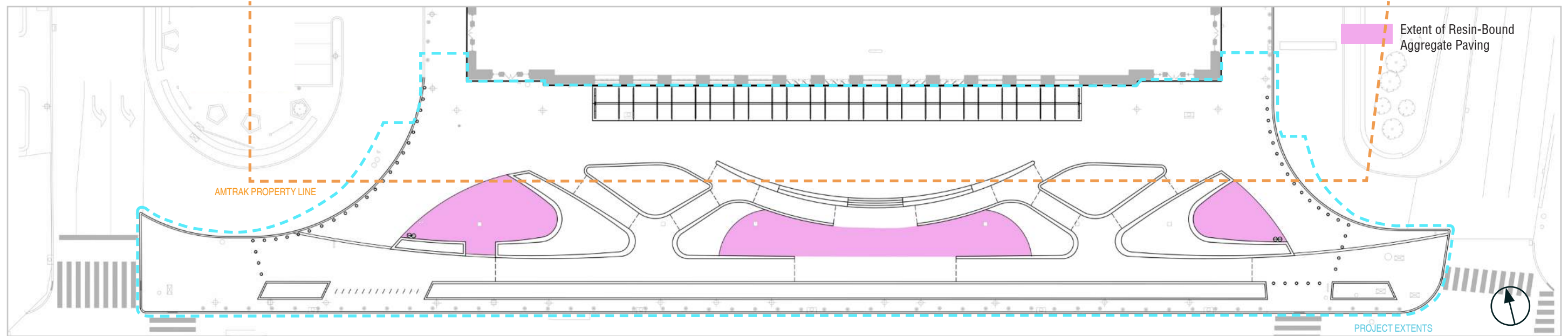

Basis of Design: Mini Pearl
Manufacturer: Sierra Stone

PAVING – PRECAST CONCRETE BENCHES & CURBS

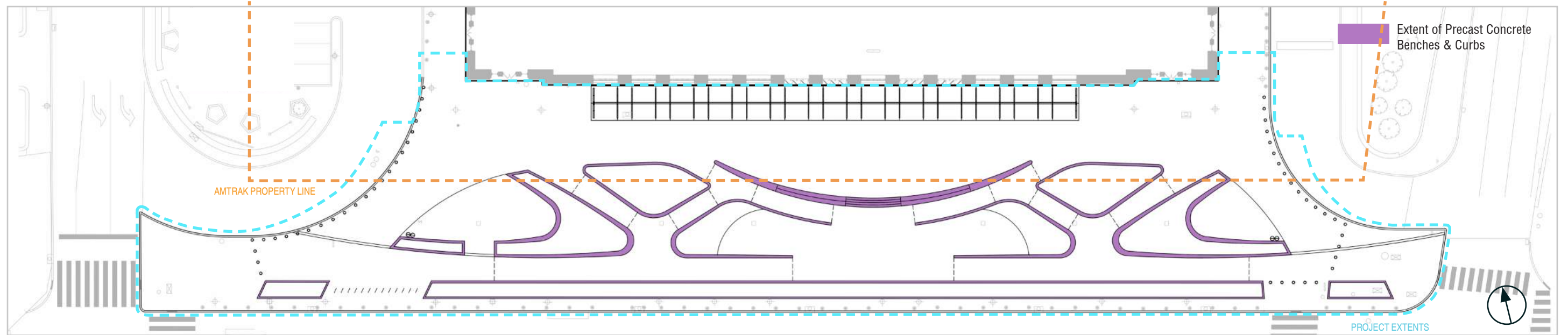

Basis of Design: A20Y
Manufacturer: Wausau Tile

PLANTING | TREES

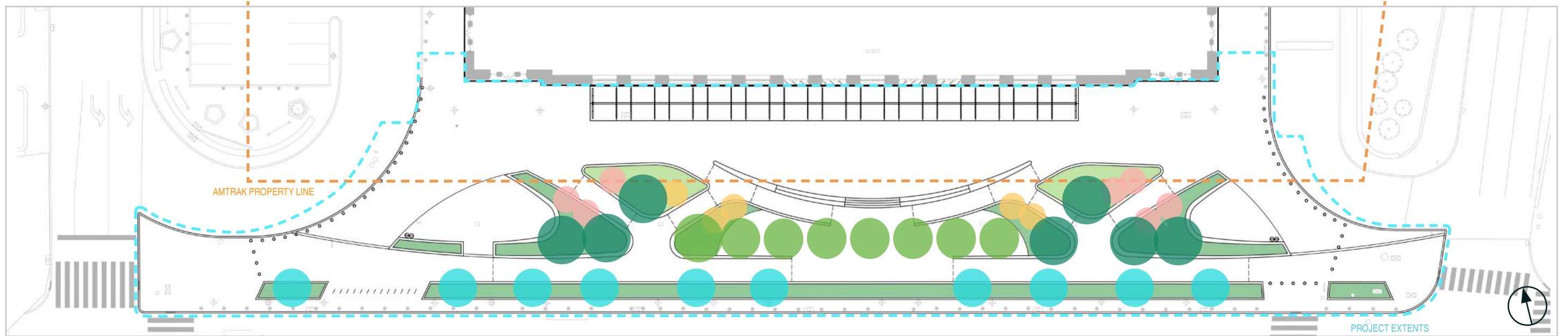

CANOPY TREE
Quercus macrocarpa
 BUR OAK

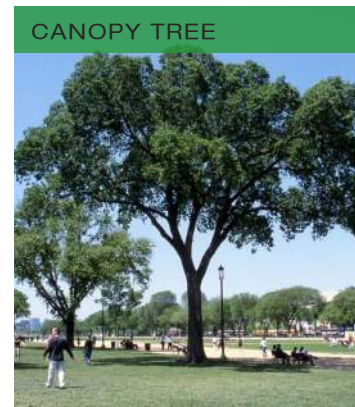

CANOPY TREE
Ulmus americana 'Jefferson'
 AMERICAN ELM



STREET TREE
Quercus phellos
 WILLOW OAK

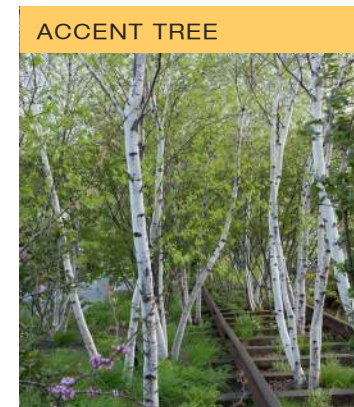

ACCENT TREE
Betula populifolia 'Whitespace'
 GREY BIRCH

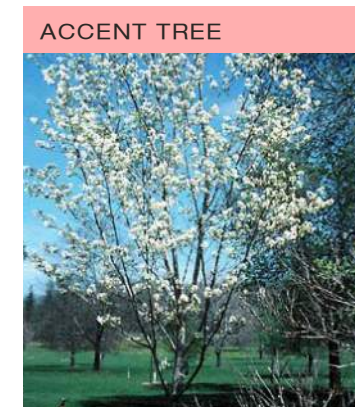

ACCENT TREE
Amelanchier laevis
 ALLEGHENY SERVICEBERRY

PLANTING | GRASSES AND PERENNIALS

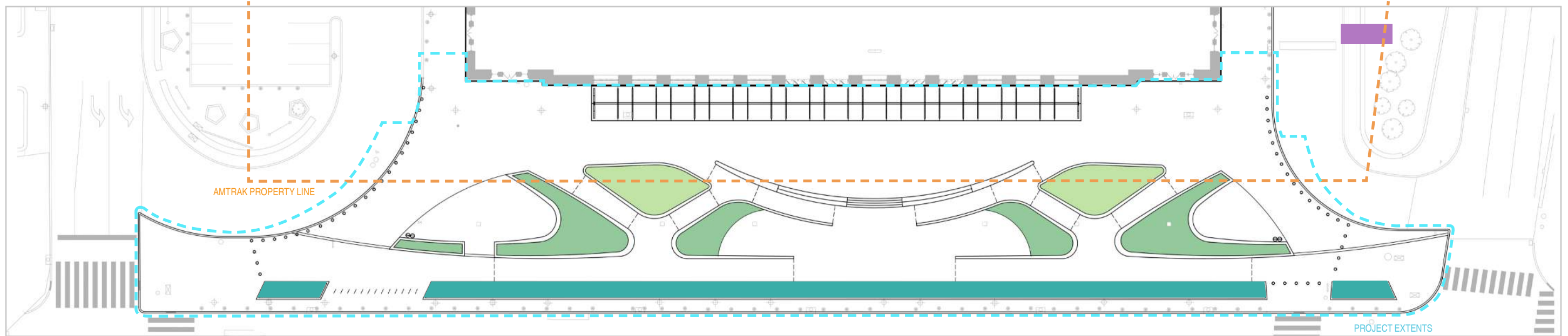

MARKET STREET PLANTERS



Spirea thunbergii 'Ogon'
OGON SPIREA

Miscanthus sinensis 'Adagio'
ADAGIO MAIDEN GRASS

Deschampsia cespitosa
TUFTED HAIR GRASS



Solidago flexicaulis
BROADLEAF GOLDENROD

Echinacea purpurea
CONEFLOWER

Asclepias tuberosa
BUTTERFLY WEED

PORCH PLANTERS



Monarda fistulosa
WILD BERGAMOT

Pycnanthemum tenifolium
MOUNTAIN MINT

Symphotrichum laeve
SMOOTH ASTER

Perovskia atriplicifolia 'Little Spire'
LITTLE SPIRE RUSSIAN SAGE



Tiarella cordifolia
FOAMFLOWER

Veronicastrum virginicum
CULVER'S ROOT

Hylotelephium 'Herbstfreude'
STONECROP 'AUTUMN JOY'

LAWN



LIGHTING

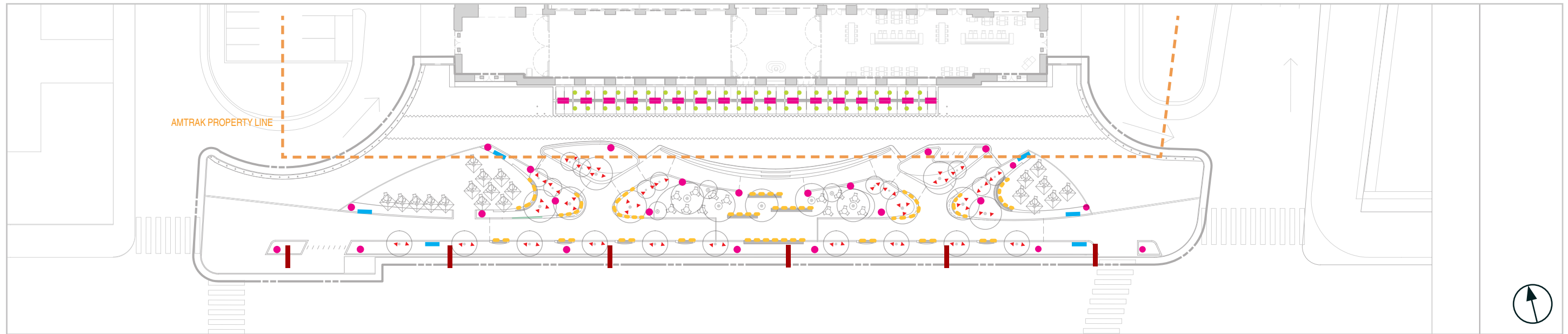

▲ CANOPY
DOWNLIGHT OR STRIP LIGHT



POLE MOUNTED ►
SELUX - OLIVIO



▲ LANDSCAPE RAIL LIGHT



◀ UPLIGHT



▲ STRIP LIGHT

- EX1 POLE LIGHT: SELUX OLIVIO SYSTEMA 2 W/ 20' WOODEN TAPERED POLE. MOUNT 2-4 PER POLE
- ▼ EX2 STAKE MOUNTED UPLIGHT
- EX3 STRIP LIGHT
- EX4 LINEAR CEILING
- EX5 LANDSCAPE LIGHT
- EX6 CANOPY CEILING LIGHT
- EXISTING TRAFFIC POLES TO REMAIN

SIGNAGE SOM | ENTRO

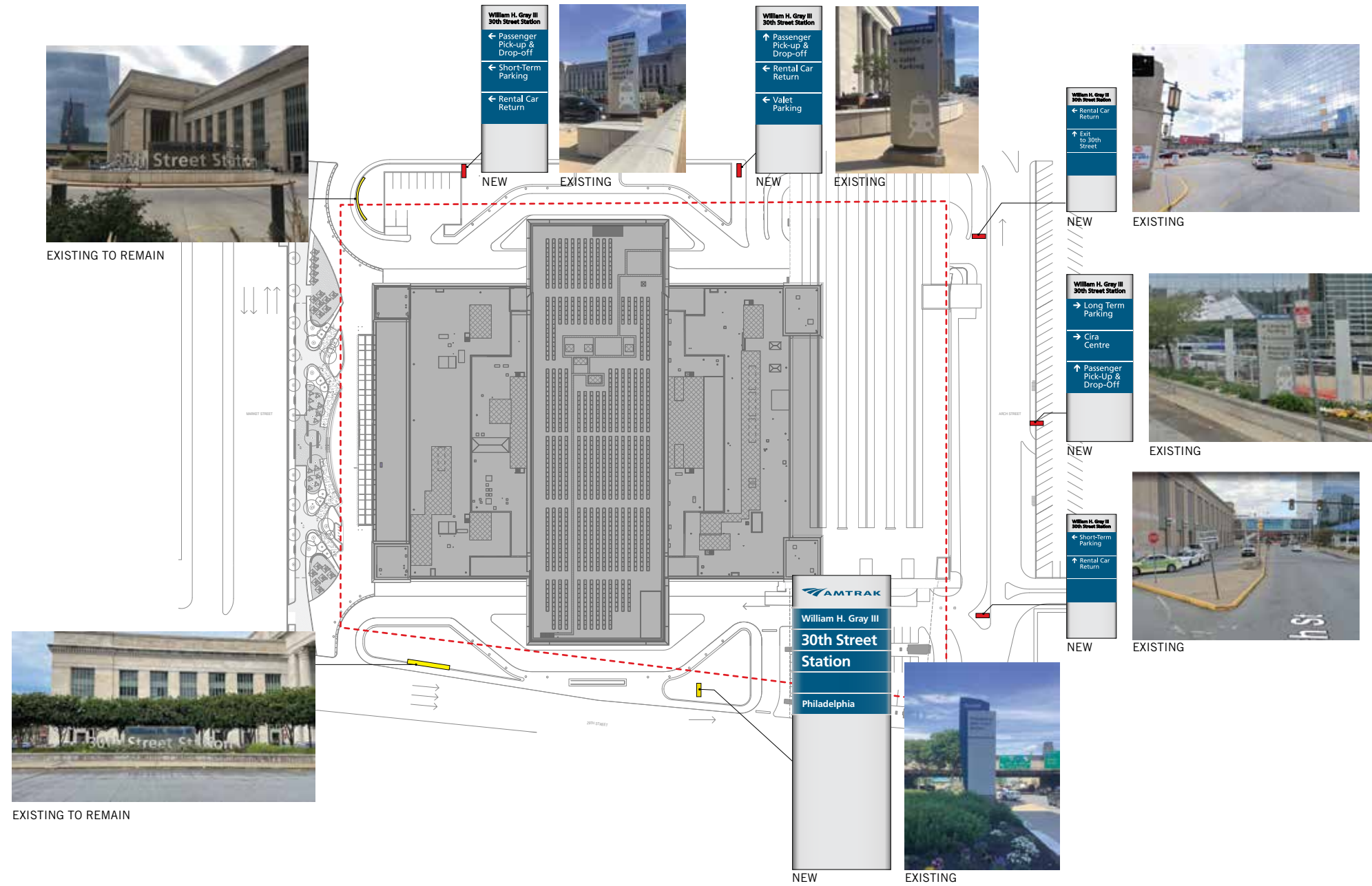

SIGNAGE / SCHUYLKILL AVE SIDE SOM | ENTRO

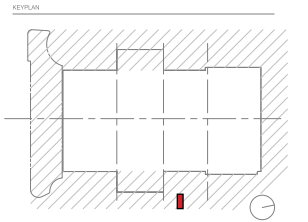

EXISTING SIGNAGE



REPLACEMENT SIGNAGE

SIGNAGE / 30TH STREET SIDE SOM | ENTRO

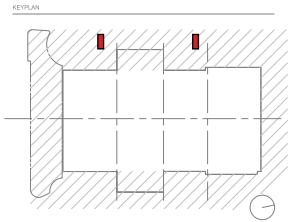

EXISTING SIGNAGE



REPLACEMENT SIGNAGE

SIGNAGE / ARCH STREET SIDE SOM | ENTRO

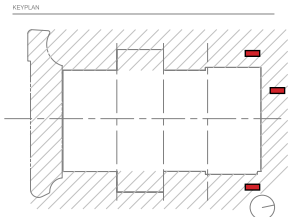

EXISTING SIGNAGE

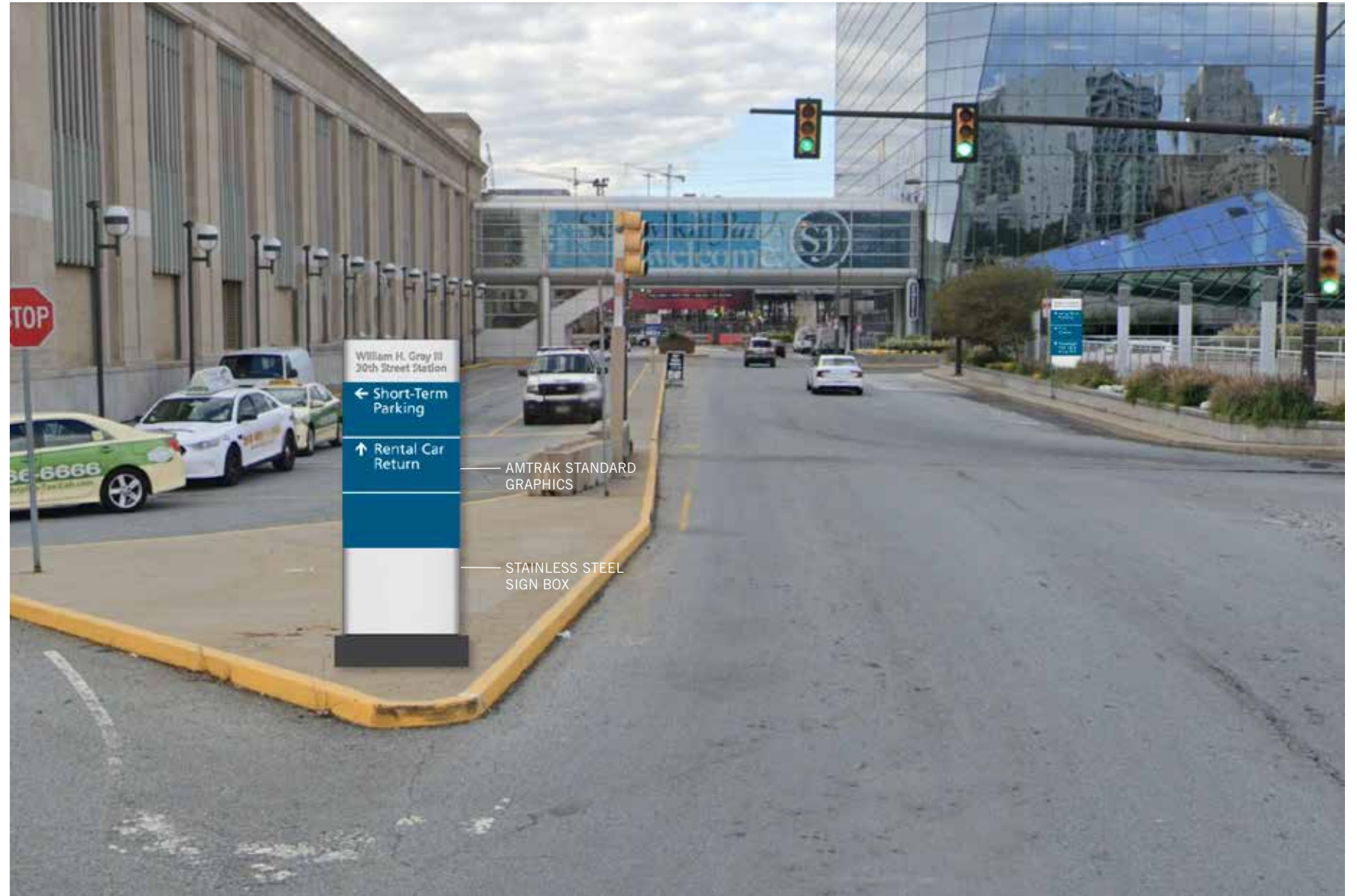

REPLACEMENT SIGNAGE



AMTRAK 30TH STREET STATION MARKET STREET PLAZA
Art Commission Presentation | May 9, 2024