

W.D. KELLY ELEMENTARY SCHOOL
1601-49 N. 28TH STREET
PHILADELPHIA, PA 19121-2798

RE: Electronic Message Board Sign

Dear Art Commission Sign Committee,

The W.D. Kelly Elementary School is proposing to Install an Electronic Message Board Sign on the Mural Wall of the school.

The Proposed Sign would be Accessory to the school, and we would like the sign to be available for non-Accessory use for the community. Such as Public and Municipal personnel i.e.: Police, Fire Departments and local communities.

The school will post Events, announcements that will be related to the school.

Our intent would be for the community to use this proposed electronic message board for public announcements, job fairs, block parties, special events, etc. The Principal, Dr.

Edwards strongly would encourage the Community to utilize the new EMC for such occasions.

No animation will be included with the sign, fixed images-slides only. No motion or flashing.

The timeline of messages for each frame will not be changed for at least 8 seconds (as per the Federal Highway Commission). The school will operate the EMC from 7am - 7pm.

Each Optec Display sign comes with an optical eye that automatically measures the ambient light. Therefore, the sign is brightest (8 nits) during the day and lowest at night. As for a rendering,

that would be difficult to present because each location, weather and time of day will change the brightness of the sign. Here are some guidelines from Optec Displays.

- Full sun? 100% brightness capable.
- Partly sunny? 70-100% brightness capable (varies as the sun hits the sensor)
- Partly cloudy? Between 50% and 100% brightness capable (will vary as sun hits sensor)
- Cloudy/Stormy? Between 30% and 70% brightness capable.
- Dusk will vary according to the 4 kinds of weather above.
- Darkness/Overnight will depend on the ambient light in the area. If no other light sources are available, it could be as low as 5%. If the display is in a city area with lots of light sources, it could go up to 40%

Thank you and look forward to hearing from you,

Sincerely,

Reneé Gross
Taus & Associates
609-707-1141



ELEVATION VIEW

1/2" = 1'-0"

full-color electronic message center, single-sided, extruded aluminum enclosure per header sign, welded/bolted connections to supports, back and side cladding to enclose supports

weather-proof junction box, with disconnect switch

communication antenna and temperature probe (if specified)

120 volt primary in approved conduit to sign by project electrician

Maximum draw of sign is 16 amps at 120 volts

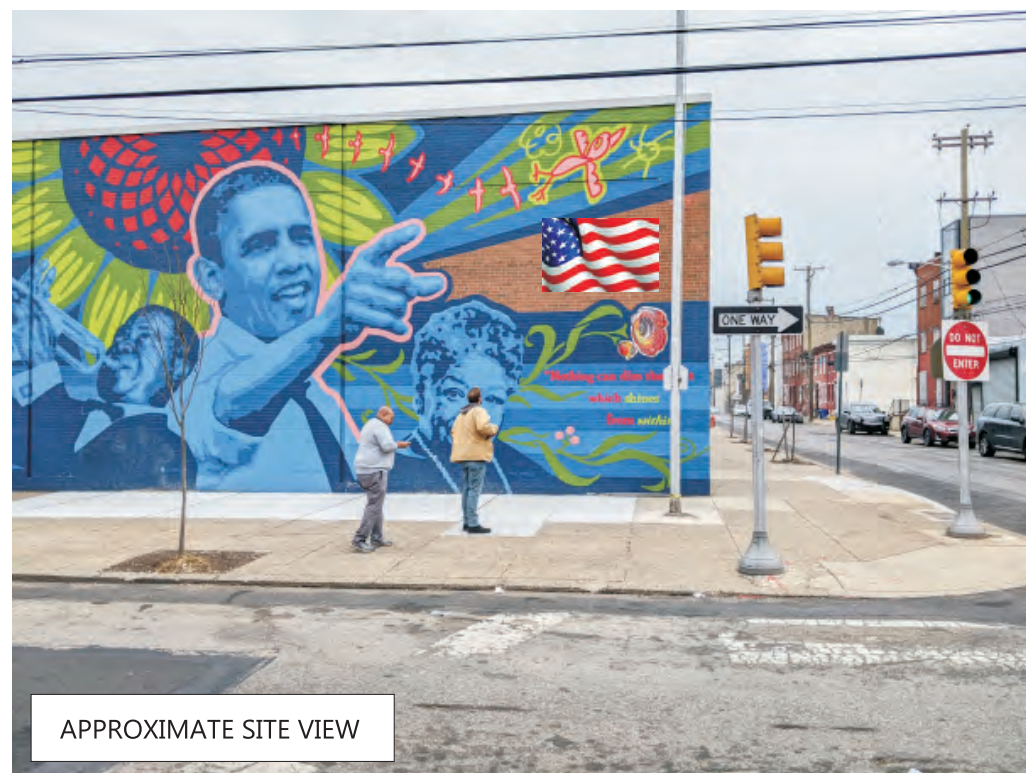

APPROXIMATE SITE VIEW

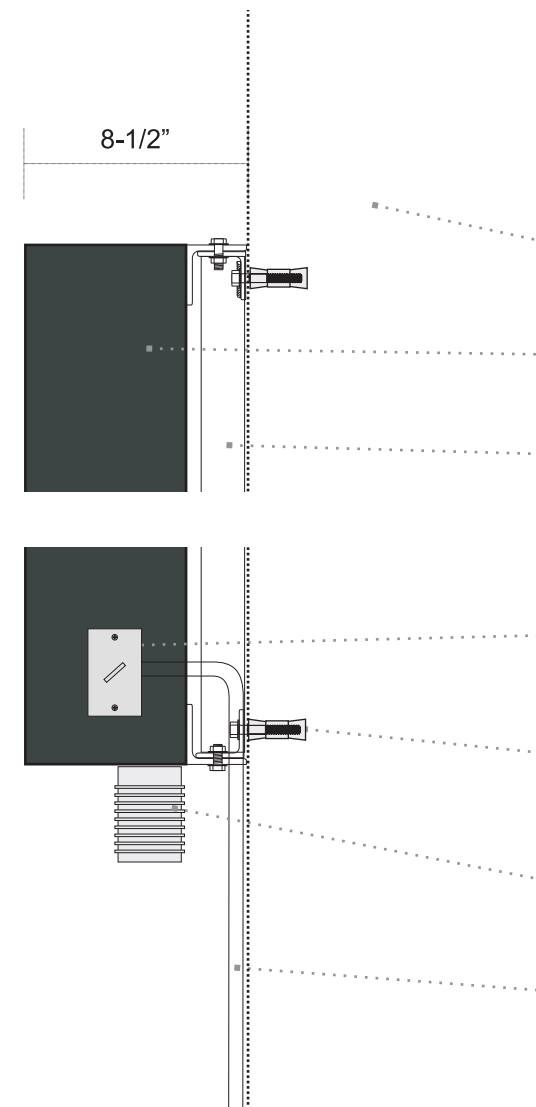

SECTION VIEW

nts

Sound structural masonry wall in excellent condition

Single-sided full color LED message display, ~8-1/2" depth

Welded A36 steel mounting bracket, black painted finish, (8) bolted connections, (4) top, (4) bottom, grade 5 (min) non-corrosive 3/8" steel bolts, evenly spaced

Weather-proof junction box with disconnect switch

3/8" diameter double-expansion anchor, 1-1/2 min embedment, (8) required, (4) top, (4) bottom, evenly spaced

Temperature probe, brightness sensor, and comm antenna located on bottom of sign

120 volt primary in approved conduit to sign by project electrician



Satin black painted finish



LISTED

Illuminated Electronic LED Message Sign
(1) SINGLE-SIDED SIGN AS SHOWN REQUIRED

53688

W B Kelley Elementary School

1601 N 28th St,
Philadelphia, PA 19121

Advanced Color Signs & Graphics

Newtown, PA 215-579-9558

Date	10-9-23, 10-11-23, 2-19-24	Scale	as shown
Drawn By	HRMc	Drawing No.	53688

NOTES

- maximum draw of sign is 16 amps @ 120 volts
- (1) 120v, 20 amp, dedicated primary circuits in approved conduits to sign by project electrician according to NEC and sign manufacturers specifications
- service disconnect toggle switch to be located on junction box
- sign control at panel (time-clock) is by project electrician
- primary leads will be routed to junction box by sign installer for final connection by project electrician
- location temp probe and antenna is approximated

SHEET

1 of 1

REVISION #

2

SEAL:

NOT ISSUED FOR CONSTRUCTION

LANDSCAPE ARCHITECT AND CIVIL ENGINEER
GILMORE AND ASSOCIATES INC.
1817 JFK BLVD, Suite 425
Philadelphia, PA 19103
Phone: 215-687-4246
Attn: Kevin Selger, RLA

SURVEYOR
CEADERVILLE ENGINEERING GROUP, LLC
159 East High Street, Suite 500
Pottstown, PA 19464
Phone: 610-705-4500

GENERAL NOTES:

- THE SITE FEATURES AND TOPOGRAPHY AS SHOWN ARE BASED ON A FIELD SURVEY PERFORMED BY CEADERVILLE ENGINEERING GROUP, LLC IN SEPTEMBER 2021
- THE PROPERTY LINES SHOWN ARE BASED ON THE METES AND BOUNDS DESCRIPTION CONTAINED IN THE VESTING DEED OF THE SUBJECT PROPERTY ONLY. NO TITLE RESEARCH WAS PERFORMED IN PREPARATION OF THIS PLAN. EASEMENTS, RESTRICTIONS AND/OR COVENANTS MAY APPLY.
- LOCATIONS OF EXISTING UNDERGROUND UTILITIES/FACILITIES SHOWN HEREON HAVE BEEN DEVELOPED FROM ABOVE GROUND OBSERVATION OF THE SITE. NO EXCAVATIONS WERE PERFORMED IN PREPARATION OF THIS DRAWING. THEREFORE ALL UTILITIES SHOWN SHOULD BE CONSIDERED APPROXIMATE IN LOCATION, DEPTH, AND SIZE. THE POTENTIAL EXISTS FOR OTHER UNDERGROUND UTILITIES/FACILITIES TO BE PRESENT WHICH ARE NOT SHOWN ON THIS DRAWING. ONLY THE VISIBLE LOCATIONS OF UNDERGROUND UTILITIES/FACILITIES AT THE TIME OF THE FIELD SURVEY SHALL BE CONSIDERED TRUCK AND ACCURATE. COMPLETENESS OR ACCURACY OF UNDERGROUND UTILITIES/FACILITIES ARE NOT GUARANTEED BY GILMORE & ASSOCIATES INC.
- THE BENCHMARK IS TO BE OBTAINED FROM THE PHILADELPHIA DISTRICT SURVEYOR.
- ALL CONTRACTORS WORKING ON THIS PROJECT SHALL VERIFY LOCATION AND DEPTH OF ALL UNDERGROUND UTILITIES FACILITIES PRIOR TO THE START OF WORK AND SHALL COMPLY WITH THE REQUIREMENTS OF P.L. 852, NO. 287 DECEMBER 10, 1974 AS LAST AMENDED ON APRIL 28, 2018, PENNSYLVANIA ACT 50. GILMORE & ASSOCIATES INC. HAS OBTAINED A PA-ONE CALL SERIAL NUMBER XXXXXXXXXXXX FOR DESIGN PURPOSES ONLY.

CONCRETE NOTES:

- PROVIDE CAST-IN-PLACE CONCRETE WITH A MINIMUM 28-DAY COMPRESSIVE STRENGTH OF 4,000 PSI AND IN ACCORDANCE WITH THE CURRENT VERSION OF ACI-318 "BUILDING CODE REQUIREMENTS FOR REINFORCED CONCRETE."
- CONCRETE SHALL CONTAIN EITHER A WATER-REDUCING, PLASTICIZING ADMIXTURE OR A HIGH-RANGE WATER-REDUCING ADMIXTURE. ALL CONCRETE SHALL CONTAIN AN AIR-ENTRAINING ADMIXTURE TO PROVIDE 5%-7% AIR ENTRAINMENT. MAXIMUM CHLORIDE CONTENT SHALL BE 0.15% MAXIMUM WATER/CEMENT RATIO SHALL BE 0.45. MAXIMUM DESIGN SLUMP OF 3 INCHES WITHOUT SUPER PLASTICIZERS. AGGREGATE SIZE SHALL BE 3/4 OF AN INCH WITH A DESIGNATION OF 45 PER ASTM C33.
- WELDED WIRE FABRIC SHALL BE GALVANIZED AND COMPLY WITH ASTM A185.
- REINFORCING STEEL BARS SHALL BE GRADE 60 PER ASTM A615.
- SUBMIT MIX DESIGN TO THE OWNER'S REPRESENTATIVE FOR APPROVAL. THE OWNER'S REPRESENTATIVE MAY REJECT DESIGN MIX FOR NON-COMPLIANCE. RE-SUBMIT DESIGN MIX UNTIL DESIGN PROFESSIONAL APPROVES.
- MOIST CURE ALL CONCRETE WORK AND COMMENCE MOIST CURING AS SOON AS FINISHES WILL NOT BE MARKED. INSULATING BLANKETS WATERPROOFED KRAFT PAPER, OR POLYETHYLENE FILM AS PER ASTM C-171 SHALL BE USED TO KEEP THE CONCRETE CONTINUOUSLY MOIST DURING THE CURING PROCESS.
- CONCRETE WALKING SURFACES SHALL HAVE A NON-SLIP FINISH. JOINTS SHALL BE TOOLED FIRST AND THEN CONCRETE SURFACE SWEEPED FOR NON-SLIP FINISH TO ELIMINATE "WINDOW PANE" LOOK. "WINDOW PANE" CONCRETE FINISH WILL NOT BE ACCEPTED.
- CONCRETE SHALL BE PLACED ON A MINIMUM OF 4 INCHES OF COMPACTED CRUSHED AGGREGATE (NO. 57 OR 3/4 INCH CLEAN) PLACED ON COMPACTED SUBGRADE. SUBGRADE SHALL BE NON-YIELDING.

ASPHALT PAVING NOTES:

- PAVING WORK IS LIMITED TO REPLACEMENT OF EXISTING ASPHALT PAVING WHERE REMOVAL OF EXISTING ASPHALT IS REQUIRED FOR THE INSTALLATION OF UNDERGROUND UTILITIES.
- COMPLY WITH APPLICABLE SECTIONS AND PROVISIONS OF THE STANDARD SPECIFICATION OF PAVEMENT CONSTRUCTION PER PENNDOT PUBLICATION 408. BITUMINOUS MATERIALS SHALL BE APPLIED WHEN THE SURFACE IS DRY, FIRM AND CURED, AND OTHERWISE ACCEPTABLE.
- CONTINUITY: NEW PAVING SHALL BE OF LIKE COMPOSITION OF INGREDIENTS FOR UNIFORMITY AND THICKNESS AND SHALL MATCH THE FINISH OF EXISTING ASPHALT PAVING.
- PERFORM THE WORK WITHOUT STAINING OR INJURY TO OTHER PERMANENT WORK, INCLUDING CURBS AND SIDEWALKS.
- WHERE NEW PAVING MEETS EXISTING, CUT EXISTING PAVING AS REQUIRED WITH A POWER SAW TO CLEAN STRAIGHT LINES WITH VERTICAL EDGES. CUT THE EXISTING PAVEMENT TO ALLOW AN OVERLAP OF ONE FOOT OF NEW WEARING COURSE OVER THE EXISTING BINDER COURSE ALONG THE CONTINUOUS EDGES OF THE TRENCH.
- APPLY PRIMER OF TACK COAT TO ALL EXPOSED SURFACES OF EXISTING PAVING AND BINDER COURSES.
- SEAL PAVEMENT JOINTS AND ALONG PAVEMENT/CURB INTERFACE WITH WG64-22 HOT BITUMINOUS JOINT SEAL.
- INSTALL SUPPORT GEOTEXTILE FABRIC OVER JOINTS IN ACCORDANCE WITH THE MANUFACTURER'S RECOMMENDATIONS.
- THE NEW PAVING SHALL PROVIDE A SMOOTH TRANSITION TO EXISTING PAVING WITHOUT ABRUPT CHANGE IN GRADE. MAINTAIN POSITIVE DRAINAGE AND ELIMINATE LOW SPOTS.

LEGEND

- PROPOSED DEPAVED AREA
- PROPOSED ASPHALT PAVING
- PROPOSED SUBSURFACE STONE
- STORMWATER STORAGE FOOTPRINT
- PROPOSED TREE
- PROPOSED TRENCH DRAIN
- PROPOSED DUAL TRAP INLET
- PROPOSED GREEN HIGHWAY INLET
- PROPOSED HIGHWAY INLET
- PROPOSED GREEN CITY INLET
- PROPOSED STORMWATER CLEANOUT
- PROPOSED DOMED RISER STRUCTURE

LEGEND	
Water Curb Box	Unknown Utility Manhole
Gas Curb Box	Utility Manhole
Water Box	Grating
Unknown Curb Box	Cellar Door
Pole	Steps
Lamp Post	Porch
PECo Pole	Planter
PECo Pole w/ Light	Bus Shelter
SEPTA Pole	Curb Ramp
Traffic Light	Compliant Curb Ramp
Traffic Sign	Tree/Trunk Size in "
Iron Pole	Tree Stump w/ Trunk in "
Bollard	Existing Pavement Markings
Parking Meter	Hedge
Parking Kiosk	Trash Receptacle
Standpipe	Fence
Clean Out	Right-of-Way Line
Down Spout	Bike Rack
Mail Box	Existing Top/Bottom of Step
Hand Hole	Existing Top/Bottom of Curb
Cable Handhole	Existing Spot Elevation
Survey Stone	Concrete Curb
Traffic Control Box (Above Ground)	G. Curb
Verizon Junction Box (Above Ground)	Sl. Curb
Bench Mark	Concrete Footway
Sewer Manhole	Br. Ftw.
Water Valve	A. Ftw.
Fire Hydrant	Sl. Ftw.
Electrolysis Test Station	Dep. Curb
Highway Grate Inlet (4 Denotes 4 FT, 6 Denotes 6 FT)	Br. Gutter
Open Mouth (4 Denotes 4 FT, 6 Denotes 6 FT)	D/W
Grate Inlet (6 Denotes 6 FT)	Driveway
City Inlet (6 Denotes 6 FT)	St. Wall
Old City Inlet (4, 6, 8, 10, 12 Denotes Size)	Br. Wall
Old Grate Inlet (4, 6, 8, 10, 12 Denotes Size)	C. Wall
Gas Valve	S.R.E.
Door Sill	Sewer Return Location

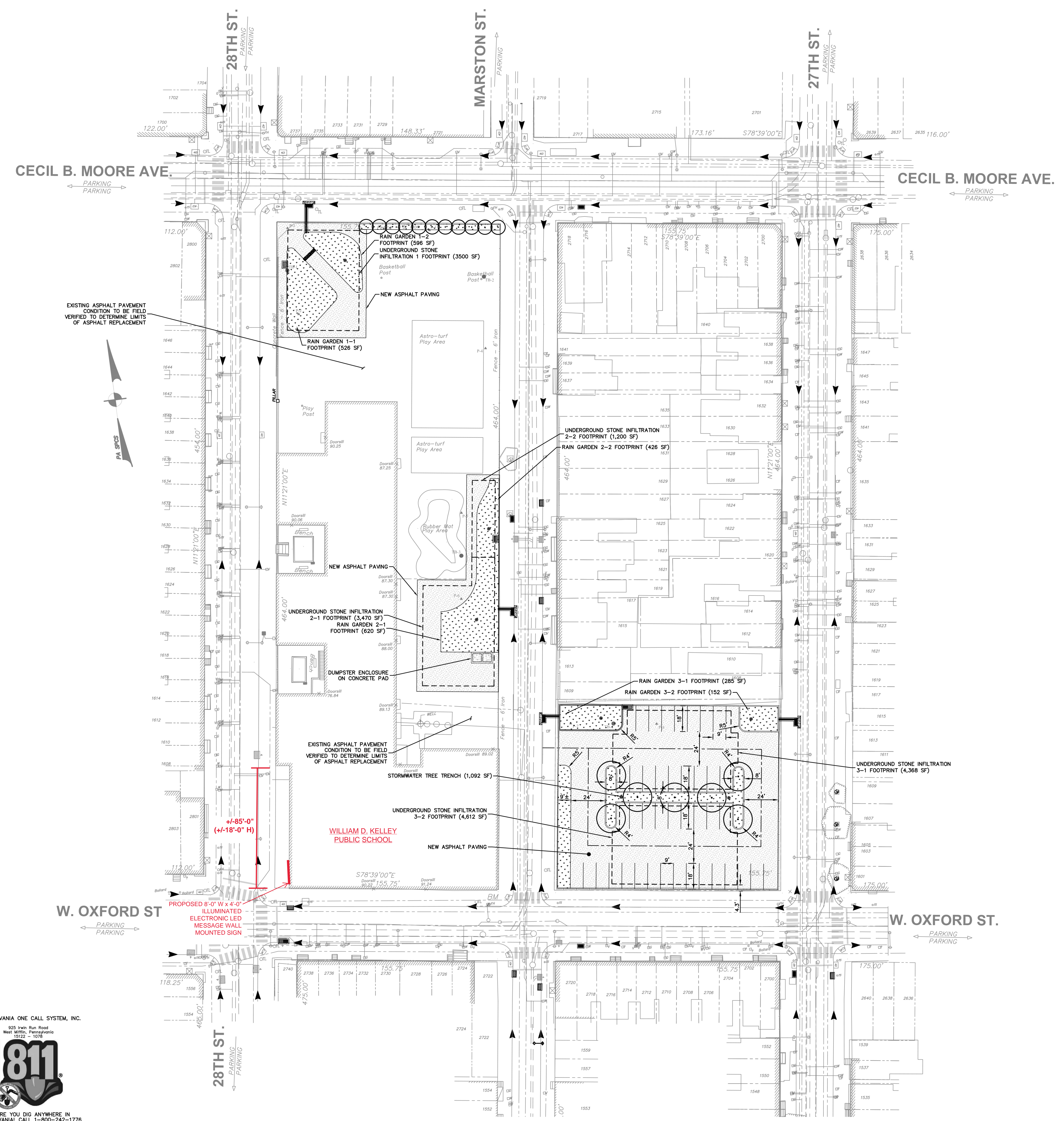
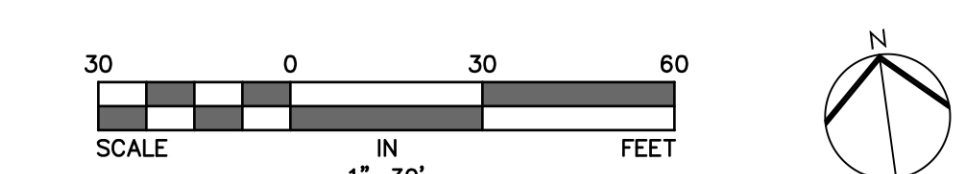

PENNSYLVANIA ONE CALL SYSTEM, INC.
825 Twin Run Road
West Mifflin, Pennsylvania
15122 - 1078

BEFORE YOU DIG ANYWHERE IN PENNSYLVANIA CALL 1-800-242-1776
NON-MEMBERS MUST BE CONTACTED DIRECTLY
PA LAW REQUIRES THREE WORKING DAYS NOTICE TO UTILITIES BEFORE YOU EXCAVATE.
DRILL, BLAST OR TRENCH

PRELIMINARY DESIGN SUBMISSION
OCTOBER 1, 2021

NO.	DATE	REVISION
10		
9		
8		
7		
6		
5		
4		
3		
2		
1		

SCHOOL & LOCATION
WILLIAM D. KELLEY SCHOOL
1601 N. 28TH STREET

PROJECT TITLE
GREEN STORMWATER IMPROVEMENT PROJECT

DRAWING TITLE
SITE PLAN

DRAWING SCALE	FILE NO.
1" = 30'	7029
LOCATION NO.	CHECKED BY
7029	KMS
DRAWN BY	CONSULTANT CONTRACT NO.
JJK	

DRAWING NO.
L-2.0

SHEET OF 6



ONE WAY

DO NOT ENTER



← ONE WAY

Mini Market LLC
Cigarettes * Beverages * Snacks
Wic Program * Food Stamps
Candy * Dairy and more...

ATM
HOT FOOD

7 DAYS
Welcome

ONE WAY





OXFORD ST
2700 W 2800 E

ONE WAY

Fw:] W. B. Kelley Elem. EMC Sign -response from Mural Artist ZP-2023-013453

Renee Gross <reneeg10@aol.com>

Wed 4/10/2024 9:44 AM

To: Katherine Liss <Katherine.Liss@Phila.gov>; Mina Monavarian <Mina.Monavarian@Phila.gov>; Art Commission <ArtCommission@phila.gov>; Paulose Issac <Paulose.Issac@phila.gov>
Cc: brad@acgcolor.com <brad@acgcolor.com>

External Email Notice. This email comes from outside of City government. Do not click on links or open attachments unless you recognize the sender.

Good Morning All,

The Mural Artist responded in a positive way to the sign on the Mural Wall. Please see his approval letter below and please let us know if this is official enough to satisfy that requirement.

Thank you,

Reneé Gross
609-707-1141

From: "David McShane" <david.mcshane@muralarts.org>
Sent: 4/9/24 11:23 AM
To: brad@acgcolor.com
Cc: Emma Lynn Melvin <emelvin@philasd.org>
Subject: Re: [EXTERNAL SENDER] W. B. Kelley Elem. EMC Proposal

Hi Brad,

Thank you for reaching out to me. I was the lead artist on that mural project, and appreciate your sensitivity toward the aesthetics of the mural and sign placement. I do not want to stand in the way of the sign going up - especially if the Principal sees it as an important communication tools with parents and community. Based on the attached photo you sent - the sign doesn't obstruct or interfere with the mural imagery, which I appreciate. The one thing I would ask is that any wires that may need to lead to the sign to provide the electricity similarly be sensitively placed (so they don't cut across one of the faces of the portraits, for instance).

Best of luck in the project,
Dave McShane

David McShane
Director of Resident Artists



**Mural Arts
Philadelphia**
Roots & Reimagination
40th Anniversary

Mural Arts Philadelphia
The Lincoln Financial Mural Arts Center
1727-29 Mount Vernon Street
Philadelphia, PA 19130
610-324-9193
david.mcshane@muralarts.org