

Existing



Proposed



Illuminated Wall Sign

4-1/2"thk Single Face Illuminated Sign Cabinet to Match Existing
 Installed as shown
 Further Detail on Following Page

Scale
 3/8" = 1' 0"

Square Footage:
 56.6 SF

Color:

- Pantone 282c (satin finish)
- Pantone 2915c (satin finish)
- MP 22085 (satin finish)

DRAWINGS PREPARED BY:

WURZ SIGN SYSTEMS

2600 Haddonfield Rd. Pennsauken, NJ 08110
 Phone: (856) 461-4397 Fax: (856) 461-4398

This is an original unpublished drawing created by WURZ SIGN SYSTEMS. It is submitted for your exclusive use, in connection with a project being planned. It is not to be shown to anyone outside your organization, nor is it to be used, reproduced, copied or exhibited in any fashion. This drawing is the property of WURZ SIGN SYSTEMS

REVISIONS

Rev01	Revised as noted	02-22-24
Rev02	Revised as noted	03-06-24

LOCATION

Jefferson Gibbon Building
 111 South 11th Street
 Philadelphia, PA 19107

DRAWN BY: AFR **SCALE:** AS NOTED

DRAWN: 02/22/24 **SALES:** BW

Jefferson_Bookstore_02-22-24

JOB#: T01798 **SHT #:** 1

NIGHT PERSPECTIVE



DRAWINGS
PREPARED BY:

WURZ SIGN SYSTEMS

2600 Haddonfield Rd. Pennsauken, NJ 08110
Phone: (856) 461-4397 Fax: (856) 461-4398

This is an original unpublished drawing created by WURZ SIGN SYSTEMS. It is submitted for your exclusive use, in connection with a project being planned. It is not to be shown to anyone outside your organization, nor is it to be used, reproduced, copied or exhibited in any fashion. This drawing is the property of WURZ SIGN SYSTEMS

REVISIONS

Rev01 Revised as noted 02-22-24
Rev02 Revised as noted 03-06-24

LOCATION

Jefferson Gibbon Building
111 South 11th Street
Philadelphia, PA 19107

DRAWN BY: AFR SCALE: AS NOTED

DRAWN: 02/22/24 SALES: BW

Jefferson_Bookstore_02-22-24

JOB#: T01798 SHT #: 2

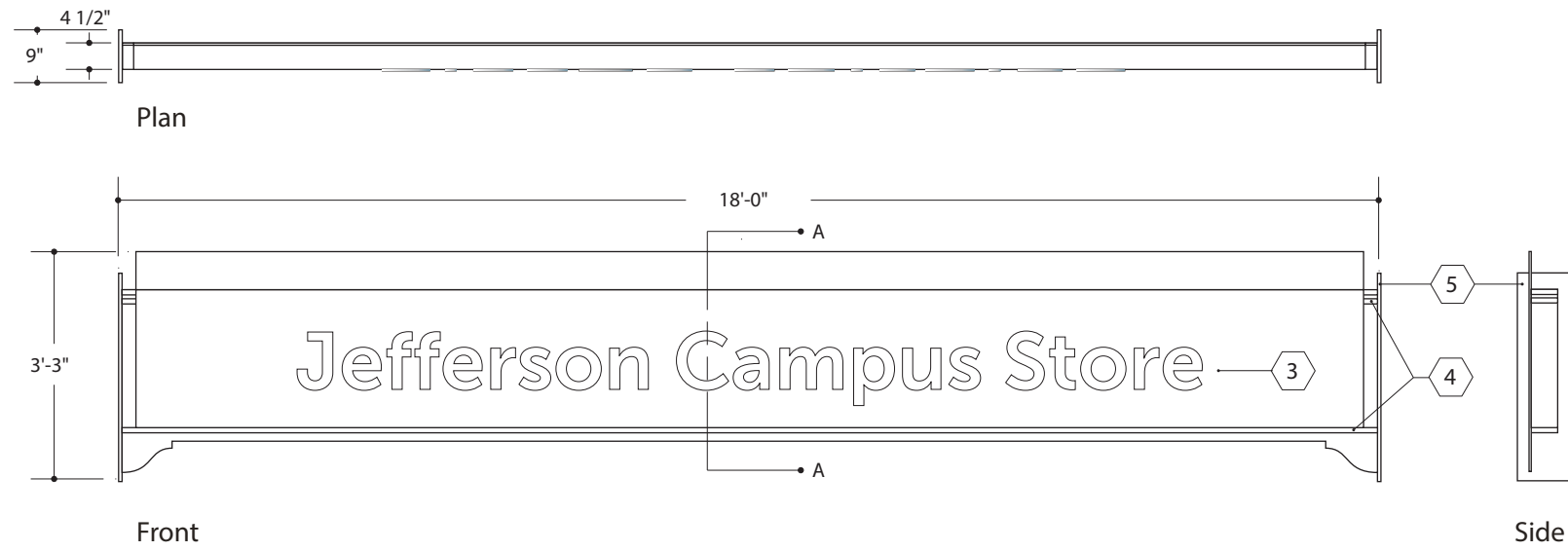

1 Elevations
scale: 3/8"=1'-0"



2 Detail
scale: 3/8"=1'-0"

- 1 3/8" alum back panel
- 2 .090 alum pan face
- 3 Push through plastic letters
- 4 Ø 4 1/2"x 7/8" wall extruded alum tube cross supports
- 5 3/8" alum mounting plates
- 6 LED light modules
- 7 Custom alum brackets welded to back panel and pan face

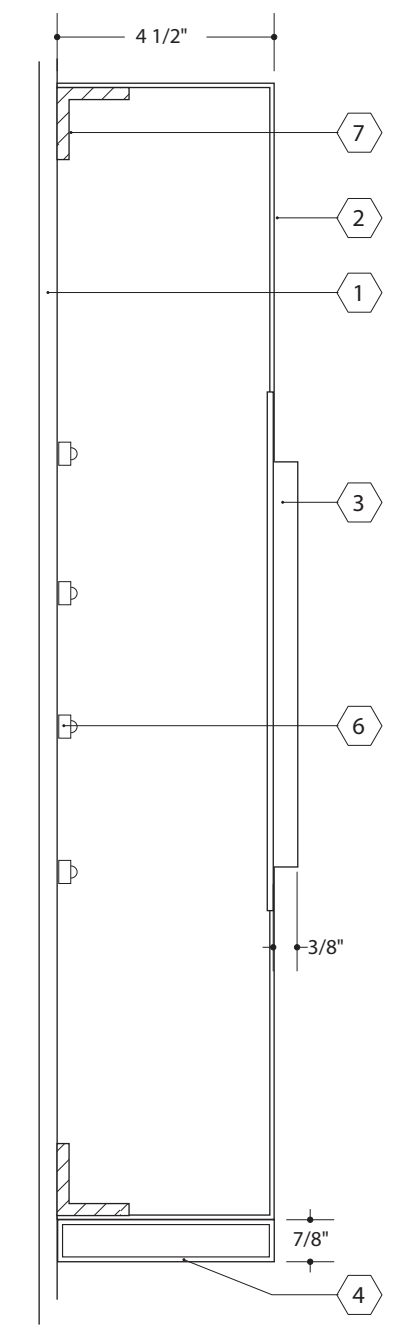

3 Section detail
scale: 3"=1'-0"

DRAWINGS PREPARED BY:

WURZ SIGN SYSTEMS
 2600 Haddonfield Rd. Pennsauken, NJ 08110
 Phone: (856) 461-4397 Fax: (856) 461-4398

This is an original unpublished drawing created by WURZ SIGN SYSTEMS. It is submitted for your exclusive use, in connection with a project being planned. It is not to be shown to anyone outside your organization, nor is it to be used, reproduced, copied or exhibited in any fashion. This drawing is the property of WURZ SIGN SYSTEMS

REVISIONS

Rev01	Revised as noted	02-22-24
Rev02	Revised as noted	03-06-24

LOCATION
Jefferson Gibbon Building
 111 South 11th Street
 Philadelphia, PA 19107

DRAWN BY:	AFR	SCALE:	AS NOTED
DRAWN:	02/22/24	SALES:	BW
Jefferson_Bookstore_02-22-24			
JOB#:	T01798	SHT #:	3

Jefferson

Jefferson Mimmel Medical Coll

Thomas Jefferson Univer



erson

Animal Medical Coll

Tho



Thomas Jefferson University Hospital

Jefferson Health.

leading
optimistic
revolutions

MSR-9834



leading
optimistic
revolution

100



Thomas Jefferson University Hospital

be bold
& think
differently

giving.jefferson.edu

COMFORT



Jefferson Health.

fueling
tomorrow's
innovations

jefferson.edu

reimagining
since
1824

giving.jefferson.edu

Thomas Jefferson University Hospital





Jefferson Health

Jefferson
Improving Our World's Health

Mikros

TRASH

Jefferson

GIBBON BUILDING

111 South 11th Street

ONE WAY



Jefferson Health



Thomas Jefferson University Hospital

Thomas Jefferson University Hospital

enterprise
truck rental

LLC
1st St
74134

Thomas Jefferson University Hospital

Thomas Jefferson University Hospital

Jefferson Health
Simon Kimmel Cancer Center
NCI - Designated





DRIVE THROUGH ENTRANCE
PATIENTS
DROP-OFF AND PICK-UP
CLEARANCE 8'7"

NO PARKING
IN FRONT OF
BUILDING
EXCEPT FOR
EMERGENCY
VEHICLES
ONLY

NO PARKING
IN FRONT OF
BUILDING
EXCEPT FOR
EMERGENCY
VEHICLES
ONLY



Sidney Kimmel Cancer Center
1120 University
Baltimore, Maryland



Sidney Kimmel Cancer Center - Baltimore



Jefferson Health

Jefferson Health.

Sidney Kimmel Cancer Center
NCI - Designated
Radiation Oncology

Sidney Kimmel Cancer Center - Bodine

 **KEYSTONE**
QUALITY TRANSPORT

PUC A 00011207





MEDICAL TRANSPORTATION DIVISION

ambulnz
AMBULANCE
214

CAT





FedEx

Express

fedex.com
1.800.Go.FedEx

MT. LAUREL, NJ
08054



we
improve
lives



Blood Donor Center

WORTHEN

Thomas Jefferson University Hospital

Blood Donor Center

health

Thomas Jefferson University Hospital

NO PARKING
FIRE DEPARTMENT

Blue vertical sign with white text



Jefferson Health

Jefferson Health

Jefferson University Hospital

Thomas Jefferson University



Home of Sidney Kimmel



College



Jefferson Health
Sidney Kimmel Cancer Center
NCI - Designated



Blue informational sign on the building wall.

200
Creating Our
World's Future
Jefferson
CHESTNUT



au bon pain

au bon pain.

the bakery café



rain

the bakery café









au bon pain.

The bakery café

ONLY
LIMIT

AT

PLAY
TODAY!

PENNSYLVANIA
BATTERY



ty Hospital

Jefferson

NO PARKING
ANYTIME
MON-FRI
7:00 AM - 6:00 PM
VIOLATORS
TO BE TOWED
AT OWNER'S RISK

au bon pain

au bon pain

uncompromising care
Jefferson Health.
PART OF PENNSYLVANIA STATE UNIVERSITY



bon pain

au bon pain

Jefferson Health

Compromising care

Jefferson Health



CHEST

WARNING
TRIPPING
Hazard

au train au train

↑ ENTER ↑





au bon pain

the bakery





ASAP

Pack of 30
250

au bon pain

au bon pain

a bakery cafe



au bon pain





Jefferson Health.



 Jefferson Health.





leading
optimistic
revolutions

giving.jefferson.edu