

MARCONI PLAZA MASTER PLAN SUMMARY

INTRODUCTION

Marconi Plaza in South Philadelphia is one of the city's largest public open spaces. It is one of the only parks that is divided by Broad Street, creating two nearly identical halves.

Currently, Broad street presents several unique challenges for park users as it separates the spaces both physically and emotionally.

We consistently heard that improved safety and maintenance were the community's primary concerns. This helped inform our design goals of promoting a safer and more maintainable park. The design succeeds if it is manageable and accessible for all to enjoy.

PPR will begin to identify avenues for funding with Council District 2 and other supporting stakeholders.



MARCONI PLAZA

Marconi is 3 times the size as Rittenhouse Square, optimizing space for **BOTH** activity and civic use.



RITTENHOUSE SQUARE

"I AM AT MARCONI ..."

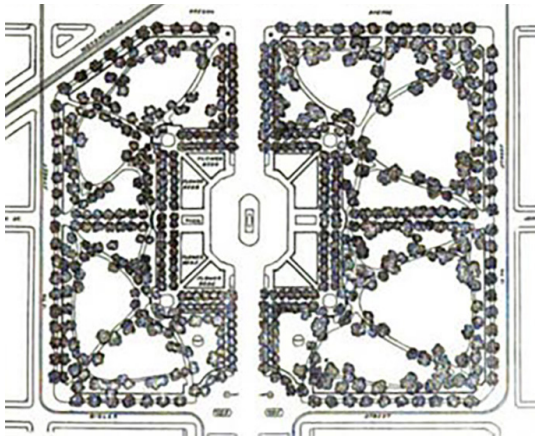

**THE ORIGINAL DESIGN BY
THE OLMSTEAD BROTHERS - 1913**



CURRENT DAY 2023

In 1913, the Olmstead Brothers famously designed the park with regal tree lined parkways to serve as the gateway to the 1926 Sesquicentennial Exposition, sited further south on Broad.

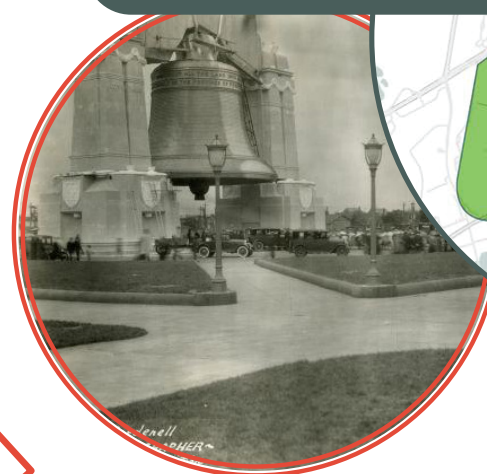

Want to know how to get involved in your neighborhood? Or receive updates about Marconi?

Get in touch with the Friends of Marconi by contacting: pprstewarship@phila.gov
friendsofmarconiplaza@gmail.com

FIND YOUR PATH PHILADELPHIA PARKS & RECREATION

Land Collective
DAVID RUBIN

Lead Community Engagement & Design Consultant: Land Collective

Supported by: Council District 2, PPR, SCSSD & Friends of Marconi.

MARCONI PLAZA MASTER PLAN SUMMARY

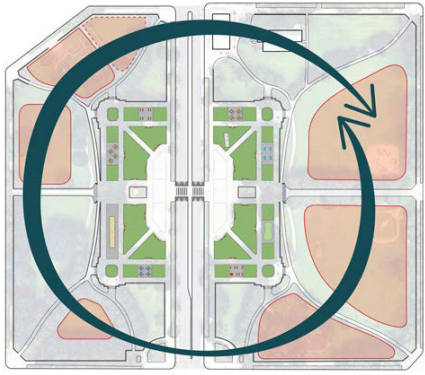

ACTIVE PERIMETER

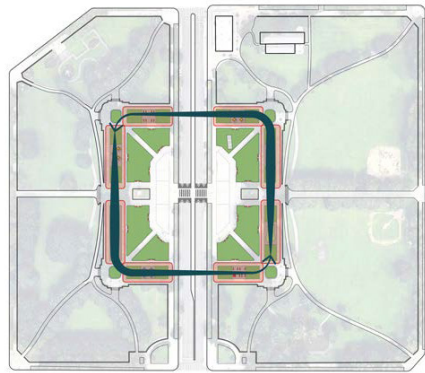

SOCIAL RING

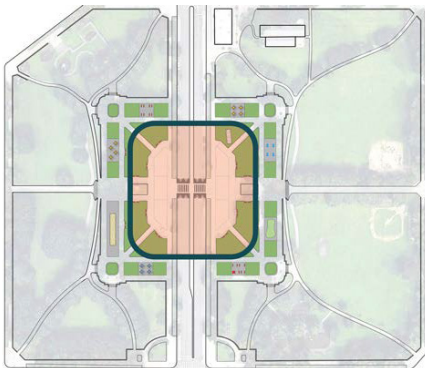

CIVIC CORE

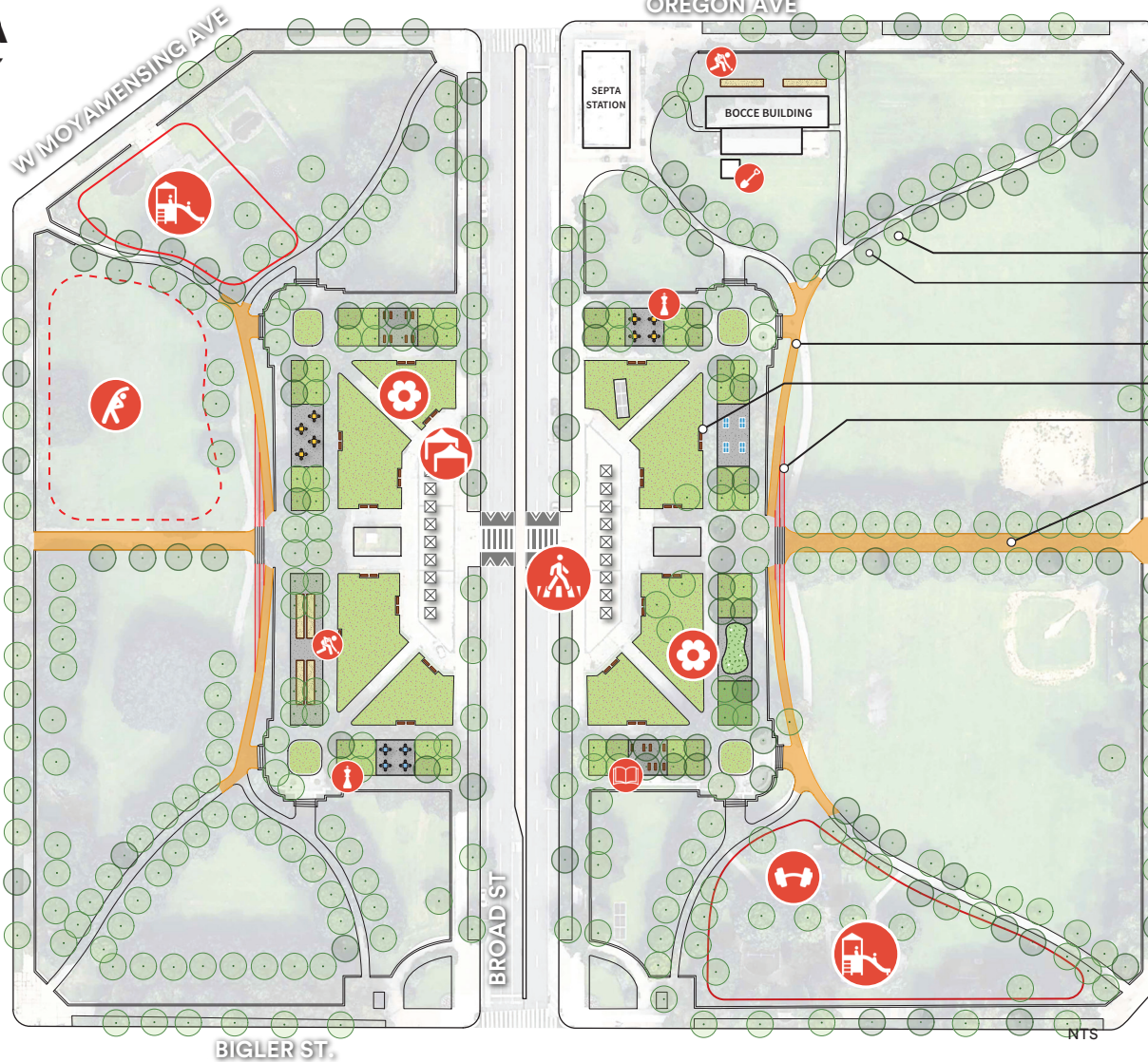

PHASE 1

- TRAFFIC STUDY: IMPROVE PEDESTRIAN SAFETY**
- IMPROVED LIGHTING
- EXISTING TREES PRUNED
- BOLD CIRCLES REPRESENT NEW TREES IN ORIGINAL LOCATIONS**
- RE-ALIGNED ACCESSIBLE PATHS
- ADDITIONAL BENCHES
- TERRACES FORM AN EXTENSION FROM STAIRS
- RE-PAVE PATHS

PHASE 2

- RENOVATE THE PLAYGROUND AT BOTH LOCATIONS**
- OUTDOOR FITNESS EQUIPMENT**
- GRADING FIELD FOR MIXED SPORT USE**
- SHED FOR FRIENDS GROUP**

PHASE 3

- NATIVE & POLLINATOR FRIENDLY PLANTINGS**
- CENTRAL PLAZA REMAINS OPEN FOR POTENTIAL MARKET OR EVENT SPACE**
- LENDING LIBRARY**
- BOCCE LANES**
- CHESS TABLES**

PHASING GOALS

1. **UPGRADE** essential infrastructure and park elements throughout, as most requested
A traffic study across city departments will be initiated in order to implement safer pedestrian crossing by Phase 3
2. **ENHANCE** existing active and play spaces
3. **ACTIVATE** the elevated, middle plaza to serve as a civic space within the park
*The outer edge will have activities to prompt social and passive play
The center plaza space will remain open for potential events*



Lead Community Engagement & Design Consultant: Land Collective
Supported by: Council District 2, PPR, SCSSD & Friends of Marconi.