

## PROJECT INFORMATION

BUSINESS NAME	LOCO PEZ FISHTOWN COMM. ACTIVITY LIC. NO. 538627
<b>BUSINESS ELIGIBILITY</b>	
FOOD LICENSE	YES (FOOD PREP LIC. NO. 538629)
INDOOR SEATING	YES
CUSTOMER RESTROOMS	YES
<b>LOCATION REQUIREMENTS</b>	
LOCATED WITHIN BY-RIGHT AREA PER SECTION 9-215	NO (HAS RCO AND COUNCILMAN SUPPORT)
<b>SITE REQUIREMENTS</b>	
PARKING LANE	YES
CLEAR OF EMERGENCY RESPONSE FACILITY	YES
MIN. 12' WIDE TRAVE LANE	YES
<b>APPLICATION TYPE</b>	
TYPE OF STREETERY	STRUCTURED
<b>PA ONE CALL</b>	
SERIAL NUMBER	20230301378

**HEXAGON** STUDIO  
ARCHITECTS

2229 East Huntingdon St., Philadelphia, PA 19125  
T 215.510.2880  
[www.hexagon-arch.com](http://www.hexagon-arch.com)

**Owner:**

LOCO PEZ FISHTOWN  
2401 E NORRIS ST.  
PHILADELPHIA, PA 19125

**General Contractor:**

**Structural Engineer:**

•

**MEPF Engineer:**

—

Project Title:

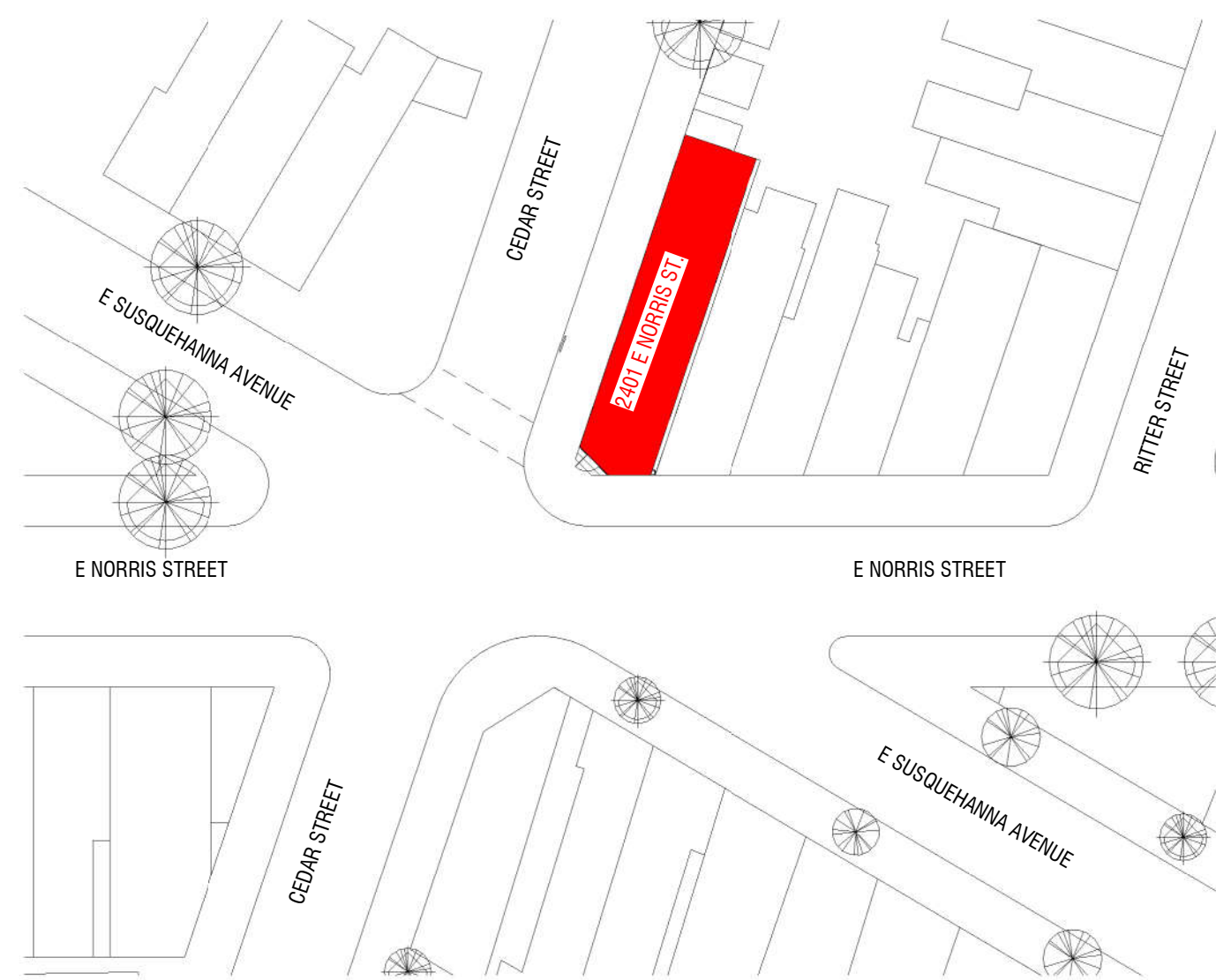

## KEY PLAN

### Approval Stamps

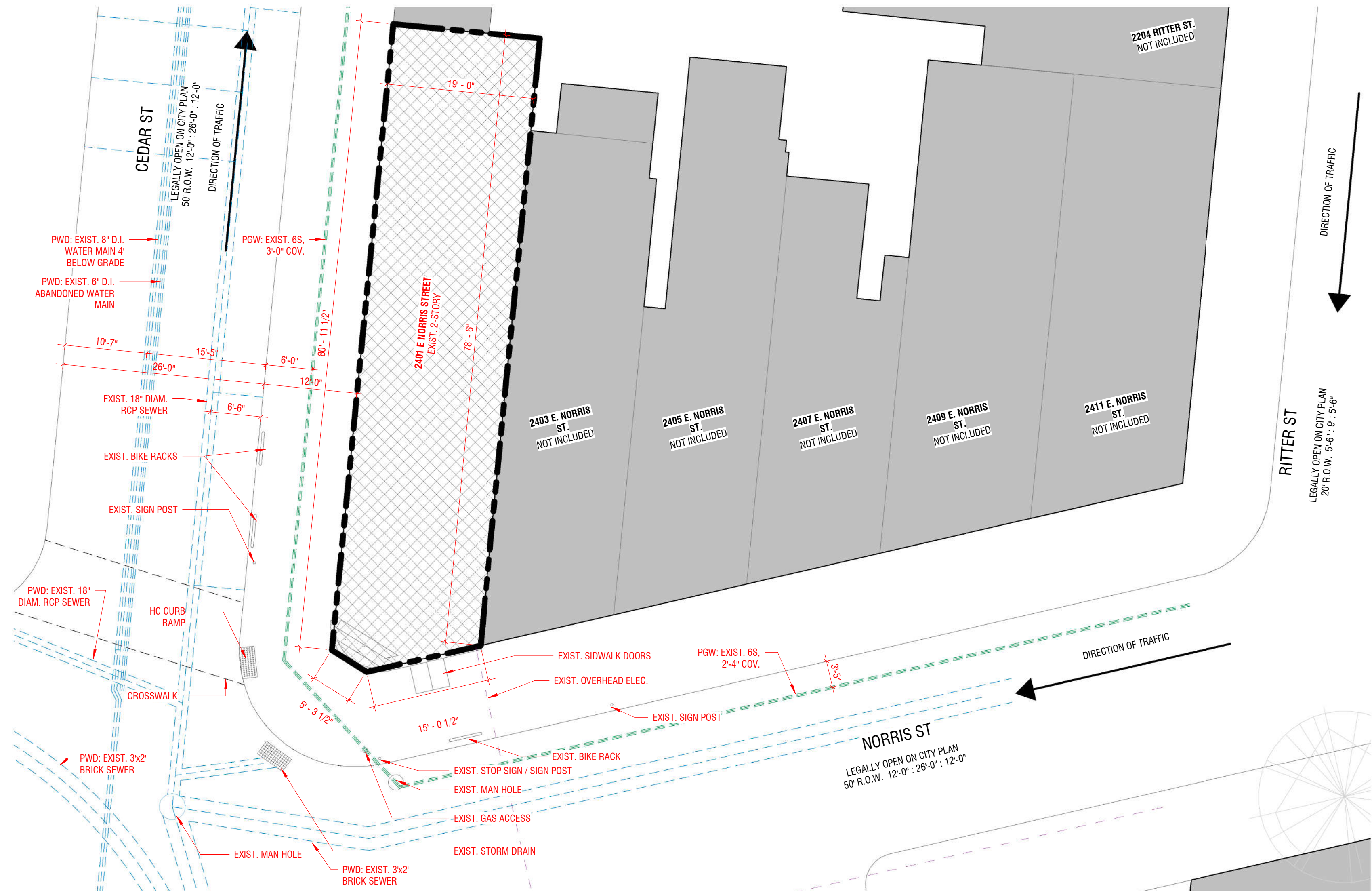
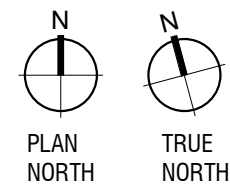

## 01 EXISTING SITE PLAN

LOCO PEZ

2401 E NORRIS STREET

Professional Seal:



The Professional Architect's seal affixed to this sheet applies only to the material and items shown on this sheet. All drawings, instruments or other documents not exhibiting this seal shall not be considered prepared by this architect, and this architect expressly disclaims any and all responsibility for such plans, drawings or documents not exhibiting this seal.

This drawing and details on it are the sole property of the architect and may be used for this specific project only. It shall not be loaned, copied or reproduced, in whole or part, or for any other purpose or project without the written consent of the architect.

[illegible]

Sheet Title

## ZONING

Project Number:

15016

Drawn By:

Author

Issue Date:

Sheet Number:

# Z101

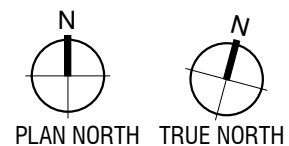
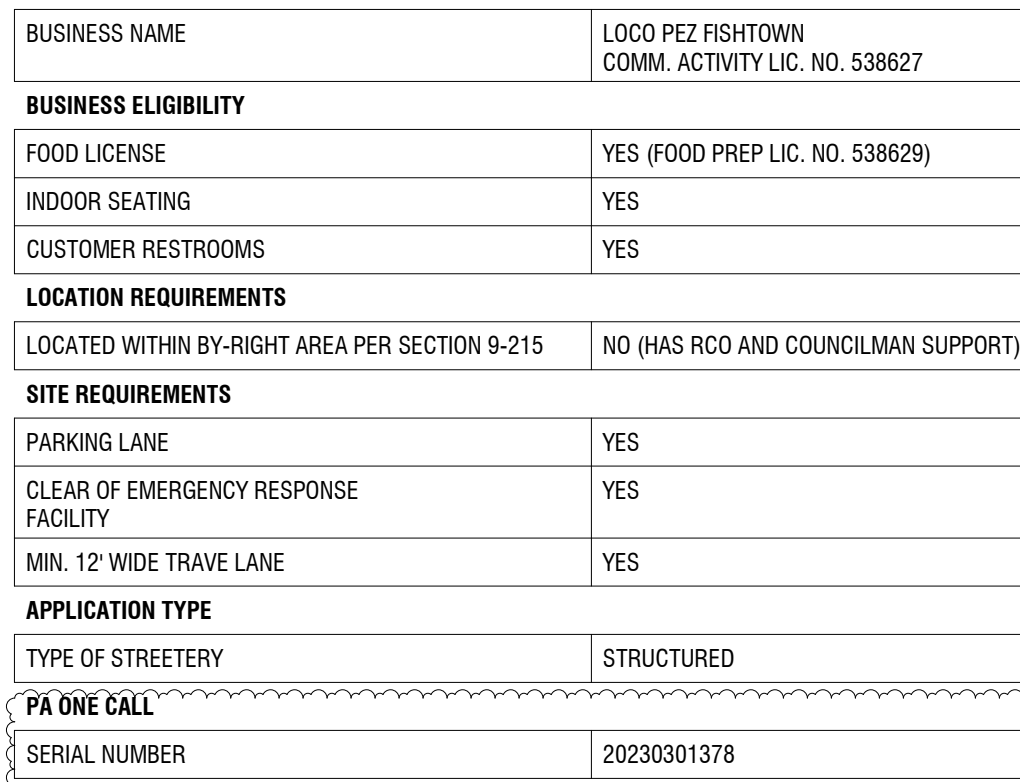
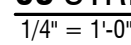
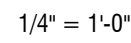

1. STREETERIES MAY ONLY OPERATE FROM 7AM TO 10PM SUNDAYS THROUGH THURSDAYS AND 7AM TO 11PM ON FRIDAYS AND SATURDAYS
2. STREETERIES ARE ONLY FOR SERVING CUSTOMERS FOOD AND BEVERAGES COMING FROM THE BUSINESS LICENSED PREPARATION ARE
3. STREETERIES MUST REMAIN FREE OF FOOD SCRAPS, SPILL STAINS, LITTER, AND ODORS AT ALL TIMES
4. A COPY OF THE STREETERY LICENSE MUST BE PROMINELY DISPLAYED WITHIN THE RESTAURANT
5. PROPANE TANKS, OTHER COMBUSTIBLES, OR OPEN FLAMES ARE NOT PERMITTED
6. NO PART OF THE STREETERY OR FURNISHINGS SHALL BE PERMANENTLY MOUNTED OR SECURED TO THE STREET OR SIDEWALK
7. NO ENCLOSED AREAS FOR EQUIPMENT, STORAGE OR UTILITIES ARE PERMITTED
8. ELECTRICAL SERVICE VIA EXTENSION CORDS OR CONDUIT ABOVE OR BELOW THE SIDEWALK ARE NOT PERMITTED
9. TENTS, CANOPIES, PLASTIC DOME SHELTERS, OR OTHER LIGHTWEIGHT STRUCTURES ARE NOT PERMITTED
10. ATTACHMENTS TO THE BUSINESS BUILDING ARE NOT PERMITTED

**General Contractor**

## Structural Engineer

**MEPF Engineer:**

Project Title:

Professional Seal:



The Professional Architect's seal affixed to this sheet applies only to the material and items shown on this sheet. All drawings, instruments or other documents not exhibiting this seal shall not be considered prepared by this architect, and this architect expressly disclaims any and all responsibility for such plans, drawings or documents not exhibiting this seal.

This drawing and details on it are the sole property of the architect and may be used for this specific project only. It shall not be loaned, copied or reproduced, in whole or part, or for any other purpose or project without the written consent of the architect.

[illegible]

Sheet Title

## ZONING

Project Number:

15016

Drawn By:

Author

Issue Date:

Sheet Number:

# Z102





2/27/2023 2:14:32 PM

### Approval Stamps

**MEPF Engineer:**

- 
- 
- 
- 
- 

Project Title:

2401 E NORRIS STREET

This drawing and details on it are the sole property of the architect and may be used for this specific project only. It shall not be loaned, copied or reproduced, in whole or part, or for any other purpose or project without the written consent of the architect.

[illegible]

Sheet Title:

Project Number:  
15016  
Drawn By:  
Author  
Issue Date:  
02/24/23

Sheet Number:

# Z103