

Bus Shelter Deployment

September 2021

#1 – 6th & Lehigh Ave, NWC

Proposed Bus Shelter Site – New – 1 Standard
Note: Final shelter position pending PA – 1 Call & Streets Department ROW Approval

MAP

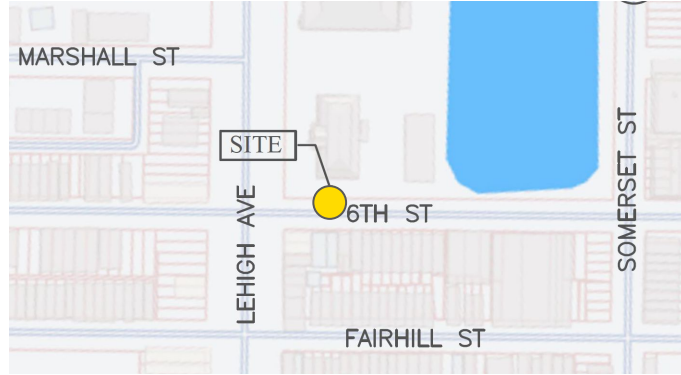

EXISTING CONDITIONS

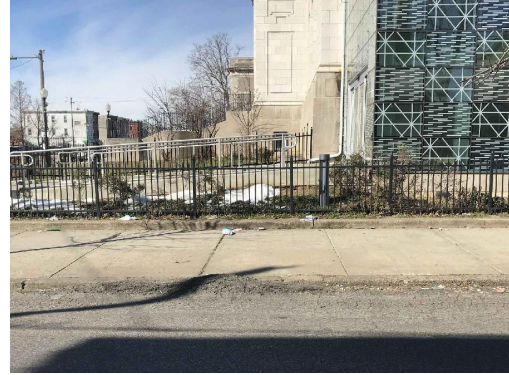

SITE PLAN

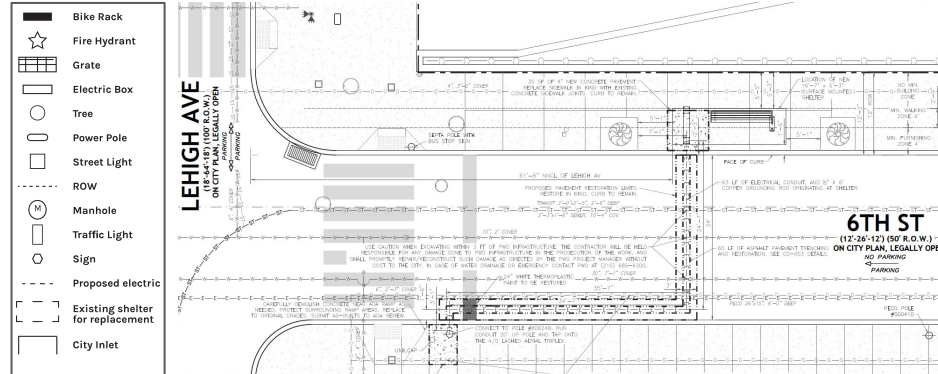

RENDERING



#2 - 19th & Vine St NWC

Proposed Bus Shelter Site - Replacement - 1 Standard

Note: Final shelter position pending PA - 1 Call & Streets Department ROW Approval

MAP

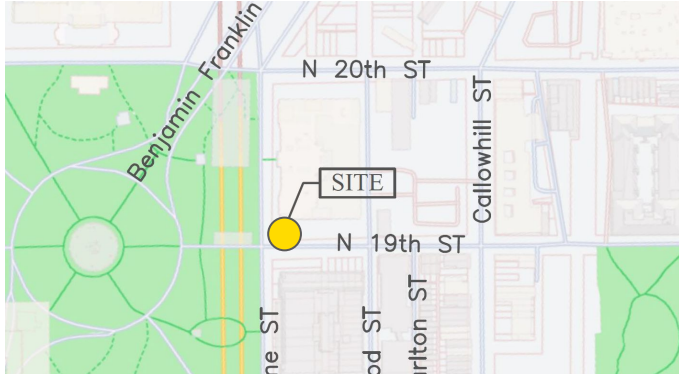

EXISTING CONDITIONS



SITE PLAN

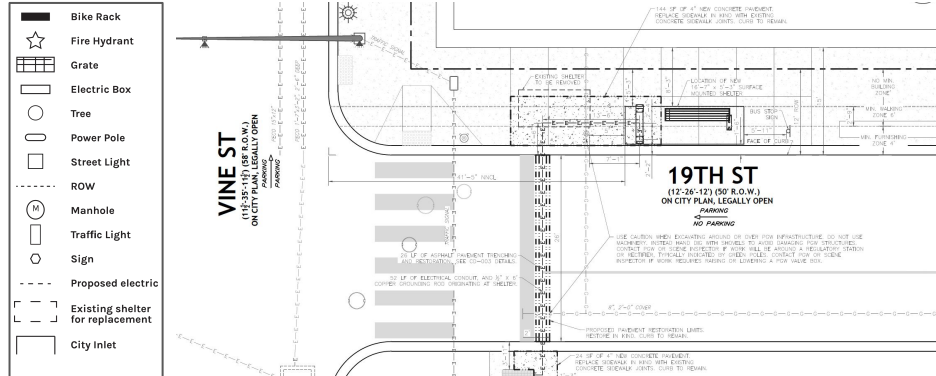

RENDERING



#3 – 54th & Berks St, NWC

Proposed Bus Shelter Site – Replacement – 1 Small
Note: Final shelter position pending PA – 1 Call & Streets Department ROW Approval

MAP

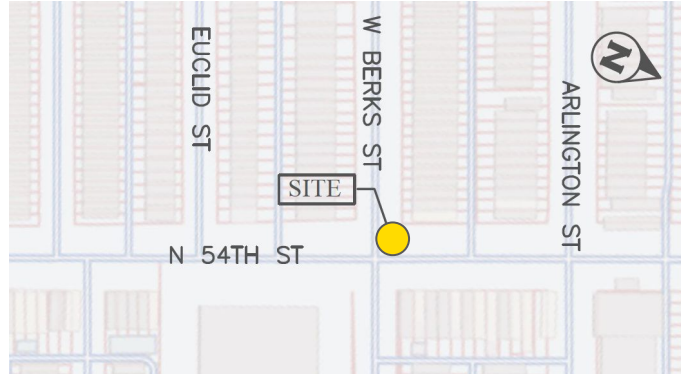

EXISTING CONDITIONS



SITE PLAN

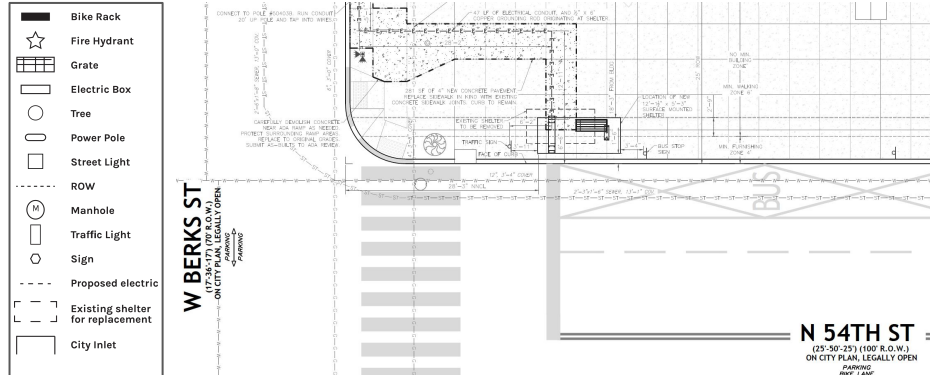

RENDERING



MAP

Note: Final shelter position pending PA - 1 Call & Streets Department ROW Approval

MAP

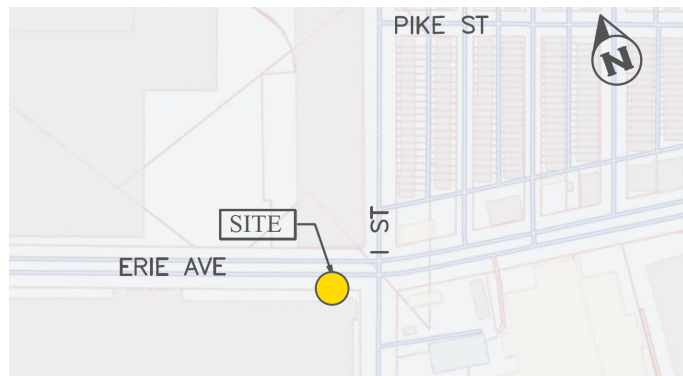

EXISTING CONDITIONS



SITE PLAN

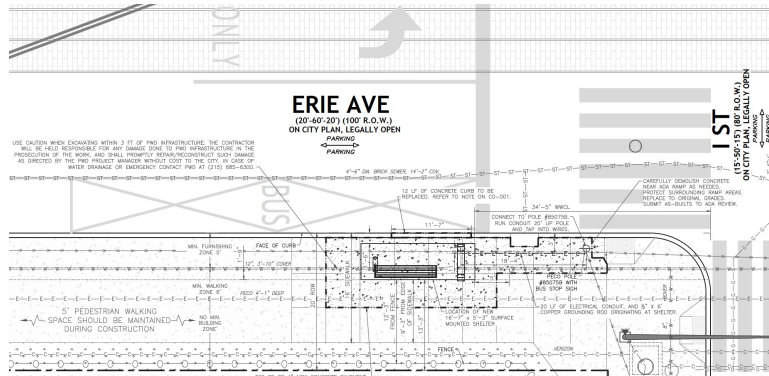
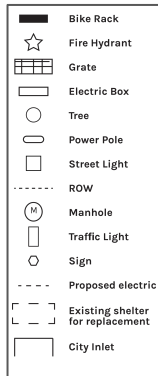

RENDERING



#5 – Germantown & Tioga St, SEC

Proposed Bus Shelter Site – Replacement – 1 Small
 Note: Final shelter position pending PA – 1 Call & Streets Department ROW Approval

MAP

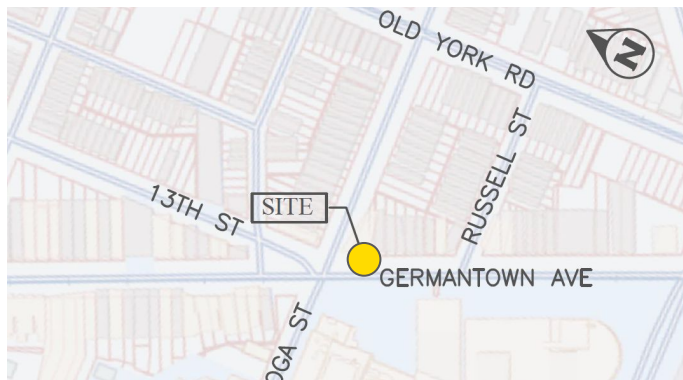

EXISTING CONDITIONS



SITE PLAN

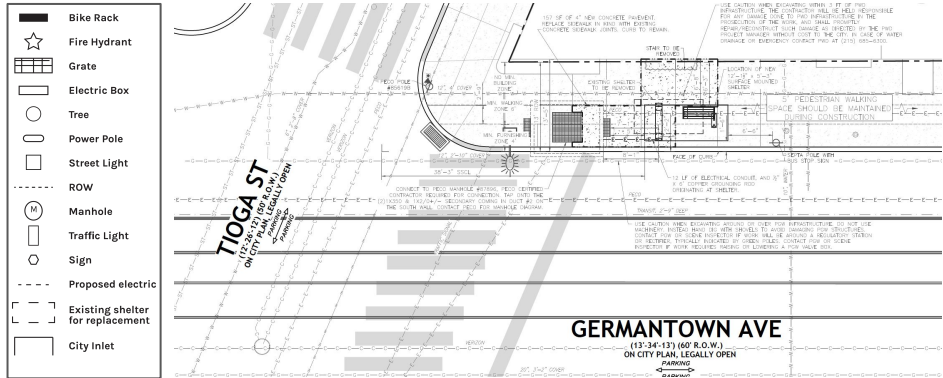

RENDERING



#6 – Henry Ave & Indian Queen Lane, MB

Proposed Bus Shelter Site – New – 1 Standard
 Note: Final shelter position pending PA – 1 Call & Streets Department ROW Approval

MAP

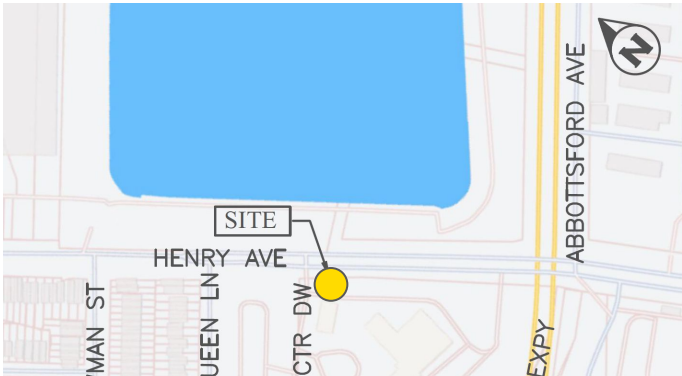

EXISTING CONDITIONS



SITE PLAN

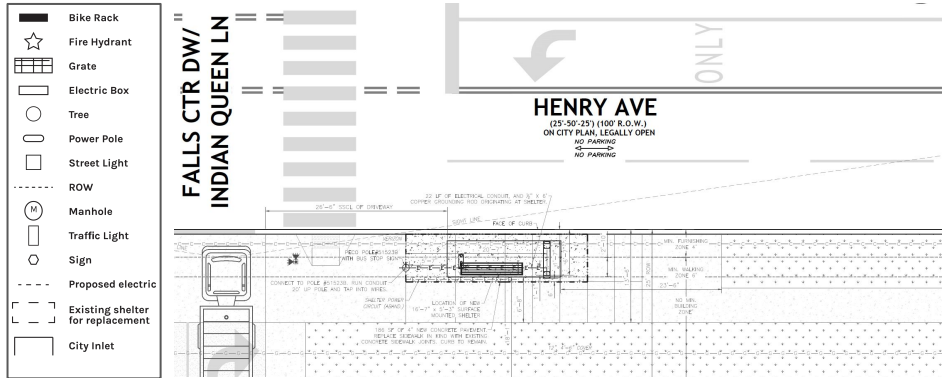

RENDERING



#7 – Pratt & Horrocks St, SWC

Proposed Bus Shelter Site – New – 1 Standard
Note: Final shelter position pending PA – 1 Call & Streets Department ROW Approval

MAP



EXISTING CONDITIONS

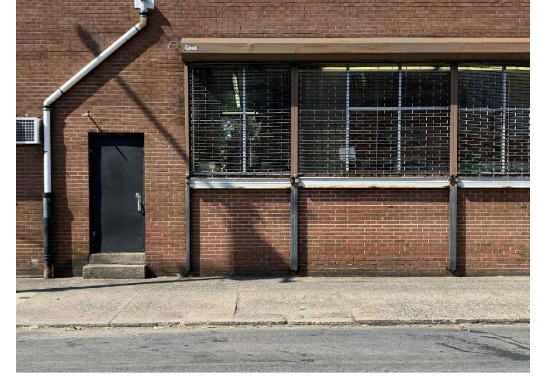

SITE PLAN

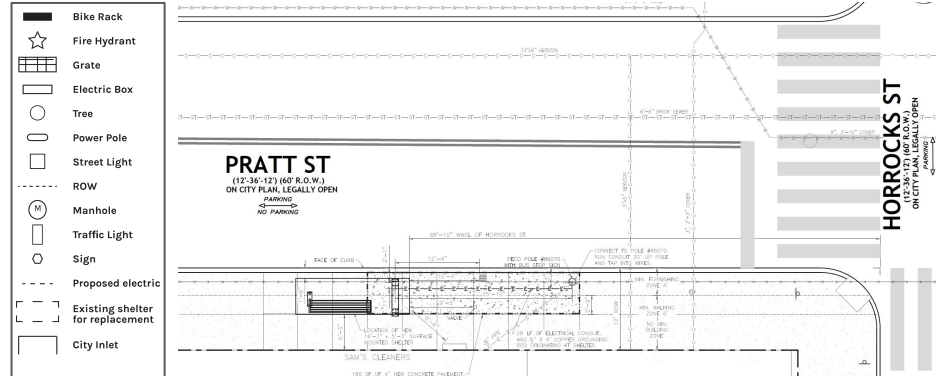

RENDERING



#8 – Ridge & Fountain, SWC

Proposed Bus Shelter Site – New – 1 Standard
Note: Final shelter position pending PA – 1 Call & Streets Department ROW Approval

MAP

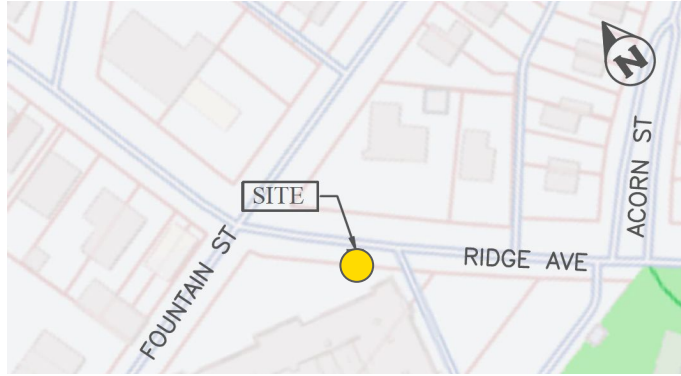

EXISTING CONDITIONS



SITE PLAN

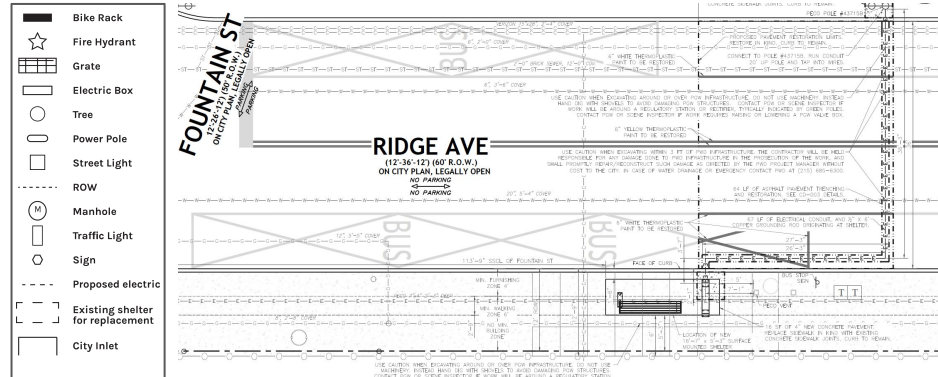

RENDERING



#9 – Ridge & Green, NWC

Proposed Bus Shelter Site – Replacement – 1 Standard

Note: Final shelter position pending PA – 1 Call & Streets Department ROW Approval

MAP

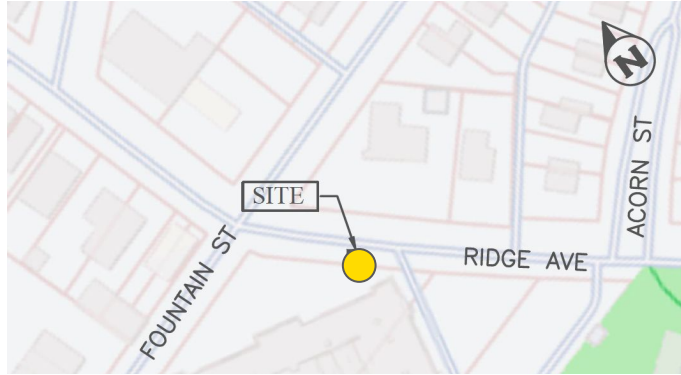

EXISTING CONDITIONS

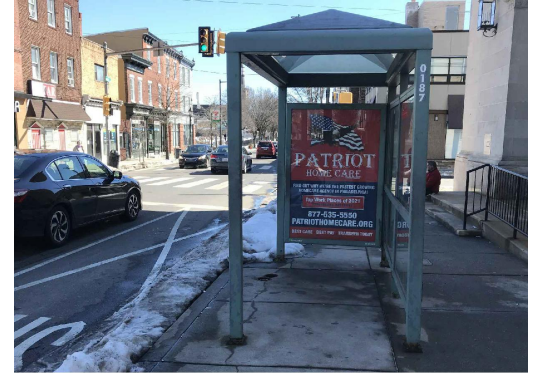

SITE PLAN

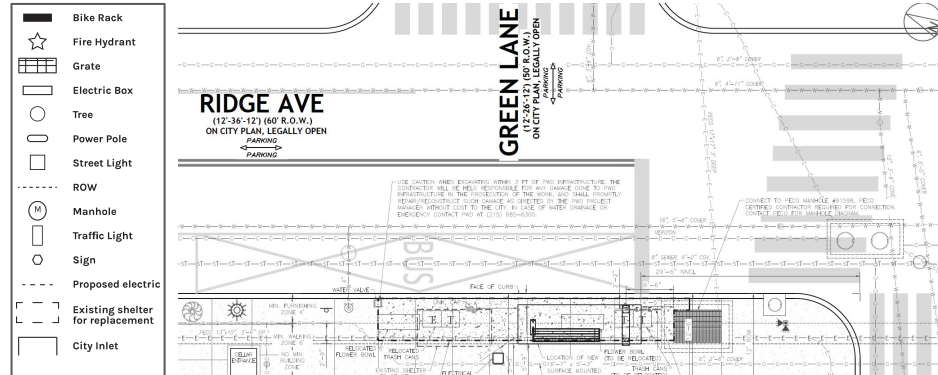

RENDERING



#10 – Spruce & 38th, SWC

Proposed Bus Shelter Site – Replacement – 1 Standard

Note: Final shelter position pending PA – 1 Call & Streets Department ROW Approval

MAP

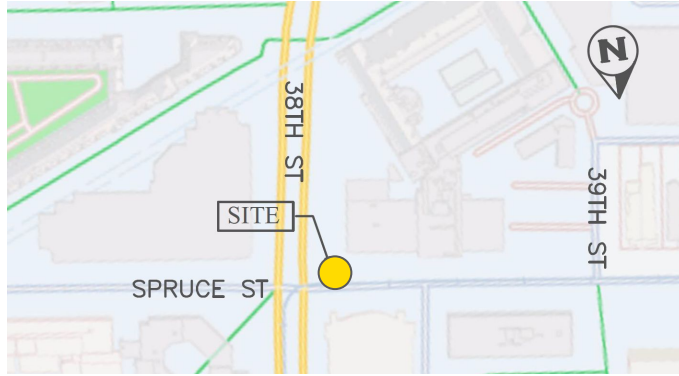

EXISTING CONDITIONS



SITE PLAN

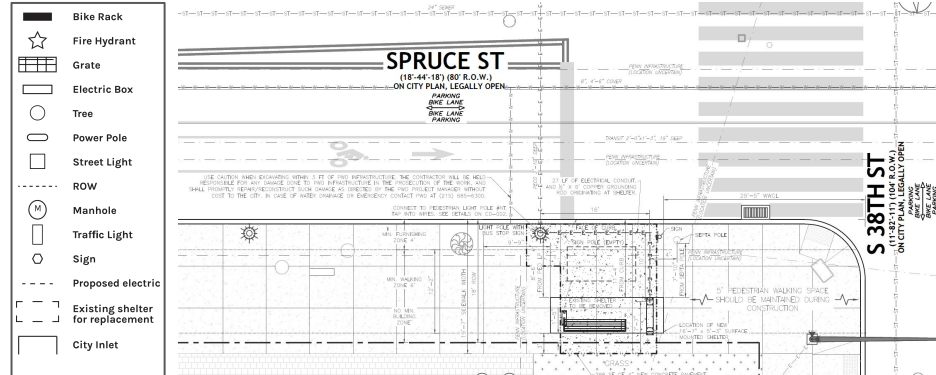

RENDERING



Thank You

Intersection

1635 Market Street, 17th Floor
Philadelphia, PA 19103
intersection.com