

TRANSIT PLATFORM PROTECTION BILL (#200496)

ENABLING ADA ACCESSIBLE BUS AND TROLLEY SERVICES

Overview

SEPTA, in coordination with the City of Philadelphia, is currently advancing its goal of providing comprehensive ADA accessibility through the **Direct Bus Program** and the **Trolley Modernization Program**.

The first phase of Direct Bus provided ADA accessible bus stations with large plazas and shelters on Roosevelt Boulevard from Cottman Avenue to Southampton Road. Phase B of Direct Bus will replicate this work on Roosevelt Boulevard from Pratt Street to Broad Street and on Hunting Park Avenue from Broad Street to Ridge Avenue.

The Trolley Modernization Program plans to replace the entire trolley fleet to provide comprehensive ADA accessibility throughout the system. SEPTA is planning to procure accessible low-floor vehicles and proposing ADA compliant near-level boarding and alighting platforms. Driveways or other curb cuts make the construction of an ADA accessible station impossible. While this program is not yet fully funded, it is important to preserve space for ADA accessible trolley stations.

In order to protect the transit platform space needed under the two programs, **Bill #200496** seeks to prohibit constructions of new curb cuts that may obstruct the construction of ADA accessible platforms.

Key points of Bill #200496

The bill proposes to *amend Section 11-104 of The Philadelphia Code, entitled "Curb Cuts"*. It will prohibit construction of curb cuts within an area designated by the Streets Department by regulation as a Transit Platform Area.

Definition:

- **Curb Cut:** An alteration to the curb that facilitates vehicular access across a sidewalk to connect the roadway to any public or private property.
- **Transit Platform Area:** Any area designated by the Department of Streets as a location for passengers to embark and disembark from a transit vehicle.

Existing (top) and modern passenger boarding (bottom)

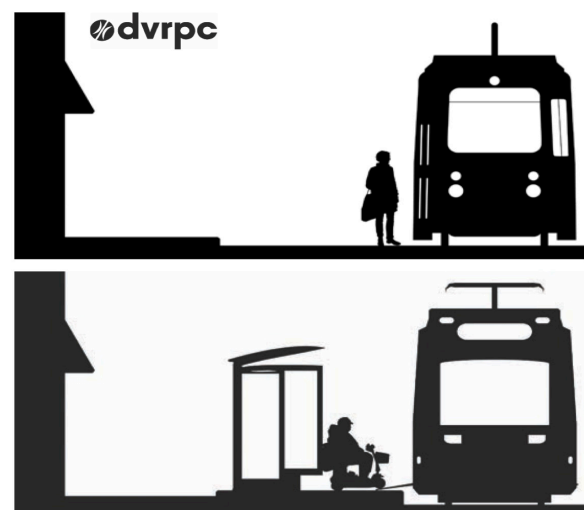

Proposed trolley platform esign

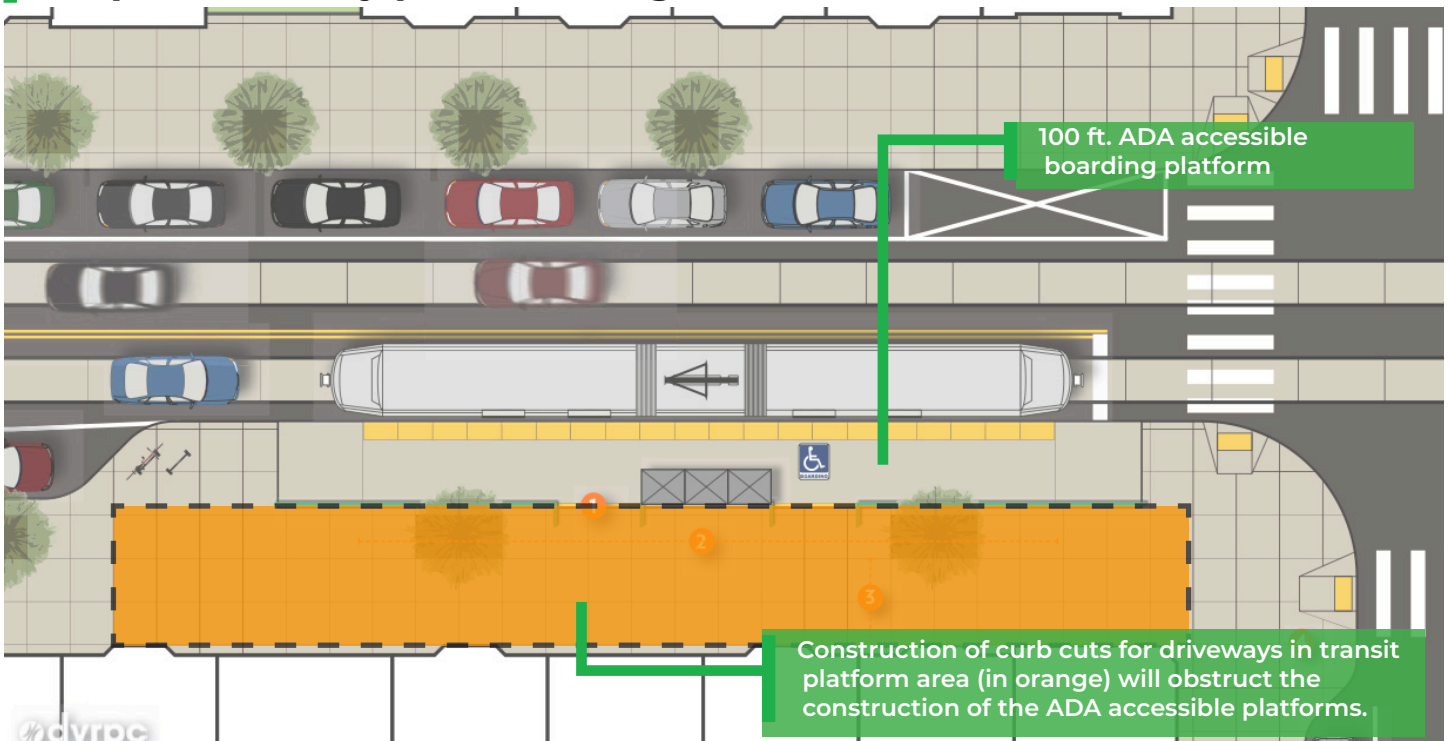

Trolley Modernization & Bus Corridor ADA Station Map

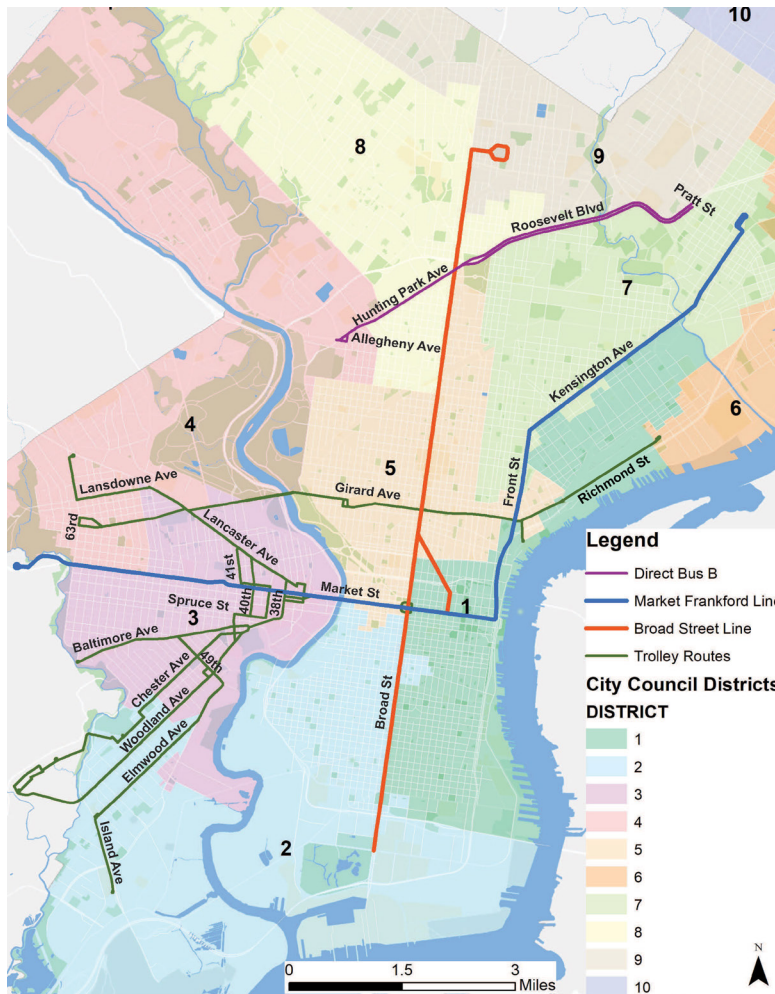

Graphic rendering of curb extension station and bicycle lane



Source: DVRPC