

1709-17 CHESTNUT ST.

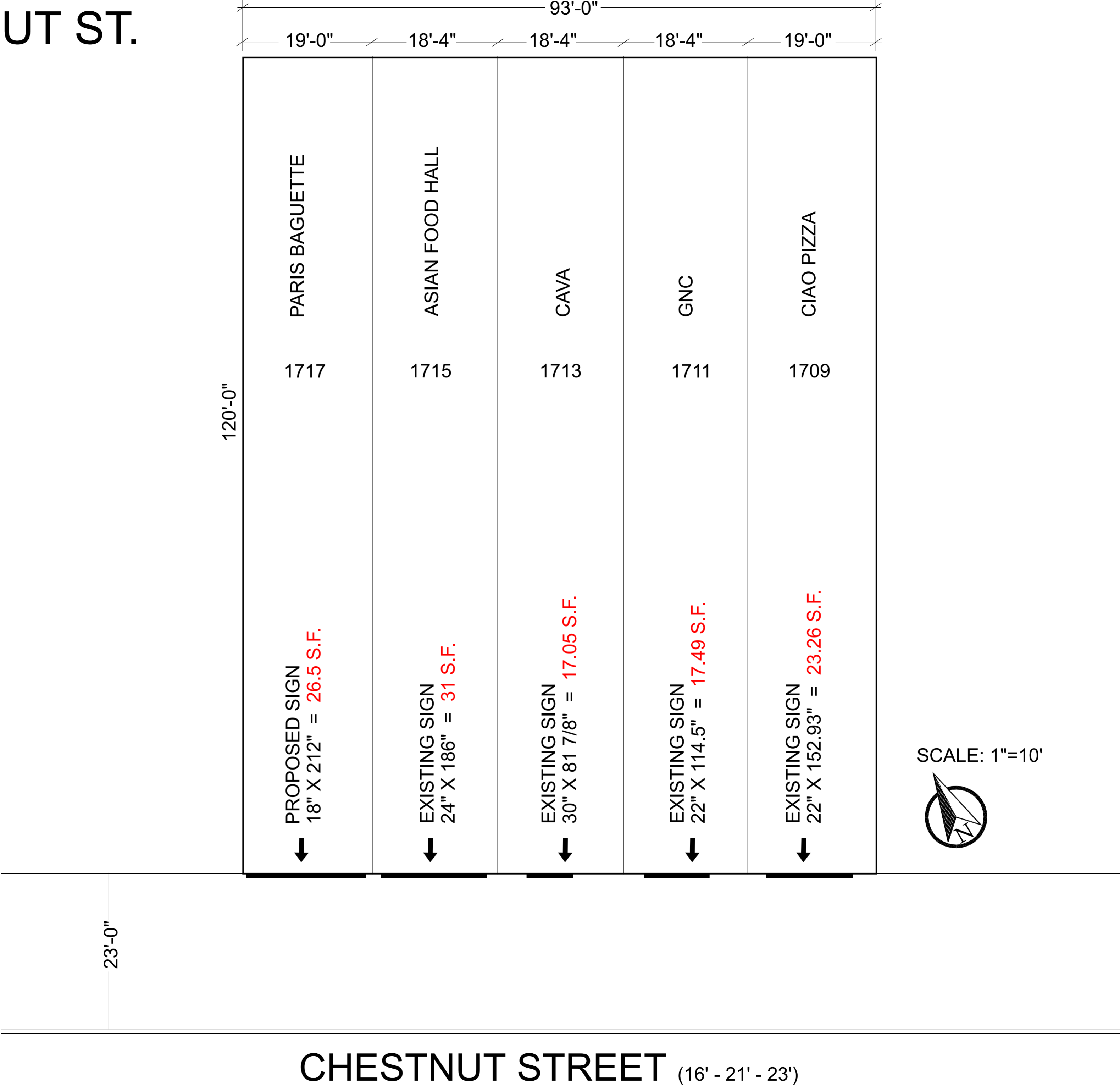



1.0 Elevation: Channel Letters White Faces on Blue Pan
Scale: 3/4" = 1'-0"

Area Assessment
Proposed: 18" x 212"/144 = **26.5 SqFt**

1.2 Side View
Scale: 3/4" = 1'-0"

 Paris Baguette Blue (PB Blue)
BM 2060-10 Symphony Blue

GENERAL NOTES:

- All Electrical Work Shall be Performed in Accordance with "NEC" Ref. Section 600
- All Electrical Sign Sections to Have U.L. Label in Accordance with "NEC" 600.3 and Manufacturers Label Located Next to Disconnect Switch
- All Non-Current Carrying Metal Parts of Sign Shall be Grounded & Bonded In Accordance With "NEC" 250
- All Wiring Contained in Enclosed Areas with Lamps Shall Be Fixture Rated
- Splicing of Conductors Shall be Made in Junction Boxes or Similar Metal Enclosures
- At the Point that Electrical Cable Passes Thru the Sign Box, it Shall Pass Thru A U.L. Listed Rubber Grommet
- All Plastic Materials Shall Comply with The Requirements of IBC Section 2606.4

Ultimate Wind Speed: 115 Mph
-3 Sec Gust Wind
Exposure: B
Estimated Sign Weight
-7 Lbs. Per Ltr.
Estimated Electrical Load
5a @ 120vac
Estimated Electrical Req.
(1)20a Circuit @ 120vac

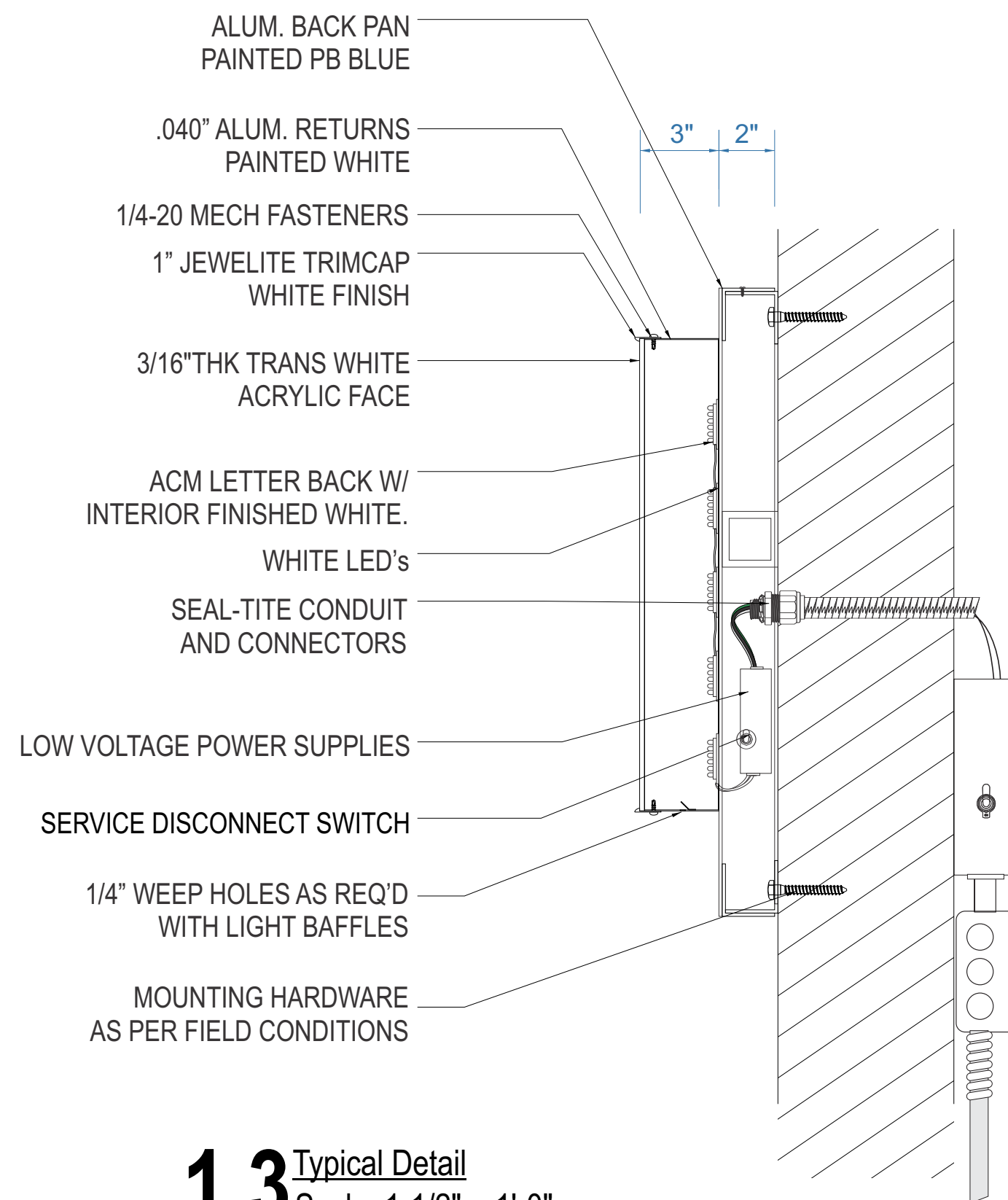

1.3 Typical Detail
Scale: 1-1/2" = 1'-0"



Existing



Proposed