

REBUILDING & REIMAGINING

THE **NEW** HANCOCK PLAYGROUND WILL INCLUDE:

- ✓ **PLAY FOR ALL AGES**
- ✓ **LOTS OF SEATING**
- ✓ **OUTDOOR FITNESS**
- ✓ **MORE GREEN SPACE**
- ✓ **A REFRESHED LOOK**
- ✓ **AND BE WELCOMING TO ALL NEIGHBORS!**

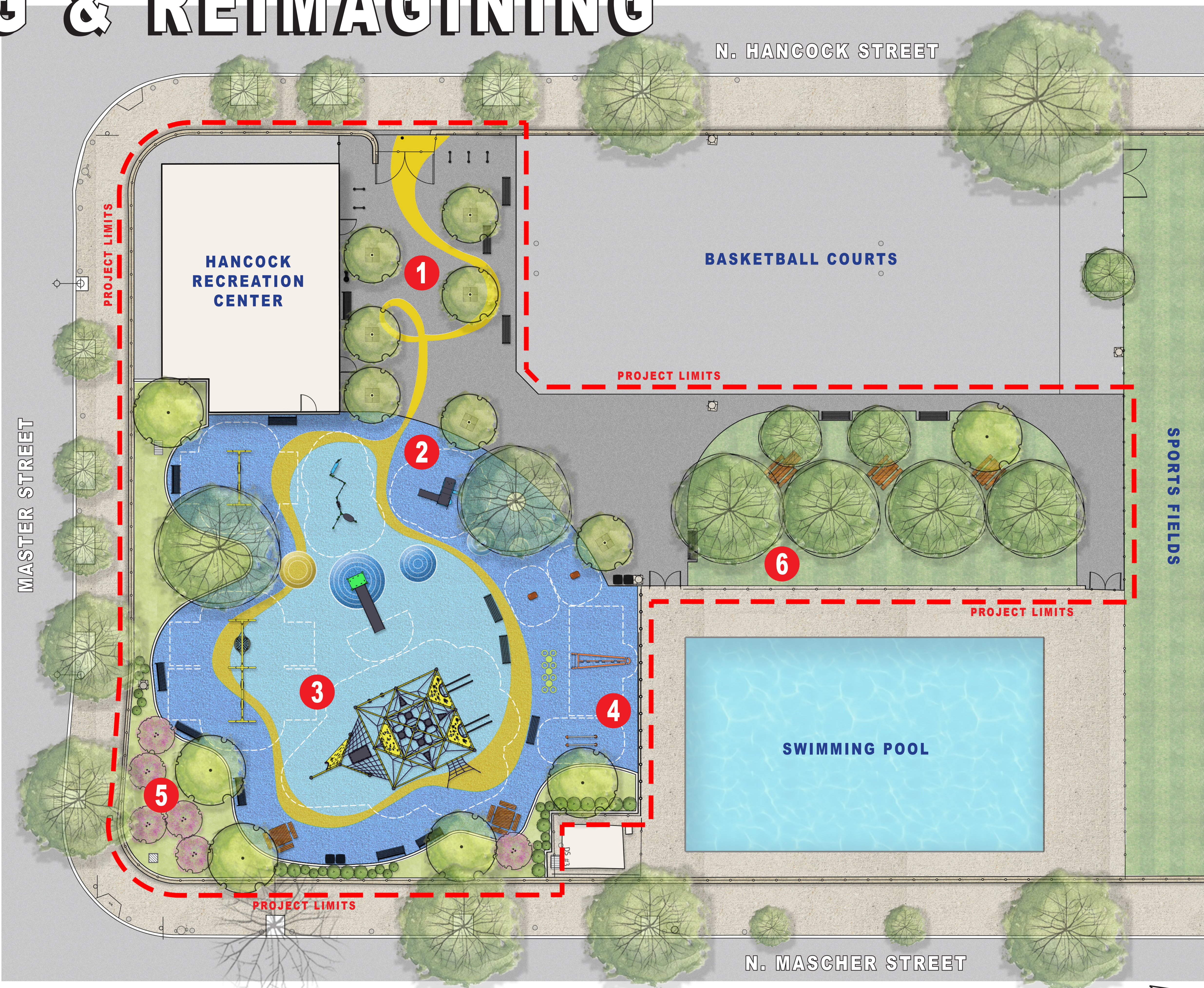

HANCOCK PLAYGROUND

1 WELCOMING ENTRANCE

A curvy pattern on the pavement and a grove of shade trees will welcome neighbors into the playground.

Bicycle racks, a drinking fountain / bottle-filling station, and benches will enhance the space for people to arrive, gather, and meet friends.

The curvy pavement pattern nods to the unique murals painted on the sides of the Rec Center building, and will draw kids straight into the play areas made for them.



4 FITNESS ZONE

AGE RANGE: 13 YEARS +

Outdoor fitness equipment adjacent to the playground will create space for the entire community to be active. Teens, adults, and elderly neighbors will be able to get active while enjoying the fresh air.

A suspension trainer, parallel bars, steps, and pavement markings for agility training promote a wide range of physical movements. Visitors will be able to perform solo work-outs or engage in group exercise.

Plenty of seating in the fitness zone will be provided for those much needed breaks between movements!



2 TODDLER PLAY

AGE RANGE: 6 MONTHS - 5 YEARS

Younger children will have their choice of play experiences with two different pieces of play equipment, a set of swings, and low mounds.

The play equipment will stimulate language development, encourage socialization, and spark imagination, while the low mounds will allow for creative play and strengthen physical skills.

Seating, shade, protection from older play, and visibility were all carefully considered when creating the Toddler Play Space.



5 PLAYGROUND GREENING

Surrounding the playground and fitness zone will be a curvy plant bed that will provide a number of benefits. New canopy and understory trees will give shade during hot summer days and reduce urban heat island effect.

Between the trees will be low-maintenance, native plants that will create habitat for local pollinators.

Utilizing the existing low point at the southeast corner of the playground, a rain garden will collect and infiltrate stormwater runoff.

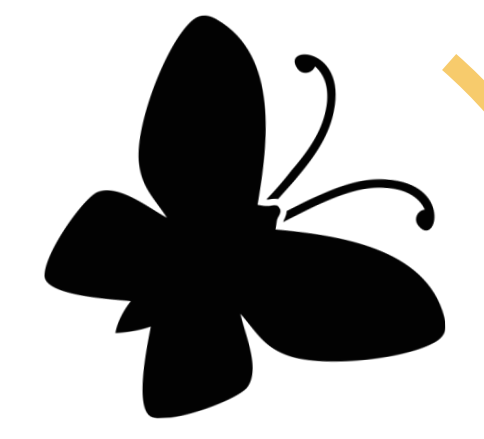

3 THRILLING PLAY

AGE RANGE: 5 YEARS +

A feature climbing structure will stand as a distinctive attraction at Hancock Playground.

The structure has three-dimensional nets that offer a varied and wild climbing experience, and membranes that create bounce and act as meeting points. Risk assessment, concentration skills, spatial awareness, and cross-body coordination will be trained as children navigate through and around the structure. The climbing structure, a larger set of swings, and an embankment slide will allow for hours of fun on the playground.



6 NEIGHBORHOOD LAWN

Expanding on the existing green space between the basketball court and swimming pool, new picnic tables can accommodate outdoor dining and neighborhood gatherings.

The lawn can act as flex space for games, yoga, and other leisure activities.

Because of its location, there will be opportunities to watch a pick-up game of basketball from the shady lawn on the west side, or lay out next to the pool on a soft surface out of the sun on the east side.

