

Sweet Cherry

Prunus spp. var Black Tatarian, Lapins, Bing

Small fruiting trees with fruit in June or July



Pipe-safe



Wire-safe

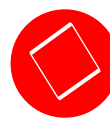

Patio-safe



Black Tatarian



Lapins



Bing

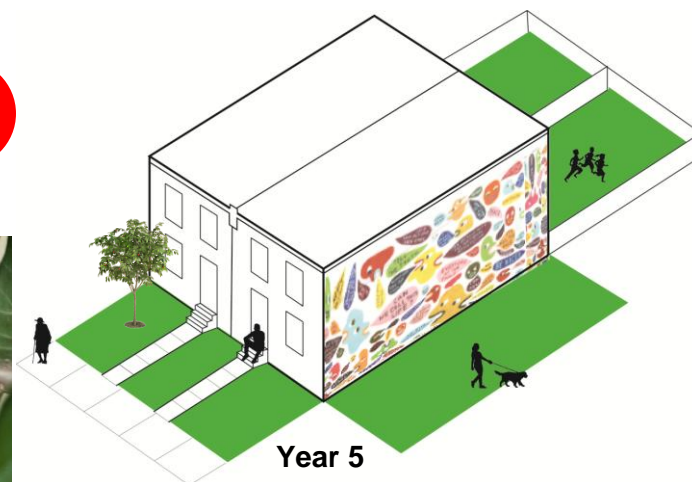

Year 5

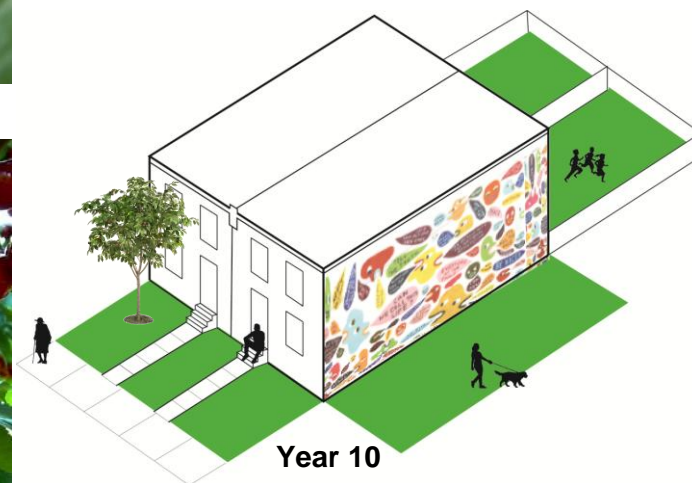

Year 10

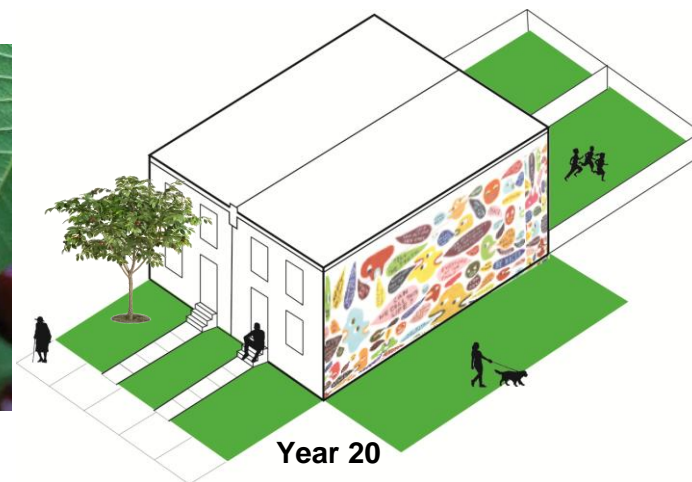

Year 20

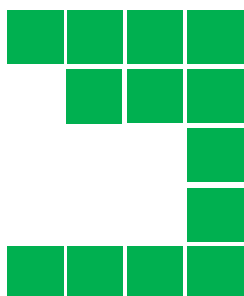

Sun: Full Sun

Soil: well-drained, sandy soil (not-compacted)

Height: Small 15 -30 feet

Width: Small, 15 – 30 feet

Maintenance: High, needs heavy pruning